



120mm



ring



Transformer
Smart Lighting



For your safety...



WARNING - Risk of electric shock. Do not mount power supply or luminaires within 10 feet (3.0 meters) of a pool, spa, or fountain.

CAUTION: For use only on a branch circuit protected by a Class A type Ground Fault Circuit Interrupter (GFCI).

When used outdoors, install only to a covered Class A GFCI protected receptacle that is weatherproof with the power unit connected to the receptacle. If one is not provided, contact a qualified electrician for proper installation. Ensure that the power unit and cord do not interfere with completely closing the receptacle cover.

Transformer must be installed greater than 1 foot above ground level.

Maximum wattage load is 200 watts. Verify that the combined total wattage of all fixtures is below 200W (for best results, do not exceed 140W).

For use with landscape lighting systems only.

Use with 12V or 15V landscape lights, including LED and halogen lights.

Use **ONLY** with common gauge sizes of CSA or UL approved low voltage cable (12-16 AWG).

DO NOT use with an extension cord.

DO NOT connect two or more power supplies in parallel.

This manual is for informational purposes only. Working with electricity can be dangerous unless proper safety precautions are taken. If you are not comfortable or are inexperienced with the processes and tools described in this manual, we recommend that you hire a licensed electrician.

1. Set up your Transformer.

Download the Ring app.

The app walks you through setting up and managing your Ring Transformer.

Download it on your iOS or Android device.



Set up your Ring Bridge.

The Bridge connects your Ring Transformer to the Ring app and other compatible Ring devices.

To set up your Bridge, follow the instructions in the Ring app or Bridge user manual.





Choose a location.

You'll have to plug in your Transformer, so the best place for it is near an outlet (make sure it's a covered, weatherproof Class A GFCI protected outlet).

Once you've decided on a spot, use the included mounting template to mark the screw holes.

To avoid damage to your Transformer, make sure the bottom screw is at least 1 foot above the ground.

Insert the top screws.

Drive the top screws first, leaving 1/8" of space between the mounting surface and screw heads.

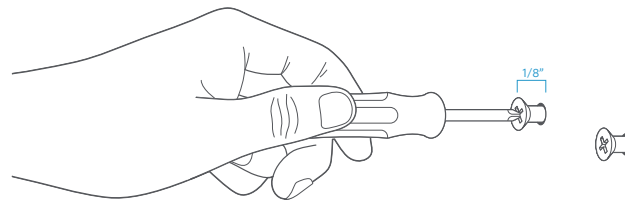

Mount your Transformer.

Align the Transformer with the top screws. Slide it down over the screws to lock it into place. Then drive the bottom screw to secure your Transformer.

2. Install lights and wiring.

Choose a cable.

Your Transformer doesn't come with low voltage cable, so you'll have to buy some online or at a home improvement store. This chart might help.

Ensure the total fixture wattage does not exceed the maximum wattage load of the Transformer.

To get the total wattage, add up the wattage of each fixture (example: 10 fixtures at 5W each is 50W total wattage).

		Wire Length *		
		0-50 Feet	51-100 Feet	101-150 Feet
Total Light Wattage	0-50 Watts	16 AWG	16 AWG	14 AWG
	51-100 Watts	16 AWG	14 AWG	12 AWG
	100-200 Watts	14 AWG	12 AWG	12 AWG with 15V Tap **

* Make sure your cable is long enough to reach all light fixtures. Consult cable manufacturer if additional wire length or connectors are needed.

** Only use 15V Tap when the wire length is over 100 feet and total wattage is over 100 Watts. 12V Tap is recommended for all other cases.



Place light fixtures.

If you're installing a new system, decide where you would like to place your lights (not included), and arrange them in the desired locations.

Open the Transformer door.

Hold it open to access the terminals.

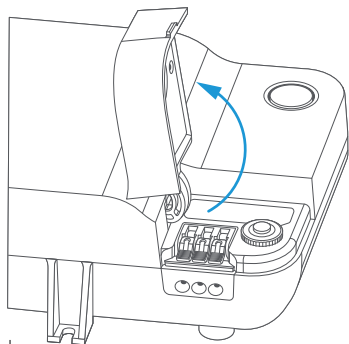

The rubber grommet can be removed to identify the terminals. Just make sure you don't lose it!

Connect cable to Transformer.

Split and strip the cable.

Flip open the terminals, and feed one end of the cable through the rubber grommet into the Common terminal (left), and the other into either the 12V (center) or 15V terminal (right) based on the cable wattage you chose.

Then close the terminals and the access door.

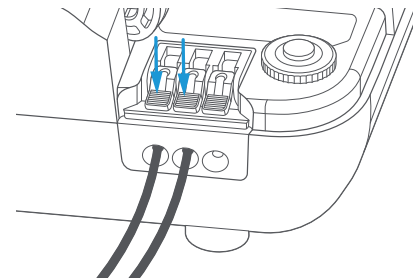
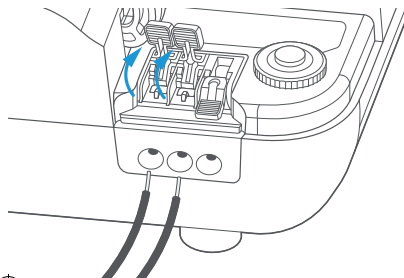



Run cable to fixtures.

Starting at the Transformer, run the cable to each light fixture, leaving about 12" of cable after the last fixture.



Leave a little extra cable at each fixture in case you have to adjust their location.

Connect the wires.

Secure the light fixtures to the cable according to the fixture manufacturer's instructions.

Plug the Transformer into the power outlet.

Your Transformer must be connected to a covered, weatherproof GFCI protected receptacle. If you don't have a covered, weatherproof GFCI protected receptacle, you'll need to hire a licensed electrician to install one.

Once plugged in, the button on the front of your Transformer will pulse red. Press the button. When it turns solid red, your Transformer is powered on.

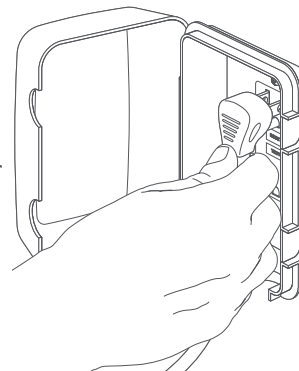



Bury wiring cable.

Dig a shallow trench (up to 6" deep) along the wiring route. Bury the wiring cable inside the trench.

Connect your lighting to Ring.

Press and hold the button on the front of your Transformer for 5 seconds.

Once it starts flashing blue, it's ready to pair with the Ring app.

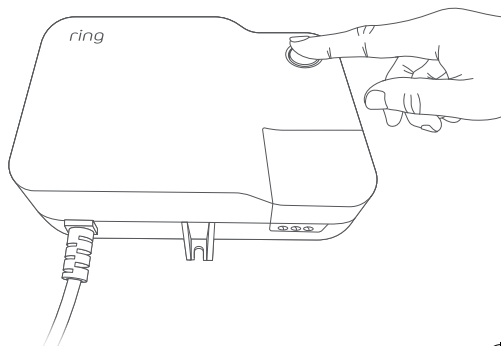

Complete Setup in the Ring app.

In the app, tap **Set Up a Device**.

When prompted, select **Smart Lighting** and follow the in-app instructions.

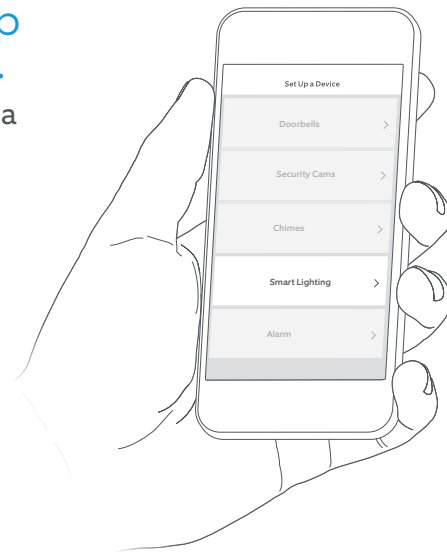



For additional help, visit: ring.com/help

Or give us a call...

[US 1 800 656 1918](tel:18006561918)

[Canada 1 855 300 7289](tel:18553007289)

[Worldwide +1 310 929 7085](tel:+13109297085)

For a list of all our customer support numbers, visit:
ring.com/callus

To review your warranty coverage, please visit www.ring.com/warranty.

Patents: www.ring.com/patents

© 2019 Ring LLC or its affiliates.

Ring, Alexa, Always Home, and all related logos are trademarks of Amazon.com, Inc. or its affiliates.

Last updated: 01/17/19

Warnings

This device complies with part 15 of the FCC Rules and Industry Canada licence-exempt RSS standard(s). Operation is subject to the following two conditions: (1) this device may not cause interference, and (2) this device must accept any interference, including interference that may cause undesired operation of the device.

Le présent appareil est conforme aux CNR d'Industrie Canada applicables aux appareils radio exempts de licence. L'exploitation est autorisée aux deux conditions suivantes : (1) l'appareil ne doit pas produire de brouillage, et (2) l'utilisateur de l'appareil doit accepter tout brouillage radioélectrique subi, même si le brouillage est susceptible d'en compromettre le fonctionnement.

This equipment has been tested and found to comply with the limits for a Class B digital device, pursuant to part 15 of the FCC Rules. These limits are designed to provide reasonable protection against harmful interference in a residential installation. This equipment generates, uses and can radiate radio frequency energy and, if not installed and used in accordance with the instructions, may cause harmful interference to radio communications. However, there is no guarantee that interference will not occur in a particular installation. If this equipment does cause harmful interference to radio or television reception, which can be determined by turning the equipment off and on, the user is encouraged to try to correct the interference by one or more of the following measures:

- Reorient or relocate the receiving antenna.
- Increase the separation between the equipment and receiver.
- Connect the equipment into an outlet on a circuit different

from that to which the receiver is connected.

- Consult the dealer or an experienced radio/TV technician for help.

Caution: Any changes or modifications to this device not explicitly approved by manufacturer could void your authority to operate this equipment.

MPE Reminding

To satisfy FCC / IC RF exposure requirements, a separation distance of 20 cm or more should be maintained between the antenna of this device and persons during device operation.

To ensure compliance, operations at closer than this distance is not recommended.

Les antennes installées doivent être situées de façon à ce que la population ne puisse y être exposée à une distance

de moins de 20 cm. Installer les antennes de façon à ce que le personnel ne puisse approcher à 20 cm ou moins de la position centrale de l'antenne.

La FCC des États-Unis stipule que cet appareil doit être en tout temps éloigné d'au moins 20 cm des personnes pendant son fonctionnement.