

Smart Partner For
Air Conditioner

INSTRUCTIONS

PRODUCT PROFILE

Smart partner for air conditioner is a smart thermostat, which can remotely control the switch/temperature/ mode and get real time status and electricity usage report of air conditioner by APP.

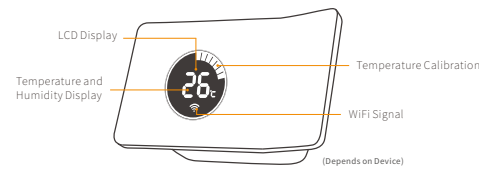

Indicator Lamp Description:
The blue or red light: Waiting for the network configuration
Green or white light: Configuration of the network status

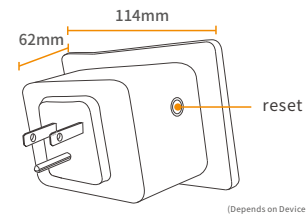

Attention:
Maximum Power is 3.5KW, Maximum Current is 16A
Please ensure the socket be used in dry circumstances.

INSTALLATION

1.Plug in the air conditioner into AC Partner.

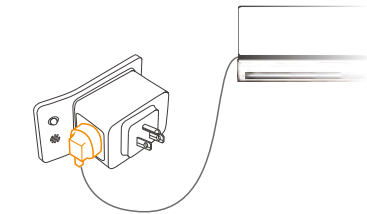

2.Plug AC Partner into a fixed socket

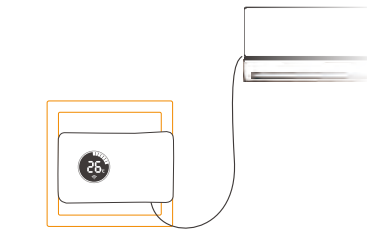

Please make sure that the LCD display is in red or blue status, otherwise, long pressing the reset button.

1 SCAN QR CODE TO GET THE APP
Download the APP by scanning QR code:

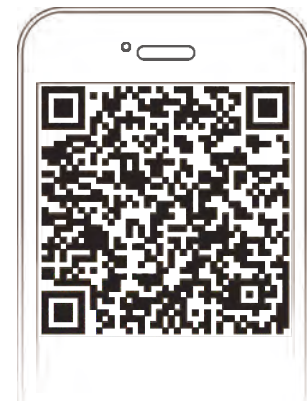

Notice:
Please remove the system limitation when installing the APP.

2 CONNECT TO THE NETWORK
Connect your mobile phone with home WiFi, Open the app, Click 'Add a New Device '

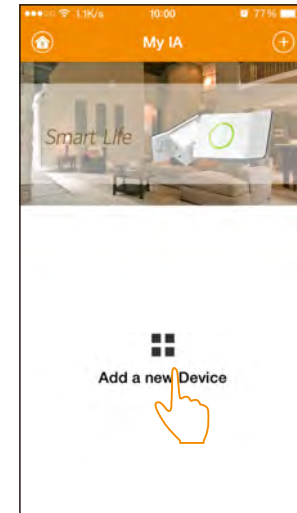

You can add a new device by clicking the button on the upper right side.

When the LCD display is in red or blue status, Please click 'Search' button after entering the password of your home WiFi.

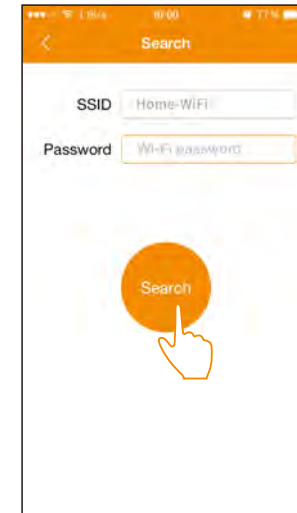

When the temperature and humidity are flashing alternately in the LCD display, it means AC Partner is connected successfully.

3 MATCH AIRCON TYPE
Come up with a nickname for the machine and then click the button 'Start to analyze your AIRCON'

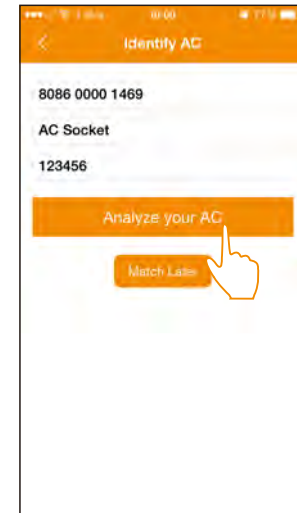

*The screen shots are for reference. The interface maybe different due to software update.

Press down the power button on aircon remote for analyzing, after that, you can control and manage your aircon via APP.



4 TV BOX CONFIGURATION
After AIRCON type configuration, back to APP main interface. Tap the TV box and enter for configuration when there is 'Not Matched'

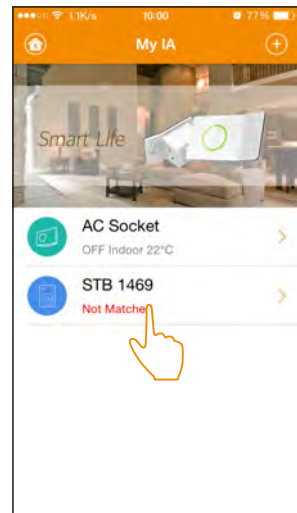

During the usage, you can edit the nickname and password of AC Partner through sliding left of the device from the above interface.

According to the APP indication, Press the TV box remote control button for pairing.



5 TV MATCHING
Tap 'TV' button to enter matching process in the TV box interface.

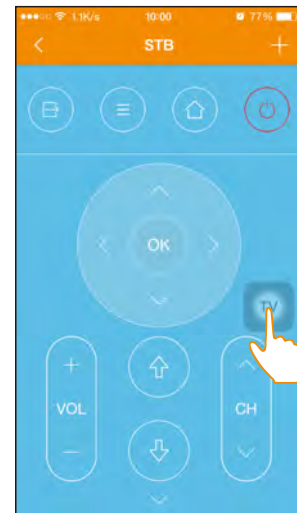

According to APP indication, press the TV remote control button to match with AC Partner.



The TV can be controlled remotely, after matching and press 'TV' button, and see the buttons of TV remote control.

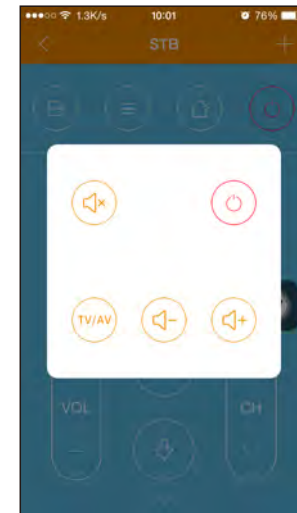

6 ADD CUSTOMIZED KEYS
AC Partner of this version support customized key, you can add as you wish. Press and pull-up the screen in the TV box interface and then tap '+' button

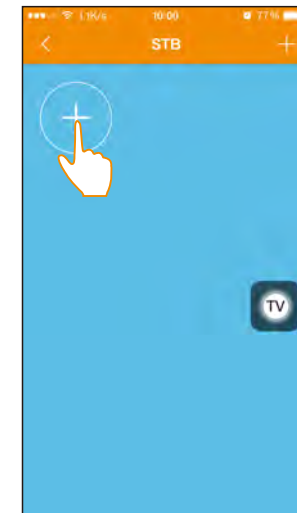

You can also tap '+' button on the upper right to add customized keys basing on the APP indications.

According to the APP indication, take the remote control to tap 'start' button and then tap the corresponding buttons for learning.



You can use it after buttons learning. You can also press and hold the button for relearning, editing and deletion.

FCC Caution:
Any Changes or modifications not expressly approved by the party responsible for compliance could void the user's authority to operate the equipment.

This device complies with part 15 of the FCC Rules. Operation is subject to the following two conditions: (1) This device may not cause harmful interference, and (2) this device must accept any interference received, including interference that may cause undesired operation.

FCC Radiation Exposure Statement:
This equipment complies with FCC radiation exposure limits set forth for an uncontrolled environment. This equipment should be installed and operated with minimum distance 20cm between the radiator& your body.

This transmitter must not be co-located or operating in conjunction with any other antenna or transmitter.