

aiwa[®]

EXOS-9

Quick Start Guide

THANK YOU.

Thanks for purchasing the Aiwa Exos-9 portable Bluetooth® speaker. Buying an Aiwa product means you want a listening experience you're proud to share with those around you, and it means a lot that you chose us.

aiwa

GETTING STARTED- BATTERY

Setting up your Exos-9 couldn't be simpler. First, make sure the battery pack is installed.

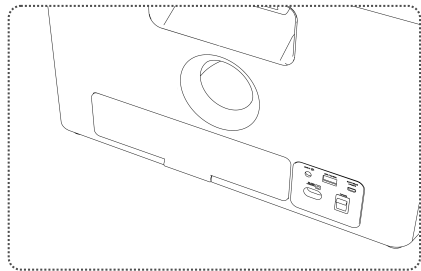
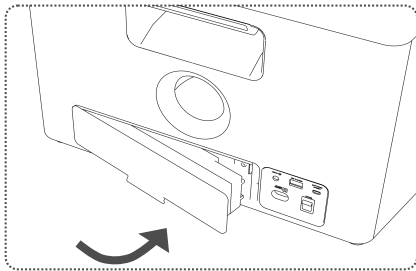

There is a small latch on the bottom of the unit that keeps the battery in place. When installing the battery, insert the tabs on the left first, and push the battery in until the latch clicks. To remove the battery, pull the catch on the latch outward.

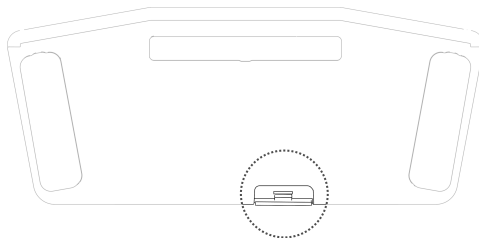

GETTING STARTED- PAIRING

Connect the power cord to the back of the Exos-9 and turn the power on using the switch. The screen should turn on. Now you're ready to listen!

The Exos-9 is always available to pair - in other words, there is no need for a "pairing mode". Just turn it on and search for it on your smartphone or other Bluetooth capable device - or simply tap your phone to the NFC touch-point on top of the speaker.

The Exos-9 will remember the last 8 devices paired, and will automatically connect when in range and powered on.

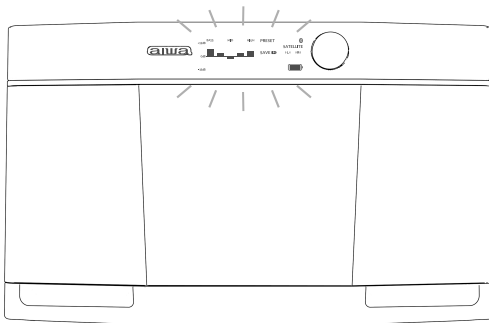

Note: The LINK button is only for connecting two Exos-9 speakers in mirror or stereo mode. Since it's always in "pairing mode", there is no need for an extra button just to connect to your device.

GETTING STARTED - PAIRING

Make sure Bluetooth is active on your device. If your device supports NFC pairing, touch it to the NFC icon in the circle on top of the device, just to the right of the button panel.

Otherwise, search for nearby Bluetooth devices. The speaker will appear as "Aiwa Exos-9".

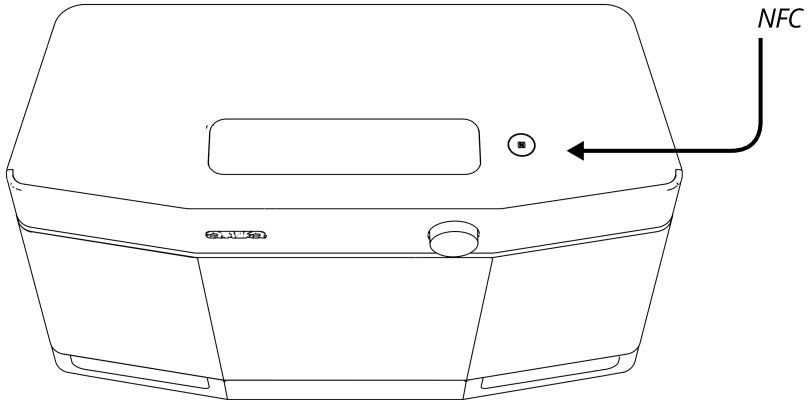

GETTING STARTED- AUX-IN

The Exos-9 will automatically switch to Auxiliary input when you connect a device using the 3.5mm cable.

However, this may be overridden if there is an active Bluetooth connection.

The screen will show "AUX IN" when this input is active. If it doesn't switch to the correct input automatically, hold the play/pause button on the speaker to switch inputs manually.

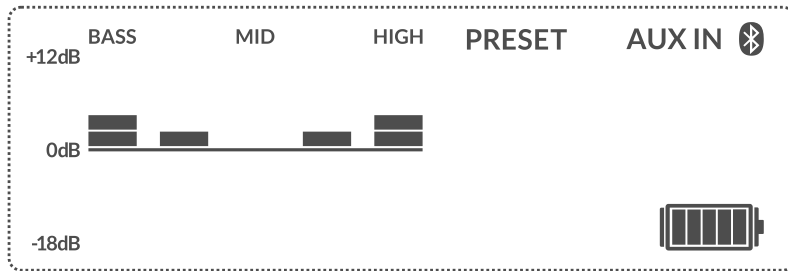

GETTING STARTED- PLACEMENT

The Exos-9 can go with you anywhere you want great sound, but if you're looking for a more permanent spot to place the speaker, there are a couple things to keep in mind. Speakers with deep bass extension like the Exos-9 are affected by how close they are to walls. Bass can be boosted if the back of the speaker is within a couple feet of the wall, but if it's too close to the wall (a couple inches) the bass may be too quiet. If you would like to improve bass response, try moving the speaker, or adjust the bass using the equalizer.

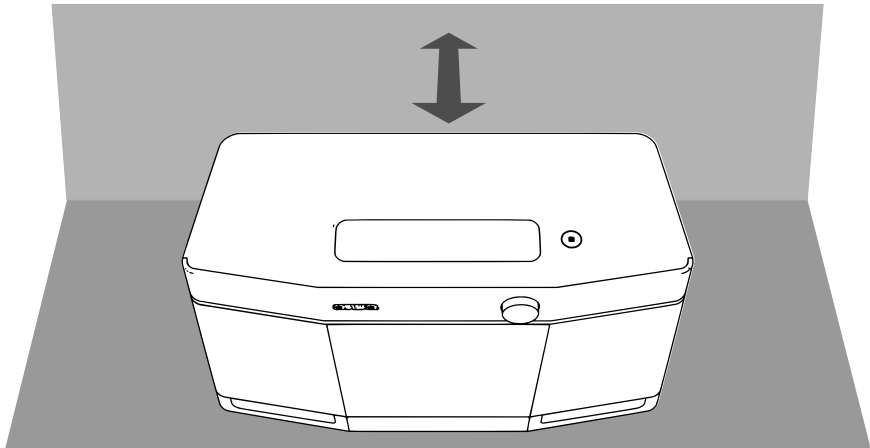

AUXILIARY INPUT

Almost anything headphones can plug into can play through the Exos-9. MP3 players, CD players, radios, computers, televisions, etc. can all be connected with the included 3.5mm audio cable.

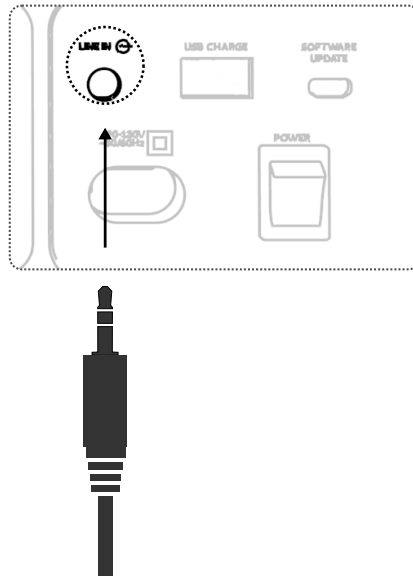

BATTERY LIFE

The Exos-9 battery lasts for approximately 10 hours playing at moderate volume. Battery life varies with volume - as with all speakers, battery life gets much shorter at very high volumes.

To get more play time at very high volumes, use the Battery Save Mode. It targets and reduces audio frequencies that use the most power, and can increase battery life by up to 100%.



The screen turns off after 15 seconds of inactivity in order to save battery life. Press any button to light it up again.

CHARGING / POWER

To charge the battery, connect the Exos-9 to AC power using the included power cord. The screen shows the charge level.

If you have a spare battery, you can charge it when the Exos-9 is plugged in. You can swap a depleted battery with a previously charged one.

After 15 minutes of inactivity, the speaker will enter sleep mode to save power. While in sleep mode, it will not connect via Bluetooth or play audio. Connect via NFC or press one of the touch buttons on top of the speaker to wake it from sleep mode.

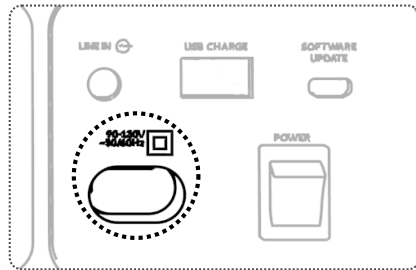

USB PORTS

There are two USB ports on the Exos-9. The port labeled "USB Charge" can be used to charge your mobile device.

The Exos-9 firmware can be updated using the micro-USB port labeled "Software Update". Check the Aiwa website (www.aiwa.us.com) for instructions, new firmware versions and to download the update utility.

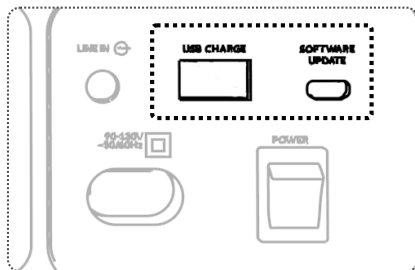

EQUALIZER

The Exos-9 has a 5-band graphic equalizer so you can adjust the sound for your personal taste or room acoustics.

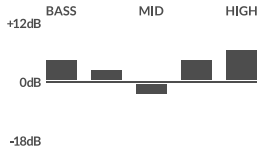

To adjust the equalizer, use the left and right arrows to select an EQ band. The currently selected band will blink. Press the up arrow to increase the gain on a given band, press the down arrow to decrease it.

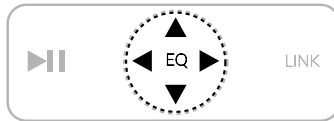

To select the EQ presets, Battery Save Mode, or to turn the EQ off, keep pressing the right arrow to make a selection.

PRESET

1 2 3 4

SAVE 

EQ OFF

The Exos-9 has 4 built-in EQ presets to enhance your music. Preset 1 is for Rock, 2 is for Hip-Hop and Dance, 3 is for Jazz and 4 is for Classical. Try them out and see what sounds best to you - these are only suggestions.

CONTROLS

Play/Pause

Controls playback of audio on your connected Bluetooth device. Does not affect playback through the auxillary-in connection.

Link

Two Exos-9 speakers can be wirelessly connected. Press LINK on both speakers within a few seconds to initiate the connection.

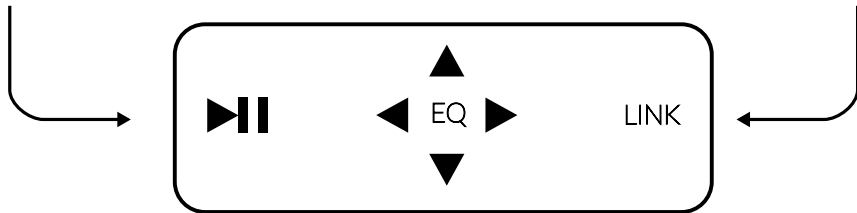

EQ Controls

Use the left/right arrows to select an EQ band or EQ preset. Use the up/down arrows to increase/decrease the gain when an EQ band is selected.

WIRELESSLY SYNC SPEAKERS

Simply press the LINK button on one Exos-9 and then press the LINK button on another Exos-9. As long as the two speakers are within about 20 feet of each other, you can listen to your favorite tunes in mirror or stereo mode.

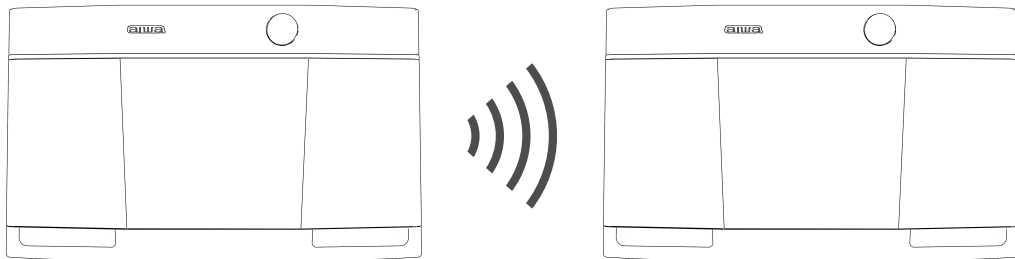

Once the two speakers are paired, press the LINK button to cycle through the channel modes. Choose from (L)(R), (L), or (R). Control the audio through the master speaker (the one without the SATELLITE icon lit up) by using the onboard controls or the music source.

CONTACT US

For more information about the limited warranty, frequently asked questions, or how to get the most out of your Exos-9, please visit www.aiwa.us.com.

Customer Service: 1-800-591-0179

info@aiwa.us.com

www.aiwa.us.com

www.facebook.com/aiwa.us

@Aiwa_US

Bluetooth® and the Bluetooth® logo are registered trademarks of Bluetooth SIG, Inc.

Changes or modifications not expressly approved by the party responsible for compliance could void the user's authority to operate the equipment.

This device complies with Part 15 of the FCC Rules.

Operation is subject to the following two conditions: (1) this device may not cause harmful interference, and (2) this device must accept any interference received, including interference that may cause undesired operation.

© 2015 Aiwa

SAFETY GUIDELINES



1. Read all instructions.
2. Do not use this apparatus near water.
3. Clean only with a dry cloth.
4. Do not use near any heat sources such as radiators, heat registers, stoves, or other apparatus that produce heat.
5. Unplug this device during lightning storms or when unused for long periods of time.
6. To completely disconnect the speaker from the AC mains, disconnect the power supply from the AC receptacle.

WARNING: To reduce the risk of fire or electrical shock, do not expose this device to rain or moisture.

WARNING: No naked flame sources - such as candles - should be placed on the product. Place the equipment near a main power supply outlet and make sure you can easily access the power breaker switch.

FCC Statement:

This equipment has been tested and found to comply with the limits for a Class B digital device, pursuant to part 15 of the FCC Rules. These limits are designed to provide reasonable protection against harmful interference in a residential installation. This equipment generates, uses and can radiate radio frequency energy and, if not installed and used in accordance with the instructions, may cause harmful interference to radio communications.

However, there is no guarantee that interference will not occur in a particular installation. If this equipment does cause harmful interference to radio or television reception, which can be determined by turning the equipment off and on, the user is encouraged to try to correct the interference by one or more of the following measures:

- Reorient or relocate the receiving antenna.
- Increase the separation between the equipment and receiver.
- Connect the equipment to an outlet on a circuit different from that to which the receiver is connected.

This device complies with part 15 of the FCC rules. Operation is subject to the following two conditions: (1) This device may not cause harmful interference, and (2) this device must accept any interference received, including interference that may cause undesired operation.

Note: Modifications to this product will void the user's authority to operate this equipment.