

# **User Manual**

**MN9015**

**Driving Video Recorder**

# 1. Appearance function interface description

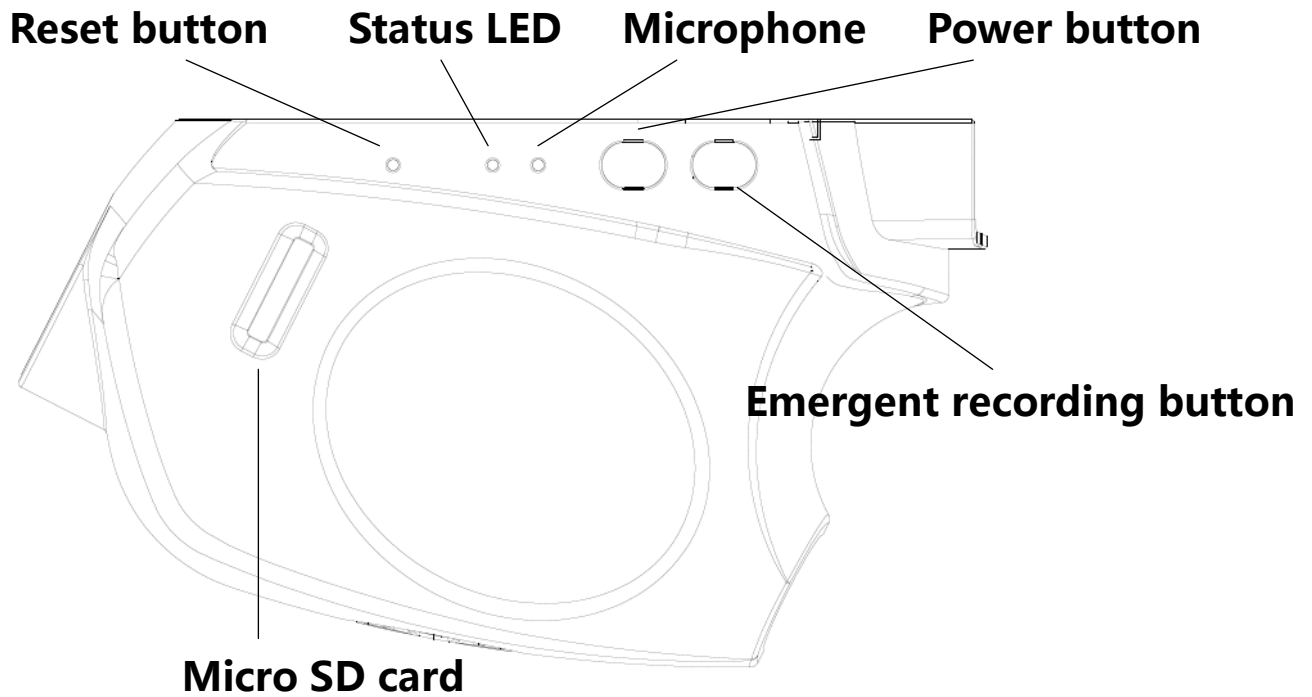

## 1.1 Interface description

### • Button Function Definition

System State		OFF	Recording	Emergent recording
Power button	<b>Short press</b> (Released in 1s)	Turn on system	Take a photo	—
	<b>Long press</b> (1~3 s release)	—	Turn off system	—
	<b>Longer press</b> (more than 4 s release)	—	Turn on/off Wi-Fi	—
Emergent recording button	<b>Short press</b> ( Released in 1s)	—	Emergent recording	Maintain
	<b>Long press</b> (more than 4 s release)	—	Returns to the initial SSID & PWD, and then reboot.	—
Reset button	<b>Short press</b> ( Released in 1s)		Reset system	

- **Microphone:** Use it for audio recording.
- **Status LED:** To indicate the status of the car recorder.
- **Reset button:** The system of the car recorder will be reboot by pressing this button.
- **Micro SD card:** Use it to store the recorded videos.

### 🚨 Warm reminder

- Press the “Emergency Recording button” to protect recording files case of unexpected emergencies.
- To avoid damage the SD card, please do not take out the card when the car recorder is working.
- The MLC/SLC SD card with the level over Class 6 and the memory capacity no less than 8G is recommended.

## 1.2 LED indicator status

System State	LED indicator
The process for turning on/off	Blue light flash
Recording	Blue light long lights
Manually Emergency Recording	Red and blue lights light alternately
Recording when collision	Red and blue lights light alternately
Turn off the system	Light lights off
Fault	Blue light long lights, &Red light flash

# 2. APP Application instructions

## 2.1 APP Operation

- ① APP can be downloaded by scanning the QR code on the box or downloaded from the following URL:  
Android : <http://t.cn/R4AUWjx>  
iOS : <http://t.cn/R4AU19G>
- ② If you are the first time to use it, please open settings for WLAN, then select “P\_ONE” network and enter the password “12345678”.
- ③ After succeed connecting, open “P\_ONE” and go on the operation based on interface instructions.



APP



Startup screen

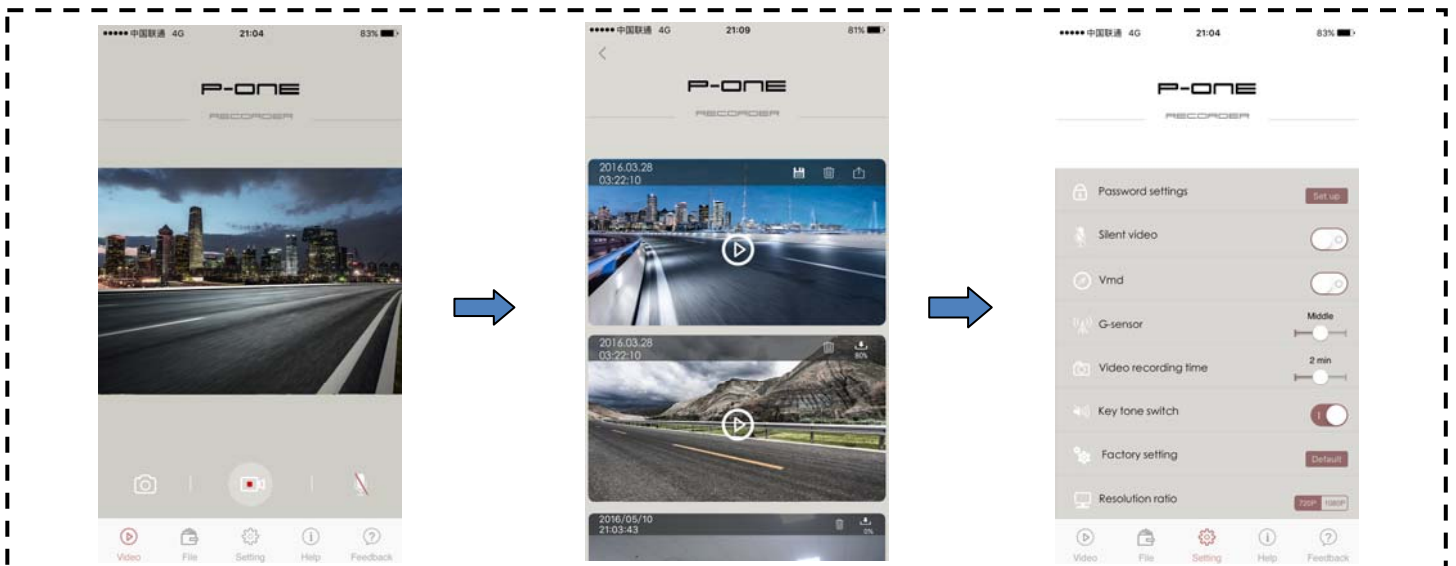

Main Page

Documents

Setup

## ⚠ Warm reminder

- if you are the first time to use it. Please connect the cell photo and open APP, so that car recorder automatically synchronize the phone time and date, to ensure the accuracy of the recording files.
- When it restart after battery reconnect, please set the right date and time according to the voice prompts.

## 2.2 Interface

### 2.2.1 Main page

- Displays current video images and time;
- Show the current video recording;
- Supporting taking photo;
- Supporting landscape.

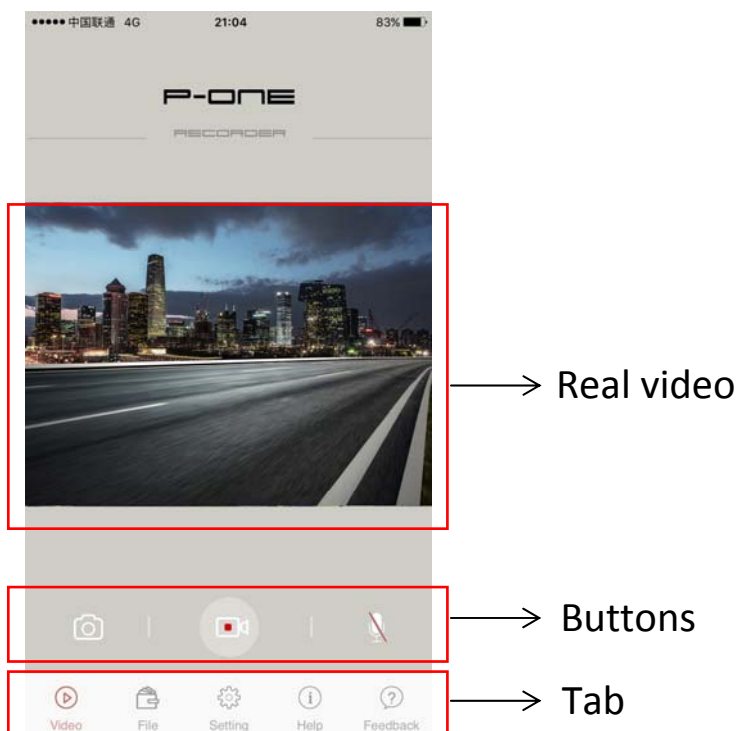

## 2.2.2 FILE

Download, replay, delete against the recorded videos and the photo, or share it.



### ⚠ Warm reminder

Downloaded time depends on the video time.

## 2.2.3 Setup

- **Password settings:** You can change the SSID network and the related password;  
Initial SSID: P\_ONE\_XXXXXX  
Initial password: 12345678;
- **Silent video:** Turn on / off recording sound. The default is mute;
- **Vmd:** Turn on / off motion detect function. The default is closed.

- **G-Sensor:** Choose the sensitivity level of acceleration of gravity sensor.
- **Video recording time:** Set time span for each video document;
- **Key tone switch:** Turn on / off key tone;
- **Factory setting:** Parameters factory Reset
- **Resolution :** 720P and 1080P selectable;
- **Storage card operation:** Format the memory card;
- **Firmware update:** Update the firmware;
- **Equipment Information:** Firmware and application version information can be found.

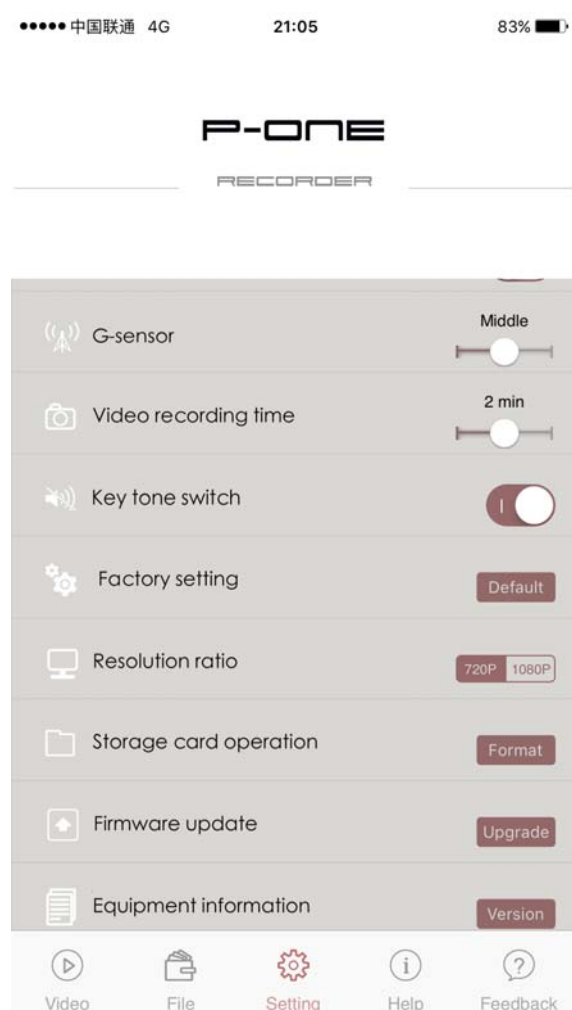
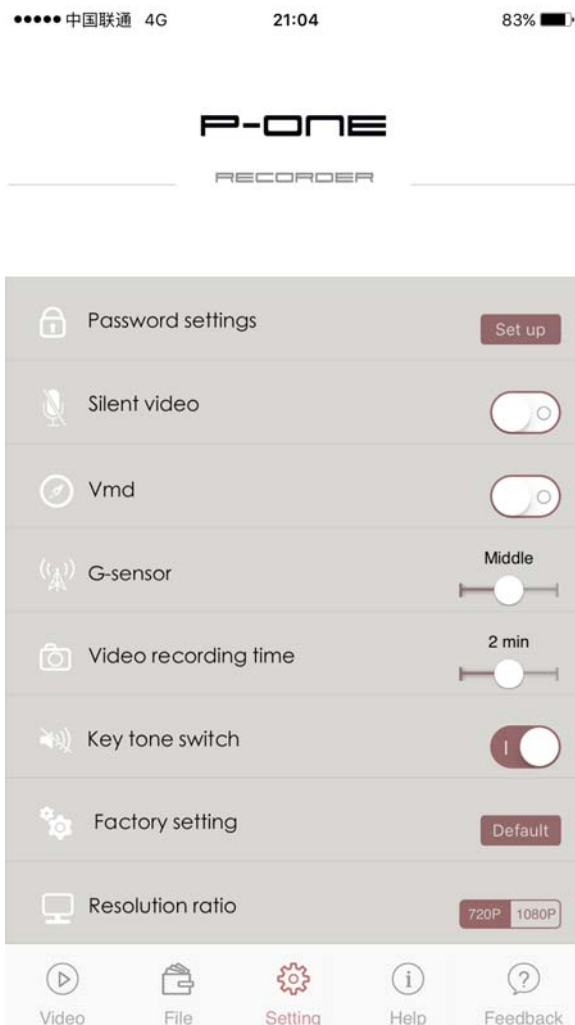

## **🚨 Warm reminder**

Take effect immediately after change the set parameters.

## **3. Function description**

### **3.1 Turn on and turn off**

The car recorder will start to recording videos when ACC is triggered, and continue to recording for 1 minute after ACC is off.

When ACC is powered, the car video recorder can be turned on and off by pressing power button.

When ACC is powered, Wi-Fi function can be turned on and off by pressing power button for 10 seconds.

### **3.2 Recording videos with mute**

The car recorder default with mute when recording videos, the audio can be opened by setting the cell phone APP.

### **3.3 Audio and Video Recording**

Activate audio recording function to recording videos with sound by using mobile APP to change settings.

### **3.4 Motion Detection Recording**

The device will start to recording when the image in front changes; in case of the image in front stay in



static over 15 seconds, the device will not recording videos until the image in front changes.

### **3.5 Collision Recording**

Recording when Collision refers to the car recorder will protect four files (i.e. the current one, the previous one and the next two) in case of activation of its G-SENSOR when it is working

### **3.6 Manually Emergency Recording**

The car recorder will record videos emergency, with protection of four files (i.e. the current one, the previous one and the next two), by pressing the “Emergency Recording button”.

### **3.7 Recording videos when found Vibration**

After the ACC has powered off, the main engine of the recorder will go to sleep mode, and the car recorder will automatically turn on to record and last for 6 minutes once it found the car is in violent vibration.

### **3.8 Under voltage protection**

After ACC has powered off, and once the voltage of the car battery is below 11V, the car recorder will no longer to execute the function of recording videos when found Vibration.

## 4. Fault Elimination

Fault	Reason or solution
Fail to turn on	Make sure the vehicle stays in “ACC ON” or “Power on”。
Crash	To press the “RESET” to restart。
Fail to record	No SD card inside, SD card failure or unrecognized SD card. YOU can replace the SD card or format it.
Fail to connect	Make mobile device (such as cell phone) close to the recorder, select SSID network and ensure to input password correctly.
Fail to live preview	To make sure the device connect the recorder in a right way, exit APP and re-open it on mobile device.
Lag	Make it close to the recorder, the less APPs running in your mobile device the better.
Setting save error	Check whether the connection is working properly.

## 5. FCC Statement

This device complies with part 15 of the FCC Rules.

Operation is subject to the following two conditions:

(1) This device may not cause harmful interference, and

(2) This device must accept any interference received, including interference that may cause undesired operation.

**Note:** This equipment has been tested and found to comply with the limits for a Class B digital device, pursuant to Part 15 of the FCC Rules. These limits are designed to provide reasonable protection against harmful interference in a residential installation. This equipment generates, uses and can radiate radio frequency energy and, if not installed and used in accordance with the instructions, may cause harmful interference to radio communications.

However, there is no guarantee that interference will not occur in a particular installation. If this equipment does cause harmful interference to radio or television reception, which can be determined by turning the equipment off and on, the user is encouraged to try to correct the interference by one or more of the following measures:

- Reorient or relocate the receiving antenna.

- Increase the separation between the equipment and receiver.

- Connect the equipment into an outlet on a circuit different from that to which the receiver is connected.

- Consult the dealer or an experienced radio/TV technician for help.

**Warning:** Changes or modifications to this unit not expressly approved by the part responsible for compliance could void the use's authority to operate the equipment.

### **FCC Radiation Exposure Statement**

This equipment complied with FCC radiation exposure limits set forth for an uncontrolled environment. This equipment should be installed and operated with minimum distance 20cm between the radiator and your body.