



Smart LED Bulb 360 Camera

Quick Manual for Android and iOS

Precautions

- Please confirm whether the voltage meets the requirements before using the product, or improper voltage will damage the device and bring security risk.
- Please install the device correctly and make sure whether to disconnect the power supply at the time of installation.
- The device will generate heat in the work, please avoid using in confined spaces.
- In order to prevent burns, do not touch the device after prolonged use.
- Please use the camera function legally.

Specifications

- Mount: E27
- Working Voltage: AC 100 ~ 240V 50~60Hz
- Power Consumption: 3W
- Life Expectancy: 20,000 hours
- Image Sensor: 3MP high performance CMOS

Product Introduction

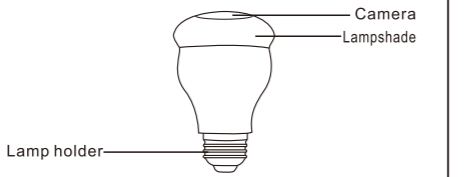

Notes: Screw the bulb into the lamp and ensure power. Turn on and off the bulb at intervals of 2 seconds. After 5 cycles, it will restore into default factory setting.

Operation

1. Download APP

Tips one :Scan QR code



Tips two :Search "iCSee" in the App store or Googleplay and download .

2.Installation

Screw the bulb into the lamps and turn on the power switch.

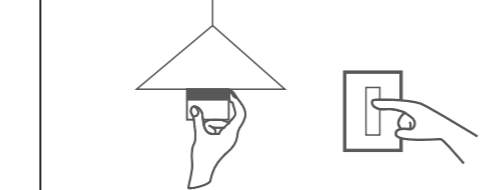

Notes: After the bulb is powered, the LED white light starts flashing at the interval of 1 second, it enters into network configuration (LED white light will always flash until finishing network configuration).

Please follow the operation of the "network configuration" on the right:

3.Network Configuration

★User login

01.Open the app"iCSee", click"login"

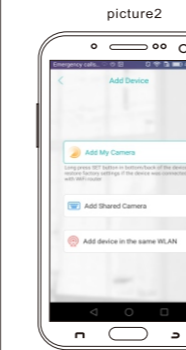
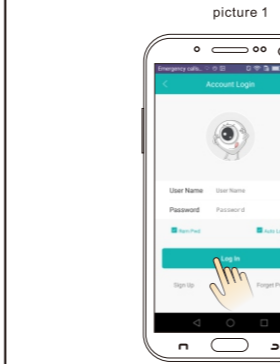

Notes:
1.Fast configuration: Connect the Raindrop camera to the router. It is for the first time to use and restore the default factory settings.
2.Add serial numbers: Add other people's Raindrop camera by entering the serial number, sharing information code or scanning the device's QR code.
3.Search local area network: You can use this method to add Raindrop camera when the camera and your phone are connected to the same router.

02.After login, click "add my camera" (picture 2) and enter "WiFi password"(picture 3). Complete the device's network configuration according to the operation tips of APP.

03. After the configuration of Smart Panoramic Bulb Camera is done successfully, you can view the video in real time, operate various personalized settings and view image information.

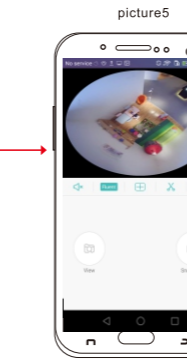
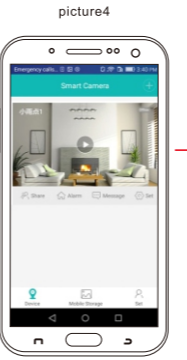

❗If the configuration fails, please restore the product into default factory setting and repeat the above steps until the configuration is done successfully.

04.Smart VR
360 Panorama VR ,support zoom

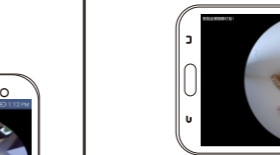

Easy to operation



★Temporary login

The usage of visitor mode: The user does not need to create a user registration if using temporarily.Visitor mode can add and access device, but only part of the information is kept on the phone.If you replace the phone or reinstall APP, you need to add the device again. This mode does not support the alarm push function and so on. **Please refer to the following introductions to operate:**

- Open"iCSee" App, choose temporary visit.

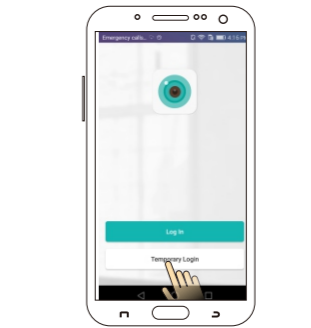

- Click the "+" symbol in the upper right corner, follow the prompts, and finish adding the camera
- Please refer to "User login" network operation in picture 3 and 4.

Directions

APP and Smart Panoramic Bulb Camera firmware will be updated from time to time, you could update it at APP online, instructions are for reference only.

Warranty Card

Product Name		Model	
Purchase Date		Purchase Store	
Cause			
Process			
Customer Name		Customer Gender	
Customer Phone		ZIP	
Address			

Warranty period: one year.
This warranty card is only our company's products.

FCC Statement

This equipment has been tested and found to comply with the limits for a Class B digital device, pursuant to part 15 of the FCC rules. These limits are designed to provide reasonable protection against harmful interference in a residential installation. This equipment generates, uses and can radiate radio frequency energy and, if not installed and used in accordance with the instructions, may cause harmful interference to radio communications. However, there is no guarantee that interference will not occur in a particular installation. If this equipment does cause harmful interference to radio or television reception, which can be determined by turning the equipment off and on, the user is encouraged to try to correct the interference by one or more of the following measures:

- Reorient or relocate the receiving antenna.
- Increase the separation between the equipment and receiver.
- Connect the equipment into an outlet on a circuit different from that to which the receiver is connected.
- Consult the dealer or an experienced radio/TV technician for help.

To assure continued compliance, any changes or modifications not expressly approved by the party.

Responsible for compliance could void the user's authority to operate this equipment. (Example- use only shielded interface cables when connecting to computer or peripheral devices).

This equipment complies with Part 15 of the FCC Rules. Operation is subject to the following two conditions:

- (1) This device may not cause harmful interference, and
- (2) This device must accept any interference received, including interference that may cause undesired operation.

FCC Radiation Exposure Statement:

The equipment complies with FCC Radiation exposure limits set forth for uncontrolled environment. This equipment should be installed and operated with minimum distance 20cm between the radiator and your body.