

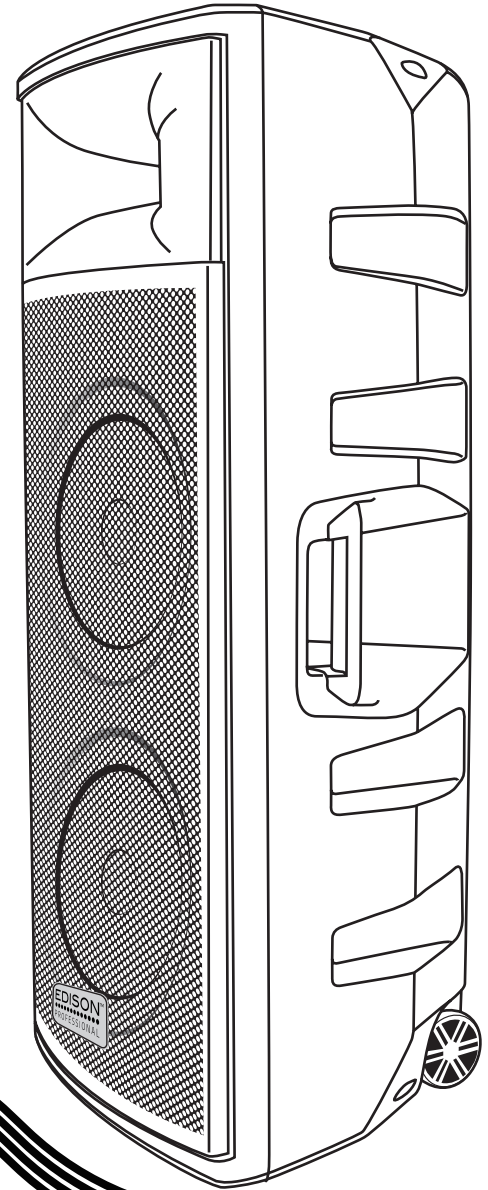

EDISON™



M-6500 MKII Speaker **OWNER'S MANUAL**

M-6500MKII Rear Panel

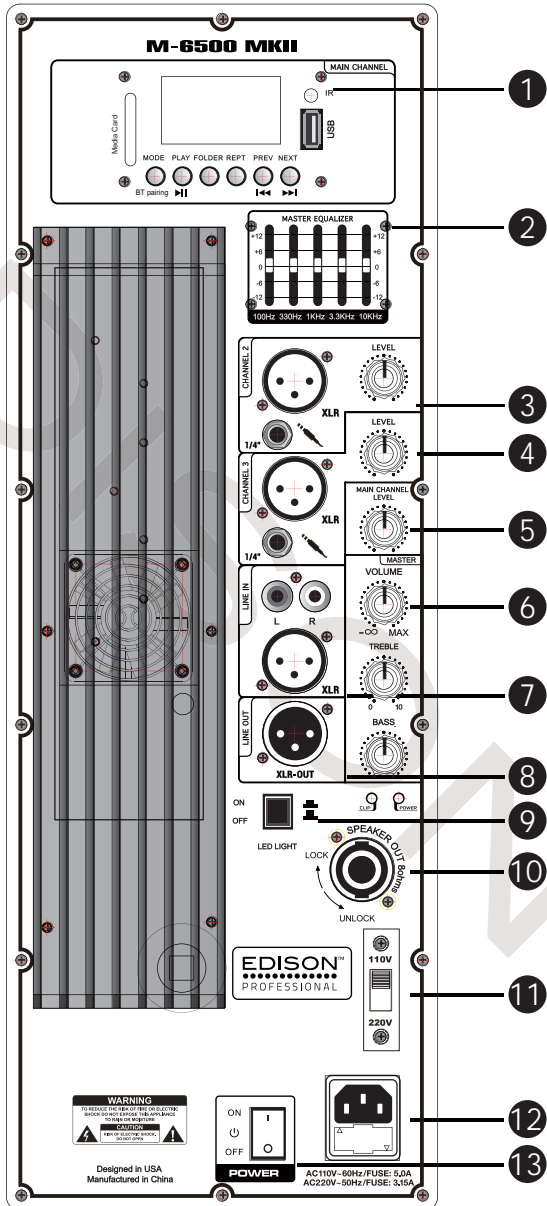

BriteLite™



Important: Please read this before returning this product

Please do not return the product to the dealer or initial place of purchase.
If you are having difficulties installing or using this product, our support organization can help you regarding installation, set up and missing or replacement parts.

You can contact us:

E-mail- Service@britelite.net

Phone- 1-888-604-8881 or 310-363-7110

In Mexico Please Call 0155 4624 0251

QUICKSTART GUIDE

QUICK SETUP GUIDE

Important: With all large speakers, an initial "break-in" period is needed to perform at optimal levels. To properly "break-in" your Transactive Mobile, play an audio source at medium volume for a few hours.

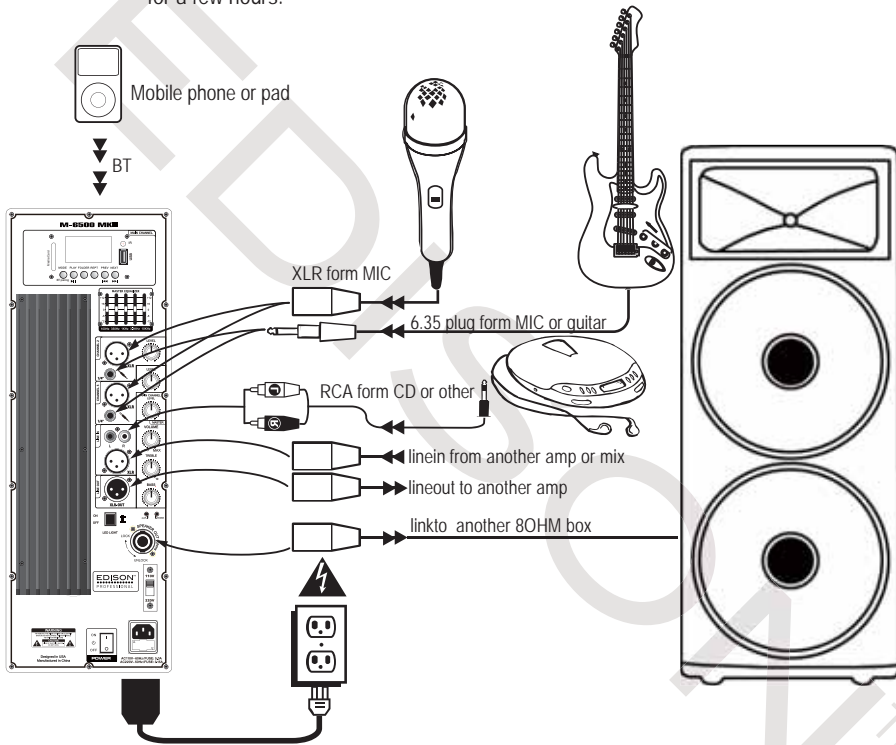

Technical specification:

1. AUX input:-10dB;
2. MIC input:-40dB;
3. EQ : ± 12 dB, 100Hz , 330Hz , 1KHz , 3.3KHz , 10KHz;
4. Distortion : 1KHz \leq 0.5%;
5. Noise : -40dB;
6. S/N : 80dB;
7. Power:6500W
8. Voltage : 110V/60Hz~220V/50Hz

Line Out Balanced Connection

The XLR Line out allows you to output the amplifier signal to subwoofer, another powered speaker, or an amp, which will, in turn, power other speakers. Simply connect the output device to the RPG225K using an XLR to XLR or XLR to 1/4 TRS cable to share the signal. We recommend you use high quality cables

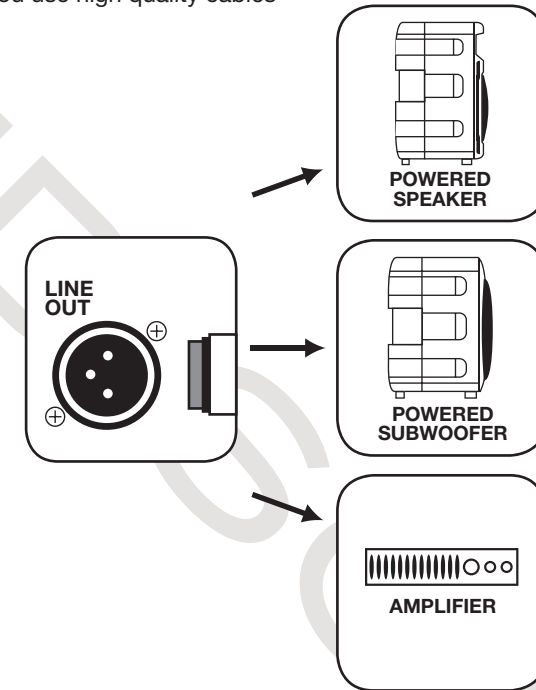

Speaker Output Connection

The Speaker output marked Speaker Out is used to connect the active unit to the passive unit. Passive speaker impedance must always be 8 ohms.

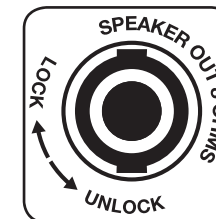

Limited Warranty

This Limited Product Warranty is provided by BriteLite Enterprises. BriteLite warrants to Customer that the product is free from defects in materials and workmanship under normal use during the Warranty Period of 90 days for parts and 1-year labor. If the product fails to conform to the warranty then BriteLite or its authorized service will either repair or replace any nonconforming product, provided that Customer gives notice of noncompliance within the Warranty Period to BriteLite by emailing service@britelite.net or calling 310-363-7110 (Mexico customers can call 0155 46240251). Please retain the original dated receipt as evidence of proof of purchase



1. Main Channel Controls

The main channel can play music from an Auxiliary source, Bluetooth, USB/SD Card, or FM Radio.

- **MODE:** Switches between the input modes mentioned above.
- **PLAY:** Press this button to play or pause music playing from Bluetooth, USB, or SD.
- **FOLDER:** Use this button to pick an Equalizer preset or choose a song to play from your USB/SD card. Use the Prev/Next buttons to switch through menu items and press the play button to select a menu item.
- **REPT:** Turn the repeat function on and off for music playing through USB or SD
- **PREV/NEXT:** Use these buttons to switch through songs playing on Bluetooth or USB/SD or channels in FM Radio mode

2. 5-band graphic equalizer

Control the sound output coming of all channels.

3. Channel 2

All three channels can be used at the same time. Both inputs on this channel can be used at the same time

- **LEVEL:** Controls the volume of Channel 2
- **XLR Input:** Connect an audio source using an XLR cable on Channel 2.
- **1/4" Input:** Connect an audio source using a 1/4" audio cable on Channel 2.

4. Channel 3

All functions operate the same as Channel 2

5. Main Channel volume

Control the volume of the music coming from the main channel(BT/AUX/USB/SD/FM)

6. Master Volume Controls

Control the Volume, Bass, and Treble of the sound coming from all three channels

7. Auxiliary/Line Input

Play music from an auxiliary device when the main channel is in aUX mode. Both inputs can be used at the same time.

- **LR Input:** Play music from an audio source using an RCA cable
- **XLR:** Play music from an audio source using an XLR cable

8. Line Out

The XLR Line Out sends a signal to a subwoofer, another powered speaker, or to an amp.

9. LED Light Switch

Use this switch to turn the Sound Activated Multicolor LED lights on and off.

10. Speakon output to passive speaker (8 ohm)

Use this jack to connect a passive speaker using an NL4 "twist lock" audio cable. Note that the signal from this output is amplified.

11. Voltage selector switch

Switches the input voltage. Make sure to be use the correct voltage corresponding to the voltage coming from your wall outlet.

12. Power input

Connect one end of the included power cable to this input and the other end to a wall outlet. Make sure the voltage switch is in the correct position before turning on the unit.

13. Power switch

Use this switch to turn the unit on and off.

FCC Statement

Changes or modifications not expressly approved by the party responsible for compliance could void the user's authority to operate the equipment. This equipment has been tested and found to comply with the limits for a Class B digital device, pursuant to Part 15 of the FCC

Rules. These limits are designed to provide reasonable protection against harmful interference in a residential installation. This equipment generates uses and can radiate radio frequency energy and, if not installed and used in accordance with the instructions, may cause harmful interference to radio communications. However, there is no guarantee that interference will not occur in a particular installation.

If this equipment does cause harmful interference to radio or television reception, which can be determined by turning the equipment off and on, the user is encouraged to try to correct the interference by one or more of the following measures:

- Reorient or relocate the receiving antenna.
- Increase the separation between the equipment and receiver.
- Connect the equipment into an outlet on a circuit different from that to which the receiver is connected.
- Consult the dealer or an experienced radio/TV technician for help

This device complies with part 15 of the FCC rules. Operation is subject to the following two conditions (1) this device may not cause harmful interference, and (2) this device must accept any interference received, including interference that may cause undesired operation.

This equipment complies with FCC radiation exposure limits set forth for an uncontrolled environment. This equipment should be installed and operated with minimum distance 20cm between the radiator & your body