

OUTDOOR SECURITY LIGHT

Model Number: DH7061



Questions, problems, missing parts?

Before returning to your retailer, call our customer service at 1-800-887-6326
Monday – Friday 9:00 a.m. – 5:00 p.m. CST

PACKAGE CONTENTS

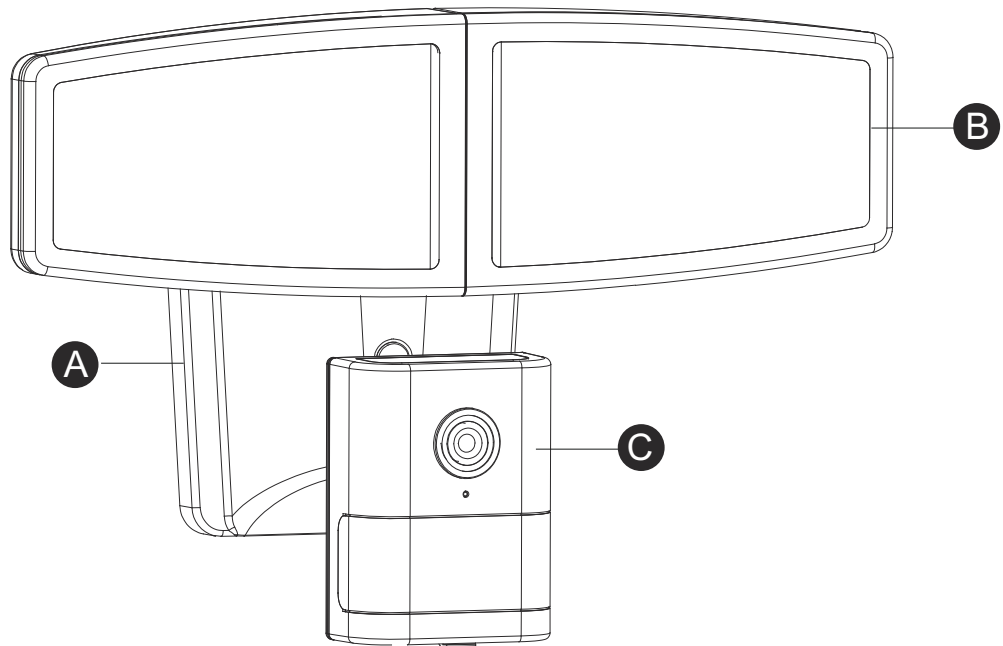

HARDWARE CONTENTS Note: Hardware not shown actual size.

AA

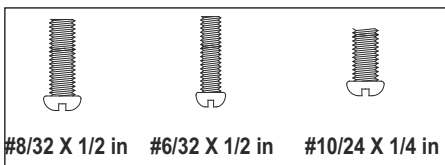

#8/32 X 1/2 in #6/32 X 1/2 in #10/24 X 1/4 in

Mounting Screw
X2

CC

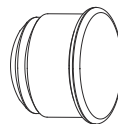

Decorative cover
X1

EE

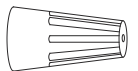

Wire Nut
X2

BB

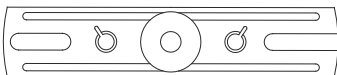

Mounting Strap
X1

DD

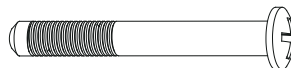

Fixture Mounting Screw
X1

⚠ SAFETY INFORMATION

Please read and understand this entire manual before attempting to assemble, operate or install the product.

WARNING

- Turn off electricity at main fuse box (or circuit breaker box) before beginning installation by removing fuse (or switching off circuit breaker).
- Be careful not to damage or cut the wire insulation (covering) during fixture installation. Do not permit wires to contact any surface having a sharp edge. To do so may damage or cut the wire insulation, which could cause serious injury or death from electric shock.
- LED electronics can be damaged by electro static discharge (ESD) shock. Before installation, discharge yourself by touching a grounded bare metal surface to remove this hazard. To avoid damage, do not touch the LED module.

CAUTION

- All electrical connections must be in agreement with local codes, ordinances or the national electric code (NEC). Contact your municipal building department to learn about your local codes, permits and/or inspections.
- Risk of fire – most dwellings built before 1985 have supply wire rated for 140°F/60°C. Consult a qualified electrician before installation.
- Only general ON/OFF wall switch applies for this fixture, the dimmable wall switch shouldn't be required.

Maximum Wattage: 36 W

Working Temperature Range: -4°F ~ 113°F

PREPARATION

Before beginning assembly, installation or operation of product, make sure all parts are present. Compare parts with package contents list and diagram on previous page. If any part is missing or damaged, do not attempt to assemble, install or operate the product. Contact customer service for replacement parts.

Tools Required for Assembly (not included): Screwdriver, Phillips Screwdriver, Pliers, Electrical Tape, Wire Cutters, Safety Glasses, Ladder, Wire Stripper.

ASSEMBLY INSTRUCTIONS

Important to Know

1. This fixture requires a 120 VAC, 60 Hz power source.
2. For general safety and to avoid any possible damage to the sensor, be sure the power is switched "off" before adjustment.
3. Motion sensor: turns light ON automatically when motion is detected and turns light OFF automatically when motion stops.
4. Photocell keeps the light OFF during daylight hours.

Note: Fixture can be wall mounted or eave mounted.



Light fixture and sensor should be mounted as shown above when installed (depending upon type of installation)

Before installing the light fixture under an eave, the sensor head must be rotated as shown in the next two steps for proper operation and to avoid the risk of electrical shock.

ASSEMBLY INSTRUCTIONS (continued)

For eave mounted only:

- Rotate the sensor head clockwise 180° horizontally, and then tilt angle properly.

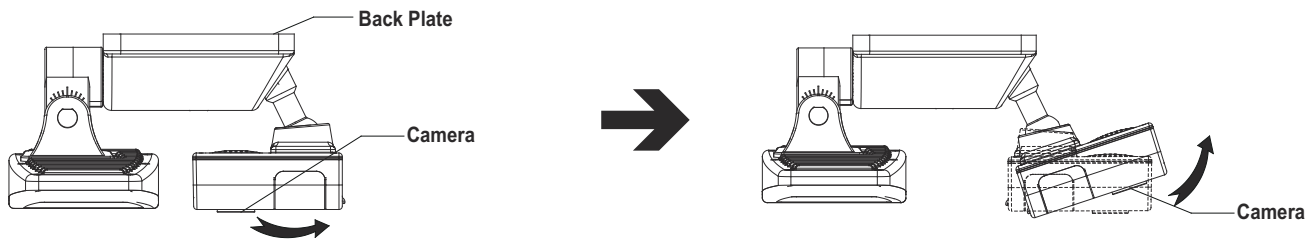

Installation Steps

Turn off the power at fuse or circuit box.

1. Install the mounting strap(BB) to the outlet box with the stamped word "FRONT" facing away from the outlet box, using two mounting screws(AA) that best fit the outlet box. (Choose one matching pair of suitable mounting screws from the 3 pairs provided)

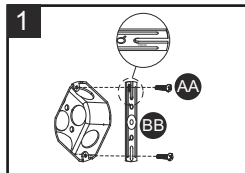

3. Attach the back plate of the light fixture(A) to the mounting strap(BB), and then secure it with the fixture mounting screw(DD). Push the decorative cover(CC) firmly into the fixture mounting screw(DD) hole on the light fixture(A).

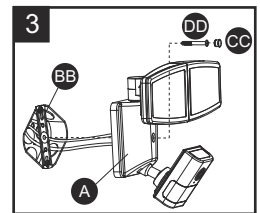

2. Connect the fixture black wire to the house black wire and the fixture white wire to the house white wire using wire nuts(EE) provided. Carefully tuck the wires back into the outlet box.

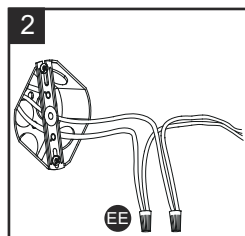

4. With silicone caulking compound (not included), caulk completely around where the back plate of the light fixture(A) meets the wall surface.

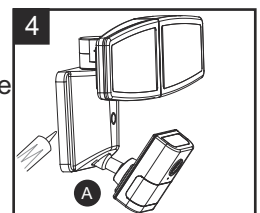

CAUTION: Be sure to caulk completely where the back plate meets the wall surface to prevent water from seeping into the outlet box.

Turn on the power at fuse or circuit box.

Adjusting the Sensor Head:

1. a: Aim sensor head(C) toward desired detection area, maintaining a 5° - 40° downward angle to allow moisture to drain. (See Fig.1)
Note: Make sure sensor head is positioned with camera facing towards the ground.
 b: You can rotate the sensor head up and down to change the coverage area . Walk through the detection zone at the farthest distance you wish to detect motion.

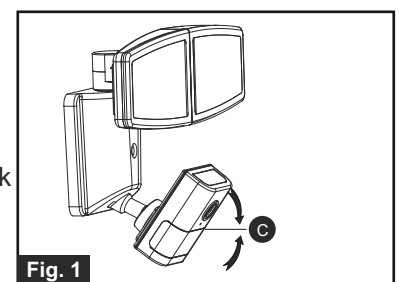

2. Range set too high may increase false triggering. (See Fig.2, Fig.3)

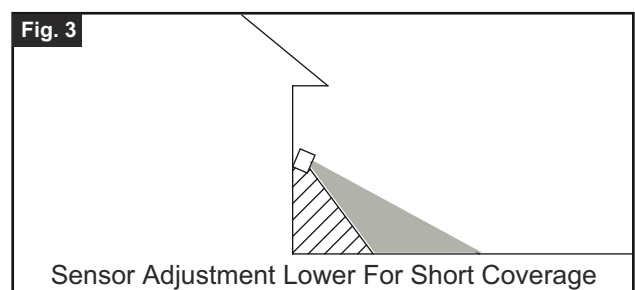
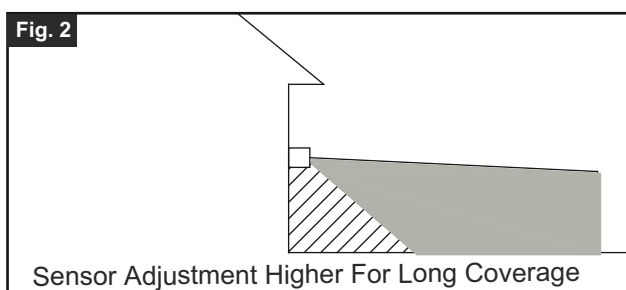

Adjusting the Light Head:

1. Gently grasp the light heads(B) and tilt them up or down, left or right to adjust the light coverage area. Keep the light heads at least 1" (25mm) away from the sensor. (See Fig.4)
2. Keep the light heads 30° below horizontal to avoid water damage and electrical shock.

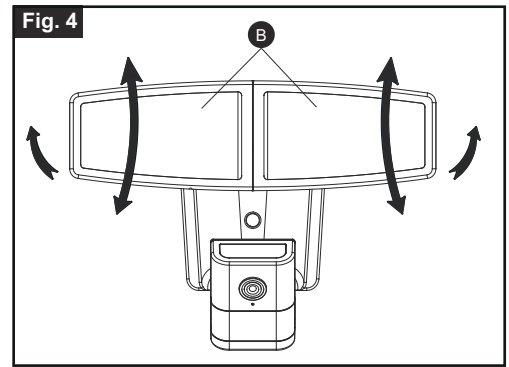

Notes:

1. The sensitivity of the motion sensor will increase as the environmental temperature gets cooler. You may wish to make adjustments when the season changes. For best performance, gently clean the lens with a soft cloth every 1 or 2 months to assure maximum sensitivity.
2. For best performance, install fixture at least 8 feet above the ground. At such a height, the fixture will provide a detection distance of up to 70 feet at 77 degrees Fahrenheit. (See Fig.5)
3. The sensor detects movement across a detection range of 240 degrees. (See Fig.6)
4. The sensor will be more sensitive to motion across its detection path than motion directly towards it. (See Fig.7)
5. To reduce possible nuisances, do not mount the fixture near a heat source like an air conditioner, vent or furnace exhaust, or in a direction facing any reflecting object or other light source.

Where you install your fixture is important:

Be sure the light is mounted straight on the wall or eave; otherwise, the detection distance may be limited.

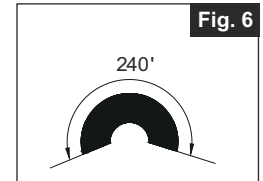
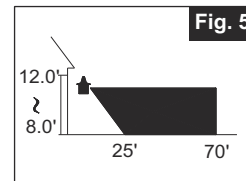
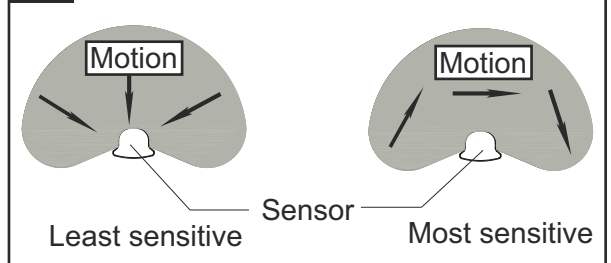
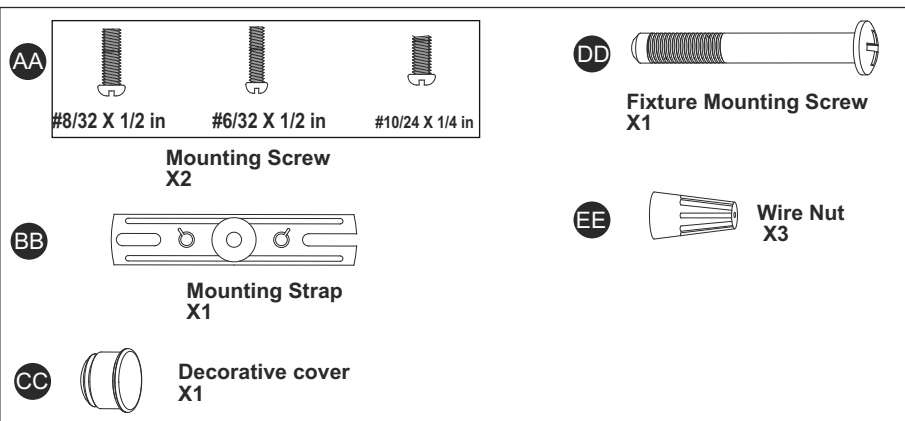

Fig. 7



The following parts are available for re-order if damaged or missing. Call us toll-free at 1-800-887-6326

Spare Parts List:



→ Assembly Kit 5731MM (1 SET)

CARE AND MAINTENANCE

- To prolong the original appearance, clean the light fixture with clear water and a soft, damp cloth only.
- Do not use paints, solvents, or other chemicals on this light fixture. They could cause a premature deterioration of the finish. This is not a defect in the finish and will not be covered by the warranty.

TROUBLESHOOTING

1) The light does not come on at all:

- a. Make sure the wall switch and circuit breaker are on.
- b. Make sure the wiring is correct.
- c. Cover the sensor with dark color cloth to verify that the ambient light level is not too high.

2) The light comes on for no apparent reason:

- a. Re-aim the motion sensor.
- b. Decrease the sensitivity setting.
- c. Do not use a dimmer or timer to control the light fixture. Replace the dimmer or timer with a standard on/off wall switch.

3) The light flashes on and off:

- a. Reposition the motion sensor.

If unable to fix any of the above issues, please consult a certified electrician.

FIVE-YEAR LIMITED WARRANTY: If, during normal use, this PATRIOT LIGHTING® lighting fixture breaks or fails due to a defect in material workmanship within five (5) years from the date of original purchase, simply bring this lighting fixture with the original sales receipt back to your nearest MENARDS® retail store. At its discretion, PATRIOT LIGHTING® agrees to have the product or any defective part(s) repaired or replaced with the same or similar PATRIOT LIGHTING® product or part free of charge, within the stated warranty period, when returned by the original purchaser with original sales receipt. This warranty; (1) excludes expendable parts including but not limited to light bulbs; (2) does not cover damage that has resulted from abuse or misuse; and (3) does not cover any losses, labor, injuries to persons/property or costs. This warranty does give you specific legal rights and you may have other rights, which vary from state to state.

FCC Statement

NOTE: This equipment has been tested and found to comply with the limits for a Class B digital device, pursuant to part 15 of the FCC Rules. These limits are designed to provide reasonable protection against harmful interference in a residential installation. This equipment generates uses and can radiate radio frequency energy and, if not installed and used in accordance with the instructions, may cause harmful interference to radio communications. However, there is no guarantee that interference will not occur in a particular installation. If this equipment does cause harmful interference to radio or television reception, which can be determined by turning the equipment off and on, the user is encouraged to try to correct the interference by one or more of the following measures:

- Reorient or relocate the receiving antenna.
- Increase the separation between the equipment and receiver.
- Connect the equipment into an outlet on a circuit different from that to which the receiver is connected.
- Consult the dealer or an experienced radio/TV technician for help.

Changes or modifications not expressly approved by the party responsible for compliance could void the user's authority to operate the equipment. This device complies with Part 15 of the FCC Rules. Operation is subject to the following two conditions:

- (1) this device may not cause harmful interference, and
- (2) this device must accept any interference received, including interference that may cause undesired operation.



Questions, problems, missing parts?

Before returning to your retailer, call our customer service at 1-800-887-6326
Monday – Friday 9:00 a.m. – 5:00 p.m. CST

The Appearance Introduction of Product:

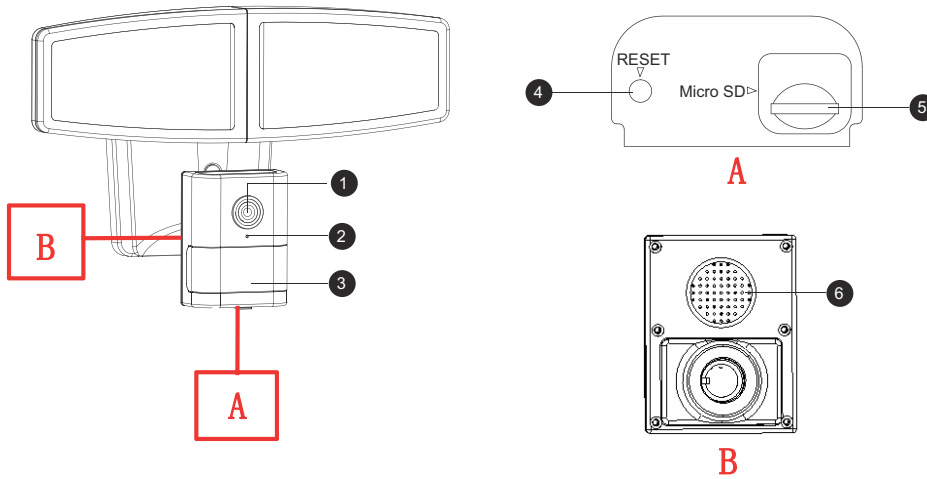

- 1. Camera
- 2. LED Indicator
- 3. Sensor and Photocell
- 4. Reset
- 5. SD Card Slot
- 6. Build-In Speaker

USER GUIDE

Setting for light through mobile device.

Before you start

Search "instaHome" on IOS APP store  or Android Google Play , install the instaHome APP  onto the mobile device and click it.

1. Select "+".

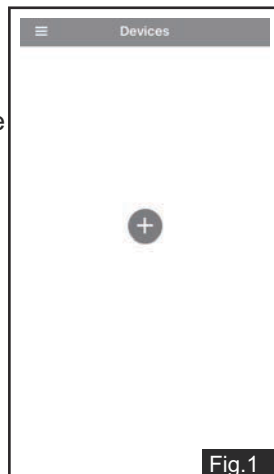

Fig.1

2. Select "Add Device".

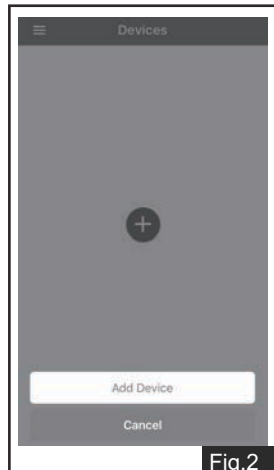

Fig.2

3. Select "Add LAN Device".

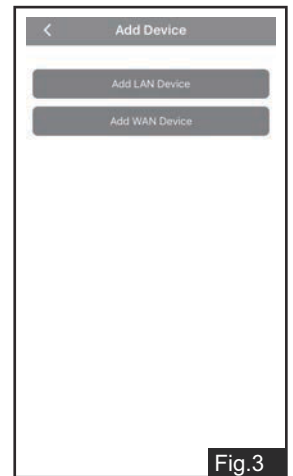



Fig.3

4. Select "Wi-Fi Settings".



Fig.4

5. Select “ Wi-Fi”.

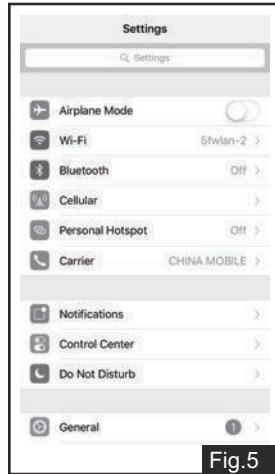

Fig.5

6. Select specified light device’s hot spot started with “wuucam-”.



Fig.6

7. Input password, the default password is:12345678, it can not be changed. Then click “Join”.



Fig.7

8. Select “OK” to change the light device password and skip to Fig.9.
Select “Cancel”, the default password is 888888, and then skip to Fig.10.



Fig.8

9. Set new light device password and confirm it, and then click “OK”, skip to Fig.11.

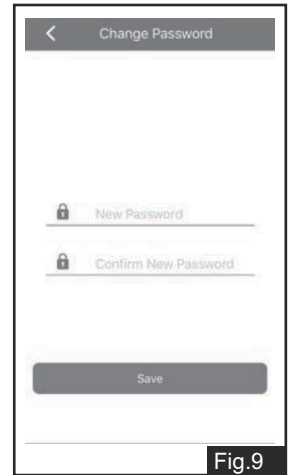

Fig.9

10. Select “Added Successfully”, skip to Fig.11.

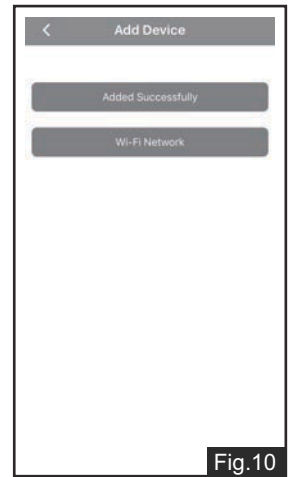

Fig.10

11. Select “”.



Fig.11

12. Select “” in pop-up box.



Fig.12

USER GUIDE (Continued)

13. Select "Wi-Fi Network".

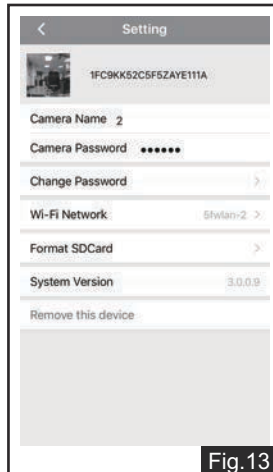

Fig.13

14. Choose an existing WiFi Network.



Fig.14

15. Input password, it is the indoor existing WiFi password, press "👁" that can show the password, and then click "OK", wait the prompt tone that the light device has connected WiFi successfully.

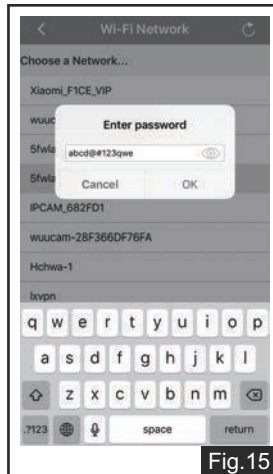

Fig.15

16. Select "Dualux" icon.



Fig.16

17. Select top right "Select".



Fig.17

18. If want to remove this light device, check the light device on the right, and then select "🗑" to remove this light device.



Fig.18

19. Select "⚙", then select "☰" in pop-up box, skip to Fig.20. Select "📷" to access user phone picture. Select "⚙", skip to Fig.21.



Fig.19

20. It is showed event video lists which are saved in light device SD.

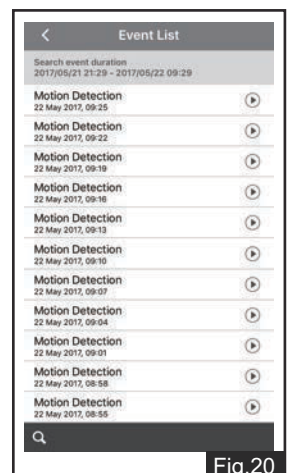

Fig.20

USER GUIDE (Continued)

21. Select "Camera Name" to change light device name.

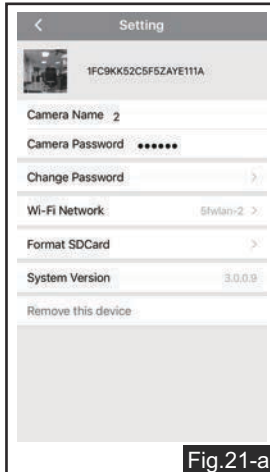

Fig.21-a

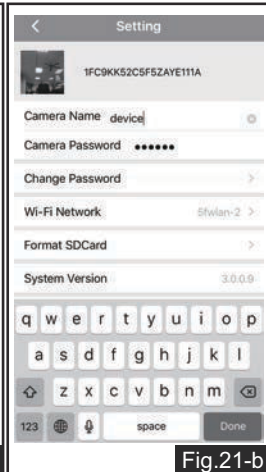

Fig.21-b

22. Select "Camera Password", set new password and confirm it.

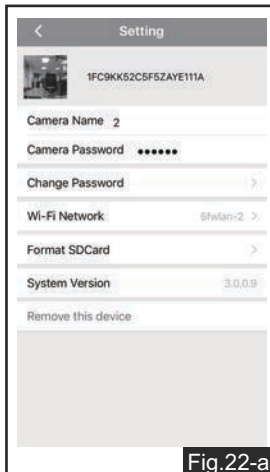

Fig.22-a



Fig.22-b

23. Select "Remove this device", then select "Format SD Card".

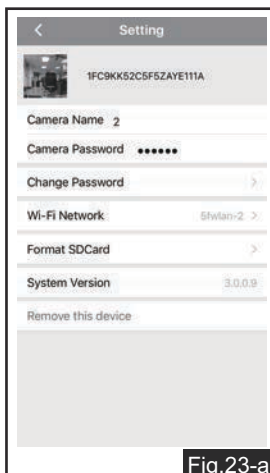

Fig.23-a



Fig.23-b

24. Select "Continue".



Fig.24

25. If want to remove videos saved in SD card, select "OK", or select "Cancel".

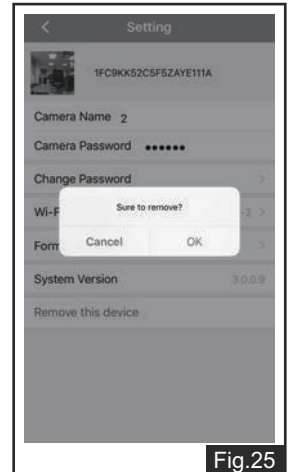

Fig.25

26. Select Fig.17 ">", when the PIR is triggered, it is alarmed by phone message, if do not want to receive these messages, turn off the notice in phone setting. Select "📞" for intercom, press "🗣️" to talk, and release it can monitor video voice.

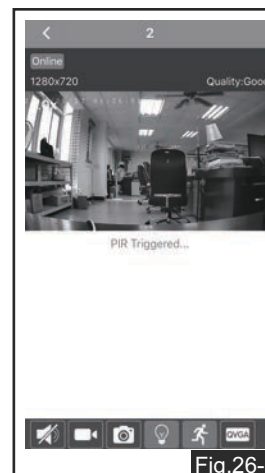

Fig.26-a

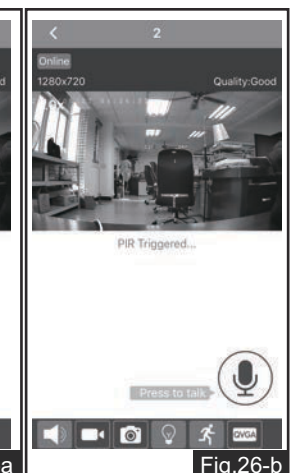

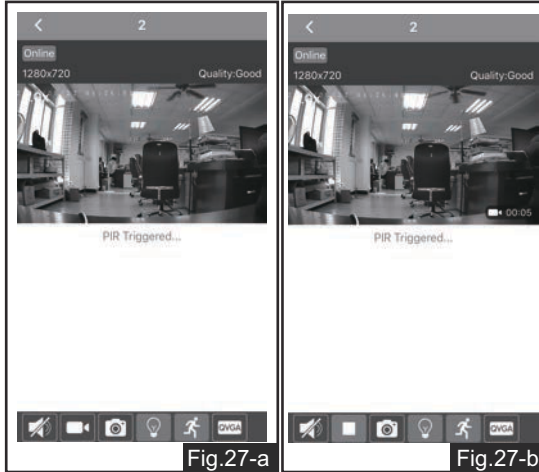



Fig.26-b

USER GUIDE (Continued)

27. Select “” for recording videos which are saved in phone picture.



28. Select “” for taking photo, the photos are saved in phone picture.

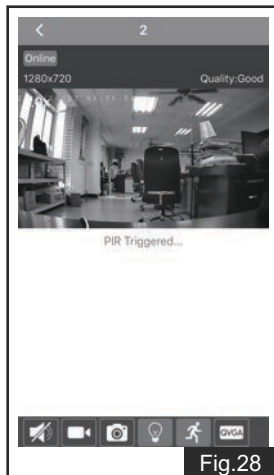

29. Select “”.

Select “ON”, the light device is turned on.
 Select “OFF”, the light device is turned off.
 Select “Brightness”, that can set the light device’s high level brightness and low level brightness.

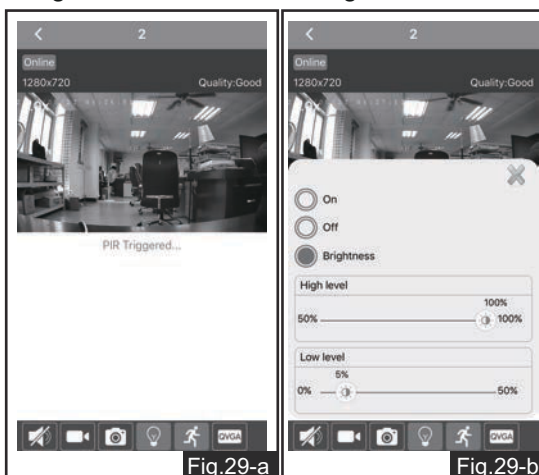

30. Select “”.

“Test” mode, on daytime and nighttime, the light turns on and records video automatically when motion is detected, and stays on as long as motion continues. About 5 seconds after motion is no longer detected, it turns off automatically and stops recording. The time of recording video is 1minute 5 second at least each time. The detection distance is 5 feet to 70 feet.

“Off” mode, the light device is turned off, and can not be recorded video.

“ON” mode, at dusk, the light will turn to low level brightness (0~50% brightness). The light will turn to high level brightness (50%~100% brightness) when motion is detected, and stay on as long as the motion is continuing. When the motion stops, the light will remain on for the predetermined time as you set (5s ~ 3min), and then revert to low level brightness (0~50% brightness). The light will turn off automatically at dawn.

On daytime and nighttime, the light records video automatically when motion is detected, and stays on as long as motion continues. When the motion stops, the light stops recording.

The time of recording video is 1minute 5 seconds at least each time.

The detection distance is 5 feet to 70 feet.

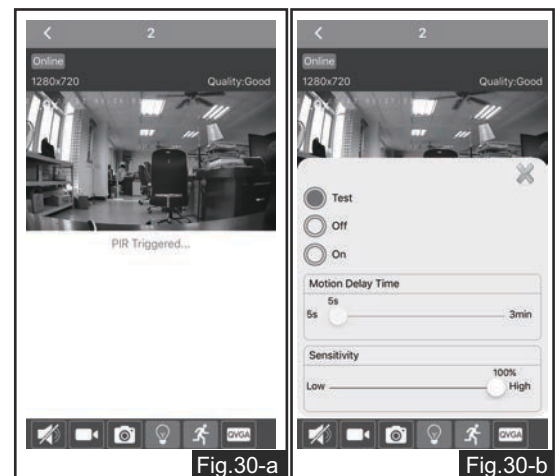

31. Select “”, and choose video quality, included HD and SD.

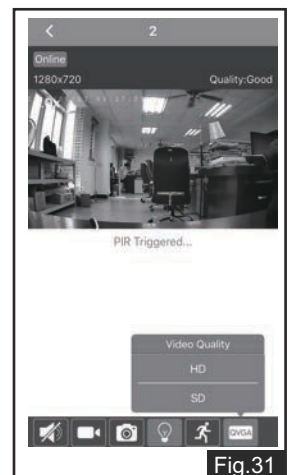

USER GUIDE (Continued)

32. Select Fig.16 top left “☰”, and then select “info” to show the APP version information.

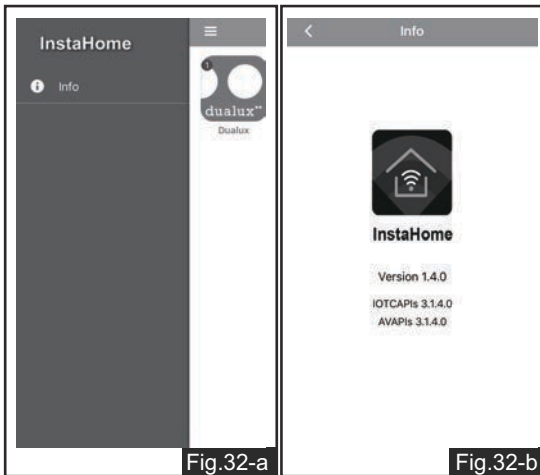

35. Input password (input the light device’s name or not to do), and then click top right “✔”.



36. Search processing.

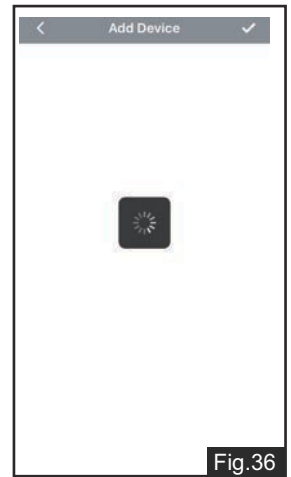

WAN Device Connect. the light device and the phone must be connected the same WiFi.

33. Select “Add WAN Device”.
Select “🔍”.



37. Select “Added Successfully”,
then skip to Fig.16 automatically.

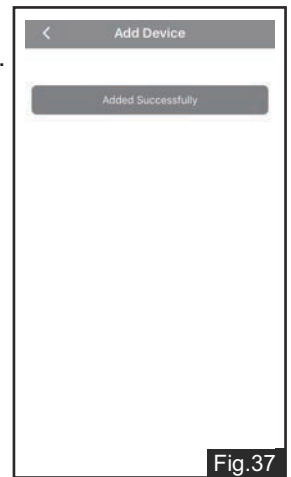

34. Select desired light device UID
shown in list.

