



### Questions, problems, missing parts?

Before returning to your retailer, call our customer service at 1-800-887-6326  
Monday – Friday 9:00 a.m. – 5:00 p.m. CST

## PACKAGE CONTENTS



## ⚠ SAFETY INFORMATION

Please read and understand this entire manual before attempting to assemble, operate or install the product.

### WARNING

- Turn off electricity at main fuse box (or circuit breaker box) before beginning installation by removing fuse (or switching off circuit breaker).
- Be careful not to damage or cut the wire insulation (covering) during fixture installation. Do not permit wires to contact any surface having a sharp edge. To do so may damage or cut the wire insulation, which could cause serious injury or death from electric shock.

### CAUTION

- All electrical connections must be in agreement with local codes, ordinances or the national electric code (NEC). Contact your municipal building department to learn about your local codes, permits and/or inspections.
- Risk of fire – most dwellings built before 1985 have supply wire rated for 140°F/60°C. Consult a qualified electrician before installation.
- This fixture is dimmable with a forward phase electronic dimmer. Dimmers tested to be compatible with this fixture are the Lutron: DVWCL-153PH, MACL-153MH, SCL-153P, TGCL-153PH.  
If you are unfamiliar with electrical installation, it is recommended to use a qualified electrician for your installation(s).

## PREPARATION

Before beginning assembly, installation or operation of product, make sure all parts are present. Compare parts with package contents list and diagram on previous page. If any part is missing or damaged, do not attempt to assemble, install or operate the product.

Tools Required for Assembly (not included): Screwdriver, Phillips Screwdriver, Pliers, Electrical Tape, Wire Cutters, Safety Glasses, Ladder, Wire Stripper.

## ASSEMBLY INSTRUCTIONS

### Important to know

1. Read all instructions carefully before installation and operation.
2. If you are not familiar with state and local electrical codes, it is recommended that you consult with a qualified electrician.
3. Do not use in wet locations, use indoors only.
4. Non-replaceable LEDs.
5. Caution: LEDs emit bright light. Avoid looking directly into the light source for prolonged periods to avoid eye damage.

Turn off the power at fuse or circuit box.

1. This fixture can only be installed in a 6-inch housing with a spring bracket (housing sold separately)

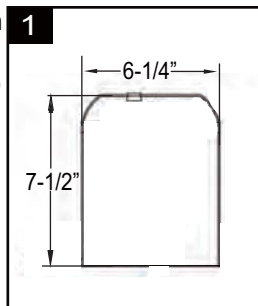

2. Remove the insulated paper before using the fixture.

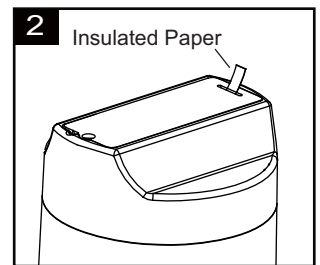

3. Plug the female connector of the retrofit-kit onto the male connector of the socket adapter assembly ( If you used E26 socket, please screw E26 socket adapter into socket in housing.)

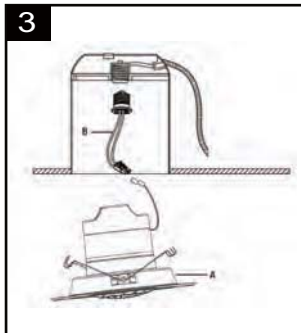

4. Squeeze the torsional springs together as shown and install into torsional spring brackets inside the housing.



5. Truck all wire into the housing and carefully push the out ring up flush to ceiling surface.

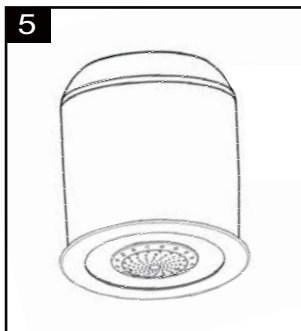

Turn off the power at fuse or circuit box.

# OPERATING THE DOWNLIGHT AND BLUETOOTH SPEAKERS

## CHANGING BATTERIES

Replacing Battery Steps Remove the battery cover from the fixture by screwdriver and replace the old battery with a new battery 7187BB, then restore the battery cover back.

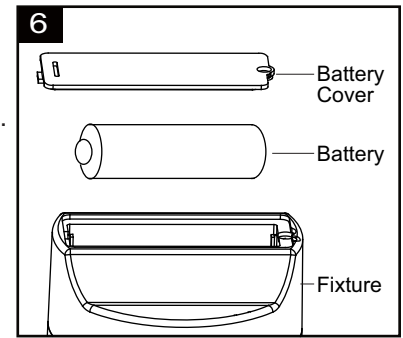

## INSTRUCTIONS:

1. The “Red” indicator is for charging, the red indicator is always on when charging and the red indicator is off when fully charged.
2. The “Blue” indicator light is reminding for Bluetooth connect status. When the blue indicator flashing fast, it is ready for connect Bluetooth; When the blue indicator is always on and speaker indicate “Connected”, it is connected successfully; when the blue indicator flash slowly, it is in playing music status.

The “Reset” button on the light surface, Press the reset button on reset / disconnect the Bluetooth when the blue indicator is flashing and speakers indicate “Disconnected”, it is reset successfully.

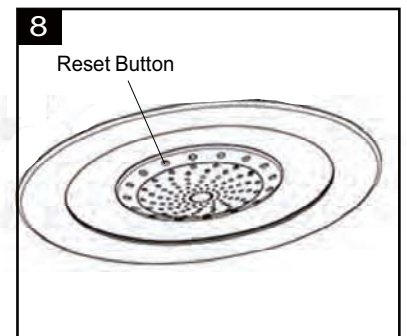
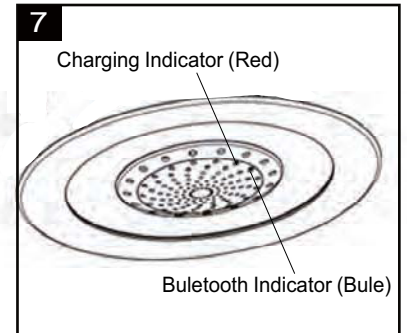

## CONNECT STEPS:

1. Once turn on power, the Bluetooth Speakers are enabled and ready to connect.
2. Enable Bluetooth on your smart device.
3. Wait for the smart device to detect the “Down light 1” and then select it to pair the device to the speakers. When successfully paired, the speaker will “Connected”.
4. Play music from your device while connected to the Down light to enjoy sound from the Bluetooth speakers.
5. Turn off music on your smart device, disconnect the Down light from Bluetooth on your smart device, or disable Bluetooth functionality on your smart device when sound is not wanted from the Down light speakers.

## NOTICE:

1. Bluetooth enabled smart devices typically have a range of approximately 33 ft. (10 m). Attempting to pair your smart device to the Bluetooth speakers beyond the intended range can result in poor audio quality, drop-outs, or failure to connect.
2. Only one device can be connected to the Bluetooth speakers at a time.
3. The speaker includes a battery (18650 type 2000mAh), The speakers can continue working even turn off the light by dimmer or switch. If the speaker run out of the battery, it will indicate alarm sound, please turn on the light right away and the battery will be charging automatically.

## CARE AND MAINTENANCE

Caution: Before attempting to clean the fixture, disconnect the power to the fixture by turning the breaker off or removing the fuse from the fuse box.

You may want to periodically clean the fixture with a soft cloth. To maintain the best appearance of the fixture, do not use cleaners with chemicals, solvents or harsh abrasives. Do not use liquid cleaner on the LEDs, LED drive, or wiring inside the light fixture.

The following parts are available for re-order if damaged or missing. Call our toll free at 1-800-887-6326.

Spare Parts List:

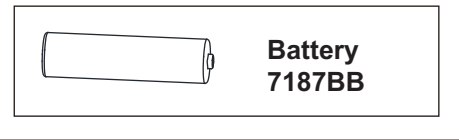

## TROUBLESHOOTING

PROBLEM	POSSIBLE CAUSE	CORRECTIVE ACTION
The fixture will not light	The power is off.	Check to ensure the power supply is on.
	The circuit breaker is off.	Check to ensure the circuit breaker is in the on position.
	There is a bad connection.	Check to ensure proper wire connections are made. Contact a qualified electrician.
	There is a defective switch.	Contact a qualified electrician.
The Bluetooth speakers will not pair with a smart device.	The smart device is out of range of the Bluetooth speakers.	Be sure the Down light is within 33 ft. (10m) of the smart device.
	The smart device is not discoverable.	Turn on "Discoverable" mode on the device to allow the Downlight and smart device to recognize each other
	Bluetooth speaker reset / interference is causing confusion with the connection.	The Speaker will be in "Reset" mode when run out of battery and press "Reset" button on the light. In this case, please remove "Down light 1" from the smart device paired list and rediscover it. Then pair the Bluetooth speaker with smart device again.
	Dead battery	Turn on the light right away and the battery will be charging automatically. Then pair the Bluetooth speaker with smart device again.
There is no sound or poor sound quality from the speakers	Music setting on the smart device need to be adjusted.	Turn music on from the smart device. Turn volume up from the smart device.
	The Bluetooth device is too far away from the Downlight speakers	Move the device closer to the Down light 1 and speakers.
	Interference is causing confusion with the connection	Please reset speaker first. Re-pair the device with Down light 1. When successfully paired, the speakers will indicate "Connected". Power off other Bluetooth devices within a 33 ft. proximity range. Only one device can be connected to the Downlight and speaker at a time.

If unable to fix any of the above issues, please consult a certified electrician.

## **FCC Statement**

This device complies with Part 15 of the FCC Rules. Operation is subject to the following two conditions:

- (1) This device may not cause harmful interference.
  - (2) This device must accept any interference received, including interference that may cause undesired operation.
2. Changes or modifications not expressly approved by the party responsible for compliance could void the user's authority to operate the equipment.

***Note: This equipment has been tested and found to comply with the limits for a class B digital device, pursuant to Part 15 of the FCC Rules. These limits are designed to provide reasonable protection against harmful interference in a residential installation.***

This equipment generates uses and can radiate radio frequency energy and, if not installed and used in accordance with the instructions, may cause harmful interference to radio communications. However, there is no guarantee that interference will not occur in a particular installation. If this equipment does cause harmful interference to radio or television reception, which can be determined by turning the equipment off and on, the user is encouraged to try to correct the interference by one or more of the following measures:

- Reorient or relocate the receiving antenna.
- Increase the separation between the equipment and receiver.
- Connect the equipment into an outlet on a circuit different from that to which the receiver is connected.
- Consult the dealer or an experienced radio/TV technician for help.

This equipment should be installed and operated with a minimum distance of 20 cm between the radiator and your body.

**FIVE-YEAR LIMITED WARRANTY:** If, during normal use, this PATRIOT LIGHTING® lighting fixture breaks or fails due to a defect in material workmanship within five (5) years from the date of original purchase, simply bring this lighting fixture with the original sales receipt back to your nearest MENARDS® retail store. At its discretion, PATRIOT LIGHTING® agrees to have the product or any defective part(s) repaired or replaced with the same or similar PATRIOT LIGHTING® product or part free of charge, within the stated warranty period, when returned by the original purchaser with original sales receipt. This warranty; (1) excludes expendable parts including but not limited to light bulbs; (2) does not cover damage that has resulted from abuse or misuse; and (3) does not cover any losses, labor, injuries to persons/property or costs. This warranty does give you specific legal rights and you may have other rights, which vary from state to state.



### **Questions, problems, missing parts?**

Before returning to your retailer, call our customer service at 1-800-887-6326  
Monday – Friday 9:00 a.m. – 5:00 p.m. CST