

- 13** (1) Install 2 pieces of 49 respectively on the left and right sides of 1.  
(2) Install 4 pieces of 50 respectively on the 4 corners of 1 as shown in the figure.

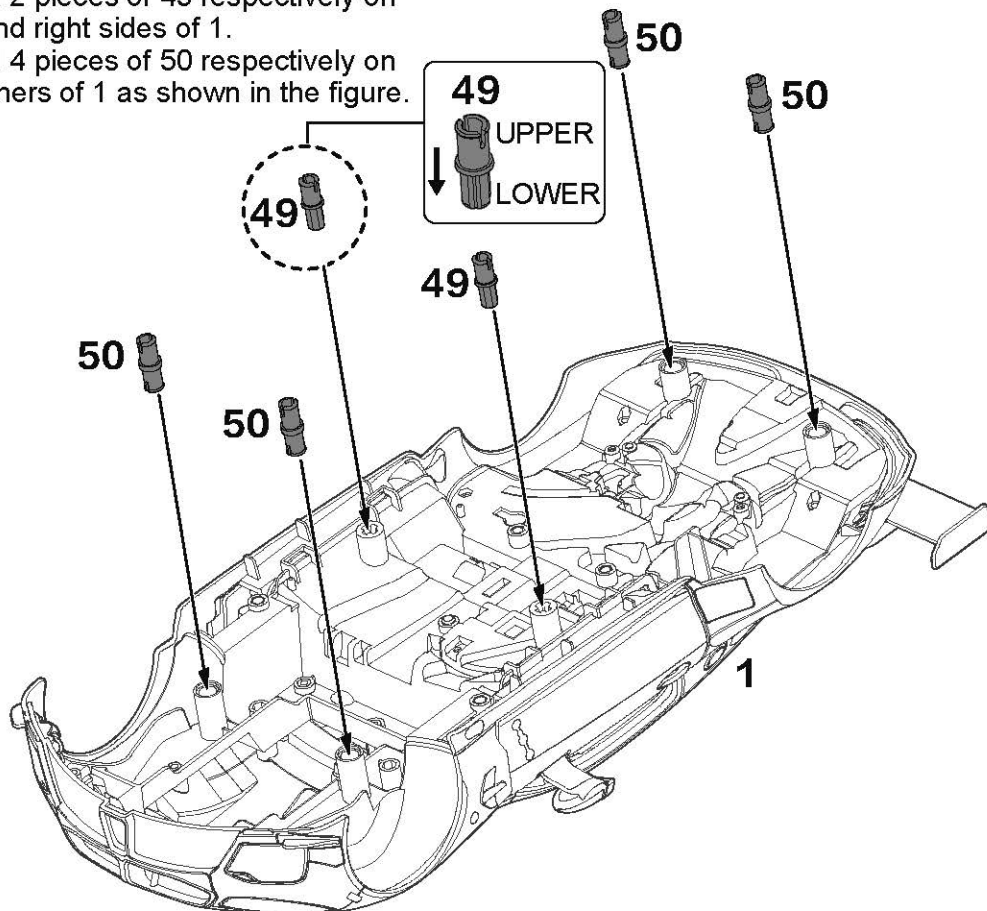

**14** Install 52 and 53 respectively on the position marked on 3.

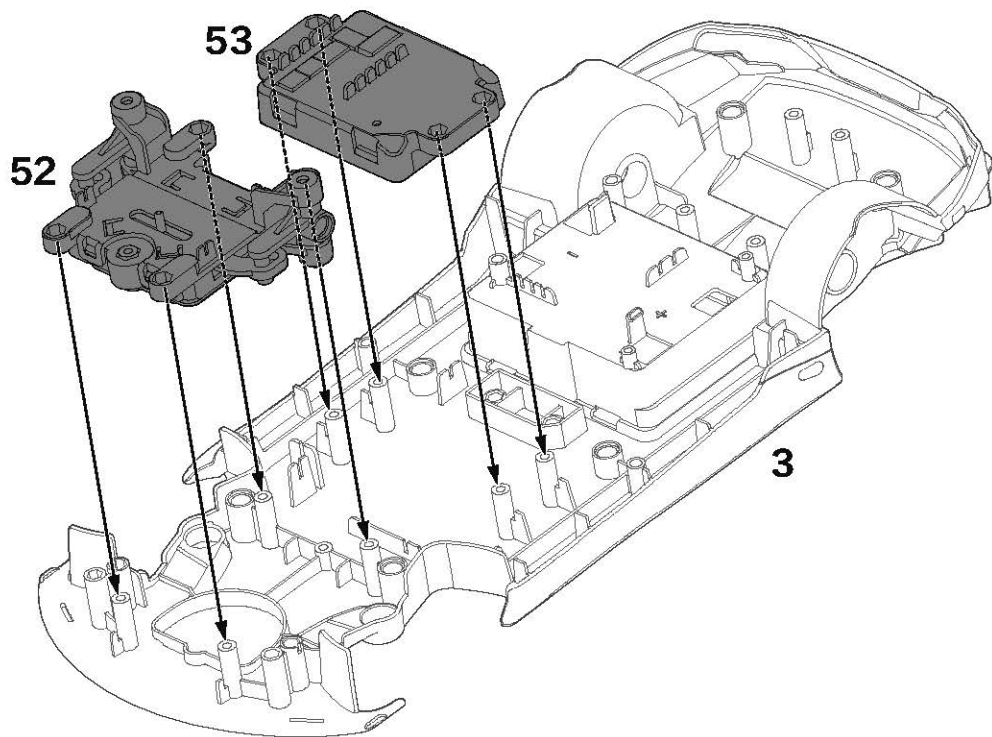

**15**

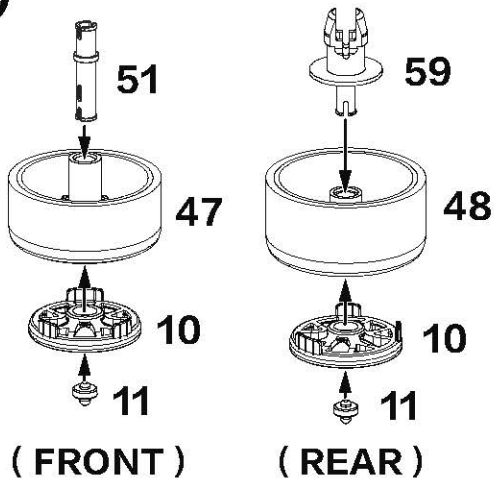

**( FRONT )**

**( REAR )**

- (1) Install front and rear wheels as shown in the figure. (when installing the front and rear wheels, please align the inside of the tire with the belt buckle, do not squeeze it)
- (2) Install the assembled front and rear wheels on 3.

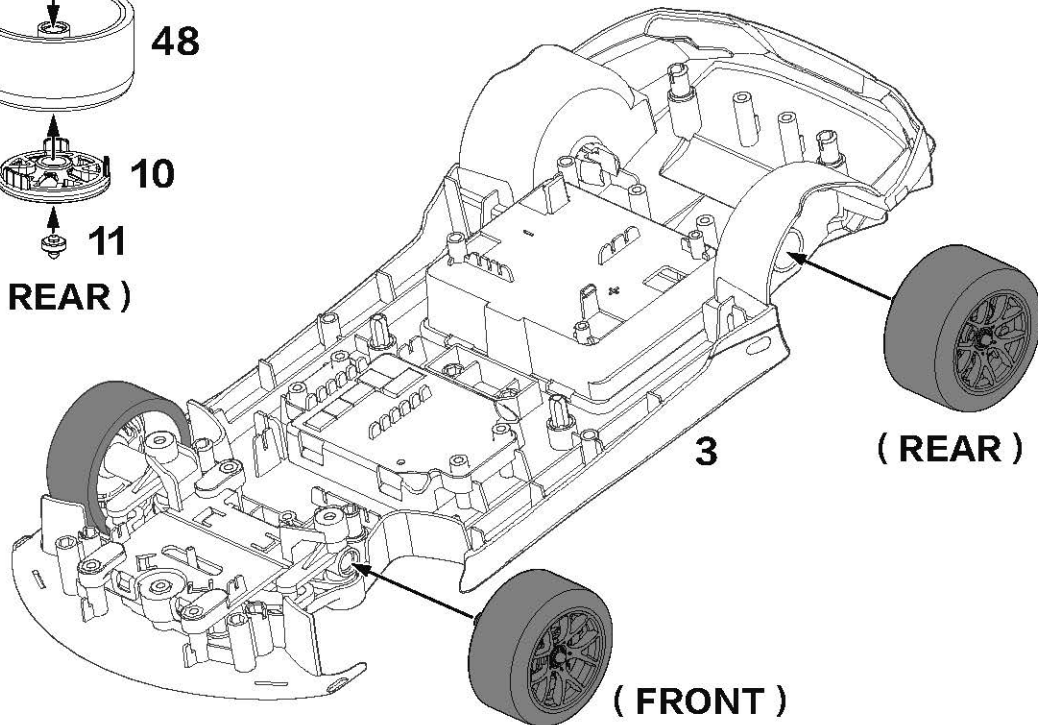

- 16** Attention: When installing the front gear box, please align the middle slot of the fan shaped gear to the middle pillar of the connecting rod.

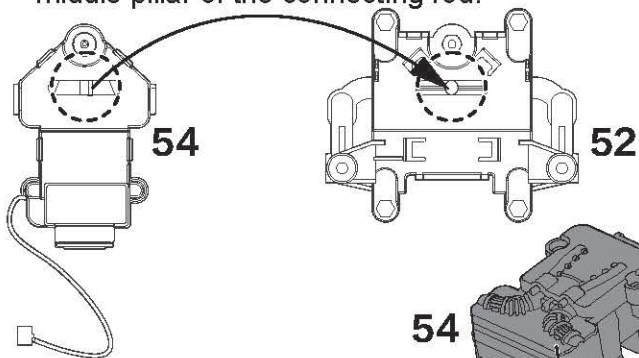

(1) Combine figure 52 and 54 into one model, please put the upper part and the lower part together, and then install it into the corresponding position as shown in the figure.

(2) Install 60 on 3. (After alignment and assembly, turning one wheel can drive the wheel on the other side to rotate.)

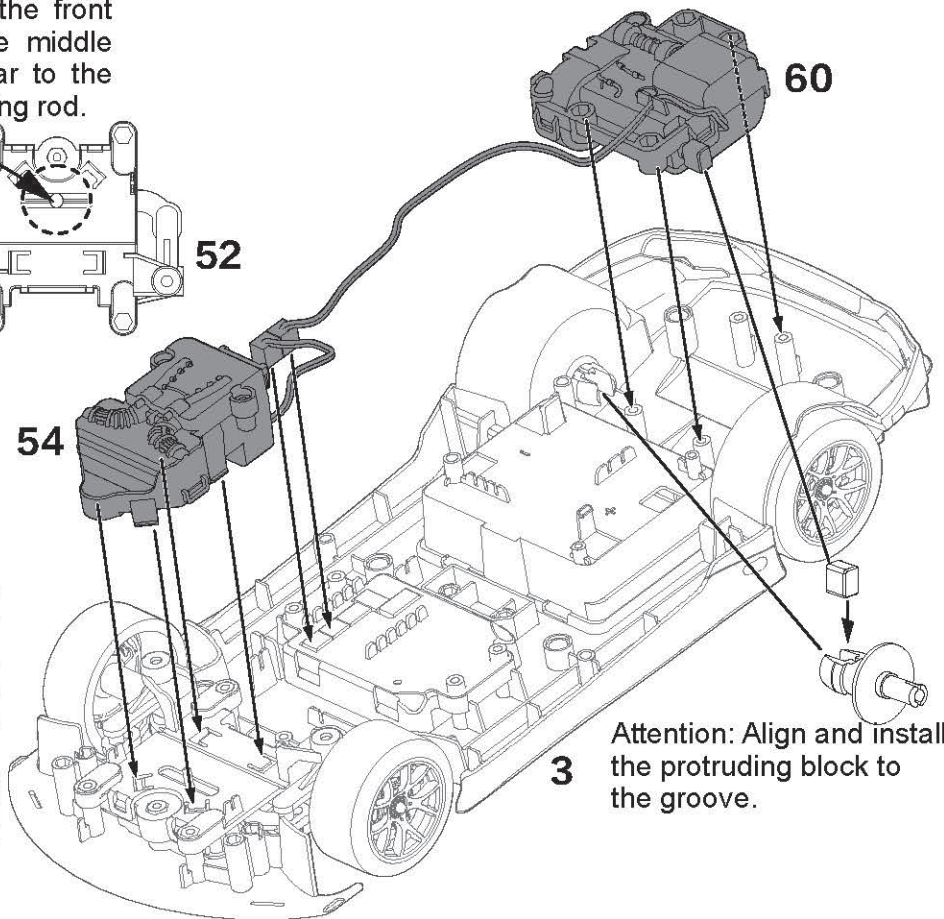

**3** Attention: Align and install the protruding block to the groove.

**17**

- (1) Install 56 on 3 as shown in the figure.
- (2) Install 57 on 3 as shown in the figure.

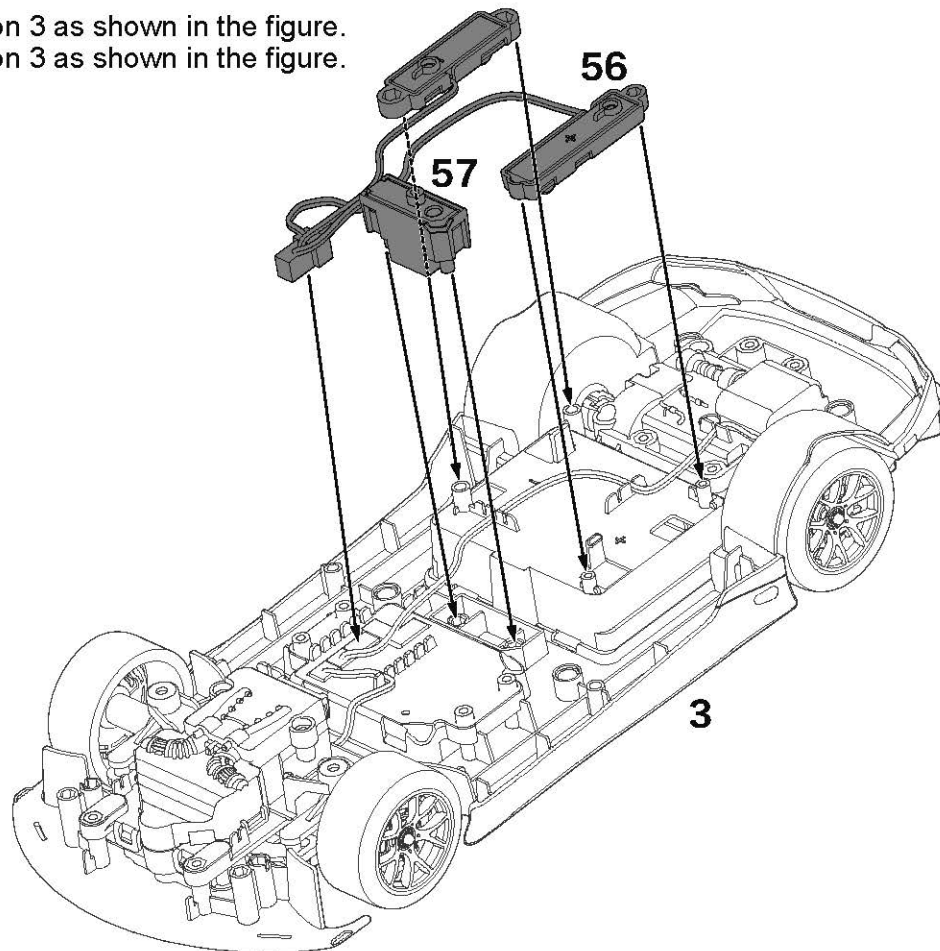

**18**

Install 55 on 3 as shown in the figure, pay attention to the length of electric wires.

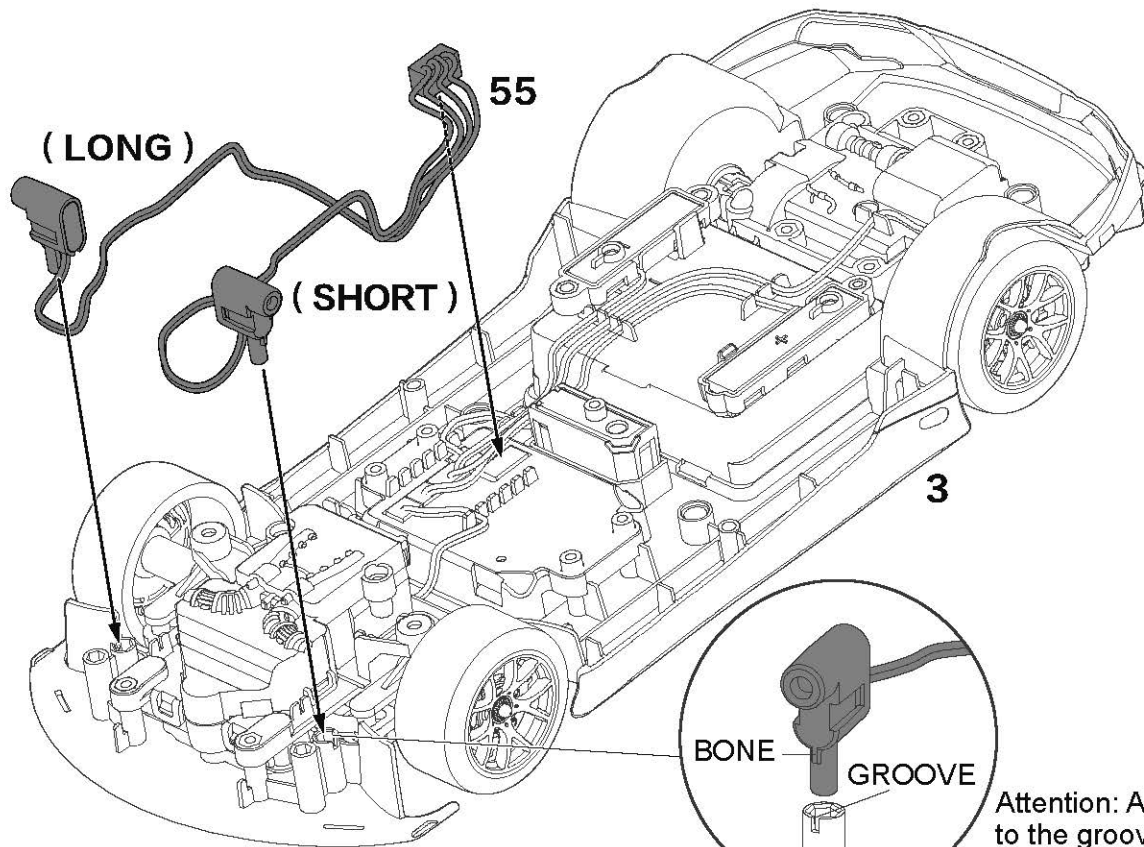

BONE

GROOVE

Attention: Align the bone to the groove when installing the headlight.

- 19** Please press the wire into the gap.  
Plug in respectively while matching by same colours and same shapes.

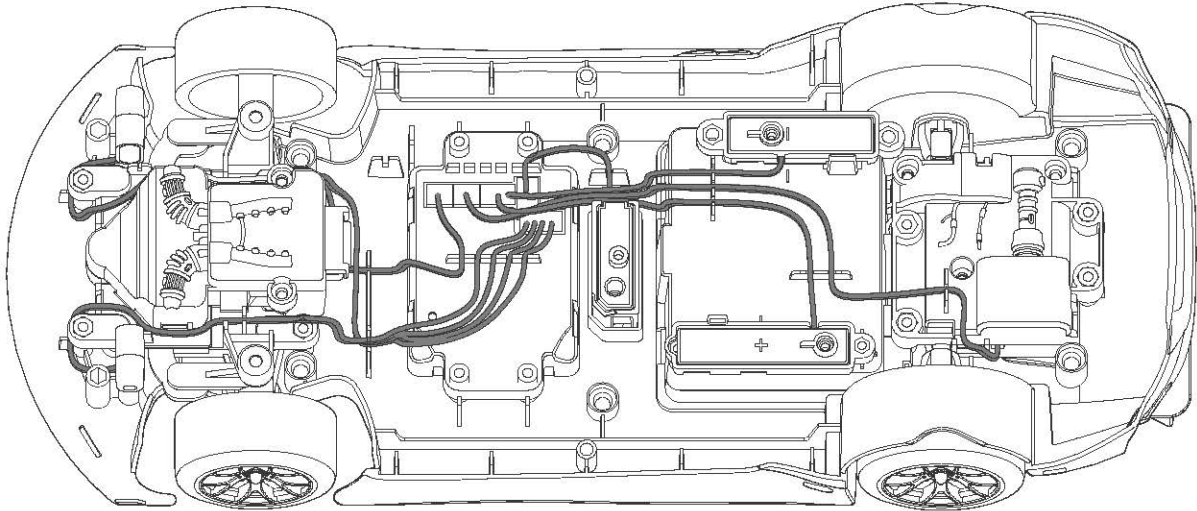

**20** Combine the assembled models as shown in the figure.

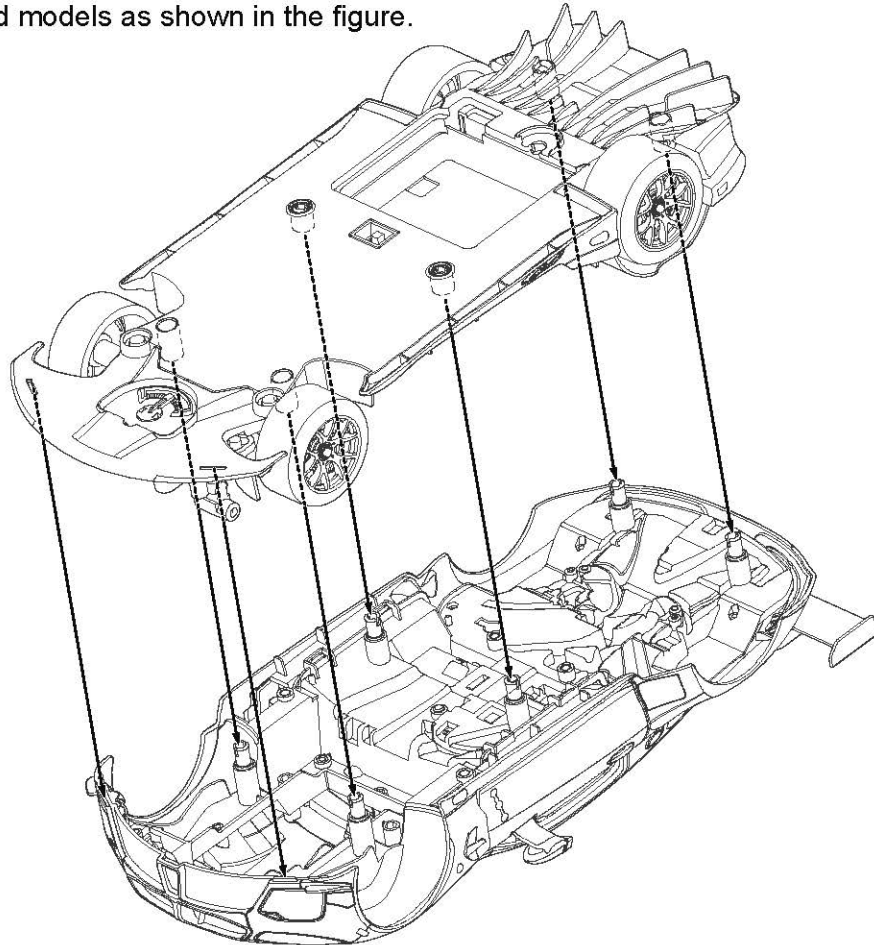



**21**

- (1) Install 58 on 3 as shown in the figure.
- (2) Install B31 on 3 as shown in the figure.
- (3) Put 3 pieces of 1.5V "AA" batteries into the car according to its polarity and then close the battery cover B29.
- (4) Twist B31 to lock the battery cover.

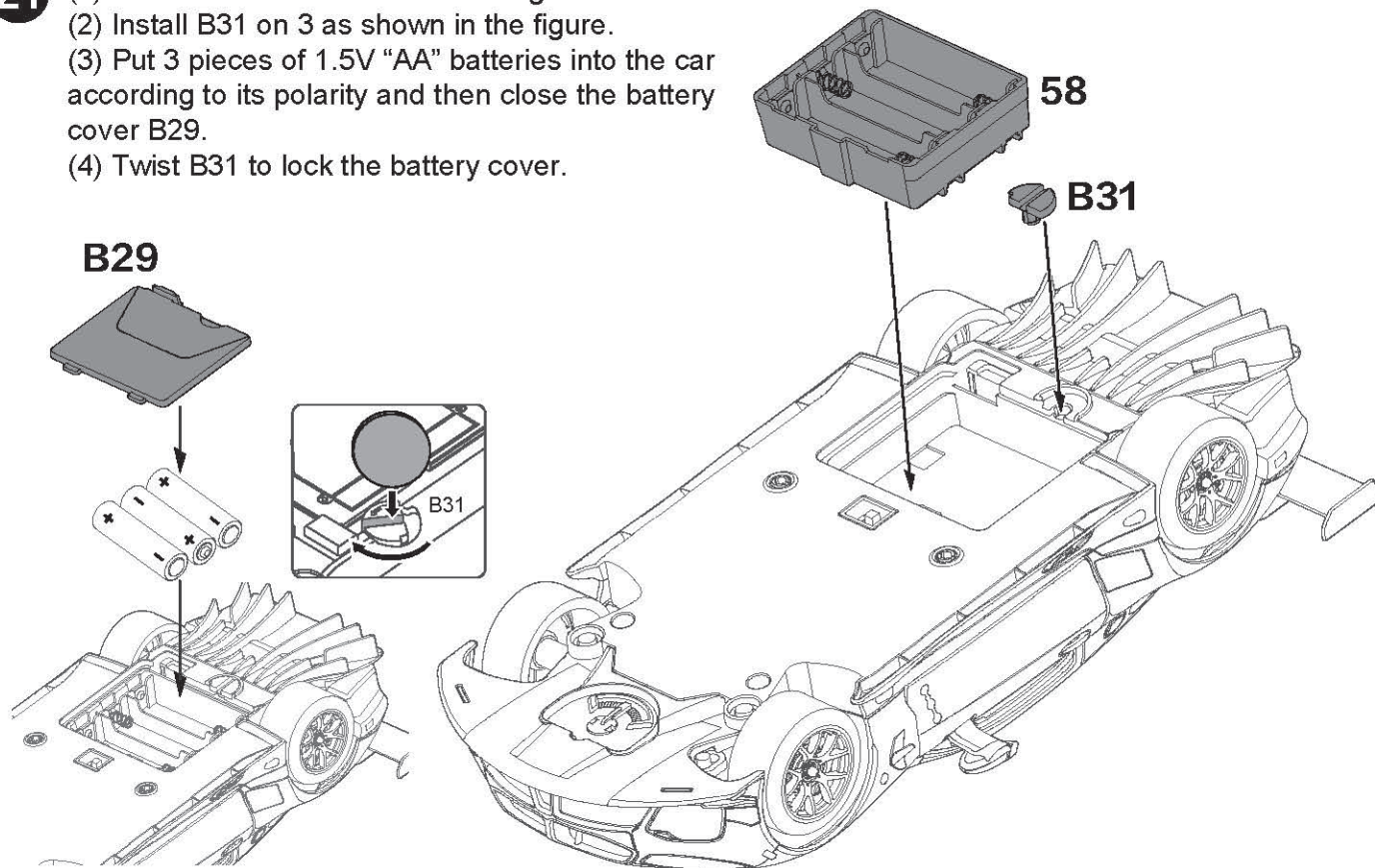

## OPERATION GUIDE

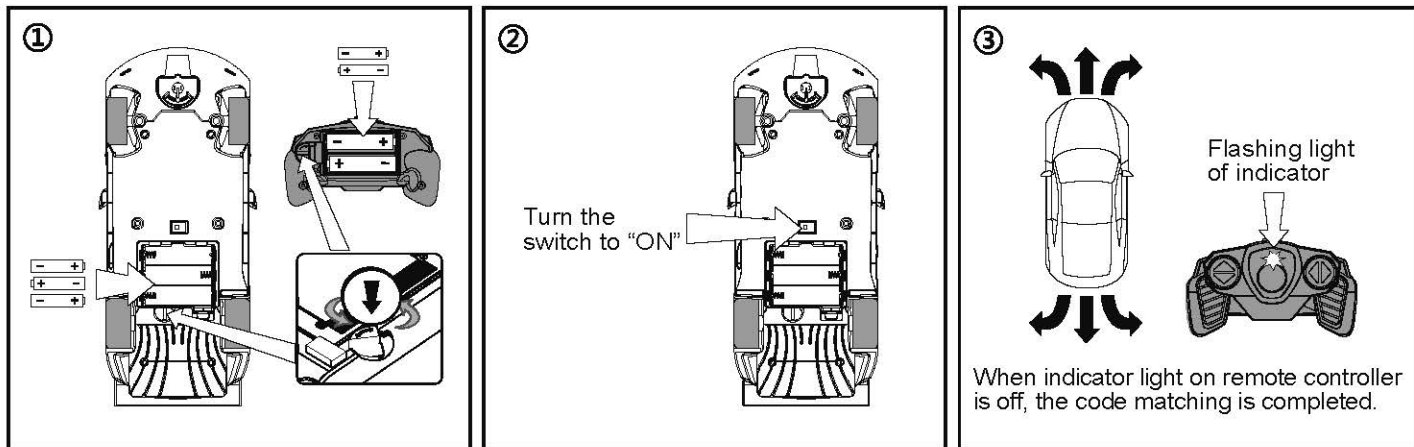

- Use a coin-like tool to twist the knob switch on battery cover to open or close it. Please refer to Figure ①.
- Open battery cover, put 3 pieces of 1.5V "AA" batteries according to the correct polarity into the car, and then close and lock the battery cover with rotary knob.
- Remote controller needs to match code with car before each use. The specific steps are as follows:
- Open battery cover, put 2 pieces of 1.5V "AA" batteries according to the correct polarity into the remote controller, and then close the lid.  
Turn switch on R/C car to "ON" position, when indicator light on remote control is flashing, it is in the status of code matching, when the flashing indicator light on remote control turns off, which means the code is matched, you can control the car freely. Please refer to Figure ②③.
- 2.4GHz transmitter is compatible to control several model cars at same time without interference, provided that the pairing process is orderly done one by one following above steps. Match the code for the first car according to the steps as mentioned above and keep their power on, then match the code for the second car in the same way, and so forth for the rest of cars.

- Please turn off model car after playing.
- Adjust the direction adjustment switch to control the car running in a straight line.
- When battery of remote controller is low, the indicator light on remote controller will be dim, batteries need to be replaced.
- When battery of the car is low, the car will slow down, batteries need to be replaced.
- When it is not in use, please take the batteries out of remote controller and the car.

## FEATURES AND FUNCTIONS

This product uses 2.4GHz communication technology, which is compatible for multi-device and multi-user, with fast response speed, high response precision, and strong anti-interference capability.

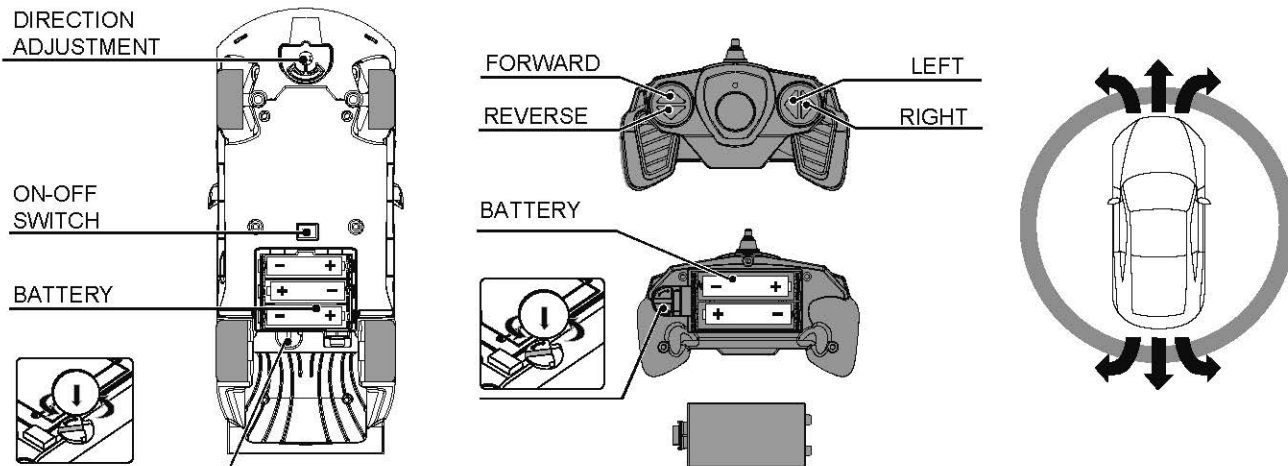

Function: Forward, Reverse, Turn Left, Turn Right,  
Headlight.

Feature: Authentic car styling with injection moulded body,  
independent suspension system.

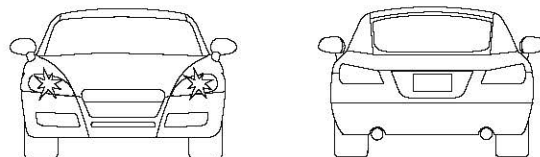

## ATTENTION

- When your vehicle starts to lose power, it may lose its functions or performance. This indicates that it's time to refresh your batteries or recharge them.

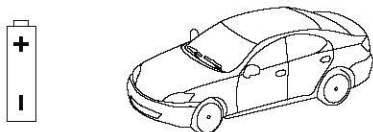

- Don't drive your vehicle in sand, through water or snow.

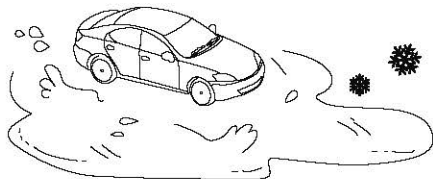

- Point the antenna of the remote control upward to the car, and control the car within the effective range, so as not to affect the play effect.

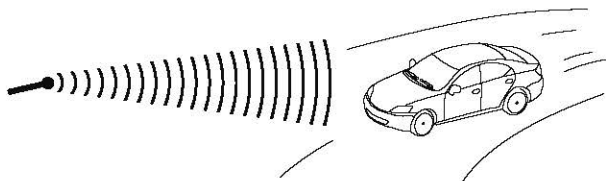

- Do not operate your car on the streets where people gather or under high voltage wires. Stay safe!

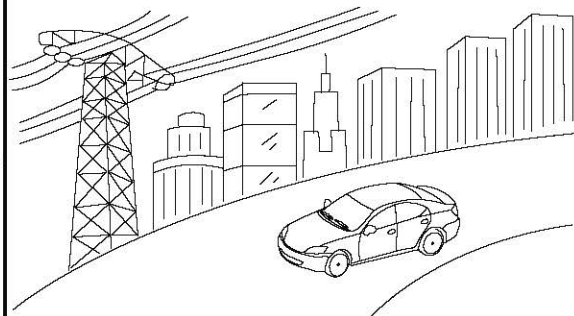

- Don't put your vehicle near heat or in direct sunlight. Always turn switches OFF after operating.

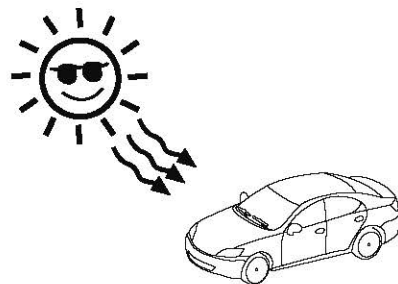

Pictures for reference only, subject to actual product.

## MAINTENANCE

- Remove the batteries when the unit is not in use for long periods of time.
- Clean the vehicle with a soft cloth.
- Avoid being heated or being exposed to strong sunlight.
- Keep dry.
- Regularly examine the toy for any damage to its wires, plug, enclosure and other parts and they must not be used until the damage has been repaired.

NOTE: This equipment has been tested and found to comply with the limits for a Class B digital device, pursuant to part 15 of the FCC Rules.

These limits are designed to provide reasonable protection against harmful interference in a residential installation. This equipment generates, uses and can radiate radio frequency energy and, if not installed and used in accordance with the instructions, may cause harmful interference to radio communications.

However, there is no guarantee that interference will not occur in a particular installation. If this equipment does cause harmful interference to radio or television reception, which can be determined by turning the equipment off and on, the user is encouraged to try to correct the interference by one or more of the following measures:

- Reorient or relocate the receiving antenna.
- Increase the separation between the equipment and receiver.
- Connect the equipment into an outlet on a circuit different from that to which the receiver is connected.
- Consult the dealer or an experienced radio/TV technician for help.

This device complies with Part 15 of the FCC Rules.

Operation is subject to the following two conditions:

- (1) this device may not cause harmful interference, and
- (2) this device must accept any interference received, including interference that may cause undesired operation.

Warning: Changes or modifications to this unit not expressly approved by the party responsible for compliance could void the user's authority to operate the equipment.

## BODY LOGO

Put the stickers on the corresponding position according to the serial number.

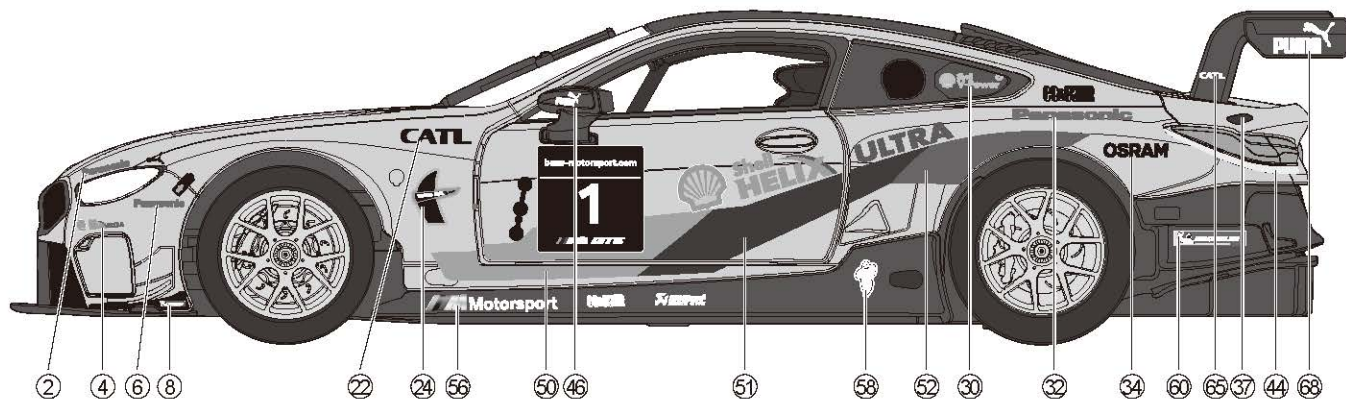
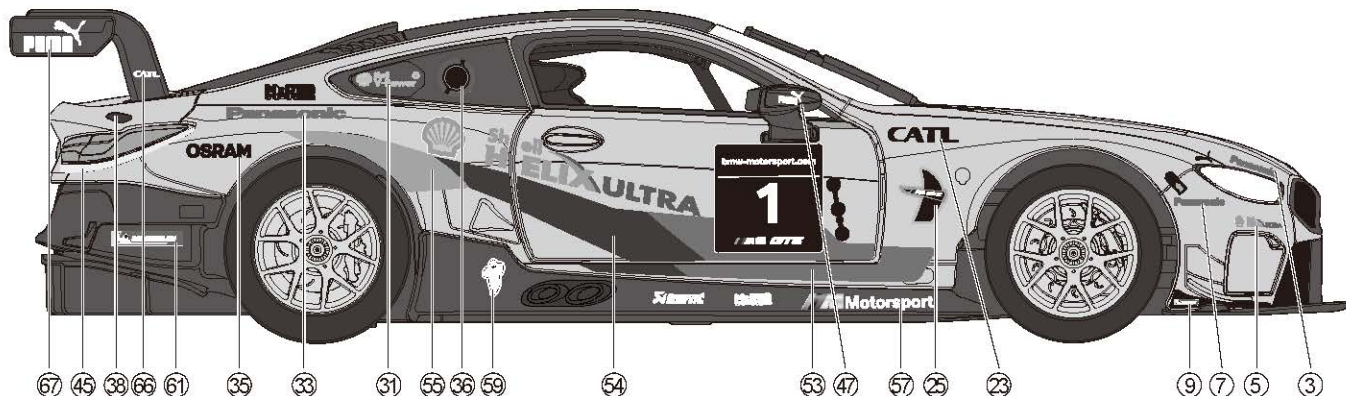

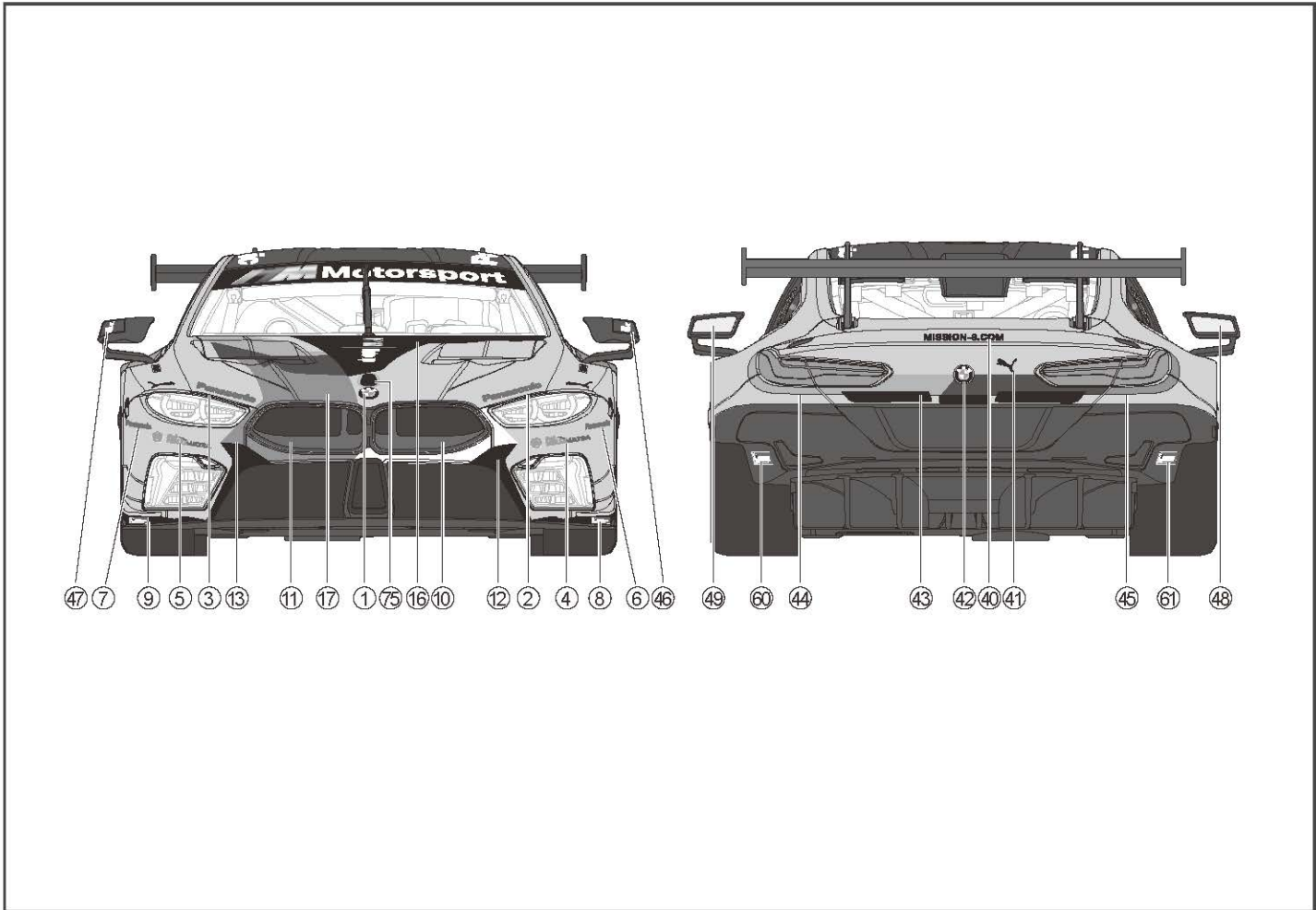

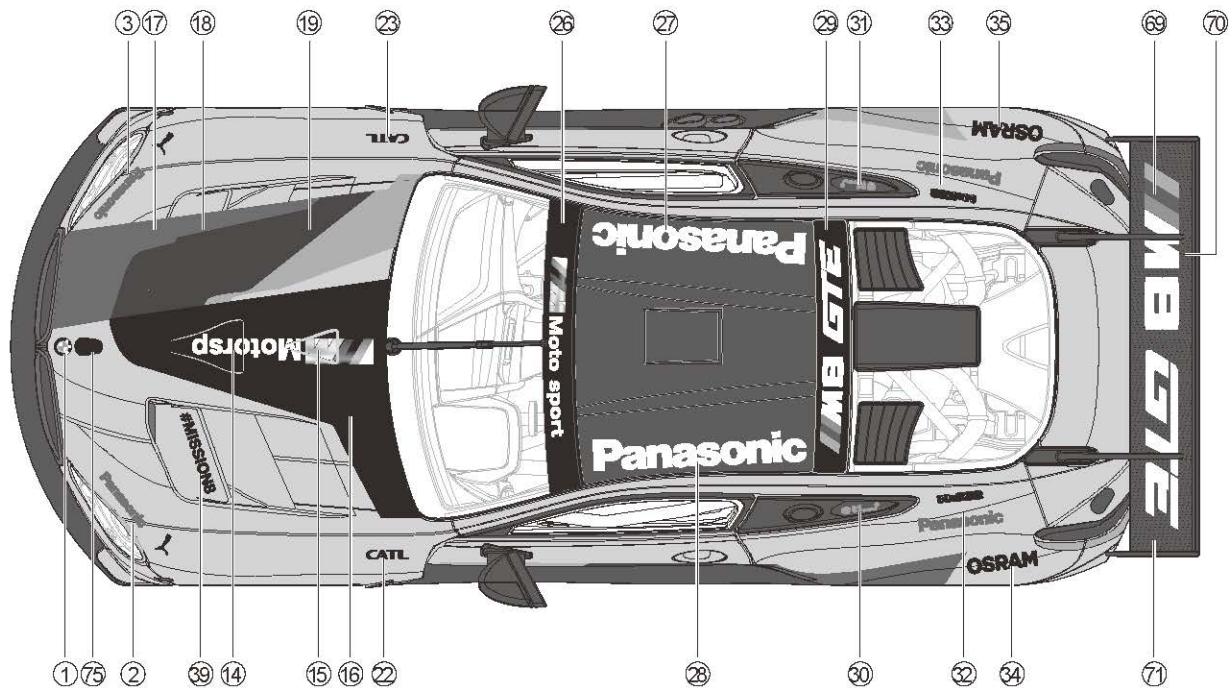



Frequency bands: 2400MHz to 2483.5MHz

Maximum Transmitting Power (EIRP) : Not more than 10mW.

Applicable age 8 years (96 months) and above.

 **WARNING:**  
CHOKING HAZARD-Small parts.  
Not for children under 3 years.

 **WARNING:**  
This product requires complex assembly and must be  
used under adult supervision.

This instruction manual contains important information. Please keep it in a safe place for future reference.



The BMW logo and the BMW wordmark are trademarks of BMW AG and are used under License.

Licensee: RASTAR GROUP  
Manufacturer: RASTAR GROUP  
Add: Xinghui Industrial Park, Xiadao Road, Shanghai,  
Chenghai, Shantou, Guangdong, China.  
[Http://www.rastar.com](http://www.rastar.com)