

•Point your transmitter antenna up not down toward your vehicle. If your vehicle gets too far away, it won't work properly. If your transmitter has an antenna carry-loop feature, make sure the antenna is removed from the holder and straightened before operating.

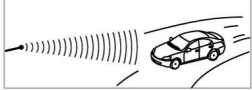

•Don't put your vehicle near heat or in direct sunlight. Always turn switches OFF after operating.



Car pictures demonstrated above may vary from the toys.

MAINTENANCE

- Remove the batteries when the unit is not in use for long periods of time.
- Clean the vehicle with a soft cloth.
- Avoid being heated or being exposed to strong sunlight.
- Keep dry.
- Regularly examine the toy for any damage to its wires, plug, enclosure and other parts, and they must not be used until the damage has been repaired.

Hereby, [Rastar Group], declares that this [Model R/C Car] is in compliance with the essential requirements and other relevant provisions of Directive 2014/53/EU.

Frequency bands: 2410Mhz to 2470Mhz
Maximum Transmitting Power (EIRP) : Not more than 10mW.

WARNING:
CHOKING HAZARD-Small parts.
Not for children under 3 years.

The instruction has to be kept since it contains important information.

RASTAR GROUP

Add: Xinghui Industrial Park, Xiadiao Road, Shanghua,
Chenghai, Shantou, Guangdong, China.
Http://www.rastar.com

-5-

01.04.00014.00803

Warning: Changes or modifications to this unit not expressly approved by the party responsible for compliance could void the user's authority to operate the equipment.

NOTE: This equipment has been tested and found to comply with the limits for a Class B digital device, pursuant to Part 15 of the FCC Rules. These limits are designed to provide reasonable protection against harmful interference in residential installation. This equipment generates, uses and can radiate radiofrequency energy and, if not installed and used in accordance with these instructions, may cause harmful interference to radio communications.

However, there is no guarantee that interference will not occur in a particular installation. If this equipment does cause harmful interference to radio or television reception, which can be determined by turning the equipment off and on, the user is encouraged to try to correct the interference by one or more of the

following measures:

- Reorient or relocate the receiving antenna.
- Increase the separation between the equipment and receiver.
- Connect the equipment into an outlet on a circuit different from that to which the receiver is connected.
- Consult the dealer or an experienced radio/TV technician for help

The device must not be co-located or operating in conjunction with any other antenna or transmitter.

FCC ID: 2AENTXH180329TX

This device complies with Part 15 of the FCC Rules. Operation is subject to the following two conditions: (1) this device may not cause harmful interference, and (2) this device must accept any interference received, including interference that may cause undesired operation.

RASTAR



INSTRUCTIONS

This manual is applicable to the following types of product: 40300,40340, 42600,42640,70900,70940,72540,80442447988,80442447987, 80442454831, 80442411559,80432318517, 80432318513, 80442463106.

OPERATION GUIDE

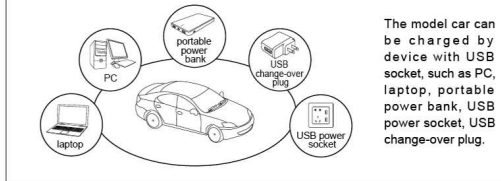
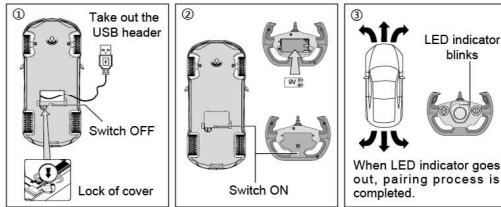

- For first time usage or after long-term unused, the model car can be charged by device with USB socket (such as portable power bank, computer, mobile charger...) following below steps:
 - Turn the switch of model car to OFF. Turn the lock of cover and open the cover, then take out the USB header. See picture 1.
 - Plug the USB header into the USB socket of charging device, then the tail light of model car will turn on. After 3 seconds, the tail light will blink slowly, which means the model car is being charged.
 - When charging is finished, the tail light will go out. If the tail light goes out after USB is connected, this means the battery is full.
 - If the tail light blinks quickly after USB is connected, this means there is problem with the circuit or battery. Please pull out the USB header as soon as possible to stop charging. The model car can be charged again only after it has been repaired by the after-sale service center or distributor.
 - Please make the USB socket works properly before charging the model car.
 - When being charged, the model car may become a little bit hot. It is normal and will not harm the model car.
- Every time before playing, the transmitter needs to pair with the model car as follows:

-2-

- Put the antenna into the controller socket. Open the lid and put the 9V(6F22) battery according to its polarity, then close the lid, Make sure the power of model car is sufficient.
- Switch on the transmitter, then the LED indicator on the transmitter will blink and ready for LED indicator pairing. Switch on the model car, the LED indicator on the model car can be fully controlled by the transmitter. See picture 3.
- Adjust the direction adjustment switch to control the car running in a straightline.
- Please replace battery when LED indicator becomes dark which means low battery.
- The speed of model car will slow down when battery is low. Please recharge then.
- 2.4GHz transmitter is compatible to control several model cars at same time without interference, provided that the pairing process is orderly done one by one following above steps. That is, first transmitter finishes pairing with first model car and keep their power on, then second transmitter can begin to pair with second model car...
- Please turn off the transmitter and model car after playing.

FEATURES & FUNCTION

This product uses 2.4GHz communication technology, which is compatible for multi-device and multi-user, with fast response speed, high response precision, and strong anti-interference capability.

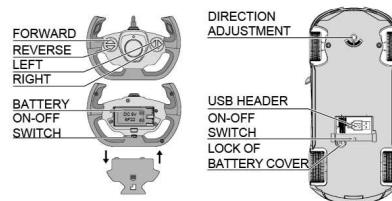

Function: Forward, Reverse, Turn Left, Turn Right, Headlight and Rear Light.
Features: Authentic car styling with injection moulded body, Independent suspension system.

-3-

CAUTION

- Different types of batteries or new and used batteries are not to be mixed. Exhausted batteries are to be removed from the toy.
- Batteries should be replaced by an adult. Batteries are to be inserted with the correct polarity. The supply terminals are not to be short-circuited.
- Non-rechargeable batteries are not to be recharged. Rechargeable batteries are to be removed from the toy before being charged. Batteries are to be charged by adult or by children at least 8 years old, leaked or broken batteries are not to be charged.
- Rechargeable batteries are only to be charged under adult supervision.
- Only batteries of the same or equivalent type is recommended to be used.
- Battery inside the car cannot be replaced.
- The antenna, wire, USB wire or battery plug are not to be inserted into output socket.
- Never put the batteries near fire or any source of heat, water or direct sunlight.
- Skin or clothing is to be washed immediately if you make contact with leaked liquid from the battery.
- For better preservation of rechargeable batteries, please regularly recharge it, and only a charger of the same or equivalent type is recommended to be used.
- Plastic bag is not for playing, as it may cause suffocation. Please keep away from small children.
- Dispose of battery responsibly, Do not dispose of in fire.
- The toy is only to be connected to Class II equipment bearing the following symbol Class II equipment.

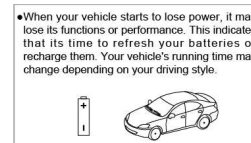

- Don't drive your vehicle in sand or through water or snow.



• Radio interference can make your vehicle run badly. Interference can be caused by other radio control vehicles running on the same frequency, electrical wires, large buildings, or CB radios. Try to stay away from them!

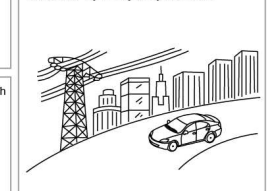

-4-