

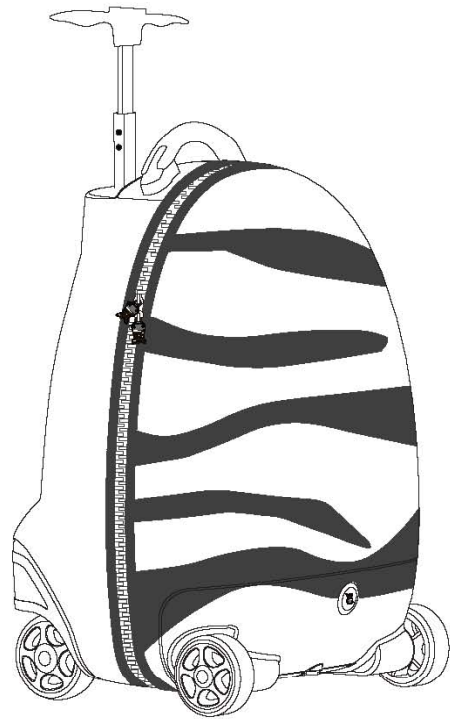

RASTAR GROUP

# Walking Suitcase

## Instruction



Thank you for buying this product. Please read this manual carefully before using. Please keep it properly for future reference. Product pictures shown in this manual is for reference only, please subject to the real object.

## Specifications

Item No.	RST1601/ RST1602 / RST1603	
Product Size	16 "/ 31cmx25cmx42cm	
Reference Standard	QB/T2155-2010	
Suitable Age	Above 6 Years	
Usage	(1) Remote Control (2) Traditional Handle	
Loading Limit	5kg	
Weight	2.6kg	
Powered	Rechargeable Battery	
Speed	2.8-3.7km/h	
Battery Specification	9.6V 600mA(1.2V 600mA 8 PCS in Series Connection)	
Power Supply	Input Voltage:5V	Output Voltage :9.6V
Charging Time	About 6h	
Battery Continuous Using Time	About 30mins	
Rechargeable Times	Above 500 times	
Suitable Temperature	0-50℃	
Motor Power	6.5W	

## Package Contents



Suitcase x 1



R/C Sling x 1



Remote Controller x 1



USB Cable x 1

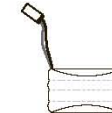

Battery Component x 1

## Operation Manual

### 1 Matters Needed Attention

(1) Before first use or reuse after long time using, charge the battery component via power devices with USB connectors, such as computers, power banks, USB chargers or USB adapters.

(2) 6 hours are needed to full charge the battery component each time. The suitcase can be used for about 30mins when it's full charged.

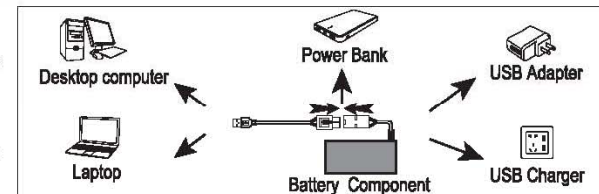

## 2.Charging Procedures

### (1) Remove Battery Component

According to diagram ①, use a tool like a screwdriver to rotate the screw on the suitcase bottom, open the battery cover, push aside the battery component port, pull the string and then take the battery component out. See diagram ② as a reference.

(P.S., Rechargeable batteries are to be removed from the suitcase before being charged.)

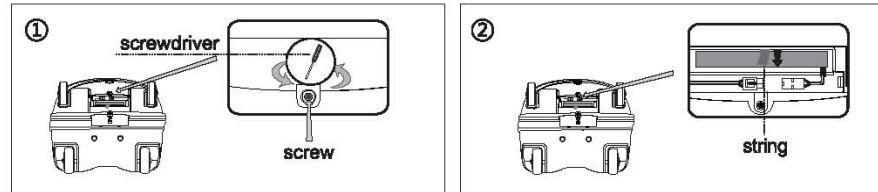

### (2) Charge Battery Component

Connect the component port with port A of the USB cable, then connect port B of the USB cable to a charge device. Indication light be on by then.(Diagram ③)

- 1) Indication light glitters about 3 seconds after charger is connect, which shows charging is working well.
- 2) Indication light will be off with automatic power off once battery component is full charged.
- 3) Indication light glitters 3 times faster than normal, means there is something wrong with cable or battery component. Please stop charging.

### (3) Attention

- 1) Make sure USB cable is in good status.
- 2) ) It's normal if USB and battery warms a little while charging.
- 3) Please stop using the batteries it's leakage.

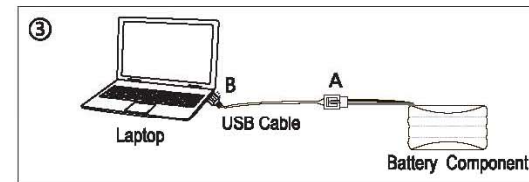

## 3.Product Usage

### (1) Suitcase Battery Component Assembly

According to diagram ④, pun in the battery component correctly, make sure the connector is on the out side, then connect it to the charger cable.

### (2) Remote Controller Assembly

Put in two AAA batteries correctly according to diagram ⑤.

(3) Correlate the R/C to the Suitcase According to diagram⑥ and ⑦.

1) Turn on the remote controller, it'll set into searching when the indicator glitters.

2) Turn on the power supply on the suitcase, if the remote controller light crushes out, the correlation is done.; if the light still glitters, the correlation is failed, reset the power supply and do the correlation again.

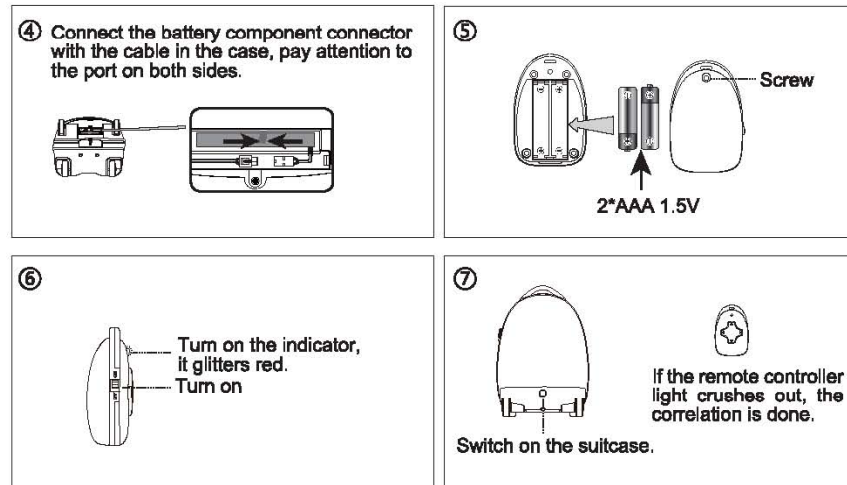

#### 4.Remote Controller Operation

(1) Adopting double motor with four channels, the suitcase can swerve, move forth and back. It can be operated with a single hand. See diagram ⑧ for your reference.

(2) Matters Needed Attention

- 1) It indicates low battery when the light darkens, please replace the batteries.
- 2) It indicates the battery component need recharge when it slows down. Charge for about 6 hours each time, and it can run for about 30mins.

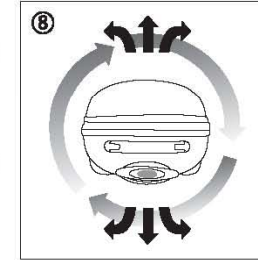

#### Specifications and Functions

Adopting the 2.4GHz communication techniques, this suitcase has wide applications with its system. With the high speed, high precision, strong anti-interference ability and other advantages, couples of the devices can be used by different users meanwhile.

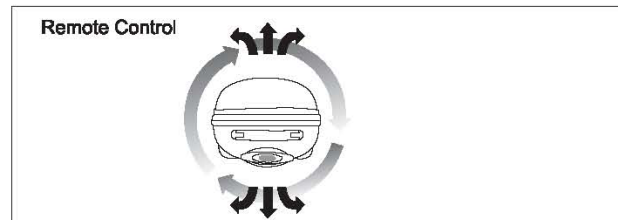
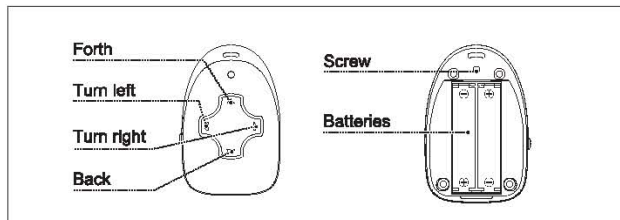
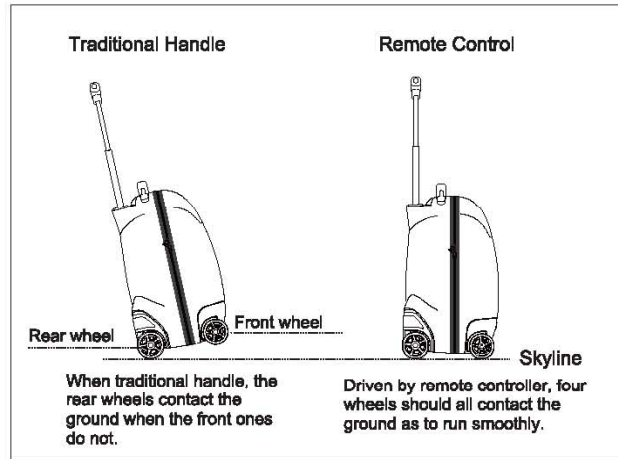
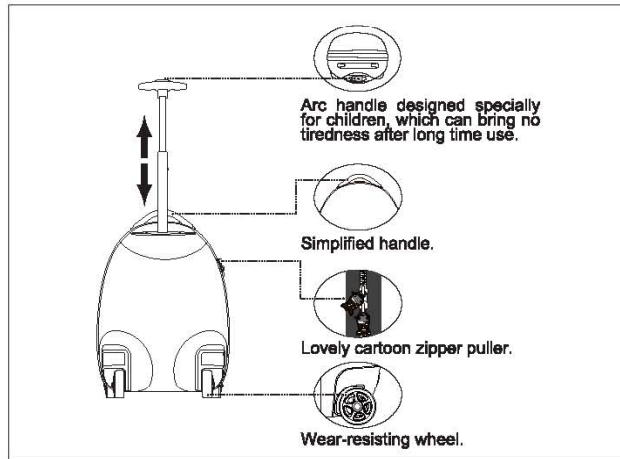

Functions: Move forth and back, turn left and right , storage.

Product pictures shown in this manual is for reference only, please subject to the real object.

## Attention

- Batteries in different types or use conditions cannot be mixed used. Exhausted batteries are to be removed from the suitcase.
- Battery replacement should be done under adult supervision. All batteries shall be put in correctly according to the signs. The supply terminals are not to be short-circuited.
- Do not charge non-rechargeable batteries. Charge the rechargeable batteries component under adult supervision. The component should be taken out for charge. When a battery gets wet, do not charge it .
- The power supply cable and the battery component cable cannot be connected to an outlet.
- The limit load of the suitcase is 5kg . Do not overload.
- When dragging, do not let the front wheels touch the ground and make sure both rear wheels touch the ground to ensure the long time use of the suitcase. In R/C Mode, four wheels should all touch the ground to ensure the stable running.
- The product is only suitable for children with an age above 6 years.
- Keep the batteries away from fire and water. And do not beat them or expose them to the sun.
- If the skin or clothes touches the liquid wept from the battery, flush with plenty of water immediately. If discomfort still exists, please go to see a doctor.
- Inspect the wires, connectors, shells and other components at regular frequencies. Replace or stop use the damaged parts.
- At least recharge three month one time, in case to ensure the service life of the batteries.
- Plastic bags can cause choking hazards, please deal with them properly.
- The suitcase can only be connected with devices with a  sign (double insulation sign).
- To avoid damages, do not operate this product in dangerous situations, such as on road, slope, or broken road.

## Maintenance

Please inspect and maintain the product at regular intervals. Please stop using and replace any screws that is loose or parts that is damaged. Please use a dry cloth to wipe the surface gently as to keep a descent look. Avoid storing the suitcase in dusty, wet or high-heat conditions.

- The suitcase stand still , do not put too much weight on it or stomp or sit on it.
- Freight stickers should be removed in time.
- To avoid dust, please wrap the suitcase when it's not used.
- Do not keep the suitcase in wet condition for long.
- As to protect the wheels and the bottom of the suitcase, do not use it on uneven road.
- Keep the wheel smooth. Check if the wheels have dirt and clean them before store the suitcase.

Some functions may not be performed when battery is low, please recharge or replace the batteries. Running time of the suitcase in R/C Mode depends on the way of use.

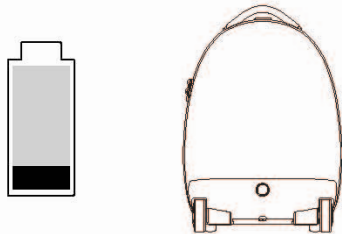

To avoid getting lost or damage, do not use it in crowded places.

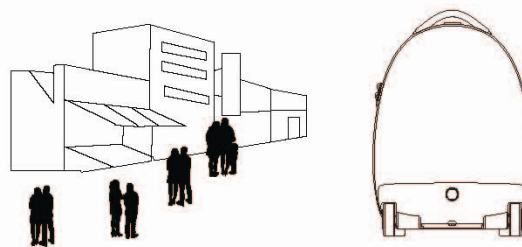



Do not drive the suitcase in the sands, water or snow.

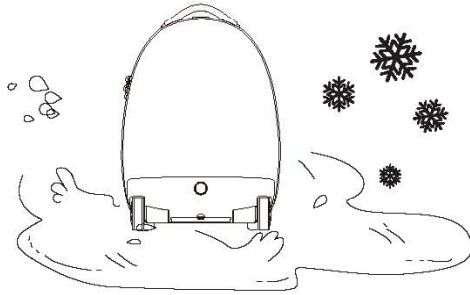

Keep the suitcase away from high heat or highlight. Turn the power off when it's not used.

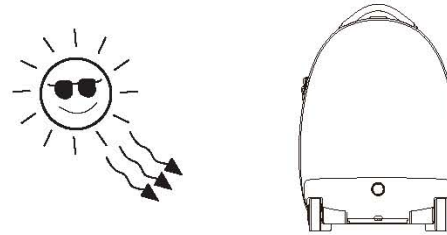

To get the best performance, please keep the suitcase in a controllable distance, i.e. 20 meters. The controllable distance may be influenced by buildings or other barriers.

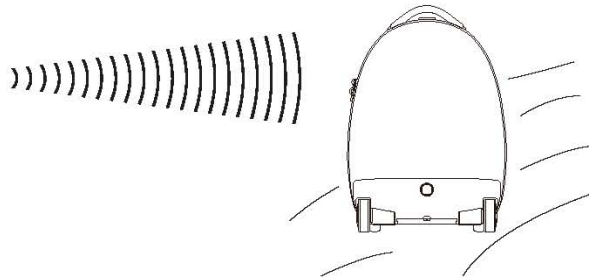

Hang the controller on the suitcase to avoid losing.

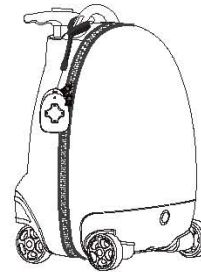

## Care and Maintenance

Malfunctions	Analysis
Suitcase can not drive	<ul style="list-style-type: none"> <li>•Check if the connector has fallen of and reconnect it if so.</li> <li>•Check if the the correlation is correct.</li> <li>•Check if the suitcase is overloaded.</li> <li>•Check if the wires are damaged.</li> </ul>
Suitcase walks slowly	<ul style="list-style-type: none"> <li>•Check if the battery is low.</li> <li>•Check if the suitcase is overloaded.</li> </ul>
Batter component can not be recharged	<ul style="list-style-type: none"> <li>•Check if the USB cable is damaged.</li> <li>•Check if the charge outlet is damaged or stuck.</li> </ul>



## RASTAR GROUP

This device complies with Part 15 of the FCC Rules. Operation is subject to the following two conditions : (1) this device may not cause harmful interference, and (2) this device must accept any interference received, including interference that may cause undesired operation.

**Warning:** Changes or modifications to this unit not expressly approved by the party responsible for compliance could void the user's authority to operate the equipment.

**NOTE:** This equipment has been tested and found to comply with the limits for a Class B digital device, pursuant to Part 15 of the FCC Rules. These limits are designed to provide reasonable protection against harmful interference in a residential installation. This equipment generates uses and can radiate radio frequency energy and, if not installed and used in accordance with the instructions, may cause harmful interference to radio communications.

However, there is no guarantee that interference will not occur in a particular installation. If this equipment does cause harmful interference to radio or television reception, which can be determined by turning the equipment off and on, the user is encouraged to try to correct the interference by one or more of the following measures:

- Reorient or relocate the receiving antenna.
- Increase the separation between the equipment and receiver.
- Connect the equipment into an outlet on a circuit different from that to which the receiver is connected.
- Consult the dealer or an experienced radio/TV technician for help.

**Manufacturer:**RASTAR GROUP

**Add:**Xinghui Industrial Park, Xiadao Road, Shanghai,  
Chenghai, Shantou, Guangdong, China.

**Http://**[www.rastar.cn](http://www.rastar.cn)

 <b>Warning:</b>
<b>Choking hazard: This product contains small parts, not suitable for children under the age of three.</b>

**The manual contains important information,  
please keep it properly.**