

Remote Controller User Manual

ZC-3

Thank you for purchasing an AODELAN product.

AODELAN ZC-3 contains a Remote Controller and a Receiver. It was especially developed to wirelessly operate compatible Sony and Canon camcorders from a distance. By simply connecting the Receiver to the REMOTE or LANC terminal (2.5mm) on the camcorder and turning on the Remote Controller, you can easily operate many of the camcorder's functions wirelessly, such as controlling recording functions, adjusting the zoom, focus and iris. Wired control of these functions can also be achieved by connecting the Remote Controller directly to the camcorder with the supplied remote cable. Wired control and wireless remote control can be performed simultaneously to enable simultaneous operation of two camcorders.

Please read this user manual as well as the user manual provided with your camcorder which works with ZC-3 before use.

For your safety

Before using your product, please read the following safety precaution carefully to ensure correct and safe use.

- Do not disassemble or attempt to repair it.
- Do not use the product in the presence of flammable or explosive gas.
- The product is not dustproof, splashproof, nor waterproof. Make sure that no water, liquid, or dust can enter the product.
- Do not expose the product to hasty temperature changes in humid conditions as this could lead to condensation water in the unit.
- Do not expose the product to high temperature over 45°C (e.g. left in a car trunk).
- Do not use organic solvents such as alcohol, benzine or paint thinner to clean the product.
- Do not connect the product to camcorders or other devices that are not compatible.
- Do not overly tighten the clamp. Doing so may cause damage.

Declaration of Conformity USA and Canada

Product name: Remote Controller	Product name: Receiver
Trade name: AODELAN	Trade name: AODELAN
Model number: ZC-3 TX	Model number: ZC-3 RX
FCC ID: 2AEJW-ZC3	Manufacturer: Shenzhen Aodelan Technology Co., Ltd.
Manufacturer: Shenzhen Aodelan Technology Co., Ltd.	

FCC Statement

This equipment has been tested and found to comply with the limits for a Class B digital device, pursuant to part 15 of the FCC Rules. These limits are designed to provide reasonable protection against harmful interference in a residential installation. This equipment generates, uses and can radiate radio frequency energy and, if not installed and used in accordance with the instructions, may cause harmful interference to radio communications. However, there is no guarantee that interference will not occur in a particular installation. If this equipment does cause harmful interference to radio or television reception, which can be determined by turning the equipment off and on, the user is encouraged to try to correct the interference by one or more of the following measures:

- Reorient or relocate the receiving antenna.
- Increase the separation between the equipment and receiver.
- Connect the equipment into an outlet on a circuit different from that to which the receiver is connected.
- Consult the dealer or an experienced radio/TV technician for help.

Caution: Any changes or modifications to this device not explicitly approved by manufacturer could void your authority to operate this equipment.

This device complies with part 15 of the FCC Rules. Operation is subject to the following two conditions: (1) This device may not cause harmful interference, and (2) this device must accept any interference received, including interference that may cause undesired operation.

RF Exposure Information

The device has been evaluated to meet general RF exposure requirement. The device can be used in portable exposure condition without restriction.

CAUTION

RISK OF EXPLOSION IF BATTERY IS REPLACED BY AN INCORRECT TYPE. DISPOSE OF USED BATTERIES ACCORDING TO THE INSTRUCTIONS.

IC Warning

This device complies with RSS Gen of the Canada Rules. Operation is subject to the following two conditions:

- 1) this device may not cause interference and
- 2) this device must accept any interference, including interference that may cause undesired operation of the device.

Radiation Exposure: This equipment complies with Canada radiation exposure limits set forth for an uncontrolled environment.

Avertissement IC

Cet appareil est conforme aux règles RSS Gén du Canada. Le fonctionnement est soumis aux deux suivantes conditions:

- 1) cet appareil ne doit pas causer d'interférences et
- 2) cet appareil doit accepter toutes les interférences, y compris celles pouvant causer des effets indésirables fonctionnement de l'appareil.

Exposition aux radiations: Cet équipement est conforme à la réglementation canadienne sur les radiations. Limites d'exposition établies pour un environnement non contrôlé.

RED 2014/53/EU

Declaration of Conformity EC

Hereby, Shenzhen Aodelan Technology Co., Ltd. declares that this product is in compliance with essential requirements and other relevant provisions of Directive 2014/53/EU. This product can be used across EU member states. A copy of the Declaration of conformity can be found at www.aodelan.net.

Installing batteries to the Remote Controller

1. Loosen the clamp knob and turn the clamp so that it does not block the battery compartment cover.

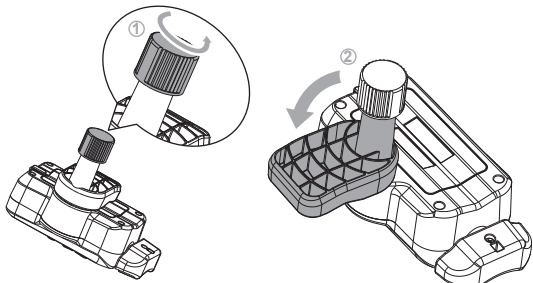

2. Open the cover and install two AAA 1.5V batteries (available separately) as shown.

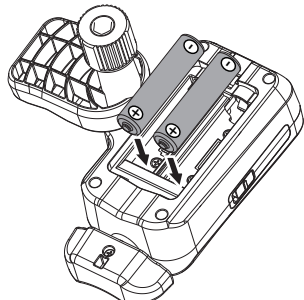

3. Close the cover. Press the cover until it snaps shut.

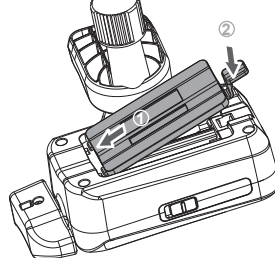

Connecting to a camcorder (Supports both wired and wireless connections)

- **Wired connection** – by connecting the Remote Controller to the camcorder with the supplied remote cable.

1. Loosen the clamp knob on the Remote controller as far as required to insert the pan handle on the tripod.

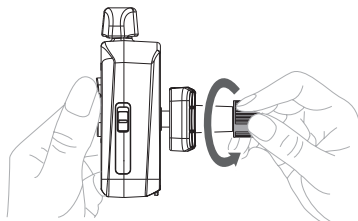

2. Align the center of the pan handle with the V groove on the clamp, and rotate the clamp knob in the opposite direction to lock it firmly.

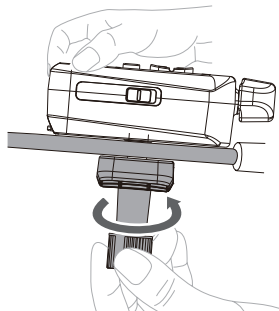

[Note]
Depending on the pan handle attached, the Remote Controller may make contact with the grip of the pan handle when it is in use. Set the Remote Controller a little apart from the grip.

3. Be sure the camcorder is turned off; insert one end of the remote cable into the Remote Controller's REMOTE jack and the other end into the camcorder's REMOTE or LANC terminal.

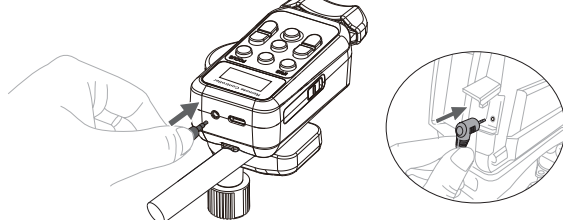

[Note]
Refer to the user manual of the camcorder for the location of the REMOTE or LANC terminal on the camcorder.

4. Turn on the camcorder and slide the switch on the side of the Remote Controller to "ON" position.

[Note]
When a plug icon is displayed on the Remote Controller's screen, it indicates that a wired connection has been established and you can operate the camcorder through the remote control.



- **Wireless connection** - by connecting the Receiver to the camcorder.

1. Be sure the camcorder is turned off; insert the plug of Receiver into the camcorder's REMOTE or LANC terminal.
2. Turn on the camcorder and slide the switch on the side of the Remote Controller to "ON" position.

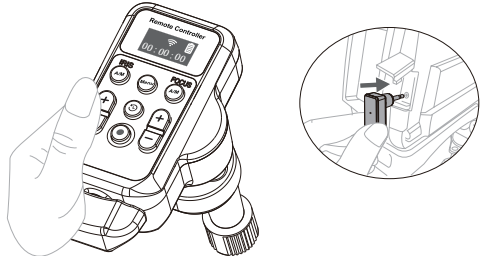

[Note]
When a wireless icon is displayed on the Remote Controller's screen, it indicates that a wireless connection has been established and you can wirelessly control the camcorder through the Remote Controller.



Setting the shooting state of the camcorder

For details, refer to the camcorder's user manual.

- Depending on the camcorder used, you may need to activate the remote controller using the camcorder's menu.
- Canceling automatic adjustment of the camcorder's shooting state.

[Note]

The switches used to turn on/off automatic adjustment of the shooting state on the camcorder varies depending on the camcorder (for example, FULL AUTO switch, AUTO/MANUAL switch).

- If using an interchangeable lens type camcorder with the supplied lens, set the focus ring to electronic control. If using a lens other than the supplied lens, focusing may not be supported from this unit.
- If the camcorder is an interchangeable lens type, set the IRIS switch on the lens to auto adjustment (AUTO).

Names of Parts and Their Functions

Remote Controller

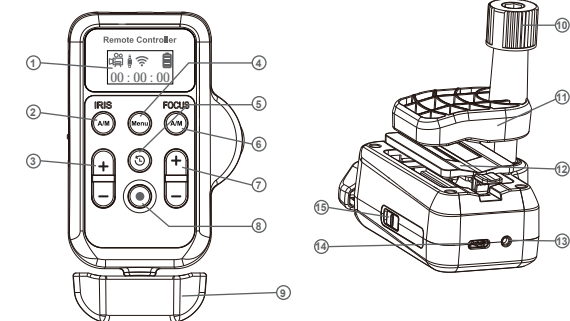

01. Screen

Displays the current status of the Remote Controller.

02. A/M(IRIS) key

Press to toggle auto iris adjustment on/off. When the Remote Control enters the setup menu, press the key to exit the menu.

03. Adjustment keys (left) “+”, “-”

When the iris mode is set to manual, press the two keys to adjust the iris. Press “+” to open the iris (decrease the iris value). Press “-” to close the iris (increase the iris value). When the Remote Control enters the setup menu, press the two keys to switch the selected item.

04. Menu key

Press to enter/exit the Remote Controller's setup menu.

05. Record review key

While in standby mode, press the key to review the last recorded clip* on the camcorder's screen, and then the camcorder will return to standby mode.

[Note]

Depending on the camcorder's recording review settings, it is also possible that the last several seconds of the clip* will be reviewed.

06. A/M (FOCUS) key

Press to toggle auto focus adjustment on/off. When the Remote Controller enters the setup menu, press the key to confirm the selected item.

07. Adjustment keys (right) “+”, “-”

When the focus mode is set to manual focus, press the two keys to adjust the focus. Press “+” to focus on distant subjects. Press “-” to focus on near subjects. When the Remote Control enters the setup menu, press the two keys to switch the selected item.

08. Record key

Press to start recording. To stop recording, press the record key again.

09. Zoom lever

Turn left/right to adjust the zoom.

[Note]

If the camcorder has a ZOOM switch, set it to SERVO or REMOTE mode.

10. Clamp knob

Rotate to lock/unlock the clamp.

11. Clamp

Used to attach the Remote Controller to the pan handle of tripod.

12. Battery compartment cover

Two AAA 1.5V batteries can be installed in the battery compartment.

13. REMOTE jack (Ø2.5mm stereo mini jack)

Connect to the camcorder with the supplied remote cable.

14. USB Type-C connector

Used for firmware update (when necessary). Go to www.aodelan.net to download the latest firmware update package for ZC-3, update your ZC-3 to the latest firmware according to the provided update files.

15. ON/OFF switch

ON: To turn on the Remote Controller.
OFF: To turn off the Remote Controller.

Receiver

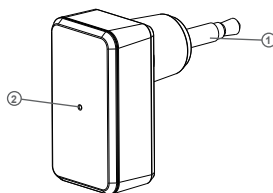

1. Plug (Ø 2.5mm)

Connect to the camcorder's REMOTE or LANC terminal. After the camcorder is turned on, the Receiver connected to the camcorder will automatically establish a wireless connection with the paired Remote Controller.

2. Status lamp

When the Receiver is connected to a camcorder that is powered on, the lamp indicates the wireless connection status of the Receiver and Remote Controller. Blinking green indicates that a wireless connection has been established with the Remote Controller.

Blinking red indicates that no wireless connection is established with a Remote Controller. (Now, you need to operate the Remote Controller to pair with the Receiver. Refer to the section [Menu setting functions] – [PAIR MODE].)

When the Receiver is not connected to a camcorder or the connected camcorder is powered off, the lamp goes off.

Screen of the Remote Controller

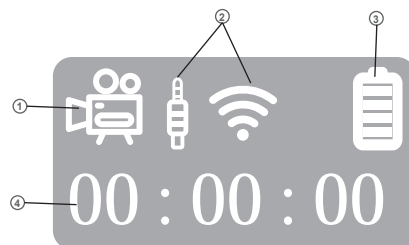

1. Recording indicator

Displays the icon when the camcorder is recording. Displays nothing in this area when recording stops.

2. Connection indicator

Displays a plug icon when a wired connection is established. Displays a wireless icon when a wireless connection is established. If both wired and wireless connections are established, then displays both and icons. Displays nothing in this area if no connection is established.

3. Battery level indicator

Indicates the battery level of the Remote Controller. If the icon (or) is displayed, it indicates the battery level is low (or extremely low), replace the batteries with new ones for the Remote Controller.

4. Timer

The timer starts when the camcorder starts recording. When recording stops, the timer displays 00 : 00 : 00. "00 : 00 : 00" indicates "hours : minutes : seconds" from left to right respectively.

Remote Controller's Menu Display and Settings

Enter the setup menu

1. Press Menu key to enter the Remote Controller's setup menu.
2. Setup menu operations.



- Move the selection arrow to the desired menu item by pressing the "+" / "-" adjustment keys.
 - Press the A/M (FOCUS) key (functions as "SET" at this point) to enter the setting of this menu item, and then press the "+" / "-" keys to select the desired sub-item.
 - Press the A/M (FOCUS) key (functions as "SET" at this point) to confirm the sub-item setting and return to the menu item for other settings.
3. To exit the menu, press the A/M (IRIS) key (functions as "EXIT" at this point) or press the Menu key.

Menu setting functions

ZOOM DIRECT – N, R

To change the rotation direction of the ZOOM lever.

- N (Normal): Turn the ZOOM lever to the right to zoom in (telephoto), and to the left to zoom out (wide angle).
- R (Reverse): Turn the ZOOM lever to the right to zoom out (wide angle), and to the left to zoom in (telephoto).

ZOOM SPEED – 1, 2, 3

To change the zoom speed.

- 1(Slow): In slow mode, the camcorder zooms at the slowest speed, regardless of how much the zoom lever is rotated.
- 2(Mid): In mid mode, the camcorder zooms quickly, depending on how much the zoom lever is rotated. (4 stages)
- 3(Fast): In fast mode, the camcorder zooms ever faster, depending on how much the zoom lever is rotated. (8 stages)

IRIS SPEED – 1, 2

To change the iris manual adjustment speed.

- 1(Slow): In slow mode, one pressing on the adjustment key (left) "+" or "-" will adjust the camcorder's iris by 1 stop.
- 2(Fast): In fast mode, one pressing on the adjustment key (left) "+" or "-" will adjust the camcorder's iris by 4 stops.

[Note]

The iris adjustment level obtained by pressing the adjustment key (left) "+" or "-" will vary depending on the camcorder being used.

FOCUS SPEED – 1, 2, 3

To change the focus manual adjustment speed.

- 1(Slow): In slow mode, press the adjustment key (right) "+" or "-", the camcorder adjusts the focus slowly.
- 2(Mid): In mid mode, press the adjustment key (right) "+" or "-", the camcorder adjusts the focus at a faster speed.
- 3(Fast): In fast mode, press the adjustment key (right) "+" or "-", the camcorder adjusts the focus at the fastest speed.

[Note]

The focus adjustment level obtained by pressing the adjustment key (right) "+" or "-" will vary depending on the camcorder being used.

SLEEP – OFF, 10M, 1H, 4H

To set the auto-sleep of the Remote Controller.

- OFF: Turn off the auto-sleep of the Remote Controller. If the ON/OFF switch is not slid to the OFF position, the Remote Controller will remain on until the battery runs out.
- 10M: The Remote Controller will go into sleep mode after 10 minutes of inactivity.
- 1H: The Remote Controller will go into sleep mode after 1 hour of inactivity.
- 4H: The Remote Controller will go into sleep mode after 4 hours of inactivity.

[Note]

Press any key to wake up the Remote Controller in sleep mode.

KEY B.L. – AUTO, ON, OFF

To control the key backlight of the Remote Controller.

- AUTO: The key backlight will light up for about 10 seconds if there is an operation on any key or on the zoom lever.
- ON: The key backlight is always on.
- OFF: The key backlight is always off.

PAIR MODE – Y

To set the Remote Controller to pair with the Receiver.

- Y: Press the A/M (FOCUS) key (functions as "SET" at this point) to confirm the setting; then the Remote Controller will enter pairing mode and automatically search for the Receiver and pair with it.

[Note]

After successful pairing, the status lamp on the Receiver blinks green.

RESET ALL – Y

Restore factory settings.

- Y: Press the A/M (FOCUS) key (functions as "SET" at this point) to confirm the setting; then all settings on the Remote Controller will be restored to the factory settings.

VERSION VX.X

The current firmware version of the Remote Controller.

Specifications

	Remote Controller	Receiver
Wireless frequency	2.4GHz	
Remote control range (Approx.)	50 m (164 ft.) (Open space without interference)	
Usage environment	Temperature: 0°C to 40°C (32°F to 104°F) Humidity: 80% or lower	
Dimensions (Approx.)	104x58x81mm (4.1x2.3x3.2 in.)	22x12.5x29mm (0.9x0.5x1.1 in.)
Weight (Approx.)	143 g (5.0 oz) (excluding battery and remote cable)	3g (0.1 oz)
Other	Connector: REMOTE jack (Ø2.5mm stereo mini jack) x1 USB Type-C connector x1 Screen: OLED screen, 0.96" Zoom lever: Support pressure-sensitive Power source: Two AAA 1.5V batteries Remote Cable (Ø2.5 - Ø2.5mm plug) x1, stretchable length up to 1m (3.3 ft.)	Plug: Ø2.5mm stereo mini plug Lamp: Green and red bi-color LED

Specifications and design are subject to change without notice.

"Sony" and "Canon" mentioned in the manual are protected trademarks which do not belong to Shenzhen Aodelan Technology Co., Ltd.

遥控器 ZC-3 使用说明书

感谢您购买AODELAN产品。

AODELAN ZC-3包含一个遥控器和一个接收器，专为远距离无线操作兼容的索尼和佳能相机而开发。只需将接收器连接到摄像机的REMOTE或LANC端子(2.5mm)，开启遥控器即可轻松无线操作摄像机的众多功能，例如控制录制功能，调整变焦、对焦和光圈。使用随附的遥控线将遥控器直接与摄像机连接，也可实现这些功能的有线控制。有线控制和无线遥控可以同时进行，以实现对两台摄像的同时操作。

使用前，请阅读本使用说明书以及与ZC-3搭配使用的摄像机随附的使用说明书。

安全须知

请在使用前仔细阅读“安全须知”，并以正确的方法使用。

- 请勿试图自行拆开或进行维修。
- 请勿在有可能起火、爆炸的场所使用本产品。
- 本产品不防尘、不防溅也不防水。确保不会有水、液体或灰尘进入本产品。
- 不要将产品暴露在温度快速变化的潮湿条件下，因为在这种情况下装置中会形成冷凝水。
- 请勿将产品放置在超过45°C的高温环境下，比如汽车后备箱内。
- 请勿使用酒精、汽油或油漆稀释剂等有机溶剂清洁产品。
- 请勿将本产品与不兼容的摄像机或其他设备相连。
- 请勿过度拧紧夹钳。这样做可能会造成损害。

使用前准备

给遥控器安装电池

1. 拧松夹钳旋钮，转动夹钳使之不会挡住电池舱盖。

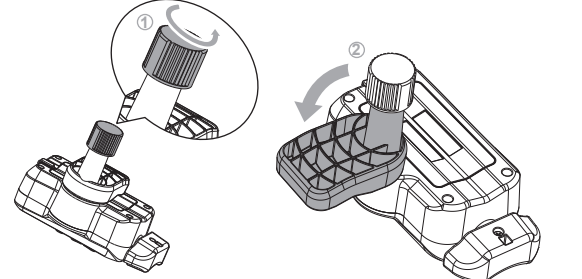

2. 打开舱盖，按图中所示装入两节AAA 1.5V电池（另行选购）。

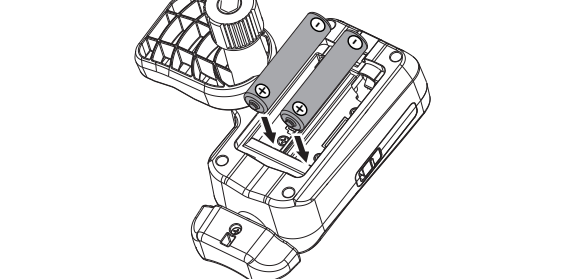

3. 盖上舱盖。按下舱盖直至其锁闭。

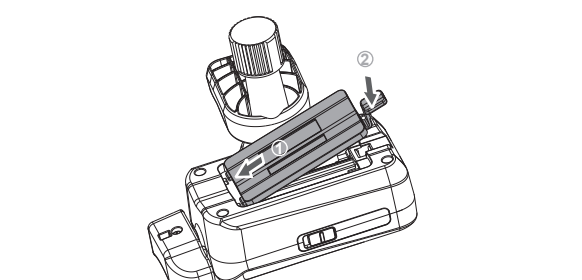

连接摄像机（支持有线、无线两种连接方式）

- **有线连接** - 通过随附的遥控线将遥控器连接到摄像机。

1. 拧松遥控器上的夹钳旋钮直至可以插入三角架的遥控器。



2. 将遥控杆的中心与夹钳上的V形凹槽对齐，然后反方向旋转夹钳旋钮将其锁紧。

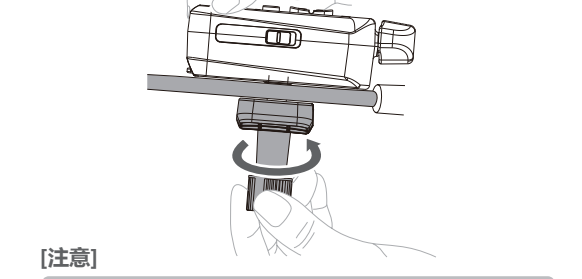

[注意] 根据所安装的遥控器，遥控器在使用时可能会触碰到遥控器上的手把。将遥控器与手把稍微分开。

3. 确保摄像机已关机；将遥控线的一端插入遥控器的REMOTE插孔，另一端插入摄像机的REMOTE或LANC端子。

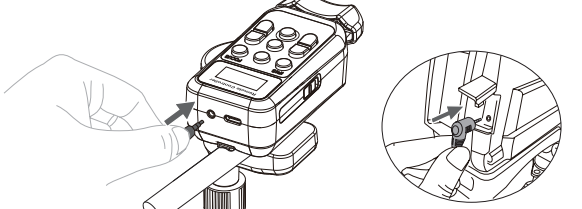

[注意] 关于摄像机上的REMOTE或LANC端子位置，请参阅摄像机的使用说明书。

4. 开启摄像机并将遥控器侧面的开关滑到ON位置。

[注意] 当遥控器的屏幕上显示插头图标时，表示已建立有线连接，可通过遥控器对摄像机进行操作。



- **无线连接** - 通过将接收器连接到摄像机。

1. 确保摄像机已关机；将接收器上的插头插入摄像机的REMOTE或LANC端子。
2. 开启摄像机并将遥控器侧面的开关滑到ON位置。

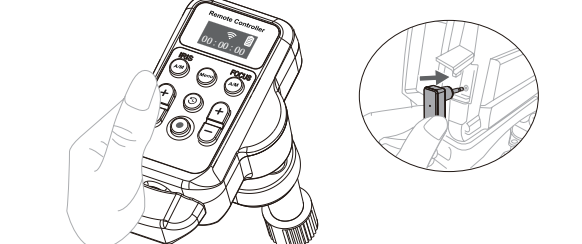

[注意] 当遥控器的屏幕上显示无线图标时，表示已建立无线连接，可以通过遥控器对摄像机进行无线遥控。



设置摄像机的拍摄状态

有关详细信息，请参阅摄像机的使用说明书。

- 视使用的摄像机而定，可能需要使用摄像机的菜单激活遥控器。
- 取消摄像机拍摄状态的自动调整。

[注意] 视摄像机而定，用于打开/关闭摄像机上拍摄状态的自动调整的开关有所不同（例如，FULL AUTO开关、AUTO/MANUAL开关）。

- 如果在可互换镜头的摄像机上使用随附的镜头，将对焦环设为电子控制。如果使用除随附镜头以外的镜头，本机可能不支持对焦。
- 如果摄像机是可互换镜头类型，针对镜头将IRIS开关设置为自动调整(AUTO)。

部件名称及其功能

遥控器

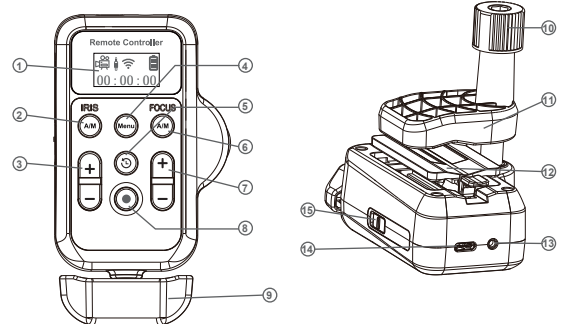

1. 屏幕

显示遥控器当前的状态。

2. A/M (IRIS)键

按此键可在打开/关闭自动光圈调整之间切换。当遥控器进入设置菜单时，按此键可退出菜单。

3. 调整键(左)“+”，“-”

当光圈模式设为手动时，按这两个键可调整光圈。按“+”可扩大光圈（减小光圈值）。按“-”可缩小光圈（增大光圈值）。当遥控器进入设置菜单时，按这两个键可切换所选择的项目。

4. Menu 键

按此键可进入/退出遥控器的设置菜单。

5. 录制预览键

在STBY(待机)模式时，按此键可以在摄像机屏幕上回放最后记录的片段*，然后摄像机将返回到待机模式。

[注意] 取决于摄像机的录制预览设置，也可能是回放该片段*的最后几秒钟。

6. A/M (FOCUS)键

按此键可在打开/关闭自动对焦调整之间切换。当遥控器进入设置菜单时，按此键可确认所选择的项目。

7. 调整键(右)“+”，“-”

当对焦模式设为手动对焦时，按这两个键可调整对焦。按“+”可对焦远处的被摄体。按“-”可对焦近处的被摄体。当遥控器进入设置菜单时，按这两个键可切换所选择的项目。

8. 录制键

按此键可开始录制。要停止录制，再次按录制键。

9. 变焦杆

向左/向右转动以调整变焦。

[注意] 如果摄像机有ZOOM开关，将此开关设置为SERVO或REMOTE模式。

10. 夹钳旋钮

旋转可锁紧/松开夹钳。

11. 夹钳

用于将遥控器安装到三脚架的遥控器上。

12. 电池舱盖

电池舱内可装入两节AAA 1.5V电池。

13. REMOTE插孔（Ø2.5mm，立体声迷你插孔）

通过随附的遥控线与摄像机连接。

14. USB Type-C接口

用于固件升级(需要时)。进入www.aodelan.net下载ZC-3的最新固件升级包，并根据其提供的升级文件将您的ZC-3升级到最新固件。

15. ON/OFF 开关

ON: 开启遥控器。
OFF: 关闭遥控器。

接收器

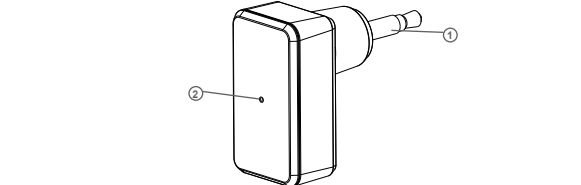

1. 插头(Ø 2.5mm)

连接至摄像机上的REMOTE/LANC端子。在摄像机开机之后，与摄像机连接的接收器将会自动与已配对的遥控器建立无线连接。

2. 状态指示灯

接收器连接至开机状态的摄像机时，此灯指示接收器与遥控器的无线连接状态。闪烁绿灯表示已与遥控器建立无线连接。闪烁红灯表示未与遥控器建立无线连接。(此时，需操作遥控器与接收器进行配对。请参考 [菜单设置功能] - [PAIR MODE] 章节。) 接收器未与摄像机连接或者连接的摄像机处于关机状态时，此灯熄灭。

遥控器屏幕

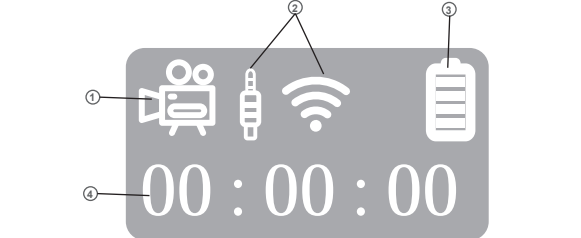

1. 录制指示

摄像机录制期间显示图标 。录制停止时，此区域无显示。

2. 连接指示

建立有线连接时显示插头图标 。建立无线连接时显示无线图标 。若有线和无线连接都有建立，则同时显示 和 两个图标。若无建立任何连接，此区域无显示。

3. 电量指示

指示遥控器的电池电量。若显示图标 (或者)，表示电量较低(或者极低)，请及时为遥控器更换为新电池。

4. 计时器

摄像机开始录制时，计时器开始计时。录制停止时，计时器显示为 00:00:00。“00:00:00”从左至右分别表示“小时:分钟:秒”。

遥控器的菜单显示和设置

进入设置菜单

1. 按Menu键进入设置菜单。
2. 设置菜单操作。



- 通过按“+”/“-”调整键将选择箭头 移动到所需菜单项目。
- 按A/M (FOCUS)键(此时功能为“SET(设置)”)进入此菜单项目的设置，然后按“+”/“-”键以选择所需的子项目。
- 按A/M (FOCUS)键(此时功能为“SET(设置)”)确认子项目设置并返回至菜单项目以进行其他设置。

3. 若要退出菜单，按A/M (IRIS)键(此时功能为“EXIT(退出)”)或者按Menu键。

菜单设置功能

ZOOM DIRECT – N, R

更改变焦杆的旋转方向。

- N (正常): 向右转动变焦杆可放大(长焦)，向左转动可缩小(广角)。
- R (反转): 向右转动变焦杆可缩小(广角)，向左转动可放大(长焦)。

ZOOM SPEED – 1, 2, 3

更改变焦速度。

- 1(慢速): 在慢速模式下，无论变焦杆被旋转多少，摄像机都以最慢的速度变焦。
- 2(中速): 在中速模式下，根据变焦杆的旋转程度，摄像机快速变焦。(4个级别)
- 3(快速): 在快速模式下，根据变焦杆的旋转程度，摄像机以更快的速度变焦。(8个级别)

IRIS SPEED – 1, 2

更改光圈手动调整速度。

- 1(慢速): 在慢速模式下，按一下调整键(左)“+”或者“-”可将摄像机的光圈调整1个档位。
- 2(快速): 在快速模式下，按一下调整键(左)“+”或者“-”可将摄像机的光圈调整4个档位。

[注意] 通过按调整键(左)“+”或“-”获得的光圈调整级别会因正在使用的摄像机而不同。

FOCUS SPEED – 1, 2, 3

更改对焦手动调整速度

- 1(慢速): 在慢速模式下，按调整键(右)“+”或“-”，摄像机缓慢调整对焦。
- 2(中速): 在中速模式下，按调整键(右)“+”或“-”，摄像机以较快的速度调整对焦。
- 3(快速): 在快速模式下，按调整键(右)“+”或“-”，摄像机以最快的速度调整对焦。

[注意] 通过按调整键(右)“+”或“-”获得的对焦调整级别会因正在使用的摄像机而不同。

SLEEP – OFF, 10M, 1H, 4H

设置遥控器的自动休眠

- OFF: 关闭遥控器的自动休眠。如果ON/OFF开关没有滑到OFF位置，遥控器会一直处于开启状态直至电池耗尽。
- 10M: 遥控器在闲置10分钟后将会进入休眠状态。
- 1H: 遥控器在闲置1小时后将会进入休眠状态。
- 4H: 遥控器在闲置4小时后将会进入休眠状态。

[注意] 按任意键都可以唤醒处于休眠状态的遥控器。

KEY B.L. – AUTO, ON, OFF

控制遥控器的按键背光

- AUTO: 如有操作任何按键或者操作变焦杆，按键背光将亮起约10秒。
- ON: 按键背光始终亮起。
- OFF: 按键背光始终关闭。

PAIR MODE – Y

设置遥控器与接收器进行配对

- Y: 按A/M (FOCUS)键(此时功能为“SET(设置)”)确认设置后，遥控器将进入配对模式，自动搜寻接收器并与之配对。

[注意] 配对成功后，接收器上的状态指示灯闪烁绿灯。

RESET ALL – Y

恢复出厂设置

- Y: 按A/M (FOCUS)键(此时功能为“SET(设置)”)确认设置后，遥控器上的所有设置将恢复到出厂设置。

VERSION VX.X

遥控器的当前固件版本。

规格

	遥控器	接收器
无线频率	2.4GHz	
遥控距离	约50米(空旷无干扰的环境)	
使用环境	温度: 0°C至40°C 湿度: 80%或更低	
尺寸(约)	104x58x81mm	22x12.5x29mm
重量(约)	143g(不含电池和遥控线)	3g
其他	接口: REMOTE插孔(Ø2.5mm, 立体声迷你插孔) x1 USB Type-C接口 x1 屏幕: OLED屏, 0.96" 变焦杆: 支持压力感应 电源: 2节AAA 1.5V电池 遥控器: (Ø2.5-Ø2.5mm 插头) x1,可拉伸至1米长	插头: Ø2.5mm, 立体声迷你插头 指示灯: 绿红双色LED

规格和设计如有变更，恕不另行通知。本说明书中所提到的“索尼”和“佳能”是受保护的商标，不属于深圳市奥德兰科技有限公司。