

Item No. 6681



Please retain this information

- * Specifications, colors and contents may vary from illustrations
- * Dispose of all packaging safely before giving the toy to your child.

R/C SUPER SPEED RACING HOVERCRAFT

PRODUCT FEATURES

- * Radio control Hovercraft - frequency: 49 mHz
- * Full function steering with forward/reverse, left/right turn
- * Super fast
- * Works on land, water & ice
- * Rear wheel suspension

BATTERY INFORMATION & INSTALLATION:

1) Transmitter

- slide open battery cover and insert a 9V/6F22 battery (not included) as picture A, following the correct polarities
- close the battery cover
- screw the antenna into the transmitter as picture B

2) Hovercraft

- remove the battery cover as picture C.
- connect the plug of the Hovercraft to the pack of rechargeable battery (included) as picture D
- place the pack of rechargeable battery properly in the battery compartment as picture E.
- close the battery cover and lock.
- turn on the power switch as picture F.
- now you are ready to play!

IMPORTANT

- * please charge the pack of rechargeable battery (included) before playing
- * connect the pack of rechargeable battery to the USB cable charger as picture G
- * plug-in the USB charger to a computer USB port for battery charging
- * charge cable will light-up during charging, and light-off automatically when charging is completed
- * charging time for 12V rechargeable battery: 8 hours for first charge, 5 hours for subsequent re-charge
- * running time of the Hovercraft: ~ 4 - 5 minutes
- * when Hovercraft starts to move slow, please re-charge the battery

(A)



(B)



(C)



(D)

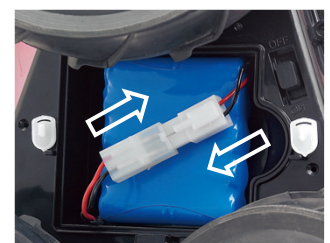

(E)



(F)

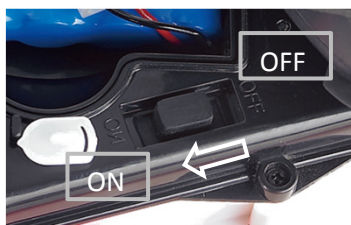

(G)

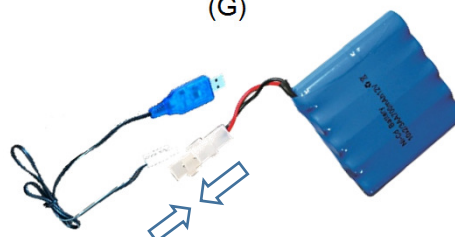

ACCESSORIES INCLUDED:



HOW TO OPERATE:

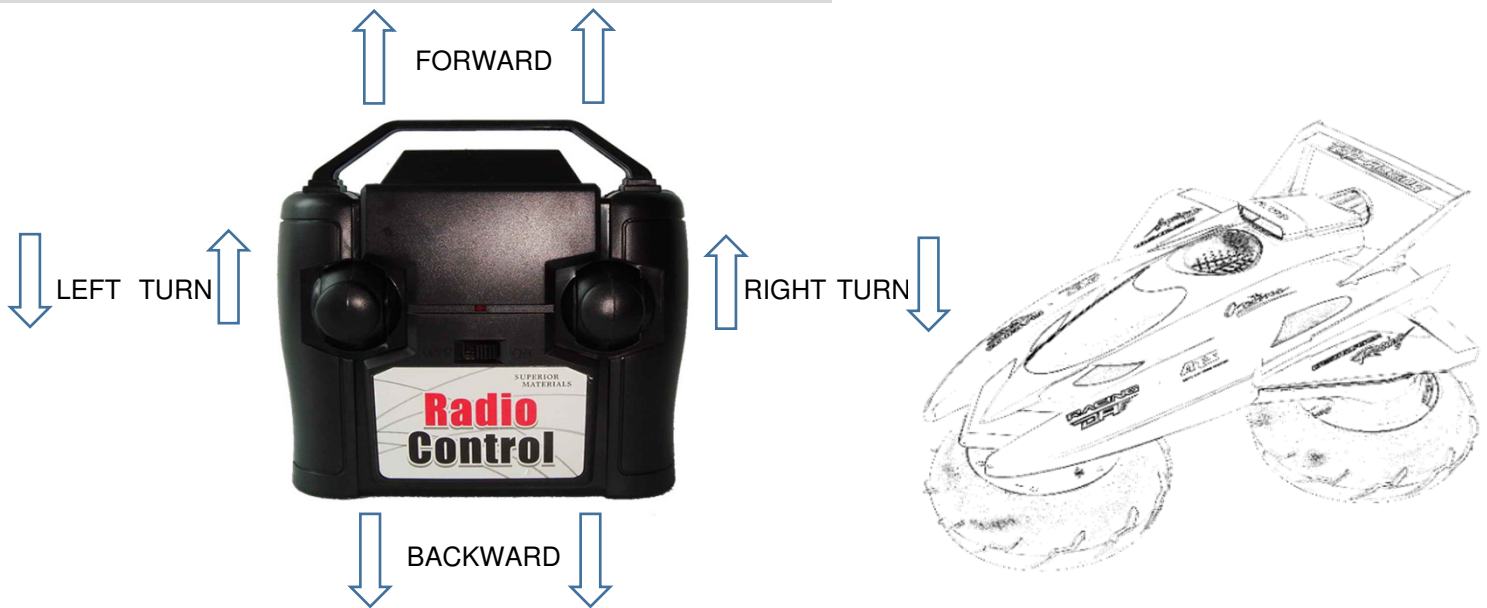

BATTERY SAFETY INFORMATION

IMPORTANT: Only adults should replace batteries

In exceptional circumstances batteries may leak that can cause chemical burn injury or ruin your product.

To avoid battery leakage:

- * Non-rechargeable batteries are not to be recharged.
- * Rechargeable batteries are to be removed from the product before being charged.
- * Rechargeable batteries are only to be recharged under adult supervision.
- * Do not mix alkaline, standard (carbon-zinc), or rechargeable batteries.
- * Do not mix old and new batteries.
- * Only batteries of the same or equivalent type as recommended to be used.
- * Batteries are to be inserted with the correct polarity.
- * Exhausted batteries are to be removed from the product.
- * The supply terminals are not to be short-circuited.
- * Dispose of battery(ies) safely.
- * Do not dispose this product in a fire. The batteries inside may explode or leak.

This device complies with Part 15 of the FCC Rules. Operation is subject to the following two conditions:

(1) this device may not cause harmful interference, and

(2) this device must accept any interference received, including interference that may cause undesired operation.

WARNING:

Changes or modifications not expressly approved by the party responsible for compliance could void the user's authority to operate the equipment.

NOTE:

This equipment has been tested and found to comply with the limit for a class B digital device, pursuant to Part 15 of the FCC Rules. These limits are designed to provide reasonable protection against harmful interference in a residential installation. This equipment generates, uses and can radiate radio frequency energy and, if not installed and used in accordance with the instruction, may cause harmful interference to radio communications. However, there is no guarantee that interference will not occur in a particular installation. If this equipment does cause harmful interference to radio or television reception, which can be determined by turning the equipment off and on, the user is encouraged to try to correct the interference by one or more of the following measures:

- * Reorient or relocate the receiving antenna.
- * Increase the separation between the equipment and receiver.
- * Connect the equipment into an outlet on a circuit different from that to which the receiver is connected.
- * Consult the dealer or an experienced radio/TV technician for help.

MADE IN CHINA



another great product by

Synergistic