

# Quick start guide

Make sure your device is compatible. MYNT requires smart phones with Bluetooth 4.0. This includes Apple iPhone 4S and later, iPad Mini and later, iPad 3rd generation and later with iOS 7 or later, and Android phones and tablets with Android 4.3 and later with Bluetooth® Low Energy (BLE).

2

## Setup your MYNT

- A** Get things ready  
On your phone, turn the Bluetooth "On" and remove the battery insulation plastic.
- B** Start to scan your MYNT  
Follow the on-screen instructions to connect MYNT to the app. Put your

1

## Download and Install MYNT

You can choose from one of the following three methods:

- A** Google play / Apple App Store  
Search the App Store or Google Play for MYNT, look for the icon, as seen below.  

- B** Scan the barcode at the back of the package  
Scan the barcode on the back of the package based on your smart phone - either iOS or Android. It will guide you to download and install MYNT App automatically.
- C** From our official website  
Visit our official website: "<http://mynt.slightech.com>" to download app for your device. The Mac remote control app is only available here.

2

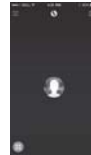
MYNT next to your phone. On the main screen of the app, press the user icon in the center to search MYNT.



- C** Start to connect your MYNT  
Once your MYNT is detected, you should see a MYNT icon with "+" on it. If so, press the MYNT icon to continue. Otherwise, check the Bluetooth connection on your phone.  
*Note: When you see there is a "+" on MYNT icon, it means you need to connect MYNT with your devices by pressing it.*



- D** Confirm connection with your phone  
When the on-screen instruction asks to press the button on MYNT, use your fingernail to press the center of the button of the LED light location

3

## How to use your MYNT

- A** Alarm when losing MYNT  
Your phone will alarm when MYNT is outside of the alarm range that you

2

for a short click. You should hear a click, which indicates the button is pressed.

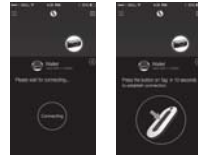

- E** Choose use scenarios  
We have several pre-defined use scenario profiles that you can choose, which will help you setup your MYNT quickly. If your scenario is not listed, or you want to specify your own alarm settings, you can tap the customize icon to setup your own preference.



4

## Find your MYNT

- A** Alarm when losing MYNT  
Check the main screen of the MYNT app. If the MYNT icon is not greyed out, that means the MYNT is nearby and still connected to your phone. You can tap the MYNT icon to let your MYNT beep and flash (the LED light). Follow the beep sound and the flash to locate your MYNT.
- B** MYNT radar  
The distance between the MYNT icon and the user icon indicates the relative distance between your MYNT and phone. So, you can use it as an indicator to move closer to your phone.
- C** Clear the alarm  
Once you find your MYNT, either tap the MYNT icon in the app again or use your fingernail to click the LED portion of the button on MYNT to stop the MYNT from beeping.

3

set in the app or when the Bluetooth signal is lost.  
*Note: The distance shown in the app is calibrated in an open space. When you are indoors or there are obstacles between MYNT and your phone, such as human body, walls, tables, bags, the Bluetooth signal will be weaker; therefore, it could trigger the alarm in a much shorter distance.*

- B** Notification on phone  
Make sure you do not set your phone in the silence mode; otherwise, you will not hear the phone alarm. You will still receive alarm notification in such a case.

4

**D Find your phone**

If you cannot find your phone, you can use MYNT to locate it. Use your fingernail to long press (>2 seconds) the LED portion of the button on MYNT, your phone will alarm, even your phone is in Silent mode. This only works when the Bluetooth connection between your phone and MYNT is on. Long press it again to dis-arm your phone.

*Note 1: If you see that the LED light on MYNT flashes twice after you press the button on MYNT, that means your MYNT has lost the connection to your phone.*

*Note 2: You can close your MYNT app, it will still work in the background, but do not kill the app; otherwise, you will not get alarm when losing.*

5

**MYNT as remote shutter and music remote control****A Configure the functions of MYNT button**

There are three operations of MYNT button: Click, Double Click and Triple Click. You can assign functions as your own preference for each of your MYNT: Remote shutter, Play / Pause music playing, Play next song, Play previous song.

5

**B Launch extended functions**

Tap the extended function icon (shown below) on the home screen, it will show the extended functions, such as Remote camera and Music. Tap the function icon to launch it.

**C Quick launch functions**

For iPhone and iPad you have to launch MYNT app and enter the extended function mode before you can use MYNT as the controller. For Android phones you can launch the function you assigned right after you unlock your phone. For example, if you have assigned single click to "Remote shutter" on your Android phone, you just unlock your phone, and then click the MYNT button, the camera UI will launch automatically.

*Note: When you launch "Remote camera" function in MYNT App, you can*

5

*always use single click to shoot pictures no matter what function single click is assigned to.*

6

**How to change battery****A Battery life and ordering the new battery**

The battery in MYNT lasts up to 1 year depending on your usage. Before your MYNT is running out of battery, you will be alerted in the MYNT app. Simply follow the instructions in the app to order new battery and replace the battery.

**B Change battery**

There is a locking plug on MYNT to lock/unlock the battery holder. To replace the battery you need to unlock the battery holder by toggling the plug to the other side, as shown in the diagram below. Taking the battery holder out is a little bit tricky. For more details please check the demo video on our website.

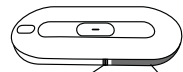

Plug Battery holder

Toggle left: Unlock

Toggle right: Lock

7

**MYNT Mac App****A Connect your MYNT**

Press the MYNT Mac app icon (shown below) to expand menu. MYNT app will start to scan for MYNT devices automatically, and list them by distance (The farthest left is the closest). Select your device and follow the same procedure to complete connection.

*Note: MYNT can connect to only one device, when you want to change the device that MYNT is connected to, you will need to disconnect first.*

**B Change mode**

After completed connection, there are four modes: Keynote & PPT, Music, Customization 1 & 2. Press the icon to select the functions you want.

**FCC Compliance Statement**

This equipment has been tested and found to comply with the limits for a Class B digital device, pursuant to part 15 of the FCC Rules. These limits are designed to provide reasonable protection against harmful interference in a residential installation. This equipment generates uses and can radiate radio frequency energy and, if not installed and used in accordance with the instructions, may cause harmful interference to radio communications. However, there is no guarantee that interference will not occur in a particular installation. If this equipment does cause harmful interference to radio or television reception, which can be determined by turning the equipment off and on, the user is encouraged to try to correct the interference by one or more of the following measures:

- Reorient or relocate the receiving antenna.
- Increase the separation between the equipment and receiver.
- Connect the equipment into an outlet on a circuit different from that to which the receiver is connected.
- Consult the dealer or an experienced radio/TV technician for help.

This device complies with part 15 of FCC rules. Operation is subject to the following two conditions:

- (1) This device may not cause harmful interference, and (2) this device must accept any interference received, including interference that may cause undesired operation.

This device complies with FCC radiation exposure limits set forth for an uncontrolled environment.

**Caution!**

Any changes or modifications not expressly approved by the party responsible for compliance could void the user's authority to operate the equipment.