



Wireless Power By  Gill Electronics

## INSTALLATION INFORMATION FOR INSTALLERS

### WIRELESS POWER TRANSMITTER (THROUGH SURFACE)



Model Number: WPT503CM

## IMPORTANT – PURPOSE OF DOCUMENT

THIS DOCUMENT IS FOR USE ONLY BY ORIGINAL EQUIPMENT MANUFACTURERS (OEMs) WHO PURCHASE THE REFERENCED TESLINK™ COMPONENTS FROM GILL ELECTRONICS, INCORPORATED OR ITS AFFILIATES (GILL). NEITHER THIS DOCUMENT NOR THE INFORMATION IN THIS DOCUMENT IS INTENDED FOR DISTRIBUTION TO, OR USE BY, END USERS OF OEM PRODUCTS WHICH INCORPORATE TESLINK™ COMPONENTS (END USERS). BY PURCHASING TESLINK™ COMPONENTS FROM GILL, EACH OEM ASSUMES, AND SHALL HAVE SOLE AND FULL RESPONSIBILITY FOR, PROVIDING APPROPRIATE INSTRUCTIONS FOR USE OF SUCH OEM PRODUCTS.

GILL ASSUMES THAT ALL OEMs WHO PURCHASE FROM GILL AND WHO USE THIS DOCUMENT HAVE EXPERTISE IN THE USE OF ELECTRICAL DEVICES AND COMPONENTS, INCLUDING THE EXPERTISE NECESSARY TO (i) DETERMINE WHETHER OR NOT TESLINK™ COMPONENTS ARE SUITABLE FOR USE WITH THE OEM's PRODUCT, AND (ii) PROPERLY AND SAFELY CONFIGURE AND INSTALL TESLINK™ COMPONENTS. ACCORDINGLY, THIS DOCUMENT IS INTENDED ONLY AS A HELPFUL SUPPLEMENT FOR USE BY THE OEM AND NOT AS A SUBSTITUTE FOR THE OEM's EXPERTISE OR THE OEM's RESPONSIBILITY FOR PROPER AND SAFE DESIGN OF ITS PRODUCT AND INSTALLATION AND USE OF TESLINK™ COMPONENTS. IF ANY OEM USING THIS DOCUMENT LACKS SUCH EXPERTISE OR DOES NOT AGREE TO THE FOREGOING LIMITED PURPOSE STATED FOR THIS DOCUMENT, SUCH OEM SHOULD IMMEDIATELY NOTIFY GILL IN WRITING TO THAT EFFECT AND SHOULD NOT USE THIS DOCUMENT. PRICES AND OTHER TERMS AND CONDITIONS FOR SALE OF TESLINK™ COMPONENTS TO ANY OEM ARE GOVERNED BY SEPARATE DOCUMENTS ISSUED OR MADE AVAILABLE TO THE OEM BY GILL, INCLUDING THE INVOICE ISSUED BY GILL AND THE STANDARD TERMS AND CONDITIONS OF SALE.

# SAFETY INFORMATION

GILL EXPECTS THAT THE INSTALLER WILL INCLUDE APPROPRIATE SAFETY WARNINGS AND INFORMATION FOR END USERS OF ALL PRODUCTS WHICH INCORPORATE TESLINK™ COMPONENTS. SUCH WARNINGS AND INFORMATION MUST INCLUDE THOSE SET FORTH BELOW AND OTHER WARNINGS AND INFORMATION AS THE INSTALLER DETERMINES NECESSARY AND APPROPRIATE.

## DANGER

### To reduce the risk of electrical shock:

- Always unplug the appliance from the electrical outlet before removing
- Do not reach for an appliance that has fallen into water – unplug it immediately
- Do not disassemble or modify any part of this appliance
- Do not install this product in any ferrous, non-ferrous, or electrically conductive surface

## WARNING

### To reduce the risk of burns, fire, electrical shock, or injury to persons:

- This product should not be used by children or persons with disabilities that may hinder their ability to understand all product information and use the product safely. Close supervision is necessary when this product is used near children or persons with disabilities
- Use this product only for its intended use as described in this manual
- Never operate this product if it has a damaged housing, cord, plug cable, or if wet
- Keep cord away from heated surfaces and liquid
- Do not operate where aerosol products are being used or oxygen is being administered
- This product is designed for indoor use only. Do not install or use this product outdoors
- Do not use this appliance with an extension cord or overloaded electrical outlet
- Do not place or leave metallic objects between the charging surface and device being charged
- This product should be kept a minimum of 35mm from all animate objects when in power transfer mode/charging mode.

## IMPORTANT SAFETY INSTRUCTIONS

- 1. SAVE THESE INSTRUCTIONS** – This manual contains important safety and operating instructions for resonant chargers  
Models: WPT503CM
- 2.** Before using the resonant charger, read all instructions and cautionary markings on the resonant charger, power supply, and product using the resonant charger
- 3. CAUTION** – To reduce damage or risk of injury, charge only A4WP/ Rezence-certified products.

# FCC & INDUSTRY CANADA COMPLIANCE

The installer shall inform end users of the following to the extent applicable:

This device complies with FCC/IC radiation exposure limits set forth for an uncontrolled environment and meets the FCC radio frequency (RF) Exposure Guidelines and RSS-102 of the IC radio frequency (RF) Exposure rules. This transmitter must not be co-located or operating in conjunction with other antenna or transmitter.

Changes or modifications not expressly approved by Gill Electronics, Incorporated could void the user's authority to operate the equipment.

This equipment has been tested and found to comply with the limits for a Class B digital device, pursuant to Part 15 of the FCC Rules. These limits are designed to provide reasonable protection against harmful interference in a residential installation. This equipment generates, uses, and can radiate radio frequency energy, and, if not installed and used in accordance with the instructions, may cause harmful interference to radio communications. However, there is no guarantee that interference will not occur in a particular installation. If this equipment does cause harmful interference to radio or television reception, which can be determined by turning the equipment off and on, the user is encouraged to try to correct the interference by one or more of the following measures:

- Reorient or relocate the receiving antenna/device
- Increase the separation between the equipment and receiver
- Connect the equipment into an outlet on a circuit different from that to which the receiver is connected
- Consult the dealer or an experienced radio/TV technician for help

This Class B digital apparatus complies with Canadian ICES-001-V4.

## EUROPEAN DECLARATION OF CONFORMITY

We, Gill Electronics, Incorporated, 5271 Plainfield Ave. NE. Grand Rapids, MI 49525, USA, declare under our sole responsibility that the product **Wireless Power Transmitter - WPT503CM T** to which this declaration relates is in conformity with the following standard(s) or other normative document(s):

**EN 55011**

**EN 300 328**

**EN 300 330**

**EN 301 328**

**EN 301 489**

**EN 609501**

**EN 61000-6-1**

**EN 62311**

**EN 60950**

Following the provisions of Electromagnetic Compatibility, R&TTE Emissions, and Safety directive(s).

The Technical Construction File is maintained at:

**Gill Electronics Inc.**

**5271 Plainfield Ave. NE**

**Grand Rapids, MI 49525 USA**

# SAFETY CONSIDERATIONS for INSTALLERS

The Installer is solely responsible for taking all steps necessary and appropriate for safe and proper installation of Teslink™ products.

Safety is dependent on a proper installation of a Teslink™ transmitter. The Installer should be properly trained and qualified for installation. The Installer should read and fully understand this document prior to installation. The installer must have a good understanding of electrical procedures and systems, along with proficiency in the installation and service of commercial and residential work surfaces. There are no adjustments required at any time of the electrical components within the transmitter.

***Installers should not open the transmitter housings or make modifications to the Teslink™ transmitter or components unless expressly approved in writing by an authorized representative of Gill Electronics, Incorporated. Any changes or modifications will void the product warranty.***

## During Installation

- **DO NOT** connect this charger to an electrical outlet until:
  1. **ALL** other electrical connections are made
  2. Mounting of **ALL** components is complete
  3. **VERIFICATION** that no short circuit exists in the entire system
  4. **VERIFICATION** that transmitter is mounted in such a location and manner that no animate object, can in a normal manner of contact, come within 44mm of the bottom of a transmitter. (i.e. a transmitter mounted in a desk would be far enough away from the edge that if a person was sitting in a chair their thighs/knees would not be positioned with 44mm of the bottom of the transmitter). See ensuing illustrations for more details.
  5. Ensure installation in a horizontal surface only.
- **DO NOT** install equipment or route wiring cords in the path of any walkways or moving components
- **BEFORE** drilling into the work surface, make sure that the equipment has no metal objects or structures within 1" around (XY) and within 2" below (Z).
- When drilling into the work surface, **DO** make sure that both sides of the surface are clear of anything that could be damaged
- The charging area on top of the work surface/furniture must be indicated in some manner

## After Installation

- Test the transmitter to ensure that it is working properly (see LED Indicator Light)
- File these instructions in a safe place and refer to them when performing maintenance or re-installing

***WARNING: Failure to follow all safety precautions and instructions may result in death, serious injury, or property damage. The installer assumes sole responsibility for such precautions and instructions and for any failure to follow them.***

## Disclaimer

By proceeding with installation of Teslink™ components in products, the installer agrees that: (i) Gill is not liable under any theory of contract, tort law, or otherwise for any loss, damage, death, personal injury, special, incidental, or consequential damages, or any other damage of any nature arising directly or indirectly from or relating to the improper installation or use of Gill products or components in residential or office furniture or any other application; and (ii) the installer will defend, indemnify, protect, and hold harmless Gill and each of its affiliates, officers, directors, agents, and employees from and against any such liability, claims, injuries, losses, and damages. In order to safely install and use Gill products and components, full consideration of the work environment (e.g., location of electrical wiring, support members, surface thicknesses, and other electrical and structural components) is required. Gill disclaims responsibility for improper use or installation of products or components and use or installation not consistent with the original manufacturer specifications and recommendations (if any) for such products or components.

## Warranty Information

Neither this document nor the statements in this document create any warranties, express or implied, regarding Teslink™ products. All information regarding any warranties made by Gill to the purchaser of components is located in separate documentation provided by

Gill to the Installer. Gill makes no other warranties and specifically disclaims any express or implied warranties of merchantability or fitness for purpose. No warranty shall extend to any person other than the Installer who purchases the Teslink™ product from Gill.

## CERTAIN PRE-INSTALLATION CONSIDERATIONS

The installer is solely responsible for taking all steps necessary and appropriate for safe and proper installation of Teslink™ components.

These steps include, without limitation, the following:

### **Instruction and Personnel**

The installer should use only properly trained and qualified personnel for installation. The installer should assure that all such personnel read and fully understand this document prior to installation.

See ensuing installation drawing and installation illustrations for detailed requirements.

## INSTALLATION INSTRUCTIONS

Before discarding any packaging materials, check the Teslink™ shipping carton and verify the following items are included:

- (1) Teslink™ Transmitter



WPT503CMFN

- (1) Power Supply

#### BEFORE INSTALLATION:

1. BE SURE THE TRANSMITTER IS AT LEAST 1 FOOT (12 INCHES) FROM ANY OTHER TRANSMITTER.
2. BE SURE THE WORK SURFACE IS NON-METAL.  
"METAL" REFERS TO FERROUS AND NON-FERROUS METALS (STEEL, ALUMINUM, COPPER, STAINLESS STEEL, NICKEL, ETC.)
3. BE SURE THAT THE POWER CHORD WILL BE ABLE TO REACH THE TRANSMITTER AFTER THE TRANSMITTER HAS BEEN INSTALLED.
4. BE SURE THE WORK SURFACE IS BETWEEN 19 AND 30 MM THICK (0.75 AND 1.18 INCHES)

#### RECOMMENDED INSTALLATION METHODS AND STEPS:

1. SCREWS (RECOMMENDED)
  - A. VERIFY SCREW LENGTH AND SIZE
  - B. PLACE FLAT SURFACE OF TRANSMITTER AGAINST THE BOTTOM OF WORK SURFACE
  - C. SCREW FOUR (4) SCREWS INTO WORK SURFACE USING PLACEMENT HOLES
2. ADHESIVE
  - A. VERIFY THAT ADHESIVE CAN HOLD TRANSMITTER WEIGHT
  - B. PLACE ADHESIVE ON FLAT SURFACE OF TRANSMITTER
  - C. SECURE TRANSMITTER TO BOTTOM OF WORK SURFACE
3. DOUBLE SIDED TAPE
  - A. VERIFY THAT TAPE CAN HOLD TRANSMITTER WEIGHT
  - B. PLACE TAPE ON FLAT SURFACE OF TRANSMITTER
  - C. SECURE TRANSMITTER TO BOTTOM OF WORK SURFACE

#### AFTER INSTALLATION:

1. CONNECT POWER USING THE PROVIDED POSITIVE RETENTION CONNECTOR ON TRANSMITTER AND POWER CHORD PROVIDED.  
DISCONNECT POWER BY PRESSING TAB DOWN ON CONNECTOR AND PULLING.
2. CHECK COLOR OF LED LIGHTS UNDER DEVICE  
FLASHING GREEN - STANDBY MODE  
SOLID GREEN - CHARGING MODE  
RED - ERROR (SEE MANUAL)
3. KEEP METALS AT LEAST 1 INCH FROM SIDES AND 2 INCHES FROM BOTTOM OF TRANSMITTER  
"METAL" REFERS TO FERROUS AND NON-FERROUS METALS (STEEL, ALUMINUM, COPPER, STAINLESS STEEL, NICKEL, ETC.)

#### NOTES:

1. ALL DIMENSIONS IN MM
2. INSTALLER DRAWING, NOT FOR QUALITY PURPOSES

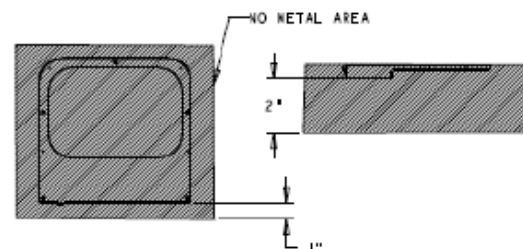
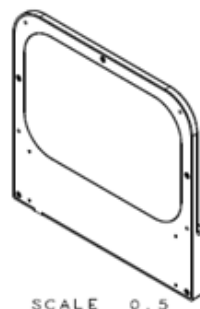
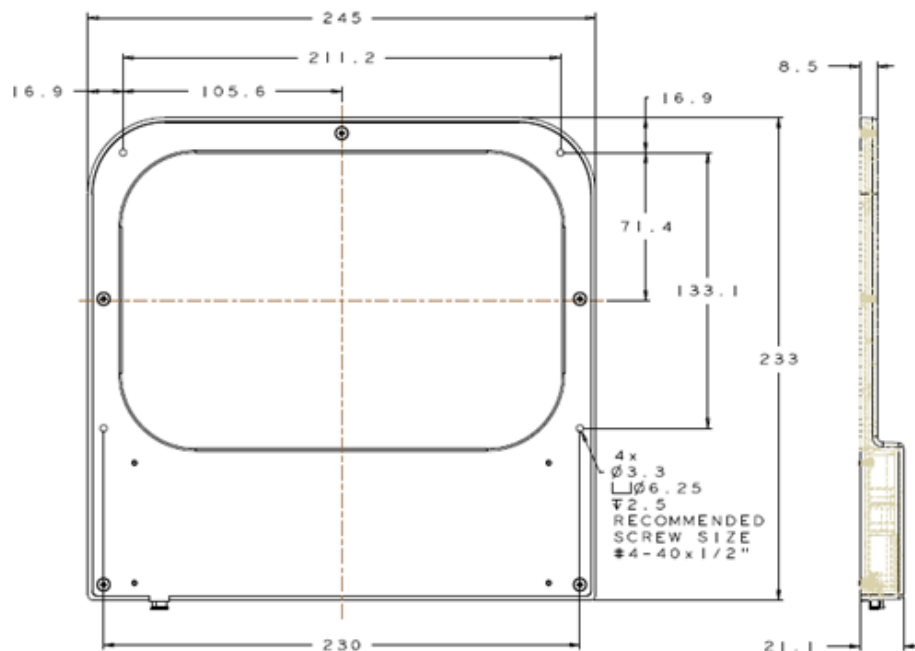

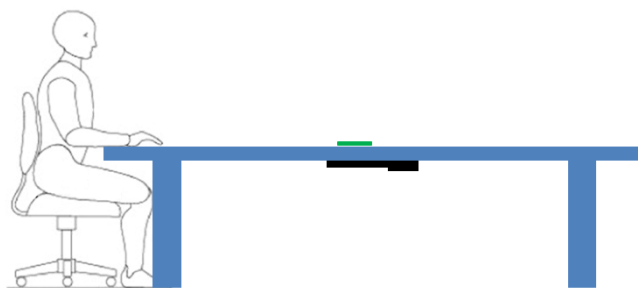

Side View (not to scale)

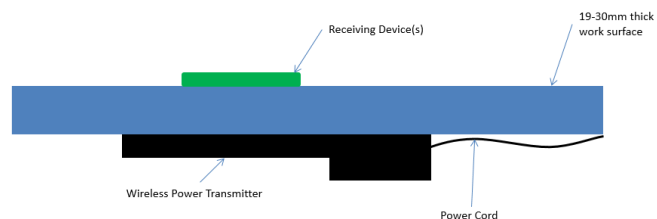

Expanded view (not to scale)

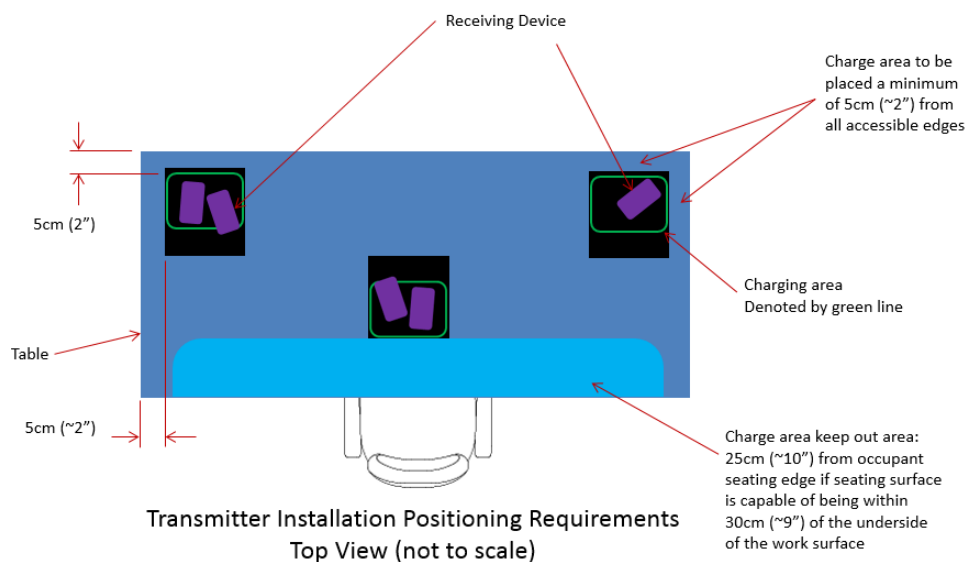

## POWER SUPPLY INFORMATION

This Teslink™ Through Surface Transmitter is supplied with a power supply having the following specifications:

Output Voltage: 36VDC 1.25A

Input Voltage: 100 – 240VAC 50-60Hz

Operating Temperature: 0°C - +70°C

Country of Origin: China

**IMPORTANT** – Under no circumstances should the installer use or supply the end user with a power supply that was not originally provided with the Teslink™ product.

Gill Electronics package graphics and other marks are trademarks of Gill Electronics Inc. All other brand names are trademarks of their respective owners. Gill Electronics Inc. is not affiliated with the respective owners of their trademarks. Teslink™ is a trademark of Gill Electronics Inc. All rights reserved.