

TECKNET

M003 Wireless Mouse



Note:
German and French language user manuals can be downloaded from our website: www.tecknet.co.uk.

Welcome

Thank you for purchasing this TeckNet product. To ensure optimum performance and safety, please read these instructions carefully before operating the product. It is strongly recommended you keep this manual for future reference.

Product Layout

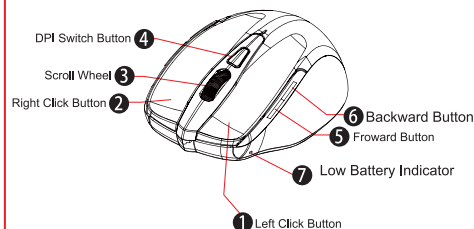

System Requirements

To use this mouse, your computer must meet the following hardware requirements and run one of the operating systems listed below.

Hardware

- PC with a Pentium processor or equivalent AMD processors
- USB 2.0

Operating System

- Windows 2000, 2003, XP, Vista, Win7, Win8, Win8.1, Win10

Note: The scroll wheel only works under the operating systems listed above. If you use the mouse under a different operating system, the mouse may either not work or lose its enhanced features.

01

Technical Specifications

Button Count:	5 buttons
Operating Frequency:	2.4GHz
Number of Channels:	34
Resolution:	1000/1500/2400DPI
Receiver interface:	USB version 2.0
Operating Voltage:	3.0V
Operating Current:	5.5 mA
Distance:	up to 15m

Package Contents

- 1 x Cordless Mouse
- 1 x USB Nano Receiver
- 1 x User Manual
- 1 x Warranty Card

Note: Batteries NOT included

24-Month Battery Life

The mouse consumes little power and offers a long battery life of up to 24 months without changing battery. However please note that the actual battery life may vary based on user and computing conditions.

Product Introduction

Battery Installation

The RF 2.4GHz optical mouse uses two AAA battery (Battery is not included).

1. Open the battery cover.
2. Insert the batteries into the compartment, ensuring they correspond with the polarity marking.
3. Replace the battery cover.
4. Switch on the mouse by adjusting the power switch underneath the mouse. The red LED of the power indicator at the top of the mouse will flash.

Note: Make sure that the polarity of the batteries is correct. The positive (+) and negative (-) ends of each battery must match the positive (+) and negative (-) markings in the battery housing.

02

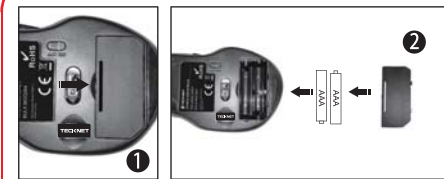

Receiver Connection

Remove the USB Nano receiver and plug it into a free USB port in your computer. Turn on the mouse. The Plug & Play function of your system will detect a new device has been connected and install it automatically.



Note: The receiver can be removed and stored next to the battery compartment while not in use.



Take out the receiver

Store the receiver

03

Intelligent Power Saving (IPS)

The mouse is equipped with Intelligent Power Saving (IPS) function.

- When the USB Nano receiver is disconnected or the PC is switched off, the mouse will be switched off automatically for the purpose of power-saving.
- When your mouse is not operated around 10 seconds, it will automatically drop to the first level of IPS. To wake the mouse, move the mouse.
- When your mouse is not operated for 8 minutes, it will automatically drop to the second level of IPS. To wake the mouse, move the mouse.

DPI Switch

The mouse supports 2400DPI, 1500DPI and 1000DPI. To switch to either setting, press the DPI button.

- The default setting is 1000DPI.
- Short press the DPI button on the top of the mouse once to switch from 1000DPI to 1500DPI.
- Short press the DPI button on the top of the mouse once again to switch from 1500DPI to 2400DPI.
- Short press the DPI button on the top of the mouse once again to switch from 2400DPI to 1000DPI.



DPI Switch

Low Power Indicator

The mouse is equipped with low power indicator. When the battery power gets low during the period of use, the low power indicator will flash to remind you replace the battery.

Note: We recommend you use AAA alkaline dry cell battery.



Low Power Indicator

04

Reconnection

The Mouse and Nano Receiver may need to be reconnected if subjected to high temperature, electromagnetic fields or strong vibrations.

1. Ensure the battery voltage is correct; if the voltage is low, replace the batteries.
2. Press the right button and middle button (under the scroll wheel) simultaneously (Do not release both buttons until you have completed step 3);
3. Plug the USB Nano receiver into a free USB port of your computer within 15 seconds.
4. Then release both buttons.

Attention

1. To maximize battery life, it is recommended you use the mouse on a white or light colour surface.
2. If not used, the mouse will drop into auto-sleeping mode around 10 seconds. Press any key or scroll wheel to activate the mouse.
3. Do not use the mouse on a glass or mirrored surface, as these surfaces will cause the mouse to fail temporarily.
4. The mouse might not work smoothly on some special surfaces, such as smooth, dark or black, reflecting and 3D mouse pads surfaces.
5. Avoid using the mouse on a metal surface. Metals, such as iron, aluminium or copper, shield the radio frequency transmission and may slow down the mouse presenter's response time or cause the mouse to fail temporarily.
6. If your PC has a metal case that contains aluminium or magnesium, use the mouse to the side. The display panel may interfere with the radio frequency signal if you use the mouse directly in front of the PC.
7. Please remove the batteries if you are not going to use it for a prolonged period of time (several weeks or months).

Note on handling batteries

- Keep batteries out of the reach of children.
- Replace old or weak batteries promptly.
- Remove the batteries if the mouse is not going to be used.

05

Safety Measures

- Keep the mouse away from young children.
- Any attempt to disassemble, adjust or repair the mouse may result in exposure and other safety hazards.

Troubleshooting

What do I do if the mouse does not work?

- Make sure that the polarity of the batteries is correct. The positive (+) and negative (-) ends of each battery must match the positive (+) and negative (-) markings in the battery housing.
- Make sure the batteries are not discharged.
- Please try to remove the batteries, and reinstall the batteries again.
- Verify that your computer's power management features is turned off.
- Check that the Nano receiver's USB connector is firmly attached to the USB port of your computer.

The USB Nano receiver is recognized by Windows (Windows2000, 2003, XP, Vista, Win7, Win8, Win8.1, Win10) but the cursor does not move.

- Check whether the low power indicator on the top of the mouse lights up. If the sensor lights up, it is likely that the batteries are discharged. Please replace them.

- If replacing the batteries does not help, it is likely that the mouse is not connected to the receiver. Please try reconnection and ensure that the mouse is within the optimal operational working distance (1.5m) from its USB Nano receiver.

Disclaimer

Every effort has been made to ensure that the information and procedures in this guide are accurate and complete, no liability can be accepted for any errors or omissions and we reserve the right to make any changes without further notice to any products mentioned herein.

Warranty

We warrant that product from authorised distributors will meet the applicable product specifications and be free from all defects in design, assembly, material and workmanship. Please contact TeckNet retailers, or visit our website for more information about the product.

06

TECKNET

TeckNet
P.O. BOX 122
Liverpool
L9 7WQ
www.tecknet.co.uk

This device complies with Part 15 of the FCC Rules. Operation is subject to the following two conditions: (1) This device may not cause harmful interference, and (2) this device must accept any interference received, including interference that may cause undesired operation. Caution: Changes or modifications not expressly approved by the party responsible for compliance could void the user's authority to operate the equipment.

NOTE: This equipment has been tested and found to comply with the limits for a Class B digital device, pursuant to part 15 of the FCC Rules. These limits are designed to provide reasonable protection against harmful interference in a residential installation. This equipment generates uses and can radiate radio frequency energy and, if not installed and used in accordance with the instructions, may cause harmful interference to radio communications. However, there is no guarantee that interference will not occur in a particular installation. If this equipment does cause harmful interference to radio or television reception, which can be determined by turning the equipment off and on, the user is encouraged to try to correct the interference by one or more of the following measures:

- Reorient or relocate the receiving antenna.
- Increase the separation between the equipment and receiver.
- Connect the equipment into an outlet on a circuit different from that to which the receiver is connected.
- Consult the dealer or an experienced radio/TV technician for help.