

P E T K I T

FRESH ELEMENT SOLO
I N S T R U C T I O N M A N U A L

Please read the User Manual carefully before using the product and keep it properly.

| TABLE OF CONTENTS

User warning	3
User safety guide	3,4
List of components	5
Product summary	6,7
Quick start guide (device setup)	8
Quick start guide (opening the lid and adding food)	9
Using the app	10
Indication light	11
Cleaning the device	12,13
FAQ	14
Basic specifications	15

| USER WARNING

- Thank you for choosing to purchase the PETKIT Fresh Element SOLO Smart Pet Feeder. PETKIT works hard to make a better life for you and your pets through the implementation of science and technology.
- Before using, please carefully read the User Manual for this device. Installing and using this device means you have read and accepted the safety guidelines listed below.
- PETKIT is not responsible, nor does it accept any legal responsibility, for any accidents or losses caused by improper use of this device.
- PETKIT reserves the rights to interpret and modify this notice.

| USER SAFETY GUIDE

- * Failure to follow the safety guide outlined below may result in device malfunction or other unexpected accidents.
- Only setup and use the device as instructed in the User's Manual.
- This device is not recommended for pets younger than 3 months.
- Please only use device indoors. Please do not use the device in the place where the sun can shine, which will affect the function of the device; Please keep away from the fire.
- This device only uses a small amount of power. However, it may still leak power if pets chew on the wire. Please guide your pets to use it correctly.
- Only use the provided power adapter. Otherwise, you may damage the device or cause a risk to safety.
- Please make sure the device is placed on a level surface. Do not overturn the device, or it may not function properly.

| USER SAFETY GUIDE

- Do not drop all items except dry pet food into the food storage container, or the device will not function properly, and it may even endanger the safety of the pet.
- In order to prevent your pet from overturning this device, we recommend placing it in a corner or against a wall.
- To prevent the device from falling down and injuring your pet or damaging property, please do not place this device in an elevated location.
- Do not allow the device to get wet.
- If you stop using the device, make sure to remove the battery and unplug the power adapter, and please clean and dry the device before storing.
- Please remove the power cord before moving the device.
- Children should only be allowed to operate this device under the supervision of an adult.
- In order to avoid unnecessary damage or injury, only repair technicians should be allowed to repair this device.
- If you need to go out, please check the battery in the battery compartment to make sure the battery has sufficient charge (this device only uses an alkaline battery).
- If you encounter any problems operating this device, please contact customer service at 400-087-0203.

| LIST OF COMPONENTS

*Before setting up your device, please make sure you have all the necessary parts.

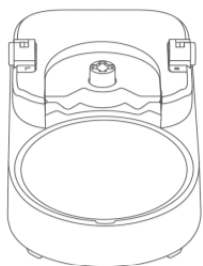

Main unit *1



Stainless steel
food bowl *1

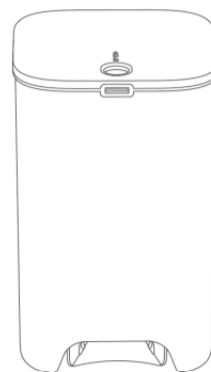

Food storage
container *1

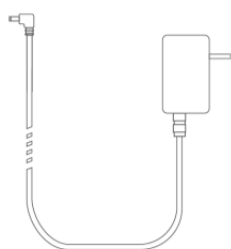

Power adapter *1



Desiccant *1



User manual *1

| PRODUCT SUMMARY

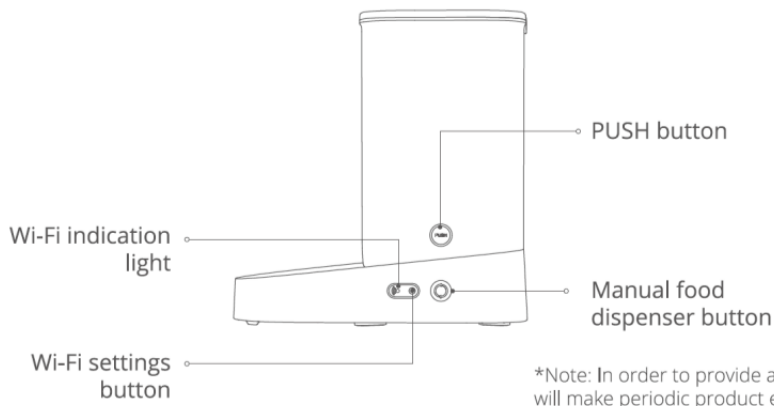
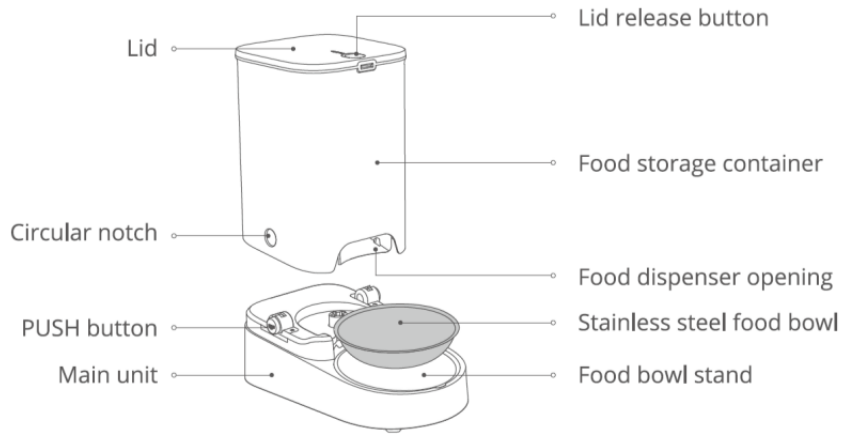

*Note: In order to provide a better product, we will make periodic product enhancements. If the illustrations do not match what you see on the device, please refer to the device as standard.

| PRODUCT SUMMARY

Bottom

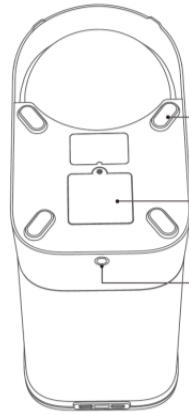

Main unit anti-slip pads

Battery cover

Power adapter port

Silicone food
dispenser paddles



**Interior of the
food storage
container**

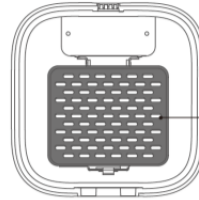

Desiccant
compartment

**Interior of
the lid**

QUICK START GUIDE (DEVICE SETUP)

(*When installing your device, make sure there is no food already in the food storage container.)

1 Connect the power adapter

Take out the power adapter cord and attach it to the power adapter port on the bottom of the main unit.

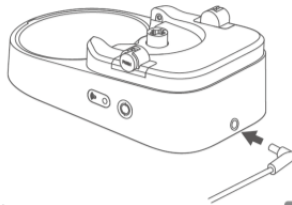

2 Install the main unit

1. Place the main unit on a level surface.
2. Press and hold the PUSH buttons, and place the circular notches on both sides of the food storage container downward toward the PUSH buttons until the PUSH buttons are fully stuck into the circular notches. (as shown in the figure below)
3. Take the stainless steel food bowl and place it in the food bowl stand.



* Install the backup batteries.

(If you want to install batteries, you will need to buy the batteries separately.)

(*Before installing batteries, make sure there is no food in the food storage container.)

1. Take out the screw and remove the battery cover.
2. Take 5 AAA batteries and place them in the battery compartment. (Pay attention to the orientation of the positive and negative ends)
3. Put the battery cover back on and tighten down the screw.

*We strongly recommend checking and replacing the batteries before leaving the device unattended for an extended period of time. Always replace batteries that have a low charge. (Only use alkaline batteries)

Bottom

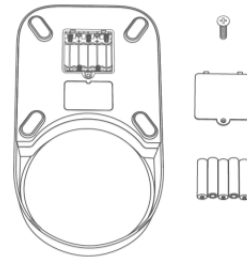

QUICK START GUIDE (OPENING THE LID AND ADDING FOOD)

1 Open the lid

Use your thumb to press down on the lid release button and slide the lid in the OPEN direction as indicated in the illustration below, lift the lid at the same time.

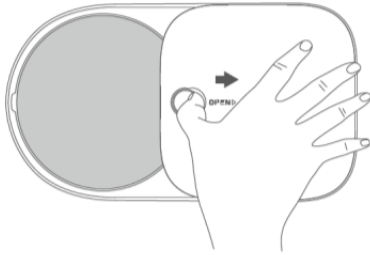

2 Insert desiccant

Open the desiccant compartment, take the desiccant packet, and lay it down evenly in the compartment. Then close the desiccant compartment.

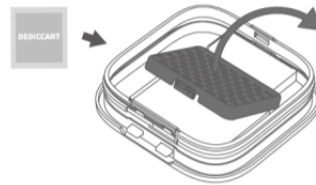

3 Add pet food

1. Add pet food. (do not exceed the MAX line)
2. Close the lid: Notch the back of the lid into the two holes located at the top of the food storage container, then press the front of the lid down.

*It is suggested that the size of dry pet food should be no bigger than 12mm.



Self-Check Chart: Size of Pet Food Pellets

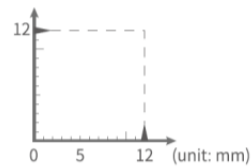

Dry pet food or freeze-dried pellet size should be below 12 mm.

| USING THE APP

1 Connect the App

Download the PETKIT App and complete your registration via the App. Go to the App's main page and follow the instructions to add the Petkit Smart Feeder SOLO and connect your device.



Scan the QR Code to download the PETKIT App

2 Use the App to remotely control food dispensing

Using the App, you can set a feeding schedule. The pet feeder will automatically dispense food each day based on your settings. When your pet has eaten, you will receive a notification. This can help you better control when your pet eats and how much they eat each time.

3 Manual feeding

Hold down on the manual food dispenser button to dispense food. Release the button to stop dispensing food.

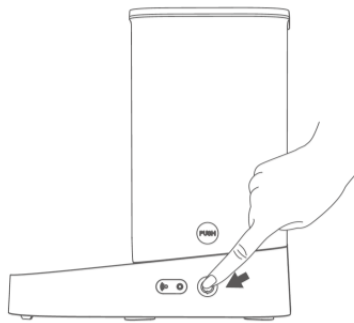

| INDICATION LIGHT

Wi-Fi Indication Light	Status
Blinking slowly	Device is offline, there is no internet connection
Blinking quickly	Device is connecting to the Wi-fi
On (constant)	Device is connected to the internet
Off	Indicates the wi-fi indication light has been turned off

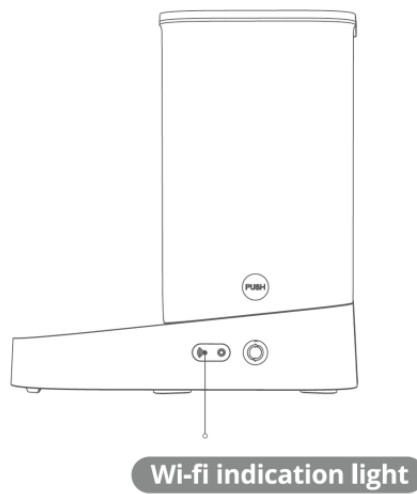

| CLEANING THE DEVICE

1. Open the lid and remove the desiccant packet.
 2. Take off the food storage container and place the feeder on a level surface. Press down on the PUSH button on one side, and at the same time lean the container toward the other side and slide it off.
 3. Remove the stainless steel food bowl.
 4. Clean each component one at a time, starting with the food storage container (including the food dispenser paddles inside), the lid, and the stainless steel food bowl. We recommend using an appropriate amount of soap when cleaning, then rinsing and drying the components after you are done.
- * Remember that the main unit cannot get wet.

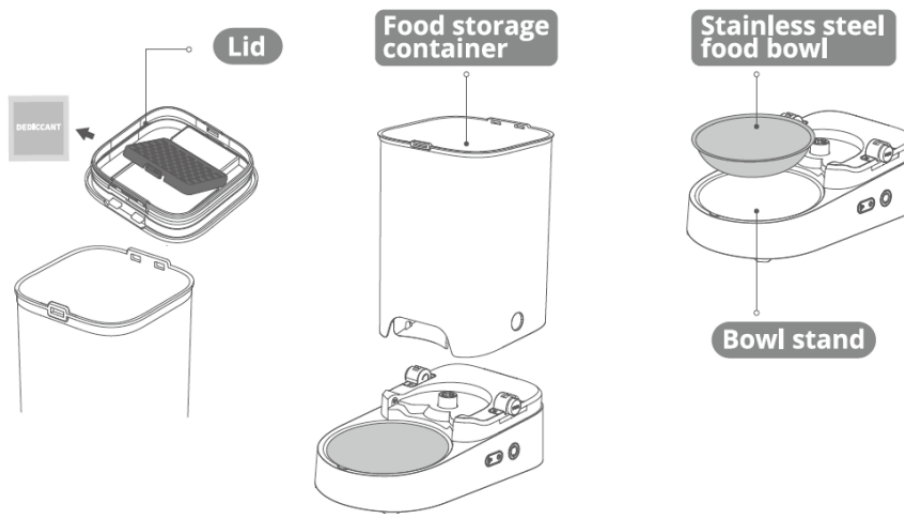

| CLEANING THE DEVICE

5. After cleaning and drying, reinstall each component in the correct order, starting with the food storage container, then the lid, then the stainless steel food bowl. (Make sure each component is completely dry before reinstalling)

*When installing the food storage container, if you are unable to get it to lock into place, try rotating the food dispenser paddles until the PUSH button snaps into place in the circular notches in the food storage container. (see Illustration 1 below)

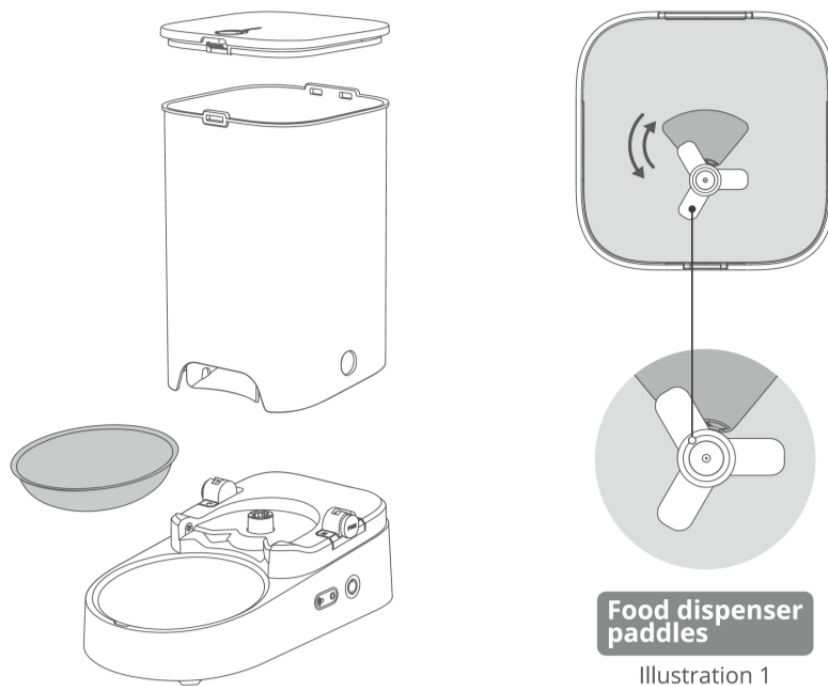

| FAQ

I. The Feeder SOLO is offline:

That the feeder loses connection to your home's router will cause the device get offline. Possible causes for this problem include:

1. The power supply of the feeder was disconnected. If it happens, your router will not work and your Feeder will switch to battery power. If there are no batteries installed, then your device will cease working until power is restored. Before the batteries die, the Feeder will operate normally. However, the App will be unable to connect to your device. Records of feeding during this time will be labeled as "unknown". (Note: once the internet connection is restored, you will only be able to update a maximum of 10 feeding records, and during this time you will be unable to adjust the feeding schedule.)
2. The internet in your home was disconnected (this can be caused by a number of reasons, such as your internet provider cutting service). If this happens, the feeder will continue to operate as normal, but the App will not be able to track your feeder's status. Any feeding logs from this period will be marked as "unknown". (Note: After the connection to the internet is restored, you will only be able to update a maximum of 10 feeding logs, and at during this time you will be unable to adjust the feeding schedule.)

II. The Feeder SOLO is not dispensing food correctly:

The feeder uses fixed volume to determine the servings of food it dispenses. Each serving is approximately 10g. The actual weight of each serving is affected by the size and density of the food pellets. When the food storage container is full, each serving is relatively consistent in weight. In most cases, you can adjust the amount dispensed in your settings. When the food level is low, the portion size may shrink. Please make sure there is always enough food in the food storage container.

| BASIC SPECIFICATIONS

Product name	Petkit Fresh Element SOLO Smart Pet Feeder
Product code	P570
Product dimensions (mm)	167mm*296mm*316mm
Recommended for	For cats and small breed dogs
Total weight of product	1.32kg
Wireless Connection	Wi-Fi
Rated voltage	6VDC
Rated power	6W/1000 mA

This device complies with part 15 of the FCC Rules. Operation is subject to the following two conditions:

(1) This device may not cause harmful interference, and ; (2) this device must accept any interference received, including interference that may cause undesired operation.

FCC warning:

Any Changes or modifications not expressly approved by the party responsible for compliance could void the user's authority to operate the equipment.

Note: This equipment has been tested and found to comply with the limits for a Class B digital device, pursuant to part 15 of the FCC Rules. These limits are designed to provide reasonable protection against harmful interference in a residential installation. This equipment generates uses and can radiate radio frequency energy and, if not installed and used in accordance with the instructions, may cause harmful interference to radio communications. However, there is no guarantee that interference will not occur in a particular installation. If this equipment does cause harmful interference to radio or television reception, which can be determined by turning the equipment off and on, the user is encouraged to try to correct the interference by one or more of the following measures: -Reorient or relocate the receiving antenna.-Increase the separation between the equipment and receiver.

- Connect the equipment into an outlet on a circuit different from that to which the receiver is connected.
- Consult the dealer or an experienced radio/TV technician for help.

The device has been evaluated to meet general RF exposure requirement.

This equipment complies with FCC radiation exposure limits set forth for an uncontrolled environment. This equipment should be installed and operated with minimum distance 20cm between the radiator & your body.

IC warning

- English:

This device complies with Industry Canada licence-exempt RSS standard(s). Operation is subject to the following two conditions: (1) This device may not cause interference, and (2) This device must accept any interference, including interference that may cause undesired operation of the device.

- French:

Le présent appareil est conforme aux CNR d'Industrie Canada applicables aux appareils radio exempts de licence. L'exploitation est autorisée aux deux conditions suivantes:

(1) l'appareil ne doit pas produire de brouillage, et

(2) l'utilisateur de l'appareil doit accepter tout brouillage radioélectrique subi, même si le brouillage est susceptible d'en compromettre le fonctionnement.