

# PETKIT

## FRESH ELEMENT 3 INSTRUCTION MANUAL

Please read the User Manual before using this product and store the User Manual in an appropriate place.

### TABLE OF CONTENTS

User warning	1
User safety guide	1, 2
List of components and parts	3
Product summary	4, 5
Quick setup (device setup)	6
Quick setup (opening top lid and adding food)	7, 8
Using the App	9
Indication lights	10
Cleaning the device	11, 12, 13
Installation guide	14, 15
FAQ	16
Basic specifications	17
Harmful substances	17



Note: This User Manual can be used for the 3L and 5L versions of the PETKIT Fresh Element 3 Smart Pet Feeder. Each is operated in the same way. This User Manual uses the 3L version as an example.

### USER WARNING

- Thank you for purchasing the PETKIT Fresh Element 3 smart Pet Feeder. PETKIT works hard to improve the lives of pet owners and pets alike through the use of technology.
- Before using, please carefully read the User Manual. By setting up or using the device, you agree that you have already read and accepted the safety guidelines listed below.
- PETKIT is not responsible, nor does it accept any legal responsibility for any accidents or losses caused by improper use of this device.
- PETKIT reserves the right to interpret and modify this notice.

### USER SAFETY GUIDE

- **Failure to follow the safety guide outlined below may result in device malfunction or other unexpected accidents.**
- Only setup and use the device as instructed in the User's Manual.
- This device is not recommended for pets younger than 3 months.
- Please only use indoors.
- This device only uses a small amount of power, however it may still leak power if pets chew on the wire. Please guide the cat to use it correctly.
- Only use the provided power adapter. Otherwise, you may damage the device or cause a risk to safety.
- Please make sure the device is placed on a level surface. Do not overturn the device, or it may not function properly.
- Do not drop all items except pet dry food into the food storage container, or the device will not function properly, and it may even endanger the safety of the pet.

### USER SAFETY GUIDE

- In order to prevent your pet from overturning this device, we recommend placing it in a corner or against a wall.
- When dispensing food, please do not obstruct the dispenser opening.
- It is forbidden to immerse or soak the main body of the device in water.
- If you plan on leaving this device unused and unpowered for long periods of time, use the power adapter to charge the device occasionally to avoid reducing the service life of lithium batteries.
- To avoid interfering with the scale function of the food bowl, do not place heavy items in the food bowl made of 304 stainless steel.
- Children should only be allowed to operate this device under the supervision of an adult.
- In order to avoid unnecessary damage or injury, only repair technicians should be allowed to repair this device.
- If you encounter any problems operating this device, please contact customer service at 400-087-0203.

### LIST OF COMPONENTS AND PARTS

\*Before setting up your device, please make sure you have all the necessary parts.

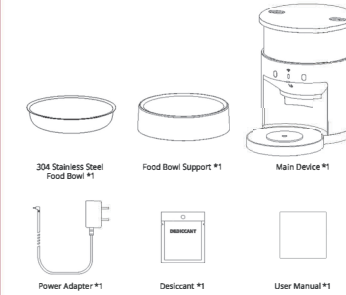

### PRODUCT SUMMARY

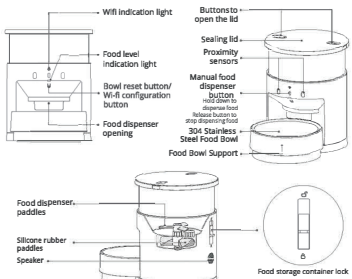

Note: In order to provide a better product, we will make periodic product enhancements. If the illustrations do not match what you see on the device, please refer to the device as standard.

### PRODUCT SUMMARY

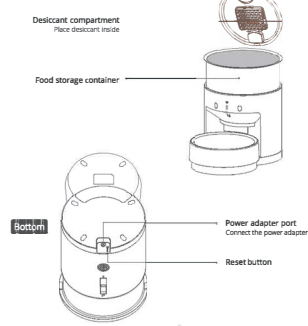

### QUICK SETUP (DEVICE SETUP)

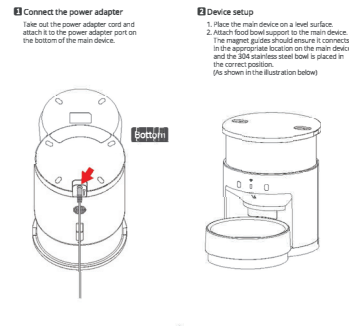

### QUICK SETUP (OPENING THE TOP LID AND ADDING FOOD)

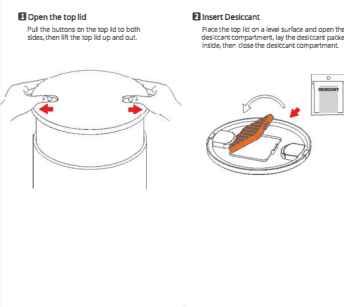

### QUICK SETUP (OPENING THE TOP LID AND ADDING FOOD)

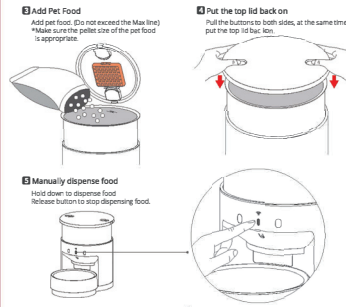

## USING THE APP

### 1 Connect the App

Download the PETKIT App and complete your registration via the App. Go to the App's main page and follow the instructions to add the PETKIT Fresh Element 3 Smart Pet Feeder and connect your device.



Scan QR Code to download the "PETKIT" App

### 2 Use the App to remotely control food dispensing

Using the App, you can set a feeding schedule. The pet feeder will automatically dispense food each day based on your settings. When your pet has eaten, you will receive a notification. This can help you better control when your pets eat and how much they eat each time.

## INDICATION LIGHTS

Indication Light	Status
Wi-Fi light is blinking slowly	Device is offline, there is no internet connection
Wi-Fi light is blinking quickly	Device is in the ready to connect Wi-Fi state
Wi-Fi light is on (constant)	Device is connected to the internet
Wi-Fi light is off	Indicator is set to off
Food level indication light is on (constant orange light)	There is an insufficient quantity of food in the food container unit.
Food level indication light is blinking orange and green	The device is malfunctioning. Check the App for more information.
Food level indication light is off	The food level is adequate.
Food level indication light is blinking orange	Low battery warning

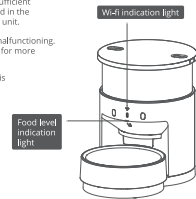

## CLEANING THE DEVICE

(This product does not come with a screwdriver. Screwdriver must be purchased separately.)



Scan QR code for an instructional video on how to clean the device

## CLEANING THE DEVICE

1 Unlock the food storage container  
Press **A** up until it is in the **☞** position.

2 Remove the food storage container  
Take off the top lid, rotate the food storage container counterclockwise to the end, and take it out upward.

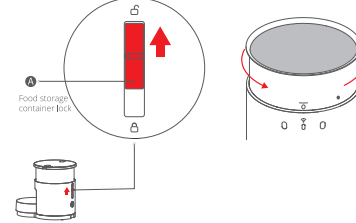

## CLEANING THE DEVICE

3 Remove the cover for the silicone rubber paddles  
Turn over the food storage container. Press upward on **B**. At the same time, rotate **C** clockwise to the end, and take it off.

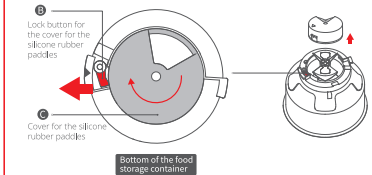

\*Please let it air-dry after washing and re-install the food storage container and food bowl one by one.

## INSTALLATION GUIDE

### 1 Install the cover for the silicone rubber paddles

Line up the grooves, press down on **C**, and rotate counterclockwise until both of the **▲** are aligned.

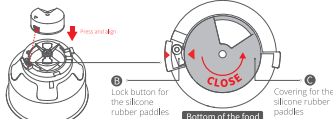

### 2 Place the food storage container back into the device

Align the **☞** symbol on the food storage container with the **☞** symbol on the outside of the main device, then place down the food storage container.

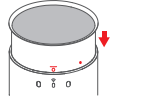

### 3 Rotate the food dispenser paddles into the device

If the food storage container does not sink down into position, rotate **A** until the **☞** symbol lies down.

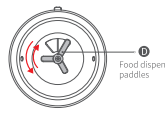

## INSTALLATION GUIDE

### 4 Rotate the food storage container

Rotate the food storage container until the **☞** symbol is aligned with the **☞** symbol.

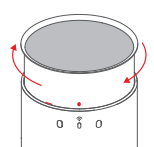

### 5 Lock the food storage container

Press down on **A** until it is in the **☞** position. Put on the top lid and make sure the rest of the device is properly set up.

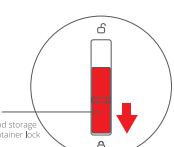

## FAQ

### I. After connecting the power cable, the device does not show any response.

The device has a lithium battery. If the battery is completely depleted, the device will charge the battery first before powering on. Please wait for 10 minutes, and the device should return to functioning as normal.

II. If I don't plan on using the product for an extended period of time, how should I turn it off?  
The device has a lithium battery. If you do not need to use the device for an extended period of time, you must turn the device off yourself. At the same time, hold down the bowl reset button together with the manual food dispenser button for 5 seconds. After you hear 3 beeps once notification, you can let go. The next time you use the device, all you need to do is plug in the power adapter cord, and it will turn on automatically.

### III. How to maintain the built-in lithium battery?

We do not recommend relying only on the lithium battery for power when using the device. If the lithium battery is almost depleted, make sure to charge it again immediately, or it may negatively impact the lifetime of the battery. Make sure to charge the battery at least once every 5 months if you are not otherwise using the device.

### IV. How do I use the food bowl reset button?

Press the food bowl reset button once to reset the weight in the food bowl. Usually, you need to reset the food bowl weight once you've put it back in place after each dispensing.

### V. Reset button:

Use a pen or other pointed object to press reset button, and hold it down for 10 seconds to restart the device.

### VI. Questions about the steel food bowl

1. There are spots of color on the device (discoloration): a protective powder is applied to the devices when they are being shipped out from the manufacturing plant. If not cleaned off before use, they may leave yellow marks or darker materials, for example:

Solution: Use warm water, white vinegar, and a soft-bristling cloth or scouring pad to clean the inside and outside of the device.

2. Rust on the product (if the surface of the product is not properly cleaned, or there is food residue, it is easy to form rust on the surface in case of long-term contact with water.)  
Solution: Before and after using the device, thoroughly clean the device. If it is not used for a long time, it should be dried and stored in a cool and dry place.

3. Questions about magnets (Explanation: Steel material can be used to not normally magnetic, however, during the manufacturing process, due to technological needs, the stretching process results in residual magnetism [weak magnetism]. Especially in the position of high tensile stretch, it is easy to produce magnetism, which is normal phenomenon.)

## BASIC SPECIFICATIONS

Product Name	PETKIT FRESH ELEMENT 3
Product Code	P560 (GL) / P560 (SL)
Total dimensions	337*223*286mm (GL) / 337*223*348mm (SL)
Intended uses	For cats and small breed dogs
Product weight	2.8kg (GL) / 3kg (SL)
Wireless connectivity	Wi-Fi
Rated voltage	6V/DC
Rated power	6W
Batter capacity	2400mAh

## HARMFUL SUBSTANCES

Name of component	Harmful Substances					
	Lead (Pb)	Mercury (Hg)	Cadmium (Cd)	Hexavalent Chromium (Cr6+)	Polybrominated biphenyl (PBB)	Polybrominated diphenyl ether (PBDE)
Printed Circuit Board	X	○	○	○	○	○
Plastic	○	○	○	○	○	○
Metal	X	○	○	○	○	○
Battery	X	○	○	○	○	○
Accessories	X	○	○	○	○	○

This device complies with part 15 of the FCC Rules. Operation is subject to the following two conditions: (1) This device may not cause harmful interference, and (2) This device must accept any interference received, including interference that may cause undesired operation.

### FCC warning:

Any Changes or modifications not expressly approved by the party responsible for compliance could void the user's authority to operate the equipment.

Note: This equipment has been tested and found to comply with the limits for a Class B digital device, pursuant to part 15 of the FCC Rules. These limits are designed to provide reasonable protection against harmful interference in a residential installation. This equipment generates uses and can radiate radio frequency energy and, if not installed and used in accordance with the instructions, may cause harmful interference to radio communications. However, there is no guarantee that interference will not occur in a particular installation. If this equipment does cause harmful interference to radio or television reception, which can be determined by turning the equipment off and on, the user is encouraged to try to correct the interference by one or more of the following measures:

- Reorient or relocate the receiving antenna.
- Increase the separation between the equipment and receiver.
- Connect the equipment into an outlet on a circuit different from that to which the receiver is connected.
- Consult the dealer or an experienced radio/TV technician for help.

This device has been evaluated to meet general RF exposure requirement.

This equipment complies with FCC radiation exposure limits set forth for an uncontrolled environment. This equipment should be installed and operated with minimum distance 20cm between the radiator & your body.

### E-warning:

• English:  
This device complies with Industry Canada (Interference RSS standard). Operation is subject to the following two conditions: (1) This device may not cause interference, and (2) This device must accept any interference, including interference that may cause undesired operation of the device.

• French:  
Ce présent appareil est conforme aux CNR d'Industrie Canada applicables aux appareils radio exempts de licence. L'exploitation de cet appareil est soumise aux deux conditions suivantes: (1) L'appareil ne doit pas produire de brouillage, et (2) l'appareil doit accepter tout brouillage radioélectrique qu'il reçoit, même le brouillage susceptible d'en compromettre le fonctionnement.

## INSTALLATION GUIDE

### 1 Install the cover for the silicone rubber paddles

Line up the grooves, press down on **C**, and rotate counterclockwise until both of the **▲** are aligned.

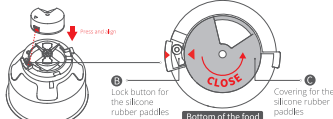

### 2 Place the food storage container back into the device

Align the **☞** symbol on the food storage container with the **☞** symbol on the outside of the main device, then place down the food storage container.

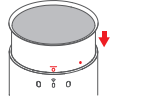

### 3 Rotate the food dispenser paddles into the device

If the food storage container does not sink down into position, rotate **A** until the **☞** symbol lies down.

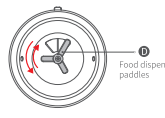

## INSTALLATION GUIDE

### 4 Rotate the food storage container

Rotate the food storage container until the **☞** symbol is aligned with the **☞** symbol.

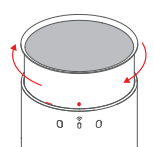

### 5 Lock the food storage container

Press down on **A** until it is in the **☞** position. Put on the top lid and make sure the rest of the device is properly set up.

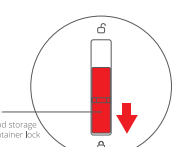

## FAQ

### I. After connecting the power cable, the device does not show any response.

The device has a lithium battery. If the battery is completely depleted, the device will charge the battery first before powering on. Please wait for 10 minutes, and the device should return to functioning as normal.

II. If I don't plan on using the product for an extended period of time, how should I turn it off?  
The device has a lithium battery. If you do not need to use the device for an extended period of time, you must turn the device off yourself. At the same time, hold down the bowl reset button together with the manual food dispenser button for 5 seconds. After you hear 3 beeps once notification, you can let go. The next time you use the device, all you need to do is plug in the power adapter cord, and it will turn on automatically.

### III. How to maintain the built-in lithium battery?

We do not recommend relying only on the lithium battery for power when using the device. If the lithium battery is almost depleted, make sure to charge it again immediately, or it may negatively impact the lifetime of the battery. Make sure to charge the battery at least once every 5 months if you are not otherwise using the device.

### IV. How do I use the food bowl reset button?

Press the food bowl reset button once to reset the weight in the food bowl. Usually, you need to reset the food bowl weight once you've put it back in place after each dispensing.

### V. Reset button:

Use a pen or other pointed object to press reset button, and hold it down for 10 seconds to restart the device.

### VI. Questions about the steel food bowl

1. There are spots of color on the device (discoloration): a protective powder is applied to the devices when they are being shipped out from the manufacturing plant. If not cleaned off before use, they may leave yellow marks or darker materials, for example:

Solution: Use warm water, white vinegar, and a soft-bristling cloth or scouring pad to clean the inside and outside of the device.

2. Rust on the product (if the surface of the product is not properly cleaned, or there is food residue, it is easy to form rust on the surface in case of long-term contact with water.)  
Solution: Before and after using the device, thoroughly clean the device. If it is not used for a long time, it should be dried and stored in a cool and dry place.

3. Questions about magnets (Explanation: Steel material can be used to not normally magnetic, however, during the manufacturing process, due to technological needs, the stretching process results in residual magnetism [weak magnetism]. Especially in the position of high tensile stretch, it is easy to produce magnetism, which is normal phenomenon.)

## BASIC SPECIFICATIONS

Product Name	PETKIT FRESH ELEMENT 3
Product Code	P560 (GL) / P560 (SL)
Total dimensions	337*223*286mm (GL) / 337*223*348mm (SL)
Intended uses	For cats and small breed dogs
Product weight	2.8kg (GL) / 3kg (SL)
Wireless connectivity	Wi-Fi
Rated voltage	6V/DC
Rated power	6W
Batter capacity	2400mAh

## HARMFUL SUBSTANCES

Name of component	Harmful Substances					
	Lead (Pb)	Mercury (Hg)	Cadmium (Cd)	Hexavalent Chromium (Cr6+)	Polybrominated biphenyl (PBB)	Polybrominated diphenyl ether (PBDE)
Printed Circuit Board	X	○	○	○	○	○
Plastic	○	○	○	○	○	○
Metal	X	○	○	○	○	○
Battery	X	○	○	○	○	○
Accessories	X	○	○	○	○	○

This device complies with part 15 of the FCC Rules. Operation is subject to the following two conditions: (1) This device may not cause harmful interference, and (2) This device must accept any interference received, including interference that may cause undesired operation.

### FCC warning:

Any Changes or modifications not expressly approved by the party responsible for compliance could void the user's authority to operate the equipment.

Note: This equipment has been tested and found to comply with the limits for a Class B digital device, pursuant to part 15 of the FCC Rules. These limits are designed to provide reasonable protection against harmful interference in a residential installation. This equipment generates uses and can radiate radio frequency energy and, if not installed and used in accordance with the instructions, may cause harmful interference to radio communications. However, there is no guarantee that interference will not occur in a particular installation. If this equipment does cause harmful interference to radio or television reception, which can be determined by turning the equipment off and on, the user is encouraged to try to correct the interference by one or more of the following measures:

- Reorient or relocate the receiving antenna.
- Increase the separation between the equipment and receiver.
- Connect the equipment into an outlet on a circuit different from that to which the receiver is connected.
- Consult the dealer or an experienced radio/TV technician for help.

This device has been evaluated to meet general RF exposure requirement.

This equipment complies with FCC radiation exposure limits set forth for an uncontrolled environment. This equipment should be installed and operated with minimum distance 20cm between the radiator & your body.

### E-warning:

• English:  
This device complies with Industry Canada (Interference RSS standard). Operation is subject to the following two conditions: (1) This device may not cause interference, and (2) This device must accept any interference, including interference that may cause undesired operation of the device.

• French:  
Ce présent appareil est conforme aux CNR d'Industrie Canada applicables aux appareils radio exempts de licence. L'exploitation de cet appareil est soumise aux deux conditions suivantes: (1) L'appareil ne doit pas produire de brouillage, et (2) l'appareil doit accepter tout brouillage radioélectrique qu'il reçoit, même le brouillage susceptible d'en compromettre le fonctionnement.