

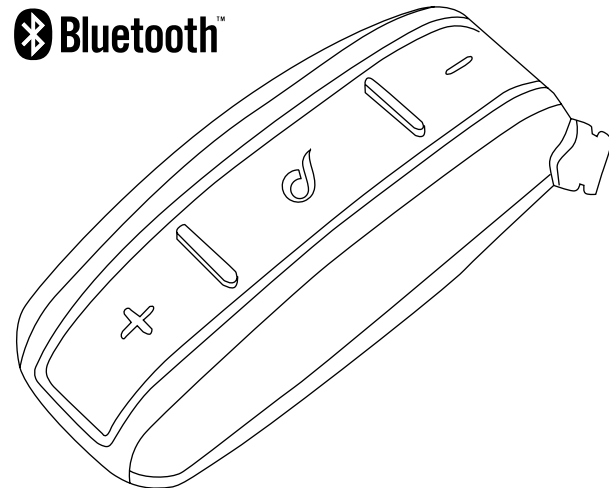

SHAPE



QUICK GUIDE

CHECK FOR SOFTWARE UPDATES ON WEBSITE
www.interphone.com



WARNING ON THE BATTERY OF THE PRODUCT

Fully charge the battery before using the product for the first time. Do not store the Product without charging it. Failure to do so may cause irreversible damage to the battery capacity. Charge the battery every TWO months.

WARNING ON THE WATER RESISTANCE OF THE PRODUCT

The external unit (control unit), connected to the audio kit, can be immersed in a meter of fresh water for a maximum of 30 (thirty) minutes. Despite this, the device is not immune to greater stress, such as prolonged immersions or high pressure water jets. Using the product during intense meteorological phenomena, at high speeds, may be equivalent to subjecting the product to a high pressure jet.

FOLLOW ALL SUGGESTIONS CAREFULLY TO AVOID DAMAGING THE DEVICE:

Do not immerse the product in fresh water which is more than a metre deep for more than 30 minutes.
Do not store the product when still wet; dry it with a clean, soft cloth.
Do not expose the product to salt water or ionised water, drinks or other liquids.
If the device is exposed to liquids other than fresh water, wash the device with cold fresh water and dry it carefully with a clean, soft cloth.
Do not expose the product to high pressure water jets.

CHAPTER 1 – COMPOSITION OF THE KIT

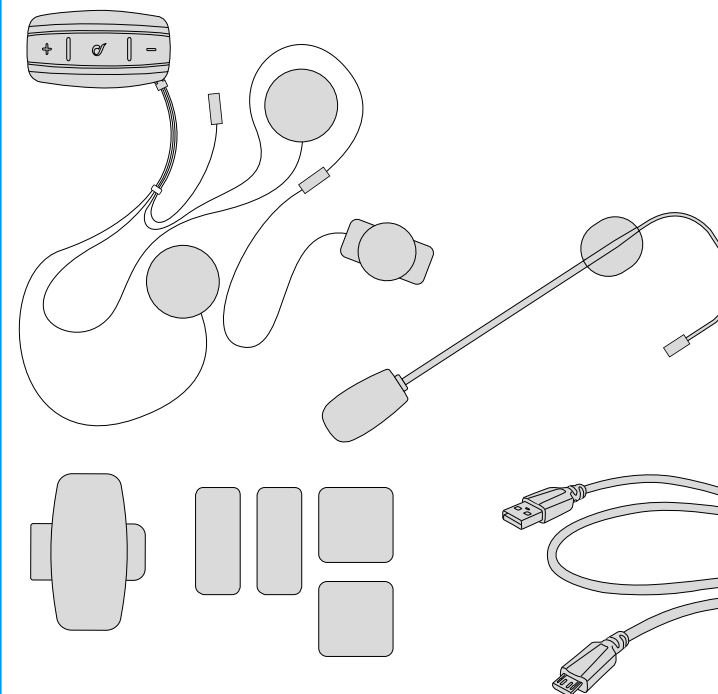
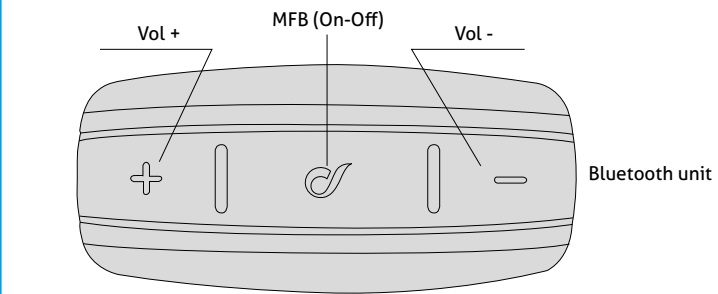

CHAPTER 2 – INSTALLATION INSTRUCTIONS

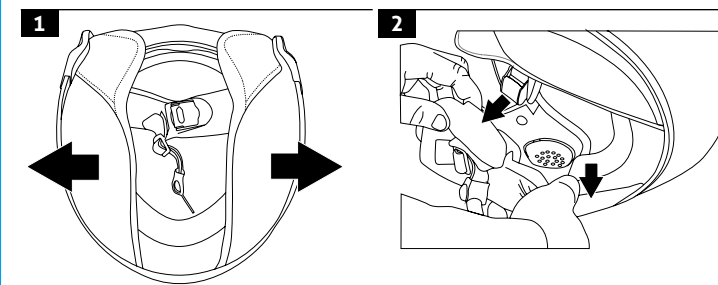

1 If possible, remove the two cushions or padding
2 Locate the area in correspondence with the ear

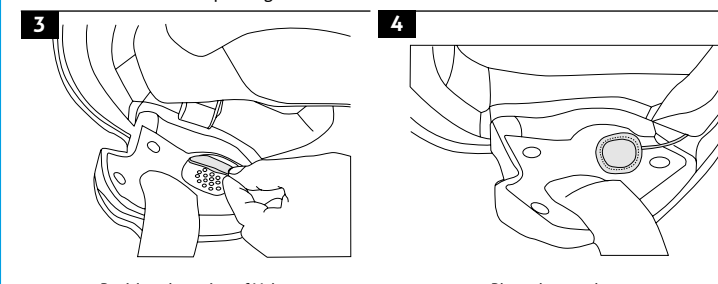

3 Position the strips of Velcro for the speakers
4 Place the speakers

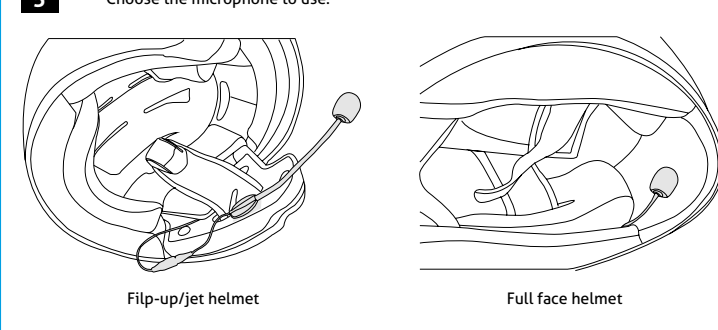

5 Choose the microphone to use:
Filp-up/jet helmet
Full face helmet

6 Choose the bracket to use, to be attached on the left side of the helmet:

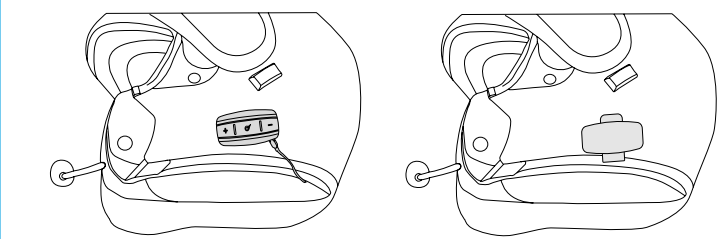

Sticker Bracket

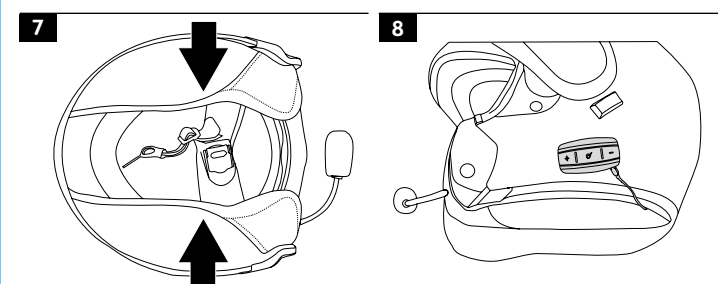

7 Re-install the cushions
8 Install the control unit

(!) Warnings on installation:

1. The centre of the speakers must be placed in correspondence with the ears, as close as possible.
2. The marking "MIC" on the microphone must be directed towards the mouth.

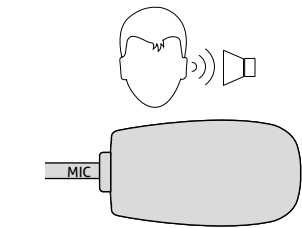

CHAPTER 3 - BATTERY CHARGE

Insert the micro USB charging cable in the special intercom connector, as shown in the picture. Connect the cable to a standard USB charger.

LED indications:
 - orange LED: charging,
 - green LED: fully charged

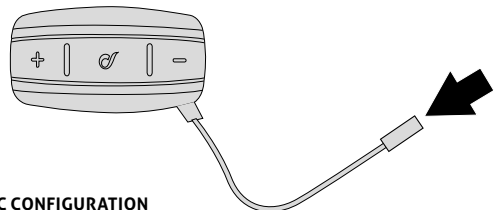

CHAPTER 4 - BASIC CONFIGURATION

Turn the device on

Press **MFB** until the blue LED comes on.

Turn the device off

Press **MFB** until the red LED lights up and the device turns off.

Activate / Deactivate automatic volume control

1. With the device off, press **MFB** until the second beep. Led will flash red/blue.
2. To activate, press **Volume +** until the first beep. Led will flash blue for 4 seconds.
3. To deactivate, press **Volume -** until the first beep. Led will flash red for 4 seconds.

Activate / Deactivate phone calls voice answer

1. With the device off, press **MFB** until the second beep. Led will flash red/blue.
2. To activate, press **Volume +** until the second beep. Led will flash blue for 4 seconds.
3. To deactivate, press **Volume -** until the second beep. Led will flash red for 4 seconds.

Factory Reset

With the device off, press together **MFB** and **Volume +** and **Volume -** until the device switches on. All settings and pairings will be erased.

CHAPTER 5 - TELEPHONE / GPS

Pairing

1. With the device off, press **MFB** until the second beep. Led will flash red/blue.
2. Start searching for new devices on the mobile phone / GPS
3. Select the intercom on the phone / GPS "interphone shape".
4. Once the pairing has been confirmed, the LED will flash BLUE twice, every three seconds.

Answering a call

Just say loudly "HELLO" or short press **MFB**.

Voice dial

Short press **MFB**.

Redial last number

Double press **MFB**.

CHAPTER 6 – MUSIC

Enable/disable playback from the phone

Press **MFB** until the second beep.

Next track

On music playback, press **Volume +** until the first beep.

Previous track

On music playback, press **Volume -** until the first beep.

Share the music with another intercom

On music playback, press **Volume +** until the second beep.
 To stop sharing, press **Volume -** until the second beep.

CHAPTER 7 – INTERCOM

Pairing with another Interphone device (for the first time only)

1. With both the intercom devices off, on each unit press power-on button until led will flash red/blue.
2. Short press **MFB** button on one Interphone SHAPE, units will pair and connect.

Pairing with a NON-Interphone device (for the first time only)

1. In the NON-Interphone unit, start the telephone search/pairing mode; refer to the user manual of the intercom to be paired.
2. With Interphone SHAPE off, press **MFB** until led will flash red/blue.
3. Short press **MFB** button on Interphone SHAPE, units will pair and connect.

Two way intercom talk

On one unit only, press **MFB** until the first beep.

To stop communication, on one unit only, press **MFB** until the first beep.

SPECIFICHE TECNICHE

Bluetooth® compliance:

Bluetooth v. 3.0 - Class II

Supported Bluetooth profiles:

HFP A2DP AVRCP

Frequency:

2.402 – 2.480GHz

Power:

7dBm EIRP

Operating temperature:

0 – 45°C

Charging temperature:

10 - 40°C

Dimensions mm:

36x78x18

Weight:

61 g

Capacity:

Up to 10 meters

Talk time:

12 h

Stand-by time:

700 h

Charging time:

3 h

Battery type:

Lithium-ion rechargeable



WARNING: To prevent possible hearing damage, do not listen at high volume levels for long periods.



Federal Communications Commission (FCC) Statement Industry Canada (IC) Statement

15.21

You are cautioned that changes or modifications not expressly approved by the part responsible for compliance could void the user's authority to operate the equipment.

15.105(b)

This equipment has been tested and found to comply with the limits for a Class B digital device, pursuant to part 15 of the FCC/IC rules. These limits are designed to provide reasonable protection against harmful interference in a residential installation. This equipment generates, uses and can radiate radio frequency energy and, if not installed and used in accordance with the instructions, may cause harmful interference to radio communications. However, there is no guarantee that interference will not occur in a particular installation. If this equipment does cause harmful interference to radio or television reception, which can be determined by turning the equipment off and on, the user is encouraged to try to correct the interference by one or more of the following measures:

- Reorient or relocate the receiving antenna.
- Increase the separation between the equipment and receiver.
- Connect the equipment into an outlet on a circuit different from that to which the receiver is connected.
- Consult the dealer or an experienced radio/TV technician for help.

This device complies with part 15 of the FCC rules and Industry Canada licence-exempt RSS standard(s). Operation is subject to the following two conditions:

- 1) This device may not cause interference and
- 2) This device must accept any interference, including interference that may cause undesired operation of the device.

FCC / IC RF Radiation Exposure Statement:

This equipment complies with FCC / IC radiation exposure limits set forth for an uncontrolled environment. This equipment should be installed and operated with minimum distance 10mm between the radiator & your body. This transmitter must not be co-located or operating in conjunction with any other antenna or transmitter.



EN - Hereby, Cellular Italia S.p.A declares that the radio equipment type B1F7 (Interphone Shape) is in compliance with Directive 2014/53/EU and Directive RoHS (2011/65/EU). The user is prohibited from making any type of change or variation to the device. Variations or changes not expressly approved by Cellular Italia S.p.A will cancel the user's authorisation to use the device. Only update with software provided by Cellular Italia S.p.A. Bluetooth® is a trademark owned by Bluetooth SIG, Inc. The full text of the EU declaration of conformity is available at the following internet address: http://www.cellularline.com/it_it/dichiarazione-conformita/



EN - INSTRUCTIONS FOR THE DISPOSAL OF APPLIANCES FOR DOMESTIC USERS (Applicable in countries in the European Union and those with separate waste collection systems). This mark on the product or documentation indicates that this product must not be disposed of with other household waste at the end of its life. To avoid any damage to health or the environment due to improper disposal of waste, the user must separate this product from other types of waste and recycle it in a responsible manner to promote the sustainable re-use of the material resources. Domestic users should contact the dealer where they purchased the product or the local government office for all the information regarding separate waste collection and recycling for this type of product. Corporate users should contact the supplier and verify the terms and conditions in the purchase contract. This product must not be mixed with other commercial waste. This product has a battery that cannot be replaced by the user. Do not attempt to open the device to remove the battery as this could cause malfunctions and seriously damage the product. When disposing of the product, please contact the local waste disposal authority to remove the battery. The battery inside the device was designed to be able to be used during the entire life cycle of the product.