

# THE BLACK SERIES™



## Bluetooth® speaker box



### INTRODUCTION

Congratulations on your purchase of the Rechargeable Speaker Box. Please read all instructions and warnings in this sheet prior to using your speaker. Keep this instruction sheet as it contains important information for future reference.

### SAFETY WARNINGS

- Inspect the product before every use. If the product appears worn, frayed, cracked, or broken in any manner, discontinue use and discard immediately.
- Do not disassemble.
- Do not use for anything other than its intended purpose.
- This is not a children's product. Keep out of reach of children.
- Product is not designed for all weather use. Keep away from moisture and extreme temperatures.
- There are no serviceable parts, do not disassemble or attempt to repair.

### FEATURES

- Built in rechargeable battery
- Auxiliary connection
- Stereo Sound
- Compatible with BLUETOOTH® device

Speaker



USB Charging Cable



### CHARGE THE SPEAKER

1. Attach the small connector of the USB Charging Cable to the Charging Jack (I).
2. Attach the other end of the cable to a computer's USB port.
3. A red LED light (F) will turn on, indicating speakers are charging.
4. Remove the USB cable from computer when the red LED light turns off.

### Note:

- It takes approximately 4 hours to fully charge speakers.
- When the battery is low, alert reminding tone can be heard.

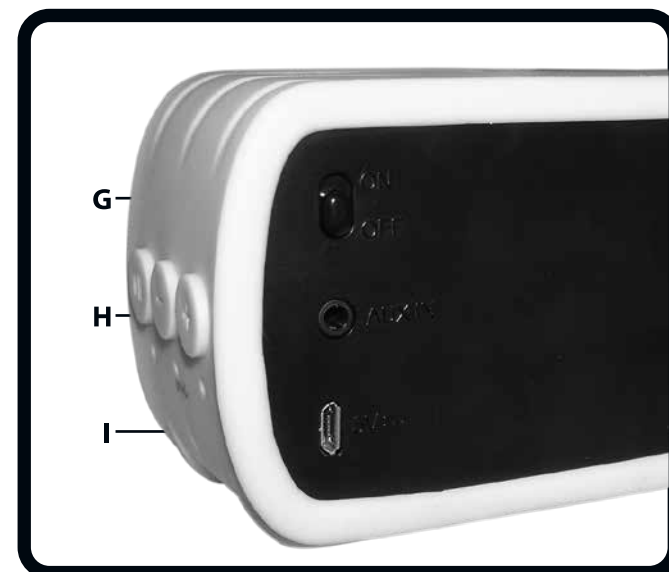

### PAIRING THE SPEAKER

1. Turn the speaker on by sliding the ON/OFF switch (G) up. You will hear 2 tones coming from the speaker signaling it is on.
2. Place your device within 3 feet of the speaker (Figure 1).
3. Enable BLUETOOTH® on your device and search for new BLUETOOTH® devices. Refer to your device's manual on how to enable and operate BLUETOOTH®.
4. Select SPEAKER from the list of BLUETOOTH® available devices (Figure 2).
5. A tone coming from the speaker will notify you when it is successfully paired.
6. You can now stream music wirelessly from your device to your speaker.

Note: If you restart the Speaker, it will automatically pair with your device. A tone will notify you when it is successfully paired.

Your device must have BLUETOOTH® capability. Consult your device manufacturer or user manual if you are unsure if your device has this feature.

Turn off any devices that may have been previously paired to the speakers.

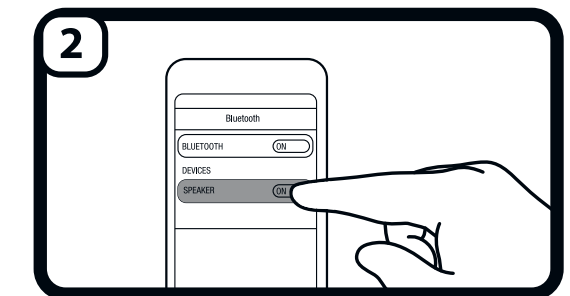
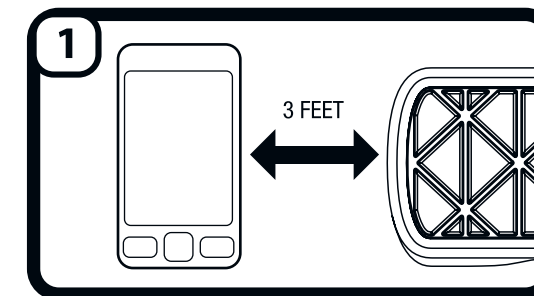

### CONTROLS

- A. While playing music - Play and pause audio.  
During a Call - Press once to answer a call / Press twice to reject a call / Press once to end the call.
- B. While playing music - Press and hold to decrease volume/ short press to skip to the previous track.  
During a Call - Press and hold to decrease volume.
- C. While playing music - Press and hold to increase volume / Press once to skip to the next song.  
During a Call - Press and hold to increase volume.
- D. Turns blue when Bluetooth is active / turns red when auxiliary is active.
- E. Microphone
- F. Red light turns on while charging.
- G. On/off
- H. Auxiliary connection
- I. Charging jack

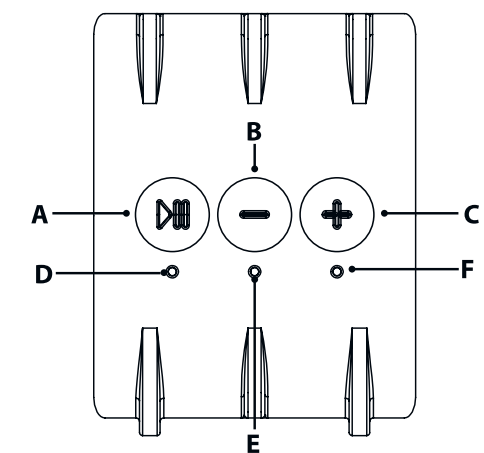

This device complies with Part 15 of the FCC Rules. Operation is subject to the following two conditions:  
(1) This device may not cause harmful interference, and (2) this device must accept any interference received, including interference that may cause undesired operation.

Warning: Changes or modifications to this unit not expressly approved by the party responsible for compliance could void the user's authority to operate the equipment.

NOTE: This equipment has been tested and found to comply with the limits for a Class B digital device, pursuant to Part 15 of the FCC Rules. These limits are designed to provide reasonable protection against harmful interference in a residential installation. This equipment generates, uses and can radiate radio frequency energy and, if not installed and used in accordance with the instructions, may cause harmful interference to radio communications. However, there is no guarantee that interference will not occur in a particular installation. If this equipment does cause harmful interference to radio or television reception, which can be determined by turning the equipment off and on, the user is encouraged to try to correct the interference by one or more of the following measures:

- Reorient or relocate the receiving antenna.
- Increase the separation between the equipment and receiver.
- Connect the equipment into an outlet on a circuit different from that to which the receiver is connected.
- Consult the dealer or an experienced radio/TV technician for help.

©2015 MerchSource, LLC. All rights reserved.

The Black Series™ and all associated logos are trademarks of MerchSource, LLC.  
Distributed by MerchSource, LLC, Irvine, CA 92618.

For technical support, please visit [www.msccustomeremercare.com](http://www.msccustomeremercare.com) or call 1-800-374-2745

The artwork and design of this instruction manual are protected by US copyright law and may not be reproduced, distributed, displayed, published or used for any purpose without prior written permission. It is not permitted to alter, remove or reproduce any trademarks or copyright notice from this manual.

### RECYCLE WARNING

PLEASE RECYCLE OR DISPOSE OF ELECTRONICS PROPERLY  
RECYCLING INFORMATION IS ONLINE AT [WWW.MSCCUSTOMERCARE.COM](http://WWW.MSCCUSTOMERCARE.COM)

Printed in China