



USER'S MANUAL
MANUEL DE L'UTILISATEUR
MANUAL DEL USUARIO

WD32HBB101

TABLE OF CONTENTS

1	IMPORTANT INFORMATION		2
2	HOW TO INSTALL THE STAND		4
3	PREFACE		5
4	SAFETY PRECAUTIONS		5
5	CONTENTS		7
6	FRONT/BACK CONNECTIONS OF LED TV		8
7	TV INSTALLATION	Power Cord Connection	9
		Antenna Connection	9
		AV Connection	10
		YPbPr(component) Connection	10
		VGA(PC) Connection	11
		USB Port Function	11
		HDMI Connection	12
8	REMOTE CONTROL	Remote control instructions in TV mode	13
		Remote control setup	14
9	MENU OPERATION	Setup Wizard	15
		Select Input Source	17
		Basic Operation	17
		Picture Menu	18
		Audio Menu	21
		Time Menu	22
		Setup Menu	23
		Lock Menu	25
		Channel Menu	27
		Setup Menu	29
USB Menu	30		
10	TROUBLESHOOTING		32
11	SPECIFICATIONS		33

IMPORTANT INFORMATION

English

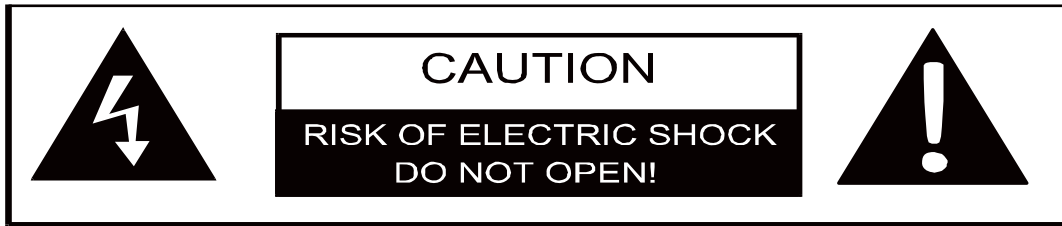

The lightning flash with arrowhead symbol, within an equilateral triangle, is intended to alert the user to the presence of un-insulated dangerous voltage within the products enclosure that may be of sufficient magnitude to constitute a risk of electric to persons.



The exclamation point within an equilateral triangle is intended to alert the user to the presence of important operating and maintenance (servicing) instruction the literature accompanying the appliance.

CAUTION: USE OF ANY CONTROLS, ADJUSTMENTS, OR PROCEDURES OTHER THAN THOSE SPECIFIED HEREIN MAY RESULT IN HAZARDOUS RADIATION EXPOSURE.

CAUTION: These servicing instructions are for use by qualified service personnel only. To reduce the risk of electric shock, do not perform any servicing other than that contained in the operating instructions unless you are qualified to do so.

Refer to service manual for servicing instructions.

Important Safety Instructions

Note:

1. Read these instructions.
2. Keep these instructions.
3. Heed all warnings.
4. Follow all instructions.
5. Do not use near water.
6. Clear only with dry cloth.
7. Do not block any ventilation openings. Install in accordance with the manufacturer's instructions.
8. Do not install near any heat sources such as radiators, heat registers, stoves, or other apparatus (including amplifiers) that produce heat.
9. Do not defeat the safety purpose of the polarized or grounding-type plug. A polarized plug has two blades with one wider than the other. A grounding type plug has two blades and a third grounding prong. The wide blade or the third prong are provided for your safety. If the provided plug does not fit into your outlet, consult an electrician for replacement of the obsolete outlet.

IMPORTANT INFORMATION

10. Protect the power cord from being walked on or pinched particularly at plugs, convenience receptacles, and the point where they exit from the apparatus.
11. Only use attachments / accessories specified by the manufacturer.
12. Use only with the cart, stand, tripod, bracket, or table specified by the manufacturer, or sold with the apparatus.
When a cart is used, use caution when moving the cart / apparatus combination to avoid injury from tip-over.



13. Unplug this apparatus during lightning storms or when unused for long periods of time.
14. Refer all servicing to qualified service personnel. Servicing is required when the apparatus has been damaged in any way, such as power-supply cord or plug is damaged, liquid has been spilled or objects have fallen into the apparatus, the apparatus has been exposed to rain or moisture, does not operate normally, or has been dropped.
15. Apparatus shall not be exposed to dripping or splashing and that no objects filled with liquids, such as vases, shall be placed on the apparatus.
16. WARNING: To reduce the risk of fire or electric shock, do not expose this apparatus to rain or moisture.
17. Mains plug or appliance coupler is used as the disconnect device, shall be readily operable.
18. The apparatus shall be connected to a MAINS socket outlet with a protective earthing connection.
19. WARNING: The batteries shall not be exposed to excessive heat such as sunshine, fire or the like.
20. The ON-MODE Power under Home Mode should be less than 40 W.
21. The Sleep Mode power should be less than 0.49W.
22.  This equipment is a Class II or double insulated electrical appliance. It has been designed in such a way that it does not require a safety connection to electrical earth.

Licensing and Patent Information

This WESTINGHOUSE product may be covered by one or more U.S. and foreign patents and patent applications.



“HDMI, the HDMI logo and High-Definition Multimedia Interface are trademarks or registered trademarks of HDMI Licensing LLC.”

How to install the stand!

English

Installing the Stand

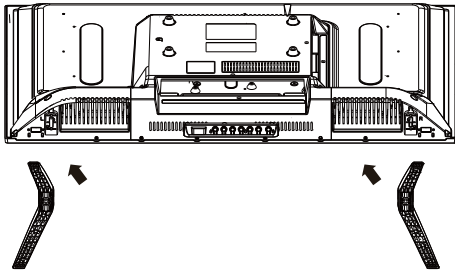

- 1. Lay the TV face down on a flat, cushioned surface to avoid damaging or scratching.
- 2. Fix the Left Base Stand to the main unit using 2 pcs provided screw (B4x18F).
- 3. Fix the Right Base Stand to the main unit using 2 pcs provided screws (B4x18F).

Removing the Stand for Wall-Mounting

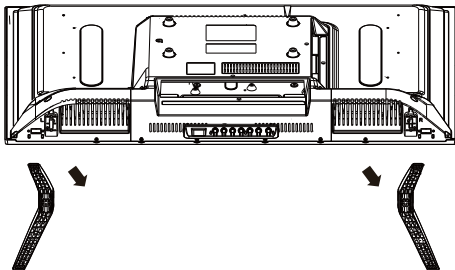

- 1. Lay the TV face down on a flat, cushioned surface to avoid damaging or scratching.
- 2. Untighten the 4 pcs screws holding the stand assembly and remove them.
- 3. Attach the wall-mount bracket to the TV using the mounting holes on the back of the TV. Mount this TV according to the instructions included in the wall-mount bracket.

Wall-Mounting Screws

Mount the VESA bracket using 4*M6*10 isometric threaded screws (not included).

WARNING: To prevent injury, this apparatus must be securely attached to the floor/wall in accordance with the installation instruction.

WARNING:

Never place a television set in an unstable location. A television set may fall, causing serious personal injury or death. Many injuries, particularly to children, can be avoided by taking simple precautions such as:

- Using cabinets or stands recommended by the manufacturer of the television set.
- Only using furniture that can safely support the television set.
- Ensuring the television set is not overhanging the edge of the supporting furniture.
- Not placing the television set on tall furniture (for example, cupboards or bookcases) without anchoring both the furniture and the television set to a suitable support.
- Not placing the television set on cloth or other materials that may be located between the television set and supporting furniture.
- Educating children about the dangers of climbing on furniture to reach the television set or its controls.

If your existing television set is being retained and relocated, the same considerations as above should be applied.

3. PREFACE

Thank you for buying this TV! Please read this manual thoroughly before operating the TV. Make sure the TV was not damaged in transit. Should the TV be damaged, do not install it and contact your dealer. Check that you have all the accessories according to the model.

4. SAFETY PRECAUTIONS

English



Put the TV on a stable surface.

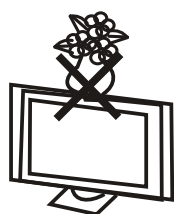

Do not place any material on the TV.

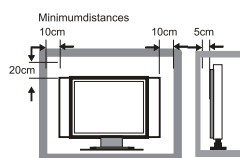

Do not use the TV with fixtures other than those provided or suggested by the manufacturer.

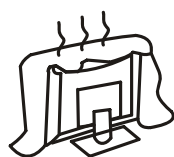

Do not block or cover the ventilation openings on the TV. If you have a wall mount, check that it is steady.



Power cord and cables must be properly routed and protected to prevent people from stepping on them and causing the TV to fall.

SAFETY PRECAUTIONS

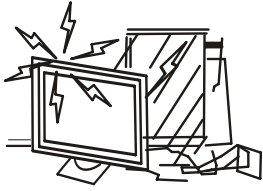

Keep the TV dry and away from humidity.

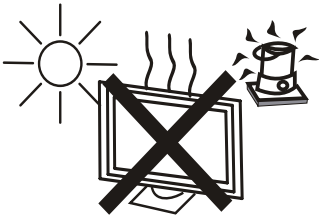

Keep the TV away from heat sources.



Unplug the TV before cleaning it. Do not use solvent or liquid to clean the TV.

Only clean the TV with a soft and dry cloth.

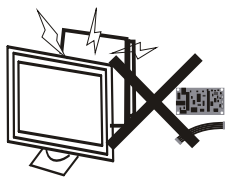

In case of troubleshooting, do not use spare parts other than those suggested by the manufacturer. Using inadequate spare parts can lead to electric shocks, short-circuits, fire or other incidents.



Unplug the TV during lightning storms or when unused for long periods of time.

5. CONTENTS

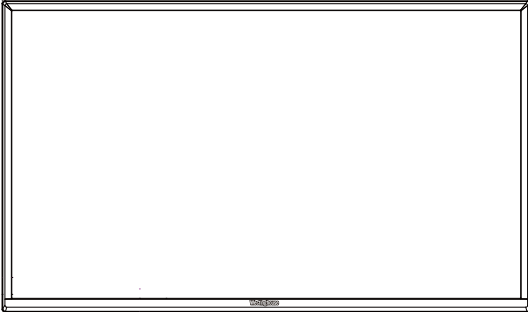

TV Set



Remote Control with Batteries

English

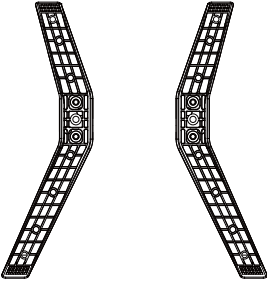

TV Stand

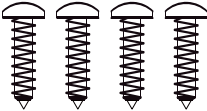

Four Screws(B4x18F).



User Manual



Quick Connect Guide



Warranty Card

English

6. FRONT/BACK CONNECTIONS OF LED TV

Front View

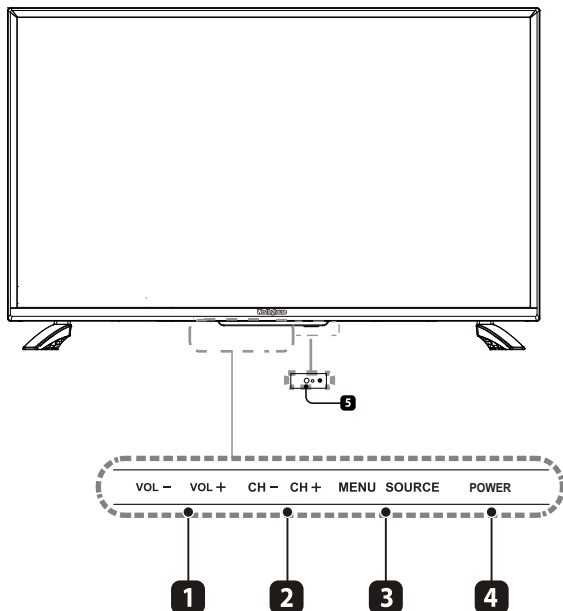

1. **VOL -/+**
Press to adjust the volume.
 2. **CH -/+**
Press to select a channel.
 3. **MENU / SOURCE**
Display the OSD (on screen display) menu.
Press to select among different input signal sources.
 4. **POWER**
Switch the TV between On / Standby mode.
 5. **IR (Infrared Receiver)**
Receive IR signals from the remote control.
- POWER Indicator**
Illuminate blue when the TV is turned on.
Illuminate red when the TV is in standby mode.

Back View and Control Connections

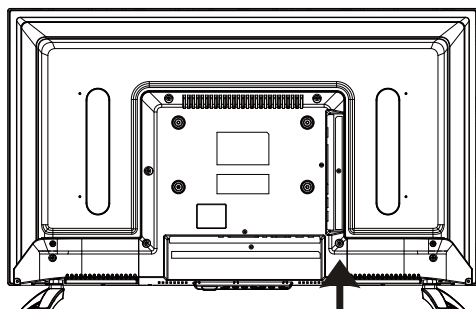

1. Headphone: Connect a stereo headphone for private listening.
2. Optical Output: Connect a digital sound system to this jack.
3. AV: Connect the Video and Audio output.
4. YPbPr: Connect the YPbPr and Audio output.
5. HDMI1/HDMI2/HDMI3: Connect the HDMI output jack of DVD.
6. VGA (PC): Connect the PC-RGB output jack of PC.
PC AUDIO: Connect the Audio output jack of PC.
7. RF IN: Connect the antenna.
8. USB: USB Port.

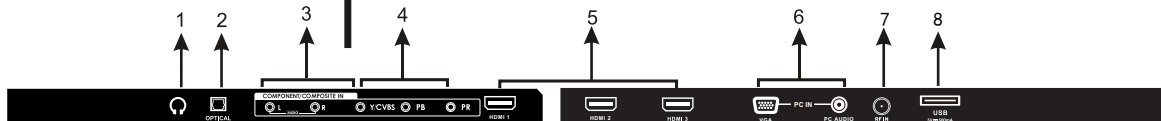

7. TV INSTALLATION

Power Cord Connection

- Connect the power cord correctly as shown.

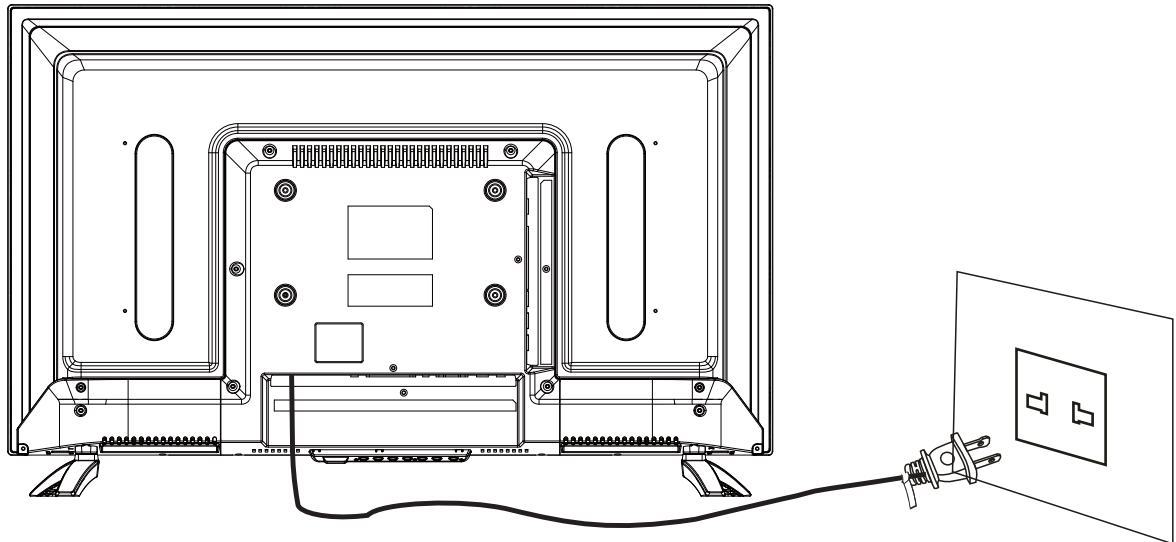

English

Antenna Connection

To ensure good picture and sound, TV antenna system needs to be installed. The antenna system as shown can be sourced from TV equipment shops, which will provide service for correct installation and connection. After installation, insert the 75-ohm antenna plug into the antenna jack as shown.

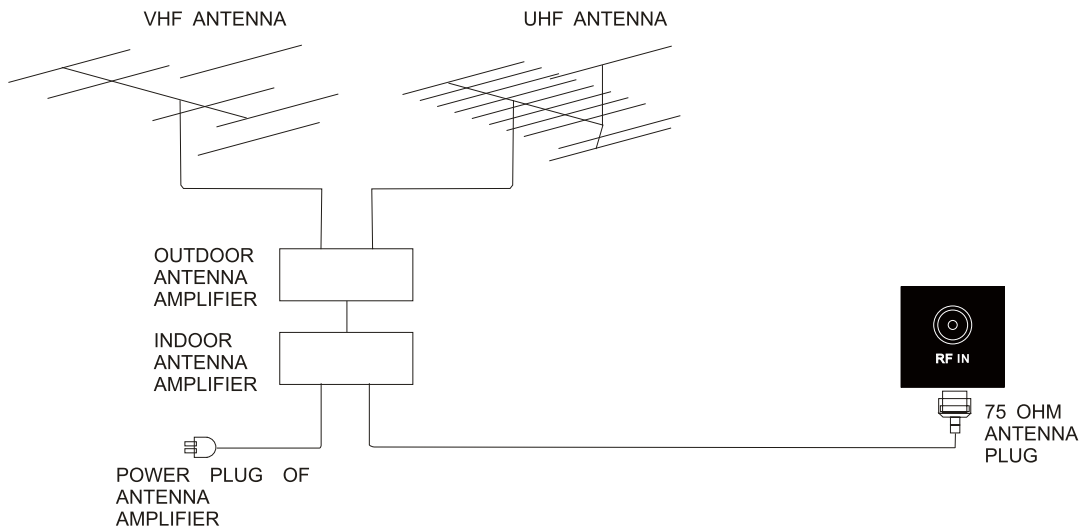

AV Connection

Connect the VIDEO and AUDIO output jack of the DVD or VCR to the VIDEO jacks on the set using the RCA cable. Match the jack colors: Video is yellow, Audio left is white, and Audio right is red. Select the AV input source using the SOURCE button on the remote control.

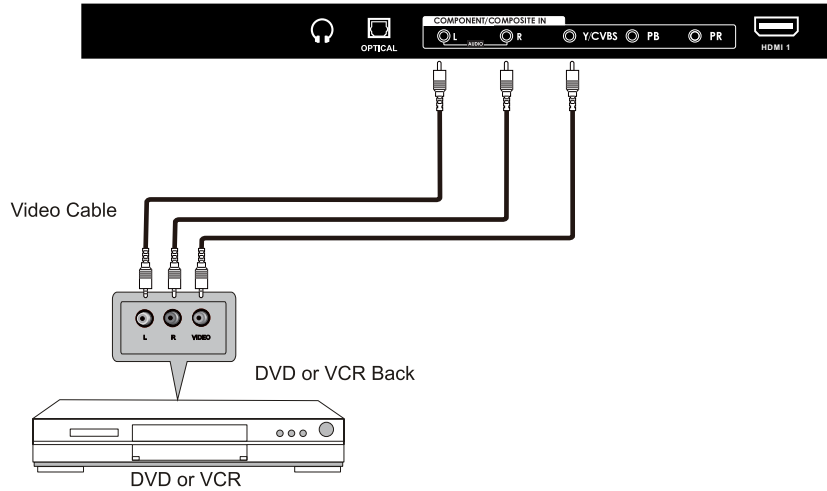

YPbPr (Component) Connection

Connect the YPbPr output of the DVD or VCR to the YPbPr input on the set. The picture quality is improved; compared to connecting a regular VCR to the video input. Connect the Audio output of the DVD or VCR to the Audio input jacks on the set using the RCA cable.

Match the jacks colors :Y is green,Pb is blue,Pr is red,Audio left is white and Audio right is red. Select component input source using the SOURCE button on the remote control.

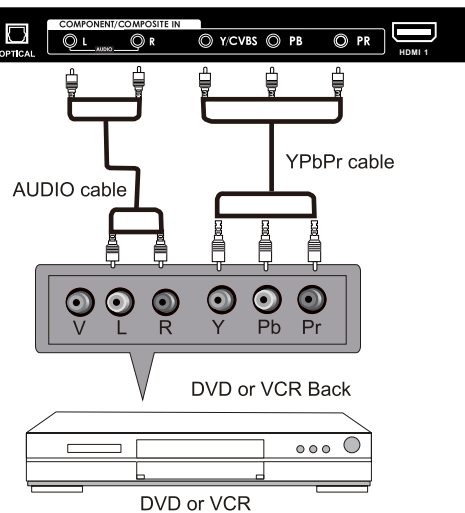

VGA(PC) Connection

Connect the RGB output of the PC to the VGA(PC) jack on the set. Connect the AUDIO output of The PC to the PC AUDIO jack on the set. Select the VGA input source with using SOURCE button on the remote control.

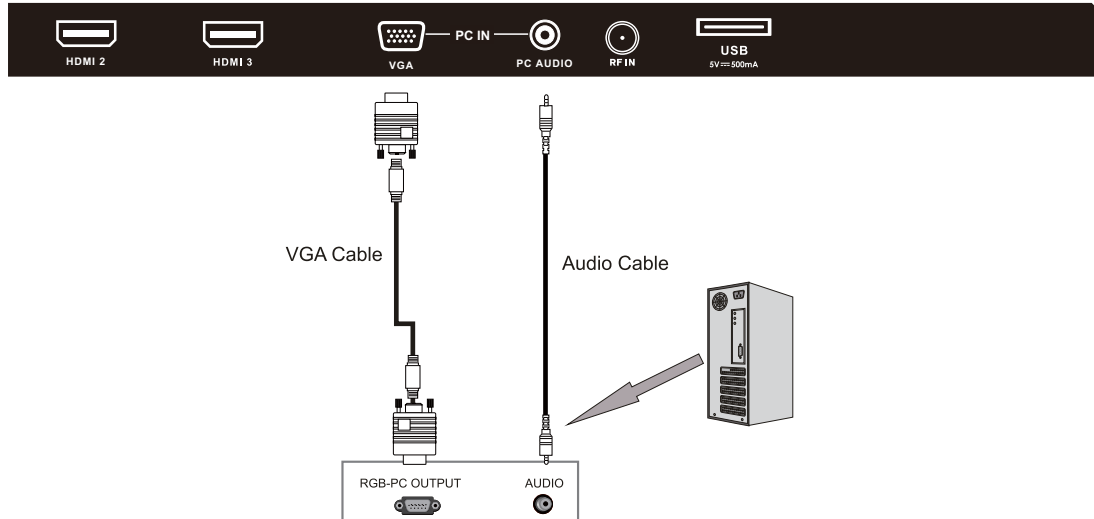

English

USB Port Function

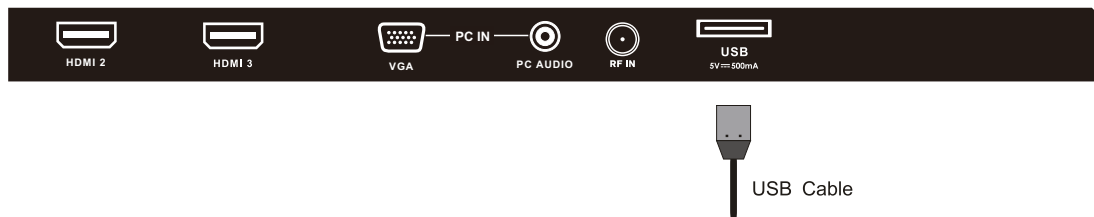

HDMI Connection

HDMI plug which replaces the HDMI connection allows transfer of all audio/video control signals through one cable only. These signals are transferred in digital.

English

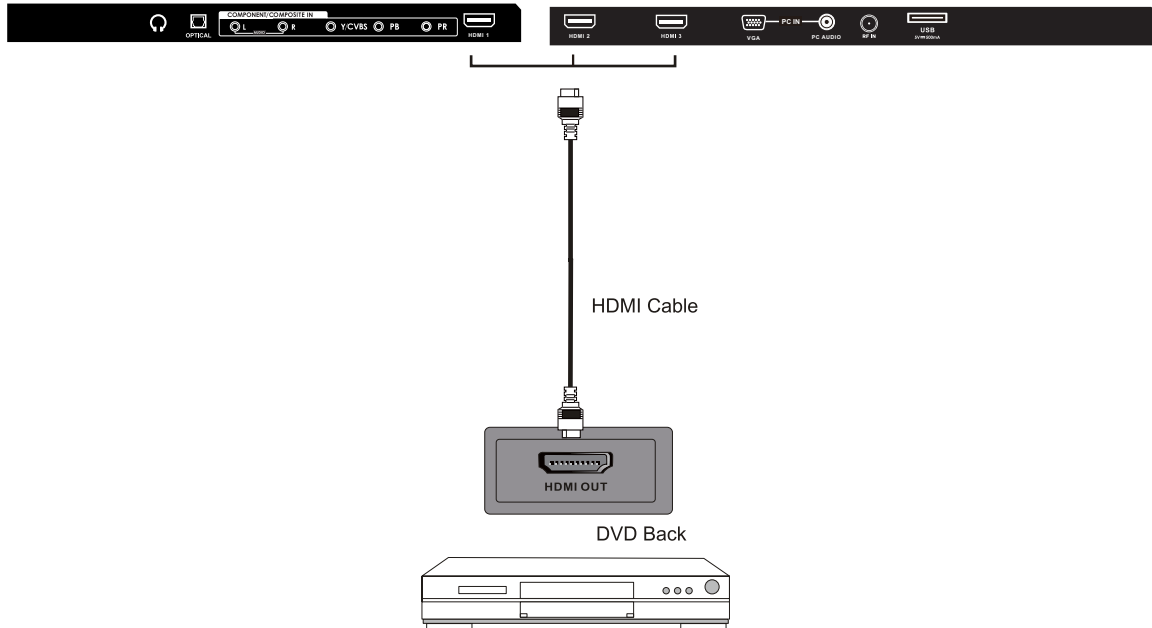

8. REMOTE CONTROL

Remote control instructions in TV mode

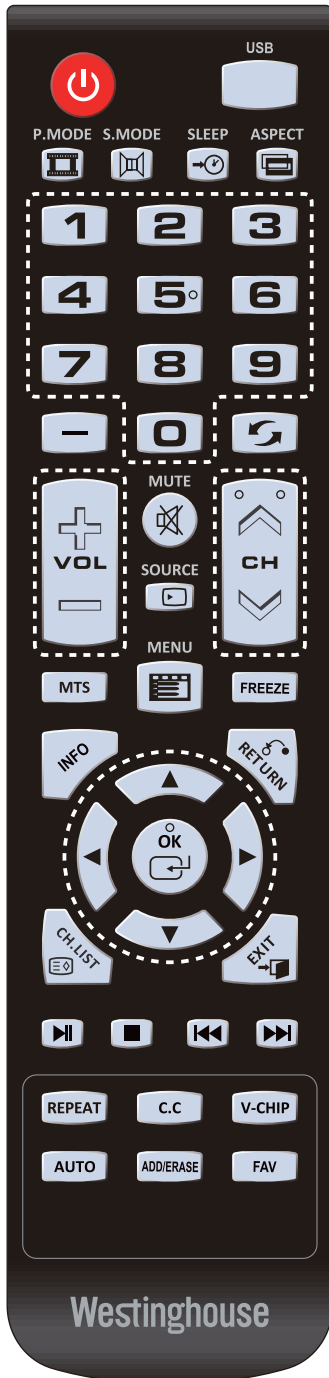

POWER	Turn the LED TV on or off.
USB	Access into the USB directly.
P.MODE	Select the picture mode.
S.MODE	Select the sound mode.
SLEEP	Set the Sleep Timer.
ASPECT	Press to select Aspect Ratio.
NUMBER BUTTONS	Press 0-9 to directly change the TV channel.
-	Press this button to enter a program number for multiple program channel such as 2-1, etc.
	Return to the previous channel viewed
VOL+/VOL-	Press to increase / decrease the sound level.
MUTE	Press once to disable the audio and press again to enable the audio.
SOURCE	Press Source to display the OSD input source, press ▲▼ to select an input source, and then press OK to confirm
CH^/CHv	Press to scan through channels.
MTS	Press to adjust between available audio channel.
MENU	Displays the main TV menu.
FREEZE	Freeze the picture.
INFO	Displays the source and channel information.
THUMBSTICK(▲/ ▼/◀/ ▶/ ok)	Allows you to navigate the on -screen menus and adjust the system settings to your preference.
RETURN	Return to previous menu.
CH.LIST	Press to display TV program list.
EXIT	Exit the main TV menu.
	Press to pause or resume the playback.
	Press to stop the playback and clear the existing memory.
	Press to skip between chapters.
REPEAT	Press repeatedly to select the repeat mode.
C.C	Press to set the closed caption.
V-CHIP	Switch to V-CHIP input.
AUTO	Automatically adjust the Horizontal/Vertical position in PC (VGA) mode.
ADD/ERASE	Add/Erase channel to favourite program list.
FAV	Press to display the favourite program list.

Remote control setup

1. Open the cover.
2. Uses AAA size batteries. When inserting the batteries, make sure correct polarities “+”and “-” marks on the batteries line up correctly with compartment markings.
3. Replace the battery cover.

To prevent battery leakage which may result in bodily injury or damage to the remote:

1. Install all batteries correctly, and as marked on the remote control.
2. Do not mix batteries:(OLD and NEW or CARBON and ALKALINE, etc)
Remove batteries when the remote is not used for a long period of time.



9.Menu Operation

SETUP WIZARD

Select Language

English

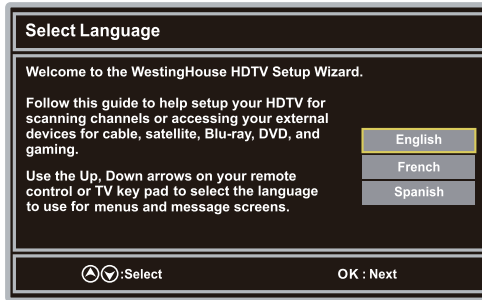

Power On Mode

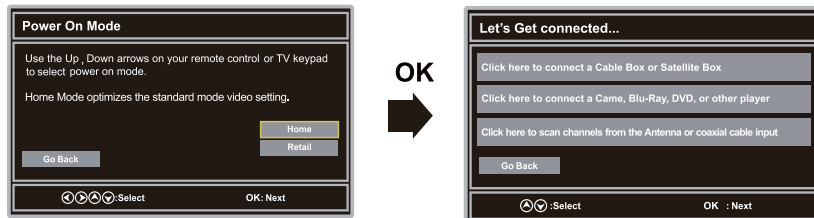

Home Mode (Energy Saving) : Select Home Mode to maximize energy efficiency. Please note if you select Home Mode the picture will be darker.

Retail Mode : Select Retail Mode if you would like your picture to be brighter. At times this mode may use more energy.

The SLEEP-MODE Power should be less than 0.49 W.

Channel Scan

Let's Get connected...

Click here to connect a Cable Box or Satellite Box

Click here to connect a Came, Blu-Ray, DVD, or other player

Click here to scan channels from the Antenna or coaxial cable input

Go Back

⬆️⬆️>Select OK: Next



Scan Channels from the Antenna or coaxial cable input

Use the Up , Down arrows on your remote control or TV key pad to select the channel scan type.

Antenna[ATSC]

Cable

Go Back

⬅️⬆️⬆️>Select OK : Next

Cable or Satellite Source Input

Use the Left, Right arrows on your remote control to select the input connected to the set top box?
For optimal video quality, we recommend HDMI or YPbPr (refer to Quick Connect Guide or User Manual to help you determine what connection you are using).

HDMI YPbPr/AV

Antenna

Go Back

⬅️⬆️⬆️>Select OK: Next



Scanning Channels

Analog	: 0
Digital	: 0
RF CH	: 5
Total Found	: 0

Menu: Exit

Antenna RF Warning

Notice:Westinghouse Digital does not recommend using the RF Antenna input as your cable or satellite connection because it will provide poor video quality to your HDTV. Use a different connection for optimum conditions.If you do not have a cable box that provides an HD quality signal, we recommend that you call your cable provider for an upgrade.Otherwise,select Proceed.

Exit Setup Proceed

Go Back

⬅️⬆️⬆️>Select OK: Next



Source Input List

YPbPr/AV

HDMI

VGA

USB

Go Back

⬆️⬆️⬆️>Select OK: Next

Select Input Source



- Press **SOURCE** button to display the input source list.
- Press **▼/▲** button to select the input source you want to watch.
- Press **ok** button to enter the selected source.

English

Basic Operation



- Press **MENU** button to display the MAIN OSD MENU.
- Press **◀/▶** button to select the MENU you want.
- Press **ok** button to enter the sub menu.
- Press **▼/▲** button to select the option and then press **◀/▶** to adjust the value in the sub menu.
- You can press **MENU** button to go back to the upper menu or **EXIT** button to close the OSD.

For TV Mode:

Picture Menu

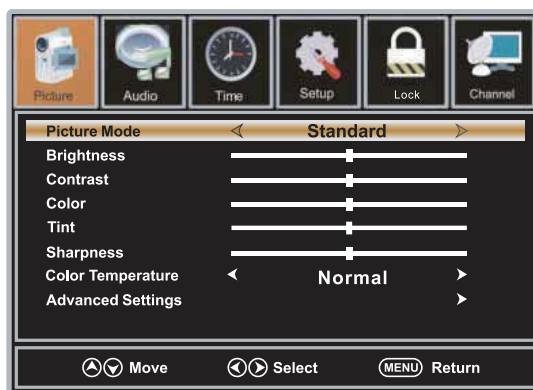

1. Press ◀/▶ button to select **Picture** in the main menu.
2. Press ▼/▲ button to select the option that you want to adjust in the Picture menu.
3. Press ◀/▶ button to desired level.
4. When you have changed the settings, you can exit from the menu by pressing MENU.

Picture Mode

Press ▼/▲ button to select Picture Mode, then press ◀/▶ button to adjust.
Available picture mode: Standard, Retail, Movie, User.

Brightness

Press ▼/▲ button to select Brightness, then press ◀/▶ button to adjust.

Contrast

Press ▼/▲ button to select Contrast, then press ◀/▶ button to adjust.

Color

Press ▼/▲ button to select Color, then press ◀/▶ button to adjust.

Tint

Press ▼/▲ button to select Tint, then press ◀/▶ button to adjust.

Sharpness

Press ▼/▲ button to select Sharpness, then press ◀/▶ button to adjust.

Color Temperature

Press ▼/▲ button to select Color Temperature, then press ◀/▶ button to adjust.

Advanced Settings

Press **▼/▲** button to select Advanced Settings, then press **ok** button to enter.
Adjust advanced video features to fine tune the picture.

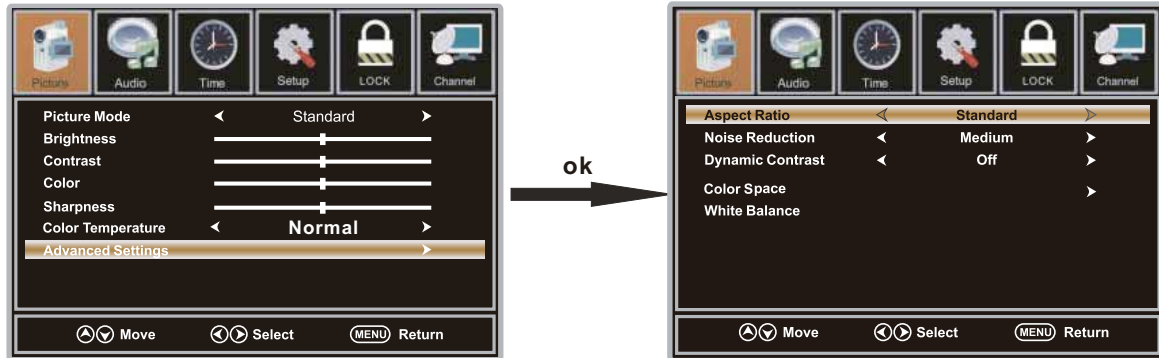

English

Aspect Ratio

Press **▼/▲** button to select Aspect Ratio, then press **◀/▶** button to adjust. Available Aspect Ratio: Standard, Fill, Over Scan.

Noise Reduction

Press **▼/▲** button to select the item Noise Reduction, then press **◀/▶** button to adjust.
Available Noise Reduction: Off, Weak, Medium, Strong.

Dynamic Contrast

Press **▼/▲** button to select Dynamic Contrast, then press **◀/▶** button to adjust On or Off. It can adjust the contrast corresponding to the input signal in order to improve the picture quality displayed.

Color Space

Press **▼/▲** button to select Color Space, then press **ok** button to enter.

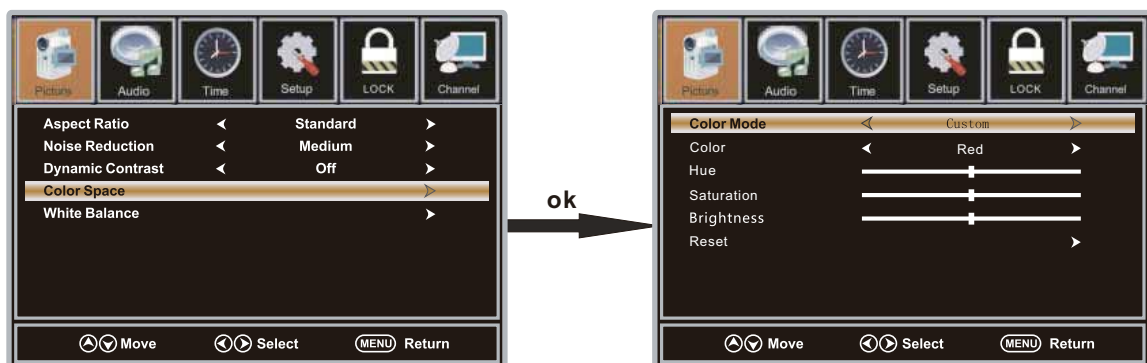

MENU OPERATION

Color Mode

Press ▼/▲ button to select Color Mode, then press ◀/▶ button to adjust. Available Color Mode: Auto, Native, Custom.

Color

Press ▼/▲ button to select Color, then press ◀/▶ button to adjust. Available Color Mode: Red, Green, Blue, Yellow, Cyan, Magenta. (It is available in Custom mode.)

Hue

Press ▼/▲ button to select Hue, then press ◀/▶ button to adjust. (It is available in Custom mode.)

Saturation

Press ▼/▲ button to select Saturation, then press ◀/▶ button to adjust. (It is available in Custom mode.)

Brightness

Press ▼/▲ button to select Brightness, then press ◀/▶ button to adjust. (It is available in Custom mode.)

Reset

Press ▼/▲ button to select Reset, Press **ok** to enter, then press ◀/▶ button to select No or Yes.

White Balance

Press ▼/▲ button to select White Balance, then press **ok** button to enter.

Press ▼/▲ button to select the option you want, then press ◀/▶ button to adjust.



Audio Menu

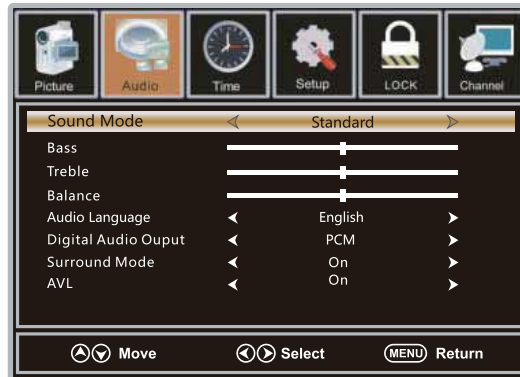

1. Press ◀/▶ button to select **Audio** in the main menu.
2. Press ▼/▲ button to select the option that you want to adjust in the Audio menu.
3. Press ◀/▶ button to desired level.
4. When you have changed the settings, you can exit from the menu by pressing MENU.

Sound Mode

Press ▼/▲ button to select the item Sound Mode, then press ◀/▶ button to select the desired mode. Available Sound Mode: Sports, User, Standard, Music, Movie. Select a sound mode to achieve ideal sound.

Bass

Press ▼/▲ button to select Bass, then press ◀/▶ button to adjust.

Treble

Press ▼/▲ button to select Treble, then press ◀/▶ button to adjust.

Balance

Press ▼/▲ button to select Balance, then press ◀/▶ button to adjust.

Audio Language

Select audio language among: English, French, Spanish

Digital Audio Output

Press ▼/▲ button to select the item Digital Audio Output, then press ◀/▶ button to select the desired digital audio output. Available digital audio output: PCM, Raw and Off.

Surround Mode

Press ▼/▲ button to select the item Surround Mode, then press ◀/▶ button to select On or Off.

AVL

Press ▼/▲ button to select the item AVL, then press ◀/▶ button to select ON or OFF. Auto Volume Level can set the volume automatically adjust corresponding to the input audio.

Time Menu



1. Press ◀/▶ button to select **Time** in the main menu.
2. Press ▼/▲ button to select the option that you want to adjust in the Time menu.
3. Press ◀/▶ button to desired level.
4. When you have changed the settings, you can exit from the menu by pressing MENU.

Sleep Time

Press ▼/▲ button to select Sleep Timer, then press ◀/▶ button to set.

Available Sleep Timer: Off, 5Min, 10Min, 15Min, 30Min, 60Min, 90Min, 120Min, 180Min, 240Min.

Time Zone

Press ▼/▲ button to select Time Zone and press the ◀/▶ button to enter time zone adjustment menu to select the local time zone.

Daylight Saving Time

Press ▼/▲ button to select Daylight Saving Time and press the ◀/▶ button to select On or Off.

Setup Menu



English

1. Press ◀/▶ button to select **Setup** in the main menu.
2. Press ▼/▲ button to select the option that you want to adjust in the Setup menu.
3. Press ◀/▶ button to desired level.
4. When you have changed the settings, you can exit from the menu by pressing MENU.

Menu Language

Press ▼/▲ button to select the item Menu Language, then press ◀/▶ button to adjust.
Available Language: English, Français, Español.

OSD Timeout

Press ▼/▲ button to select OSD Timeout, then press ◀/▶ button to set.
Available OSD Timeout: 5Sec., 15Sec., 30Sec., 45Sec., 60Sec..

Closed Caption

Press ▼/▲ button to select Closed Caption, then press **OK** button to enter.

Accessibility

Enter to select Voice Guide and Video Description function setting.

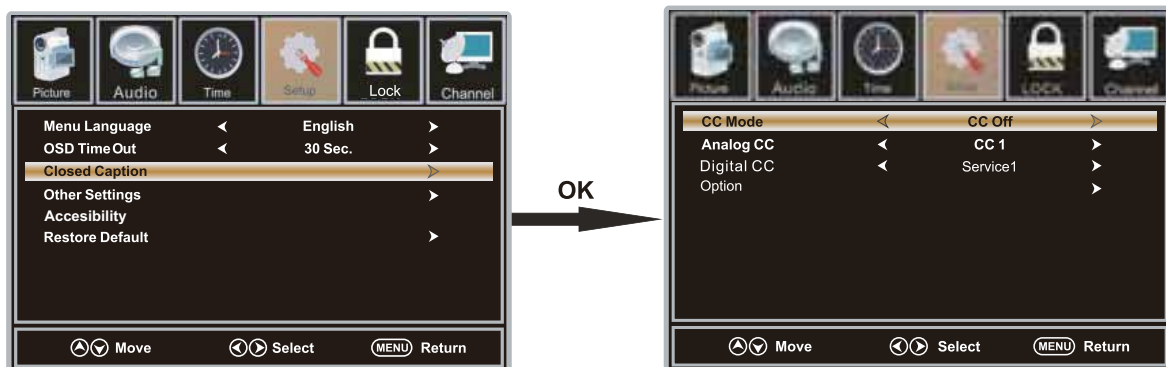

CC Mode

Press ▼/▲ button to select CC Mode, then press ◀/▶ button to select CC Off , CC On, CC on Mute.

MENU OPERATION

Analog CC

Press ▼/▲ button to select Analog CC, then press ◀/▶ button to select.

Available Analog CC: CC1, CC2, CC3, CC4, Text1, Text2, Text3, Text4.

Digital CC

Press ▼/▲ button to select Digital CC, then press ◀/▶ button to select Service1, Service2, Service3, Service4, Service5, Service6.

Option

Press ▼/▲ button to select Option, then press ▶ button enter submenu.

Other Settings

Press ▼/▲ button to select Other Settings, then press **OK** button to enter.

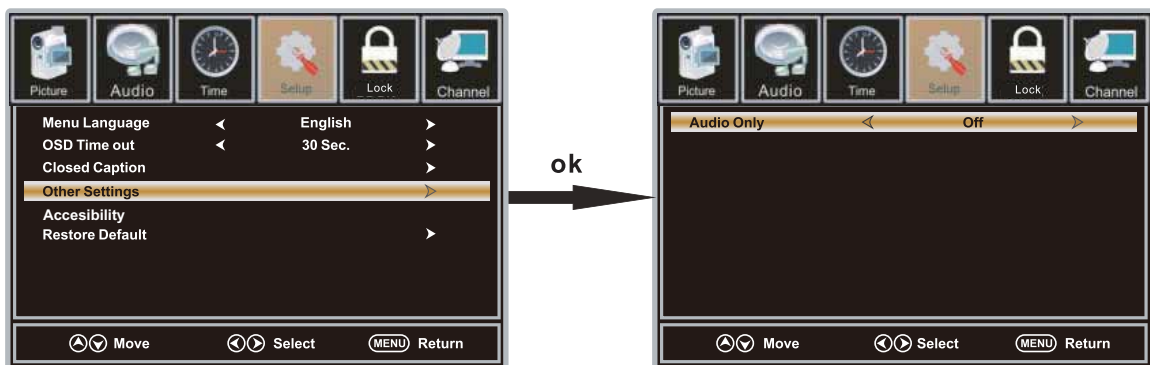

Audio Only

Press ▼/▲ button to select Audio Only, then press ◀/▶ button to set On or Off.

Restore Default

Press ▼/▲ button to select Restore Default, then press **ok** button to select No or Yes.

Change power on options or reset TV to factory default. (0000)

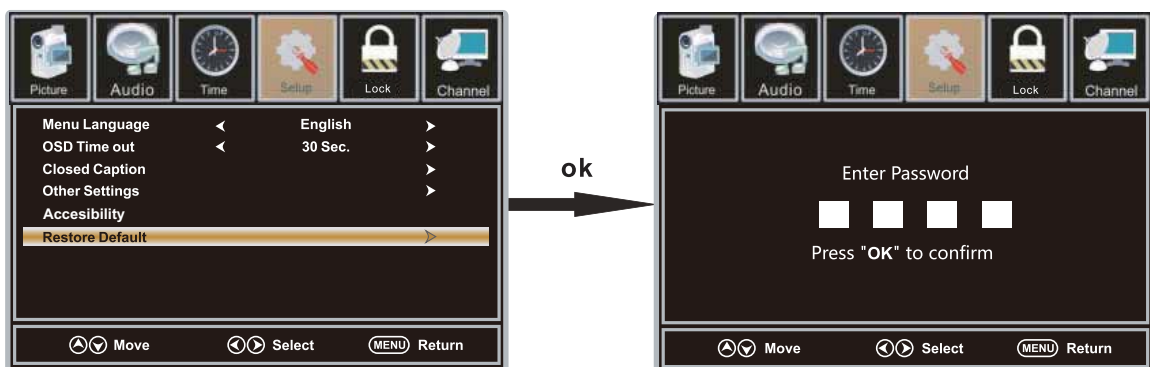

Lock Menu

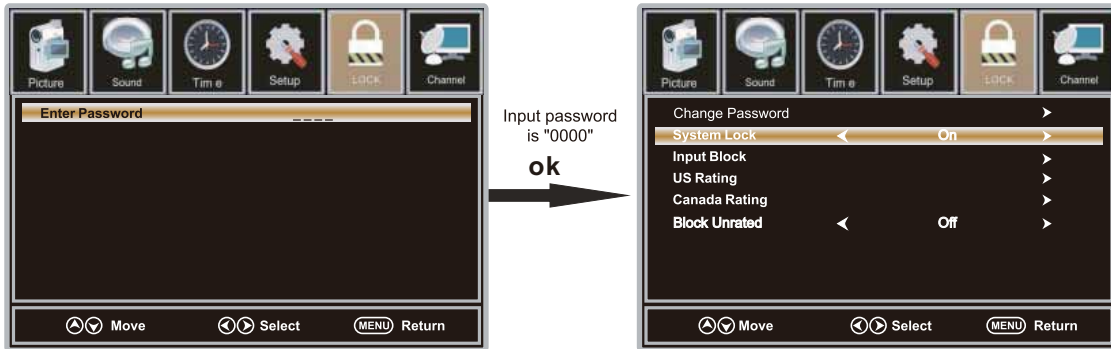

English

1. Press ◀/▶ button to select **Lock** in the main menu.
2. Press ▼/▲ button to select the option that you want to adjust in the Lock menu.
3. Press ◀/▶ button to desired level.
4. When you have changed the settings, you can exit from the menu by pressing MENU.
Input password to enter, default password is "0000".

Change Password

Press ▼/▲ button to select Change Password, then press **ok** button to adjust the value. a sub menu will appear as below. If the password is changed, all of the passwords in the menu will be changed at the same time.

Note: If you forget your password, you can use "8899" to enter any menu locked.

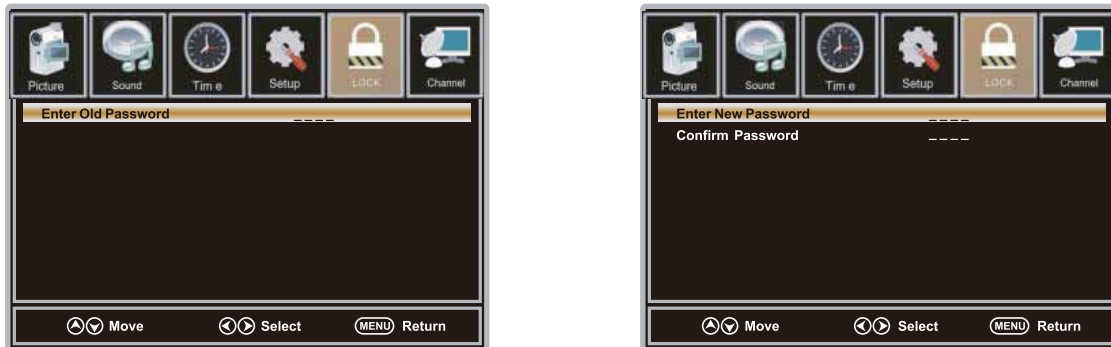

System Lock

Press ▼/▲ button to select System Lock, then press ◀/▶ button to set On or Off. Only available when "System Lock" is "On".

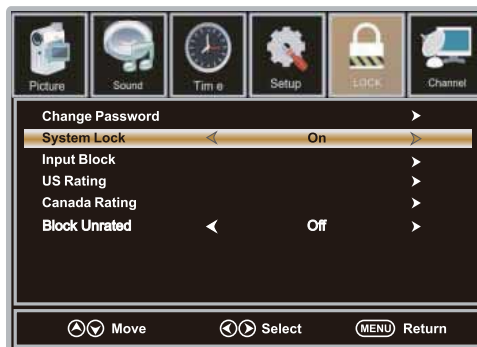

MENU OPERATION

Input Block

Press ▼/▲ button to select Input Block, then press ◀/▶ button to enter.

Press ◀/▶ button to select Unblock or Block the input sources.

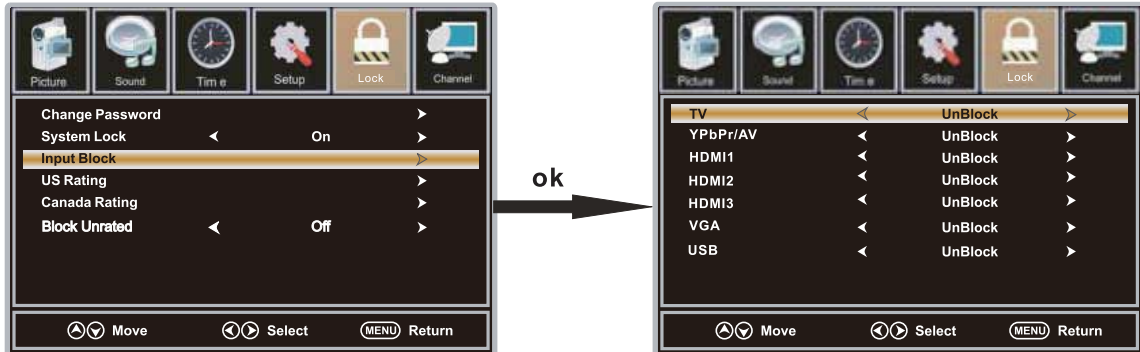

US Rating

Press ▼/▲ button to select US Rating, then press ◀/▶ button to enter. A sub menu will appear as below.

The TV rating composes of two aspects: age-based and content -based.

This system defines the rating control which comes from MPAA rules.

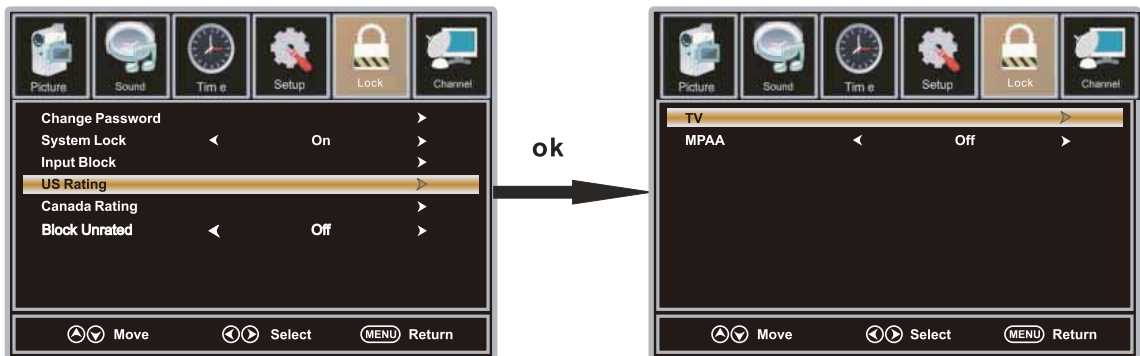

Canada Rating

Press ▼/▲ button to select Canada Rating, then press ◀/▶ button to enter. Press ◀/▶ button to select.

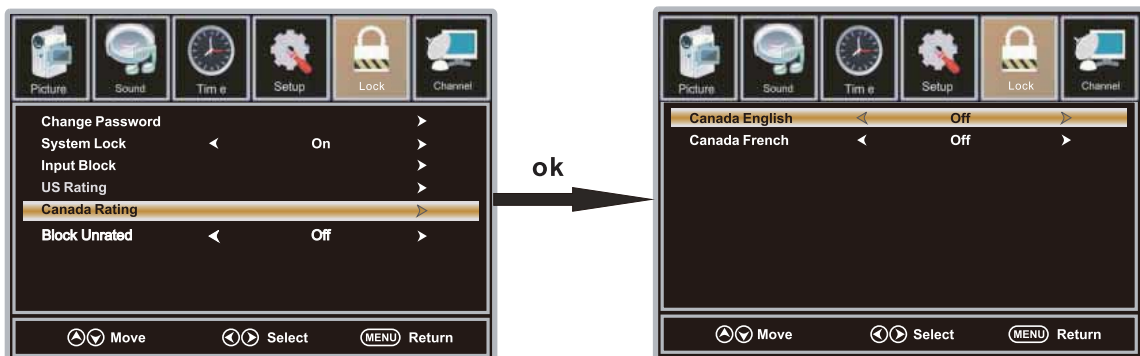

Canada English

Press ▼/▲ button to select Canada English, then press ◀/▶ button to set.

Available Canada English: Off, C, C8+,G, PG, 14+,18+.

Canada French

Press ▼/▲ button to select Canada French, then press ◀/▶ button to set.

Available Canada French: Off, G, 8ans+, 13ans+, 16ans+, 18ans+.

Channel Menu

Note: This menu is only shown when the input source is TV.



English

1. Press ◀/▶ button to select **Channel** in the main menu.
2. Press ▼/▲ button to select the option that you want to adjust in the Channel menu.
3. Press ◀/▶ button to desired level.
4. When you have changed the settings, you can exit from the menu by pressing MENU.

Signal Type

Press ▼/▲ button to select Signal Type, then press ◀/▶ button to set. Available Signal Type: Air, Cable.

Auto Scan

Press ▼/▲ button to select Auto Scan, then press **ok** button to search channel.

A Channel Search Menu will appear as below.



Favorite

Press ▼/▲ button to select Favorite, then press **ok** button to scan the Favorite channel list.



Channel List

Press ▼/▲ button to select Channel List, then press **ok** button to scan the Channel List.



Show/Hide

Press ▼/▲ button to select Show, then press **ok** button to enter .

Show or hide the channels in your program list.

Channel Number

Press ▼/▲ button to select Channel Number, then press ◀/▶ button to adjust.

Channel Label

Press ▼/▲ button to select Channel Label, then press **ok** button to enter.

Create labels for channels, up to 7 characters.

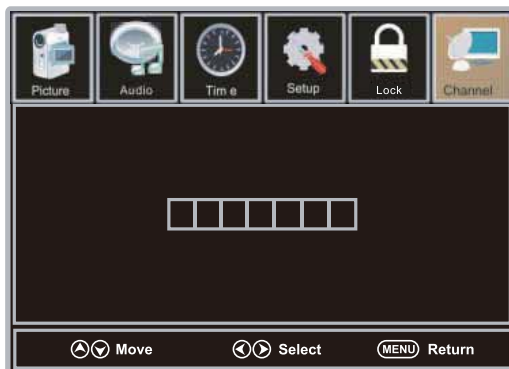

Setup Menu

For VGA Mode :

1. Press ◀/▶ button to select **Setup** in the main menu.
2. Press ▼/▲ button to select VGA Settings, then press **ok** button to enter.
A sub menu will appear as below.

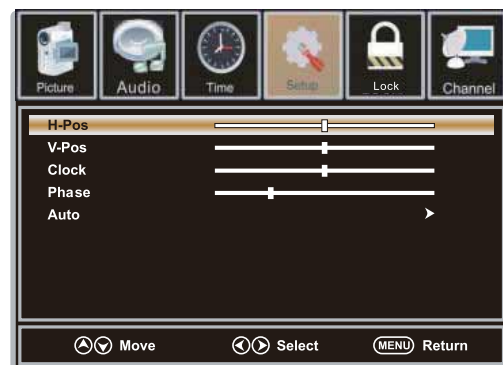

H-Pos

Press ▼/▲ button to select H-Pos, then press ◀/▶ button to adjust.

V-Pos

Press ▼/▲ button to select V-Pos, then press ◀/▶ button to adjust.

Clock

Press ▼/▲ button to select Clock, then press ◀/▶ button to adjust.

Phase

Press ▼/▲ button to select Phase, then press ◀/▶ button to adjust.

Auto

Press ▼/▲ button to select Auto, then press **ok** button to enter.
Adjust to the PC signal timing automatically.

1. PICTURE menu and description are the same as that for TV mode.
2. Audio Language in AUDIO menu is invalid.
3. TIME menu and description are the same as that for TV mode.
4. Close Caption in SETUP menu is invalid.
5. US, Canada, RRT Setting and Reset RRT in LOCK menu is invalid
6. PC mode has no CHANNEL menu.

Note: The operation and description of the hot key are programmable on your remote control.

USB Menu

Note: Before operating Media menu, Plug in USB device, then press SOURCE button to set the Input Source to USB.

Press ▲/▼ button to select USB in the Source menu, then press OK button to enter.

English



Press ◀ / ▶ button to select the option you want to adjust in the main Media menu, then press OK button to enter.

Press ◀ / ▶ button to select JPEG or M-JPEG in the main menu, then press OK button to enter. Press Exit button to return back to the previous menu.



Press ◀ / ▶ button to select drive disk you want to watch, then press OK button to enter. Press ◀ / ▶ button to select Return option to go back to the previous menu.

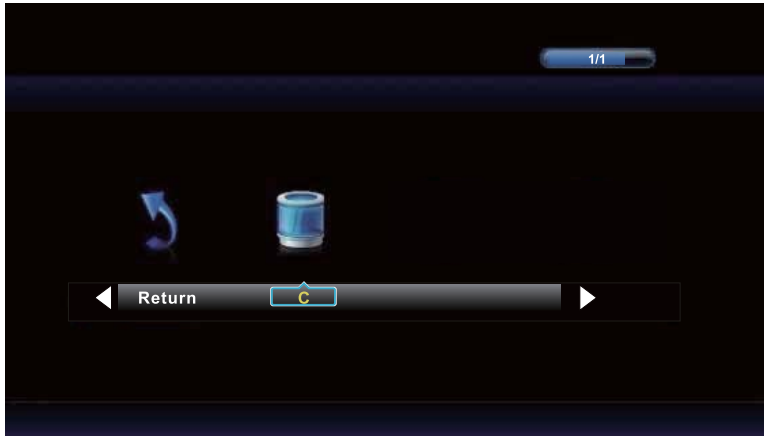

Press ◀ / ▶ button to select the file you want to watch in the file selecting menu, then press OK button to display picture.
When highlighting the option you select, the file information will appear on the right and picture or video will be previewed in the center.

10. Troubleshooting

Please check if you can solve problems by troubleshooting yourself.

Troubleshooting	Control
No signal	Please check that all cables are correctly plugged in.
No color shades	Adjust the contrast, the color and the brightness.
Stain on the screen	May be the result from a lighting signal from car, motor, neon light and other electrical devices or appliances.
Double or multiple display image	May be the result of an electrical wave disturb from other TV, Computer and Game machine or Radio.
Snow on the screen	The cables of the antenna are not correctly plugged in.
The remote control does not work	Please check the batteries order and alignment. Check that the IR of the remote control is not hidden by something.
"Zip" made noise on TV cover	Even if the display image is correct, the noise may come from an unsteady fixation of the panel.
No sound	Make sure that you have not press the MUTE button of the remote control.

The FCC Wants You to Know



FCC STATEMENT

This device complies with Part 15 of the FCC Rules. Operation is subject to the following two conditions:

- (1) This device may not cause harmful interference, and
- (2) This device must accept any interference received, including interference that may cause undesired operation.

Changes or modifications not expressly approved by the party responsible for compliance could void the user's authority to operate the equipment.

NOTE: This equipment has been tested and found to comply with the limits for a Class B digital device, pursuant to Part 15 of the FCC Rules. These limits are designed to provide reasonable protection against harmful interference in a residential installation.

This equipment generates uses and can radiate radio frequency energy and, if not installed and used in accordance with the instructions, may cause harmful interference to radio communications. However, there is no guarantee that interference will not occur in a particular installation. If this equipment does cause harmful interference to radio or television reception, which can be determined by turning the equipment off and on, the user is encouraged to try to correct the interference by one or more of the following measures:

- Reorient or relocate the receiving antenna.
- Increase the separation between the equipment and receiver.
- Connect the equipment into an outlet on a circuit different from that to which the receiver is connected.
- Consult the dealer or an experienced radio/TV technician for help.

FCC Radiation Exposure Statement

This equipment complies with FCC radiation exposure limits set forth for an uncontrolled environment. This equipment should be installed and operated with minimum distance 20cm between the radiator & your body.

11. SPECIFICATIONS

Panel Size	31.5 inch diagonally
Display Type	DLED
Panel Technology	TFT
Panel 60 Hz Vs. 120 Hz	60 Hz
Display Resolution	720P
HDMI Support	Up to 1080P
Panel Resolution	1366 x 768
Aspect Ratio	16:9
Dynamic Contrast Ratio-Panel	1200:1
Response Time (G To G)	8ms
Lamp Life (Typ. Hours)	30,000 hours
Horizontal Viewing Angle (At CR>10)	178
Vertical Viewing Angle (At CR>10)	178
Wall-mount(LxW-mm)	200*100 VESA(mm)

- Do not use your TV in areas that are too hot or too cold, because the cabinet may warp or the screen may malfunction. Your TV works best in temperatures that are comfortable to you.
- Storage temperatures are 32° to 122°F(0° to 50°C).
- Working temperatures are 32° to 95°F(0° to 35°C).
- Do not place your TV in direct sunlight or near a heat source.
 - minimum 5cm distances around the apparatus for sufficient ventilation;
 - the ventilation should not be impeded by covering the ventilation openings with items, such as newspapers, table-cloths, curtains, etc.;
 - no naked flame sources, such as lighted candles, should be placed on the apparatus;
 - attention should be drawn to the environmental aspects of battery disposal.