

User Manual



Factory Default



Version V5.8

Introduction

This is a easily use manual for laser barcode scanner , if you need the more details about how to use , please download from our official website or get the manual from distributors.

Installation

☑ keyboard wedge cable install

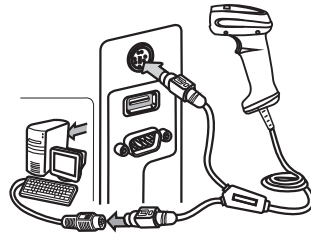

keyboard wedge cable install

☑ USB Cable install (put the cable insert the USB serial directly, The Computer will detection and identification automatically)

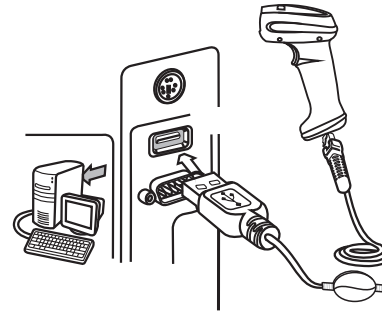

☑ Accessories: Bracket install

1. Use the bracket connector connect to the main body of bracket.
2. Main body of bracket.
3. Philip's screw, Dimensions: M6*10MM
4. Base Support
5. Direct wedged in the base of bracket when the head of bracket and main body connection well.

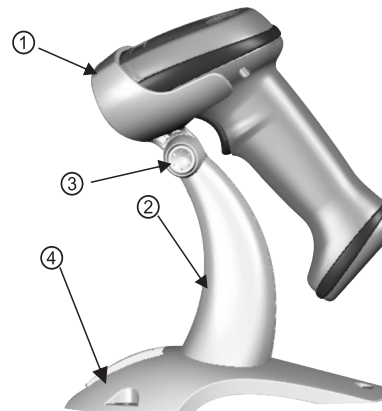

DATA Interface Choose



USB-HID Model*



Ps2-Keyboard Model



USB-COM Model



COM-RS232 Model

Scanning Type



Automatic successive scanning model



Automatic flashing mode

Buzzer



Sound OFF



Sound ON

Barcode Display Tybe



Display barcode type after barcode



UN-Display type after barcode

Keyboard Model

☑ Language Choice



USA



German



France

☑ Keyboard Caps Lock control



None



Capitalize



Lower case

Serial Model

☑ Baud Rate



4800



9600



19200



38400



57600



115200

☑ Prefix&Suffix Setting



AddPre



AddSuff



Hide Before
Character



Hide After Character

Special Code ON



CODE11



CODE 39



FULL ASCII



CODE 93



CODE 128



CODE 128ISBT



CODEBAR



Enable Interleaved
2 of 5



Industrial 2 of 5



Matrix 2 of 5



CHINA POST CODE



MSI CODE



UPC-A



UPC-E



EAN-13



EAN-8

☑ Suffix & Skip Setting



CR



LF



CR&LF



Tab



Space



None

Wireless Setting



RF Model



Delet ADD



Setting DeviceADD



01



02



03



04



Pairs ADD



Inventory Mode



Up lodaing New Date



Up lodaing ALL Date



Up lodaing Statistic Date



Reset



Reset

Federal Communications Commission (FCC) Statement

This device complies with part 15 of the FCC Rules. Operation is subject to the following two conditions: (1) This device may not cause harmful interference, and (2) this device must accept any interference received, including interference that may cause undesired operation.

Note: This equipment has been tested and found to comply with the limits for a Class B digital device, pursuant to part 15 of the FCC Rules. These limits are designed to provide reasonable protection against harmful interference in a residential installation. This equipment generates, uses and can radiate radio frequency energy and, if not installed and used in accordance with the instructions, may cause harmful interference to radio communications. However, there is no guarantee that interference will not occur in a particular installation. If this equipment does cause harmful interference to radio or television reception, which can be determined by turning the equipment off and on, the user is encouraged to try to correct the interference by one or more of the following measures:

- Reorient or relocate the receiving antenna.
- Increase the separation between the equipment and receiver.
- Connect the equipment into an outlet on a circuit different from that to which the receiver is connected.
- Consult the dealer or an experienced radio/TV technician for help.

Warning: Changes or modifications made to this device not expressly approved by **Guangzhou Xunbao Electronics Technology Co., LTD** may void the FCC authorization to operate this device.

Note: The manufacturer is not responsible for any radio or tv interference caused by unauthorized modifications to this equipment. Such modifications could void the user's authority to operate the equipment.