



Mars 4K

Quick Guide

V1.0.0



WELCOME



Thank you for purchasing the Mars 4K wireless video transmission system. Please read the instruction carefully before using the product. We you a pleasant experience.



KEY FEATURES



- 4K 30FPS HDMI input and output
- Color LCD display
- Intelligent channel selection upon power-on
- 66ms transmission latency
- 1,300ft (450m) wireless transmission distance (LOS range) for the receiver
- 260ft (80m) wireless transmission distance (LOS range) for the app
- SDI input and HDMI input for the transmitter
- SDI output and HDMI output for the receiver
- DC, NP-F battery, and USB-C power supply

PACKING LIST

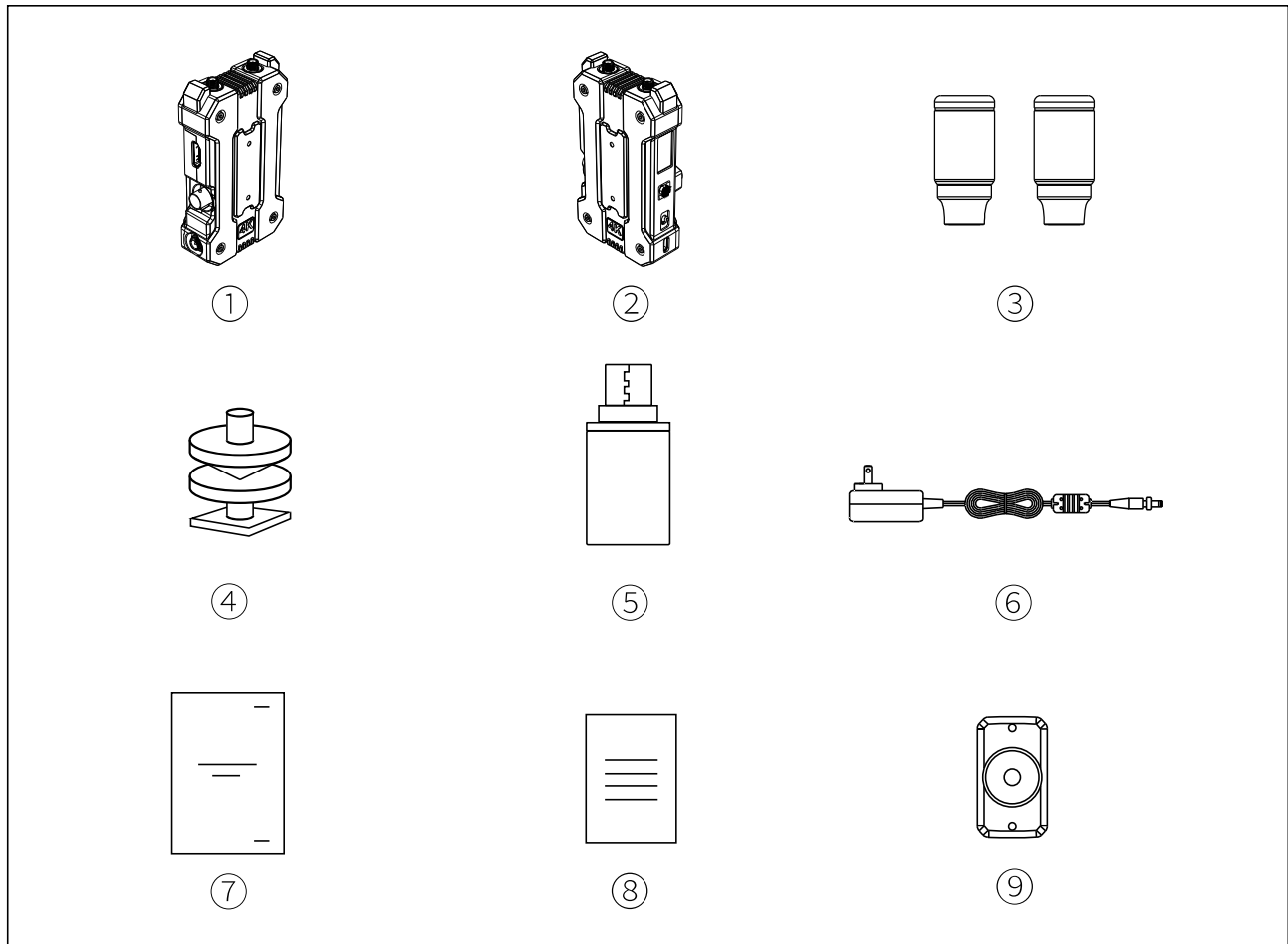

SKU	1 TX to 1 RX	1 TX	1 RX
① Transmitter	1	1	0
② Receiver	1	0	1
③ Antenna	5	2	2
④ Cold Shoe	1	0	0
⑤ Type-C OTG Converter	1	0	0
⑥ Self-locking DC Adapter	1	1	1
⑦ User Guide	1	1	1
⑧ Warranty Card	1	1	1
⑨ Expansion Accessory	1	0	0

Note: The quantity depends on the configuration and is subject to the actual list of equipment purchased.

PRODUCT CONNECTION

TYPICAL SETUP

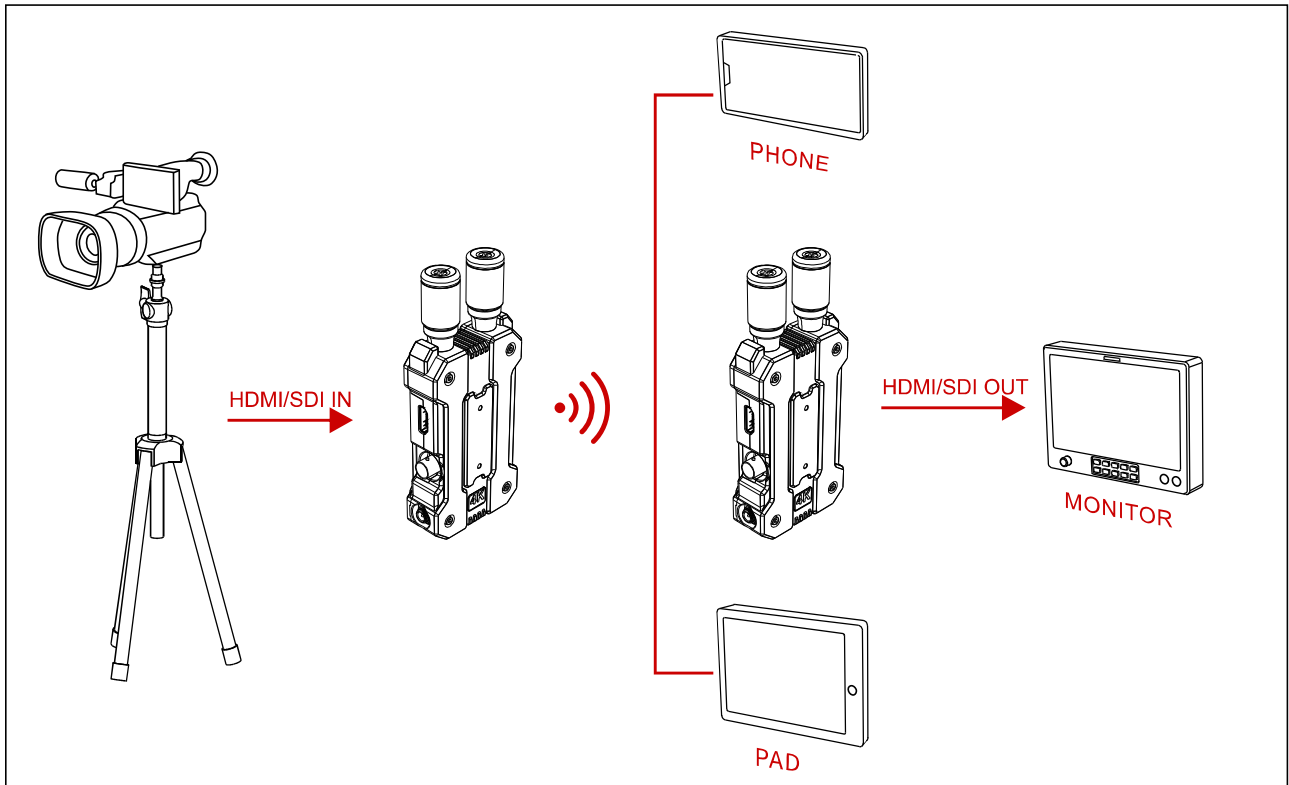

DUAL MONITOR SETUP

