



# Mars 4K

Quick Guide

V1.0.0

# WELCOME

Thank you for purchasing the Mars 4K wireless video transmission system. Please read the instruction carefully before using the product. We you a pleasant experience.

## KEY FEATURES

- HDMI input and output maximum support 4K30 fps
- Colorful LCD display
- Smart channel selection upon power-on
- The device's transmission latency average is 66ms
- The device supports 1,000ft(300m) wireless transmission distance (LOS)
- The mobile App supports 260ft(80m) wireless transmission distance (LOS)
- The Transmitter supports SDI input and HDMI input
- The Receiver supports SDI output and HDMI output
- DC power supply, battery, and USB-C

# PACKING LIST

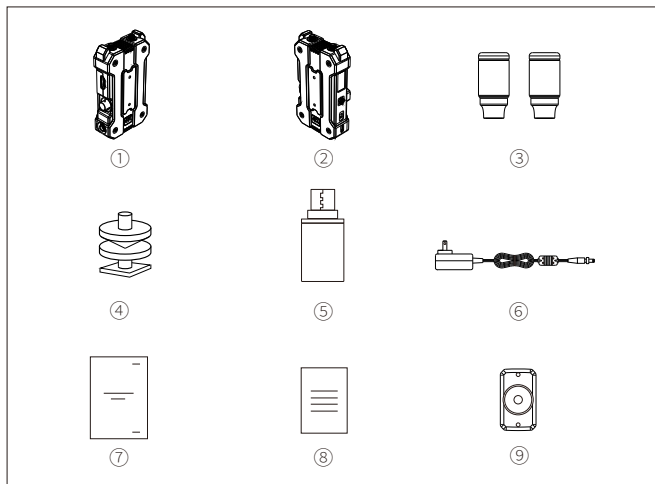

SKU	1 TX to 1 RX	1 TX	1 RX
① Transmitter	1	1	0
② Receiver	1	0	1
③ Antenna	5	2	2
④ Cold Shoe	1	0	0
⑤ Type-C OTG Converter	1	0	0
⑥ Self-locking DC Adapter	1	1	1
⑦ User Guide	1	1	1
⑧ Warranty Card	1	1	1
⑨ Expansion Accessory	1	0	0

Note: The quantity depends on the configuration and is subject to the actual list of equipment purchased.

## PRODUCT CONNECTION

### TYPICAL SETUP

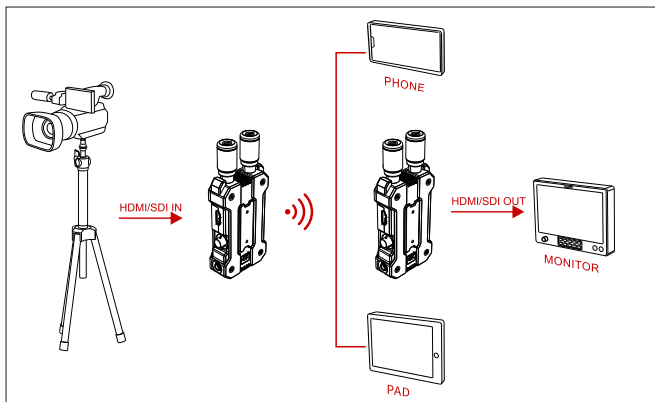

### DUAL MONITOR SETUP

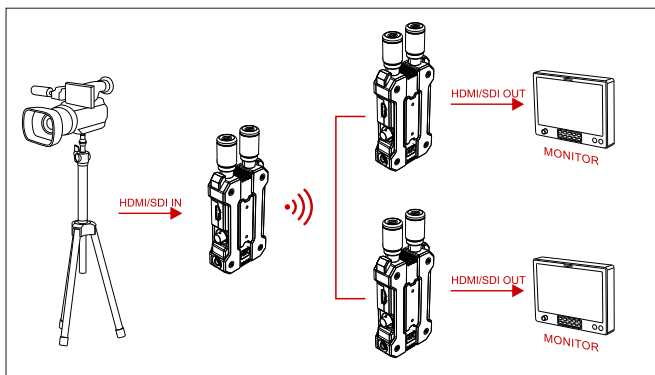

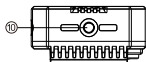
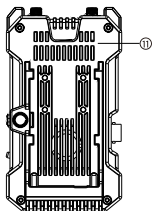
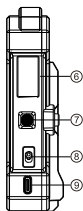
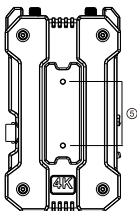
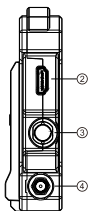
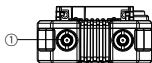

A

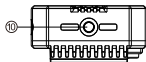
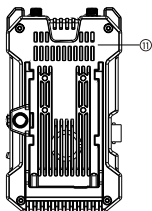
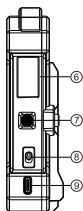
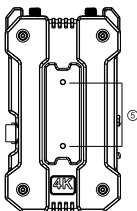
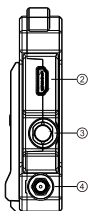
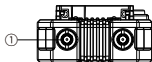

B

# PRODUCT INTRODUCTION

## **A** Transmitter:

- ① Antenna Port
- ② HDMI Input
- ③ SDI Input
- ④ DC Power Input
- ⑤ Expansion Accessories Mounting Hole
- ⑥ Colorful LCD Display
- ⑦ Menu Button
- ⑧ Power Switch
- ⑨ USB-C Interface
- ⑩ 1/4 Threaded Hole
- ⑪ Outlet

## **B** Receiver:

- ① Antenna Port
- ② HDMI Output
- ③ SDI Output
- ④ DC Power Input
- ⑤ Expansion Accessories Mounting Hole
- ⑥ Colorful LCD Display
- ⑦ Menu Button
- ⑧ Power Switch
- ⑨ USB-C Interface
- ⑩ 1/4 Threaded Hole
- ⑪ Outlet

# INSTALLATION

## INSTALLATION OF TRANSMITTER

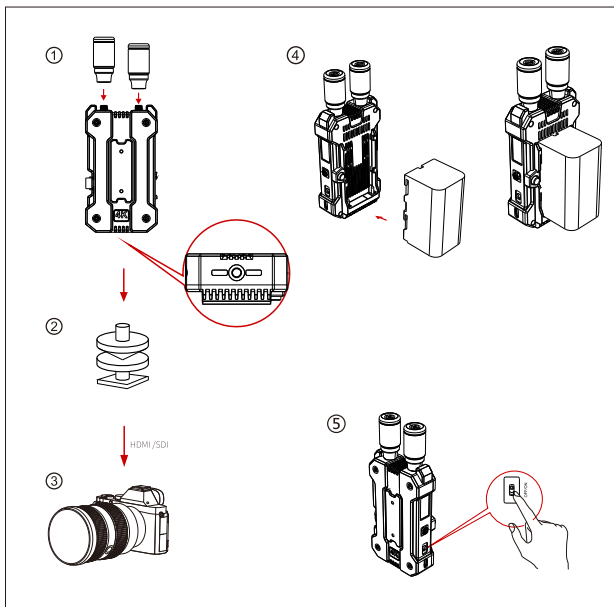

① Install the antenna shown in the picture.

② Install the transmitter to the camera with the cold shoe.

③ Connect the transmitter to the corresponding interface of the camera with an HDMI cable or SDI cable.

④ Install the battery (compatible with NP-F970, or others of the same series).

⑤ Push the power switch up to turn on the device.



# INSTALLATION

## INSTALLATION OF RECEIVER

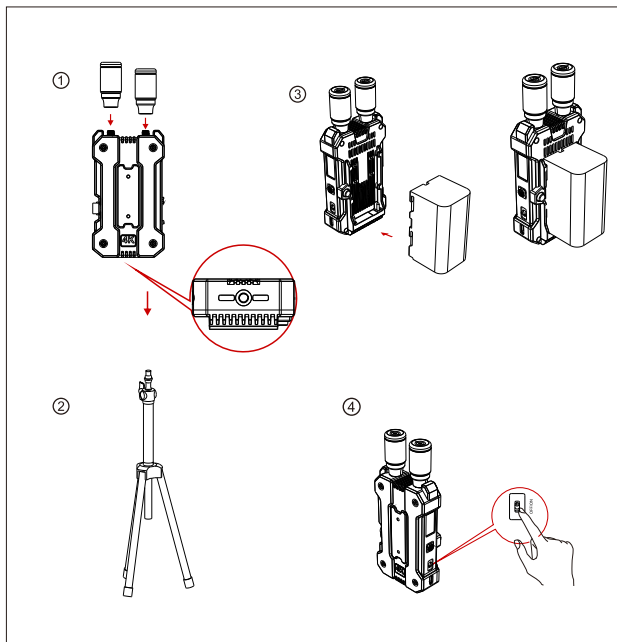

- ① Install the antenna shown in the picture.
- ② Install the receiver onto the stand through the 1/4 threaded hole on the bottom of the device.
- ③ Install the battery (compatible with NP-F970, or others of the same series).
- ④ Push the power switch up to turn on the device.

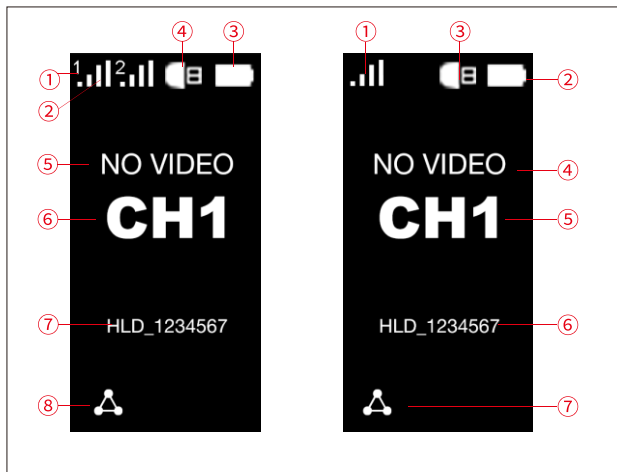

## A Transmitter:

- ① Receiver Device Number
- ② Signal Strength
- ③ Indicator of Power Supply
- ④ USB Plugged In
- ⑤ Video Format
- ⑥ Channel Display
- ⑦ Device Wi-Fi ID
- ⑧ Application Scene Mode

## B Receiver:

- ① Signal Strength
- ② Indicator of Power Supply
- ③ USB Plugged In
- ④ Video Format
- ⑤ Channel Display
- ⑥ Device Wi-Fi ID
- ⑦ Application Scene Mode

## QUICK GUIDE

### CHANNEL SWITCHING

Click UP or DOWN to switch the menu options on the transmitter or receiver, click OK to confirm the channel, then the receiver and transmitter channel will be synchronized automatically.

### ENTER MENU

Long press OK for three seconds to enter the menu. Click UP or DOWN to switch menu options and click OK to confirm.

### APP INSTALLATION and CONNECTION

1.Download the HollyView App



2.Connecting Method:

Enter the WiFi connection interface of mobile phone and find out the WiFi named as "HLD + DEVICE ID", and input the WiFi password to connect (Factory Default Password is: 12345678). After successful connection, you can have the APP monitoring..

## PARAMETERS

	Transmitter	Receiver
Interface	Antenna Port (RP-SMA Male) HDM Input (Type A Female) SDI Input DC Input USB Type-C	Antenna Port (RP-SMA Male) HDMI Output (Type A Female) SDI Output DC Input USB-C
Power Supply	DC Power Input: 6-16V USB Type-C Power Supply: 5V/2A Battery Power Supply: 6.8-8.4V	DC Power Input: 6-16V USB-C Power Supply: 5V/2A Battery Power Supply: 6.8-8.4V
Power Consumption	<11W	<7W
Weight	223g (Without Exterior Antenna)	223g (Without Exterior Antenna)
Dimension	(L*W*H) : 115*65*32mm (Excluding The Battery Plate)	(L*W*H) : 115*65*32mm (Excluding The Battery Plate)
Frequency	5GHz	5GHz
Transmission Power	Maximum 21dBm	Maximum 21dBm
Receiver Sensitivity	\	-80dBm
Transmission Latency	About 66ms	
Bandwidth	20MHz	20MHz

HDMI Input Format	HDMI Output Format	SDI Output Format
720p50/59.94/60	720p50/60	720p50/60
1080i50/59.94/60	1080i50/60	1080i50/60
1080p23.98/24/25/29.97/30	1080p24/25/30	1080p24/25/30
1080p50/59.94/60	1080p50/60	1080p50/60
3840*2160 24/25/30	3840*2160 24/25/30	1080P24/25/30

SDI Input Format	SDI Output Format	HDMI Output Format
1080p50/59.94/60(Level A)	1080p50/60(Level A)	1080p50/60
1080p50/59.94/60(Level B)		
1080i50/59.94/60	1080i50/60	1080i50/60
1080p23.98/24/25/29.97/30	1080p24/25/30	1080p24/25/30
1080psf23.98/24/25/30	1080i50/60	1080i50/60
720p50/59.94/60	720p50/60	720p50/60

## SUPPORT

If encounter any problems in using the product or need any help, please follow these ways to get more technical support:

 Hollyland Products User Group

 HollylandTech

 HollylandTech

 [Support@hollyland-tech.com](mailto:Support@hollyland-tech.com)

 [www.hollyland-tech.com](http://www.hollyland-tech.com)

**Note:** The frequency range and wireless transmit power of the device vary based on the regulations of different countries and regions.

### **Safety Precautions**

Do not place the product near or inside heating devices (including but not limited to microwave ovens, induction cookers, electric ovens, electric heaters, pressure cookers, water heaters, gas stoves) to prevent the battery from overheating and exploding.

Never use non-original charging cases, cables, and batteries with the product.

The use of non-original spare parts may cause electric shock, fire, explosion, or other dangers.

**FCC Requirement**

Any changes or modifications not expressly approved by the party responsible for compliance could void the user's authority to operate the equipment.

This device complies with Part 15 of the FCC Rules. Operation is subject to the following two conditions:

- (1) this device may not cause harmful interference.
- (2) this device must accept any interference received, including interference that may cause undesired operation.

**Note:**

This equipment has been tested and found to comply with the limits for a Class B digital device, pursuant to Part 15 of the FCC Rules. These limits are designed to provide reasonable protection against harmful interference in a residential installation. This equipment generates, uses, and can radiate radio frequency energy, and if not installed and used in accordance with the instructions, may cause harmful interference to radio communications. However, there is no guarantee that interference will not occur in a particular installation. If this equipment does cause harmful interference to radio or television reception, which can be determined by turning the equipment off and on, the user is encouraged to try to correct the interference by one or more of the following measures:

- Reorient or relocate the receiving antenna.
- Increase the separation between the equipment and receiver.
- Connect the equipment into an outlet on a circuit different from that to which the receiver is connected.
- Consult the dealer or an experienced radio/TV technician for help.

**This equipment should be installed and operated with a minimum distance of 20cm between the radiator and your body.**