

# Explosion diagram specification

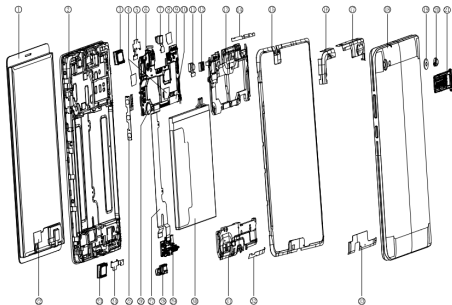

1	LCD	2	Front case
3	Speaker	4	Camera ZIF mylar
5	Speaker FPC	6	Earphone waterproof silicone
7	Front camera	8	Camera ZIF mylar
9	mainboard	10	TP_ZIF mylar
11	Back camera	12	Back camera silicone
13	Mainboard bracket	14	Main bracket waterproof mylar
15	Front and rear case sealing foam	16	BT& wifi & GPS antenna FPC
17	Main antenna FPC	18	Bottom case & side key
19	Back camera lens	20	Rear flash light cover
21	SIM slot component	22	TP-ZIF mylar
23	speaker	24	Speaker FPC
25	Sidekey FPC	26	vibrator
27	Main FPC	28	USB waterproof silicone

29	subboard	30	baterry
31	subboard bracket	32	subboard bracket waterproof mylar
33	defocus mylar	34	

## Know your Tablet

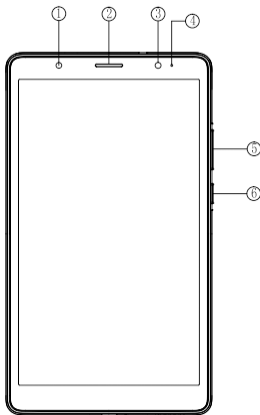

- 1.front camera
- 3.front flash light
- 5.volumer key

- 2.receiver
4. BLN
- 6.power key

## SIM/SD card installation

1. Power off mobile.
2. Refer to the following picture for SIM / SD card installation.

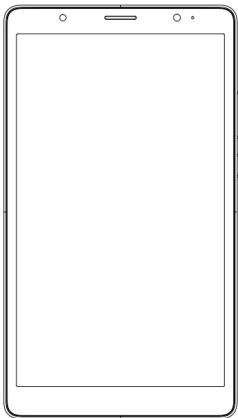

## Charging the Tablet

You can charge your device using a charger or by connecting it to the computer using a USB cable (comes with the tablet).

1. Please remind the front and back of the plug.
2. Use only TECNO charger and cables. Other chargers or cables may damage the device. This will invalidate your tablet warranty.

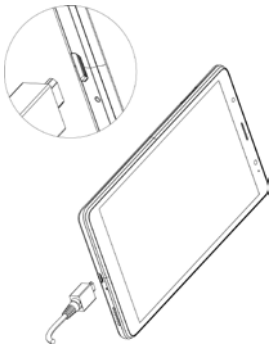

# FCC Caution:

Any Changes or modifications not expressly approved by the party responsible for compliance could void the user's authority to operate the equipment.

This device complies with part 15 of the FCC Rules.

Operation is subject to the following two conditions: (1)

This device may not cause harmful interference, and (2)

this device must accept any interference received,

including interference that may cause undesired

operation.

Note: This equipment has been tested and found to comply with the limits for a Class B digital device, pursuant to part 15 of the FCC Rules. These limits are designed to provide reasonable protection against harmful interference in a residential installation. This equipment generates, uses and can radiate radio frequency energy and, if not installed and used in accordance with the instructions, may cause harmful

interference to radio communications. However, there is no guarantee that interference will not occur in a particular installation. If this equipment does cause harmful interference to radio or television reception, which can be determined by turning the equipment off and on, the user is encouraged to try to correct the interference by one or more of the following measures:

—Reorient or relocate the receiving antenna.

—Increase the separation between the equipment and receiver.

—Connect the equipment into an outlet on a circuit different from that to which the receiver is connected.

—Consult the dealer or an experienced radio/TV technician for help.

Specific Absorption Rate (SAR) information

SAR tests are conducted using standard operating positions

accepted by the FCC with the tablet transmitting at its highest certified power level in all tested frequency bands, although the SAR is determined at the highest certified power level, the actual SAR level of the tablet while operating can be well below the maximum value. Before a new model tablet is available for sale to the public, it must be tested and certified to the FCC that it does not exceed the exposure limit established by the FCC, tests for each tablet are performed in positions and locations as required by the FCC.

For body worn operation, this model tablet has been tested and meets the FCC RF exposure guidelines when used with an accessory designated for this product or when used with an accessory that contains no metal and that positions the tablet a minimum of 2.5mm from the body. Non-compliance with the above restrictions may result in violation of RF exposure guidelines