

Explosion diagram specification

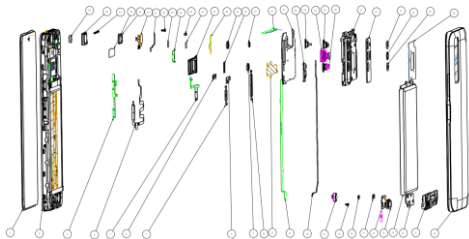

1	FL(CTP+LCM)6.95FHD+h X693 Black TXD V1.0	2	F hsg asm LE7 Black
3	FPC Side Key LE7	4	fingerprint(GSL6157)_08_fin gerchip
5	FPC Google AI Key LE7	6	Bat CONN Rubber 15.66 *4.18 X693 Black
7	Google AI key LE7 Bordeaux Red highlight)	8	LCM CONN Rubber 18.85* 5.75 X693 Black
9	R CAM Rubber 2M LE7 Black	10	Vol Key LE7 Polar Silver matt
11	MAIN Radiating Film 54.6* 16.35 X693	12	FPC MAIN LE7
13	coaxial cable KTA S 158.5 LE7 RoHS	14	MOT_COIN_0827_L12_H_JX
15	mc screw M1.4*L2.5* D2.5*H0.5 silver glue	16	mc screw M1.4*L1.2* D3.5*H0.4 silver glue
17	SUB PCB CONN Rubber 9.4* 3.5 X693 Black	18	SUB PCBA_H697_JACK _2_A V1.1
19	USB Rubber LE7 Black	20	battery__TECNO_BL_68AT _6850mAh_ATL_IN
21	SUB PCBA_H697_2_A_V1.1	22	DOWN frame asm LE7 Black

23	Bat cover asm LE7 Polar Silver spray	24	UP Frame Support Foam 35.95*36.5 LE7
25	R vice CAM Lens LE7 rainbowGlass0.5Black	26	R MAIN CAM Lens LE7 rainbowGlass0.5Black
27	R vice CAM Lens LE7 rainbowGlass0.5Black	28	R CAM Deco LE7 composite board
29	UP frame asm LE7 Black spray	30	camera_FF_2M_GC02M1B_YM_P_3P+IR_B_SJ_V1.0
31	camera_FF_2M_GC02M1_A_P_3P+IR_B_LHYX_V1.0	32	camera_AF_48M_GM1ST03_A_A_6P_B_ST_V1.0
33	camera_FF_8W_GC6153_A_P_1P_B_30P_XCG_V1.0	34	R CAM Frame 2M LE7
35	MAIN PCBA_H697_G1_64GB+4GB_V1.2	36	MAIN Waterproof Mylar 62.5*6.2 LE7
37	R CAM Rubber 8W LE7 Black	38	R CAM CONN Rubber 9.9*4.25 X693 Black
39	R CAM Rubber 2M LE7 Black	40	F CAM Cop foil 12.74*6.6 LE7
41	Card Holder LE7 Polar Silver Matt)	42	R CAM Con Foams 2M 7.89*5 X693
43	Distance Sensor Rubber LE7 Black	44	R CAM Con Foams 48M 15.5*12.9 LE7
45	R CAM Con Foam 8W 5*5 LE7	46	mc screw M1.4*L3.5*D2.5 *H0.5 silver glue
47	UP SPK Radiating Film 14.3*5.5 X693	48	camera_FF_8M_GC8034_B_B_4P+BG_B_TS_V1.0
49	F CAM frame asm 8M LE7	50	Shield Radiating Cop foil 30.6*8 X693
51	REC Deco part LE7 Black	52	spk_1115_SPR_H2.5_1.0W_AC
53	F CAM Rubber 8M LE7 Black	54	

Know your phone

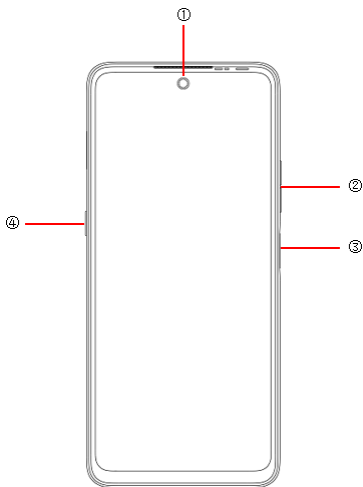

1. Front camera
2. Volume key
3. Power key
4. power-plus button
- 5.

SIM/SD card installation

1. Power off mobile.
2. Refer to the following picture for SIM / SD card installation.

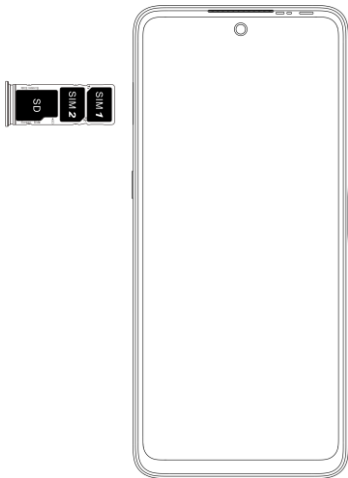

Charging the phone

You can charge your device using a charger or by connecting it to the computer using a USB cable (comes with the phone).

1. Please remind the front and back of the plug.
2. Use only TECNO charger and cables. Other chargers or cables may damage the device. This will invalidate your phone warranty.

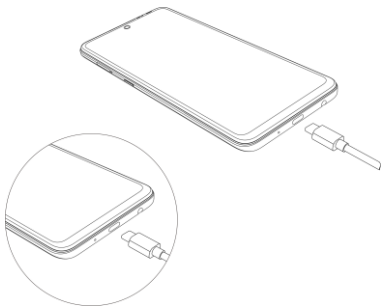

FCC Statement

1.This device complies with Part 15 of the FCC Rules. Operation is subject to the following two conditions:

- (1) This device may not cause harmful interference.
- (2) This device must accept any interference received, including interference that may cause undesired operation.

2.Changes or modifications not expressly approved by the party responsible for compliance could void the user's authority to operate the equipment.

NOTE:

This equipment has been tested and found to comply with the limits for a Class B digital device, pursuant to Part 15 of the FCC Rules. These limits are designed to provide reasonable protection against harmful interference in a residential installation.

This equipment generates uses and can radiate radio frequency energy and, if not installed and used in accordance with the instructions, may cause harmful interference to radio communications. However, there is no guarantee that interference will not occur in a particular installation. If this equipment does cause harmful interference to radio or television reception, which can be determined by turning the equipment off and on, the user is encouraged to try to correct the interference by one or more of the following measures:

Reorient or relocate the receiving antenna.

Increase the separation between the equipment and receiver.´

Connect the equipment into an outlet on a circuit different from that to which the receiver is connected.

Consult the dealer or an experienced radio/TV technician for help.

SAR Information Statement

Your wireless phone is a radio transmitter and receiver. It is designed and manufactured not to exceed the emission limits for exposure to

radiofrequency (RF) energy set by the Federal Communications Commission of the U.S. Government. These limits are part of comprehensive guidelines and establish permitted levels of RF energy for the general population. The guidelines are based on standards that were developed by independent scientific organizations through periodic and thorough evaluation of scientific studies. The standards include a substantial safety margin designed to assure the safety of all persons, regardless of age and health. The exposure standard for wireless mobile phones employs a unit of measurement known as the Specific Absorption Rate, or SAR. The SAR limit set by the FCC is 1.6 W/kg. * Tests for SAR are conducted with the phone transmitting at its highest certified power level in all tested frequency bands. Although the SAR is determined at the highest certified power level, the actual SAR level of the phone while operating can be well below the maximum value. This is because the phone is designed to operate at multiple power levels so as to use only the power required to reach the network. In general, the closer you are to a wireless base station antenna, the lower the power output. Before a phone model is available for sale to the public, it must be tested and certified to the FCC that it does not exceed the limit established by the government adopted requirement for safe exposure. The tests are performed in positions and locations (e.g., at the ear and worn on the body) as required by the FCC for each model. The highest SAR value for this model phone when tested for use at the ear is **1.143W/Kg** and when worn on the body, as described in this user guide, is **0.445W/Kg**(Body-worn measurements differ among phone models, depending upon available accessories and FCC requirements). The maximum scaled SAR in hotspot mode is **0.530W/Kg**. While there may be differences between the SAR levels of various phones and at various positions, they all meet the government requirement for safe exposure. The FCC has granted an Equipment Authorization for this model phone with all reported SAR levels evaluated as in compliance with the FCC RFexposure guidelines. SAR information on this model phone is on file with the FCC and can be found under the Display Grant section of <http://www.fcc.gov/oet/fccid> after searching on

FCC ID: **2ADYY-LE7** Additional information on Specific Absorption Rates (SAR) can be found on the Cellular Telecommunications Industry Association (CTIA) web-site at <http://www.wow-com.com>. * In the United States and Canada, the SAR limit for mobile phones used by the public is 1.6 watts/kg (W/kg) averaged over one gram of tissue. The standard

incorporates a substantial margin of safety to give additional protection for the public and to account for any variations in measurements.

Body-worn Operation

This device was tested for typical body-worn operations. To comply with RF exposure requirements, a minimum separation distance

of 10mm must be maintained between the user's body and the handset, including the antenna. Third-party belt-clips, holsters,

and similar accessories used by this device should not contain any metallic components. Body-worn accessories that do not meet these requirements may not comply with RF exposure requirements and should be avoided. Use only the supplied or an approved

TECNO

HiOS is based on Android™
Android is a trademark of Google LLC.