

# Explosion diagram specification

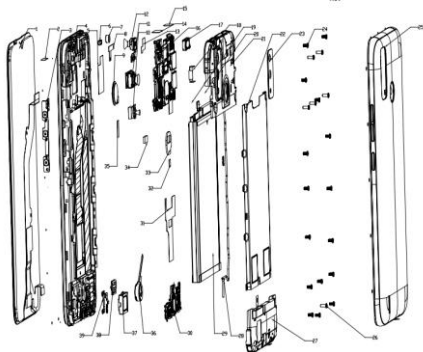

1	FL(CTP+LCM) 6.52HD+ KE5 Black HX V1.0	2	Astigmatism film 3.5*1.2*0.05 KE5
3	FPC Side key BB4	4	Astigmatism film 3.5*1.2*0.05 KE5
5	Shield Seal Cop foil 20.7*15.5*0.06 KE5	6	LT sensor Seal rubber KE5 Black
7	F CAM Seal rubber KE5 Black	8	FPC REC KC1
9	FM(ICNF7332AL)04 Aqua Blue19 fingerchip	10	CAM FF 8W GC6153 CSP W6003 XCG V 1.0
11	CAM AF 13M S5K3L6 B B 5P B ST V1.0	12	CAM FF 8M GC8034 A B 4P B TXD V1.0
13	F CAM con fb 10.75*7.75*0.1 KE5	14	DistanceSensorSeal mylar10.7*4.8*0.03 KE5

15	F LED-Flashseal mylar 8*4.8*0.03 KE5	16	PCBA MB H6123 A1 32GB+2GB V1.0
17	REC 1206W H20 broadband H:SPL 50mW Goer	18	R MAIN CAM Con foams 12.61*10.46*0.2 KE5
19	BATT Seal rubber 6.15*4.0*0.65 KE5	20	LCM Con Seal rubber 13.1*3.7 *0.65 KE5
21	R hsg asm KE5 Black PC	22	Bat imp steel KE5
23	R CAM lens KE5 Glass 0.5mm Black	24	mc screw M1.4*L2.5*D2.5 *H0.5 silver glue
25	Bat cover asm KE5 Aqua Blue PC	26	mc screw M1.4*L3.5*D2.5 *H0.5 silver
27	SPK frame asm KE5 Black PC	28	Coaxial cable ECT D 147.9 X653C
29	Bat TECNO BL 49FT 4900mAh FH IN	30	PCBA SUB H6123 1 A V1.0
31	FP graphite film 37.14*28.8 *0.05 KE5	32	FP In mylar 4*4*0.05 KE5
33	FP support foam 13.26*12.78 *0.6 KE5	34	FP con foams 7.5*3.5*1 KE5
35	ZIF mylar 9.5*3.5*0.05 KE5	36	Motor COIN 1027 L22 H JX
37	SPK 1115 SPR H3.0 aluminiumfilmRoHS Goer	38	SUB PCB Con Seal rubber KE5
39	FPC SPK KE5		

# Know your phone

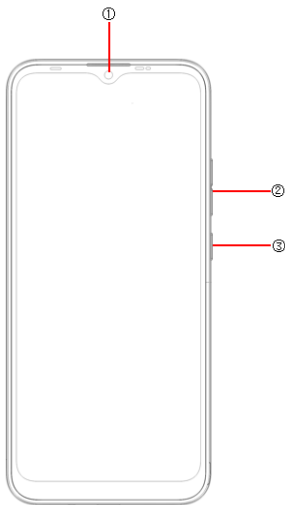

1. Front camera
2. Volume key
3. Power key

# SIM/SD card installation

1. Power off mobile.
2. Refer to the following picture for SIM / SD card installation.

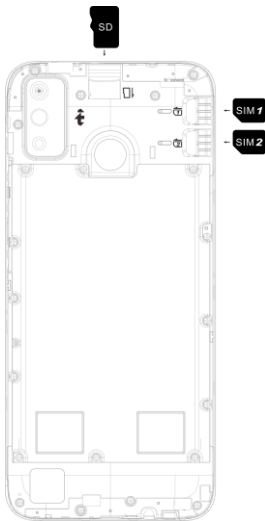

# Charging the phone

You can charge your device using a charger or by connecting it to the computer using a USB cable (comes with the phone).

1. Please remind the front and back of the plug.
2. Use only TECNO charger and cables. Other chargers or cables may damage the device. This will invalidate your phone warranty.

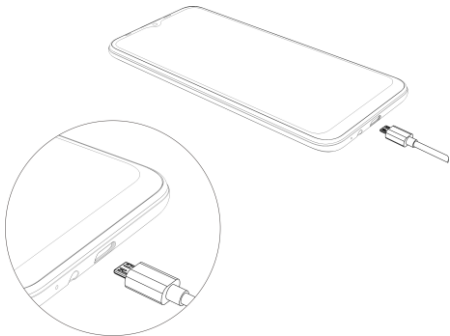

# FCC Caution

## Emergency call

If any emergency arises, dial 112/911 (or other emergency call number) for emergency help.

Due to the nature of cellular networking, the success of emergency call is not guaranteed.

## FCC Warning:

This device complies with part 15 of the FCC Rules. Operation is subject to the following two conditions: (1) This device may not cause harmful interference, and (2) this device must accept any interference received, including interference that may cause undesired operation.

Any Changes or modifications not expressly approved by the party responsible for compliance could void the user's authority to operate the equipment.

This equipment has been tested and found to comply with the limits for a Class B digital device, pursuant to part 15 of the FCC Rules. These limits are designed to provide reasonable protection against harmful interference in a residential installation. This equipment generates uses and can radiate radio frequency energy and, if not installed and used in accordance with the instructions, may cause harmful interference to radio communications. However, there is no guarantee that interference will not occur in a particular installation. If this equipment does cause harmful interference to radio or television reception, which can be determined by turning the equipment off and on, the user is encouraged to try to correct the interference by one or more of the following measures:

- Reorient or relocate the receiving antenna.
- Increase the separation between the equipment and receiver.
- Connect the equipment into an outlet on a circuit different from that to which the receiver is connected.
- Consult the dealer or an experienced radio/TV technician for help.

The SAR limit of USA (FCC) is 1.6 W/kg averaged over one gram of tissue. Device types **KE5k (FCC ID: 2ADYY-KE5K)** has also been tested against this

SAR limit. The highest reported SAR values for head, body-worn accessory, and product specific (Hotspot) are 0.762 W/kg, 0.704 W/kg, and 0.735 W/kg respectively. The Max simultaneous SAR is 1.009 W/kg. This device was tested for typical body-worn operations with the back of the handset kept 10mm from the body. To maintain compliance with FCC RF exposure requirements, use accessories that maintain a 10mm separation distance between the user's body and the back of the handset. The use of belt clips, holsters and similar accessories should not contain metallic components in its assembly. The use of accessories that do not satisfy these requirements may not comply with FCC RF exposure requirements, and should be avoided.

### **Body-worn Operation**

This device was tested for typical body-worn operations. To comply with RF exposure requirements, a minimum separation distance of 1.0 cm must be maintained between the user's body and the handset, including the antenna. Third-party belt-clips, holsters, and similar accessories used by this device should not contain any metallic components. Body-worn accessories that do not meet these requirements may not comply with RF exposure requirements and should be avoided. Use only the supplied or an approved antenna.