

User Manual

Mobile Phone

CD8

TECNO

TECNO MOBILE LIMITED

ROOM 604 6/F SOUTH TOWER WORLD, FINANCE
CTR HARBOUR CITY 17 CANTON ROAD TST KL,
Hong Kong

Explosion diagram specification

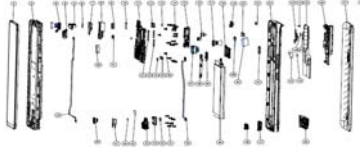

1	FL(CTP+LCM) 6.53FHd+	2	F hsg asm
3	Cam FF 32M	4	F Cam to FPC
5	F Cam slide seal loop asm	6	F Cam Lens
7	Front cam deco asm	8	F Cam slide frame
9	F Cam Rubber 32M	10	F Cam radiating Cop foil
11	PCBA MB	12	REC
13	REC con foam	14	MC Screw M1.4*1.3.5*D2.5*H0.5 silver
15	Elevator module	16	Cam FF 8W
17	Cam FF 2M	18	Card holder asm
19	UP frame asm	20	R vice Cam Rubber 8W
21	Range sensor Rubber	22	Bat cover asm Mi housing
23	R Cam support frame	24	F Cam slide frame seal Ads
25	Bat cover radiating film	26	R Cam deco asm
27	Bat cover asm COM board	28	R Cam lens
29	coaxial cable	30	R MAIN Cam Cop foil 48M
31	MC Screw M1.2*1.1.7*D2.0*H0.3	32	F Cam con rubber
33	R Cam con rubber 2M	34	Bat con rubber
35	LCM FPC con rubber	36	MC Screw M1.4*1.2.0*D3.0*H0.5 Silver
37	Cam AF 48M	38	FPC Switch key
39	FM	40	R MAIN Cam supf 48M
41	R MAIN Cam Rubber 48M	42	RF support foam
43	REC con foam	44	Transfer to FPC fixing Ads X
45	Transfer to FPC fixing Ads D	46	SPK frame asm
47	Earphone Rubber	48	USB Rubber
49	Bat	50	FPC MAIN
51	MC Screw M1.4*1.3.0*D2.75*H0.5 Black	52	MAIN FPC con rubber
53	Speaker	54	Sub PCB
55	LCM FPC mylar	56	Waterproof label
57	Vibrator	58	FPC RLED-Flash
59	Cam FF 5M		

Know your phone

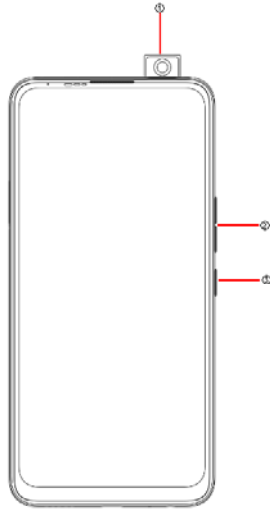

1. Front camera
2. Volume key
3. Power key

SIM/SD card installation

1. Power off mobile.
2. Refer to the following picture for SIM / SD card installation.

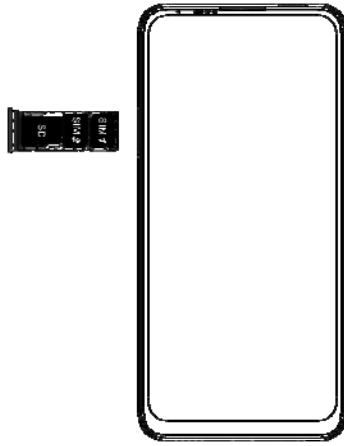

Charging the phone

You can charge your device using a charger or by connecting it to the computer using a USB cable (comes with the phone).

1. Please remind the front and back of the plug.
2. Use only TECNO charger and cables. Other chargers or cables may damage the device. This will invalidate your phone warranty.

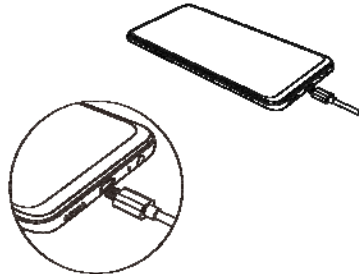

Emergency call

If any emergency arises, dial 112/911 (or other emergency call number) for emergency help.

Due to the nature of cellular networking, the success of emergency call is not guaranteed.

FCC Warning:

This device complies with part 15 of the FCC Rules. Operation is subject to the following two conditions: (1) This device may not cause harmful interference, and (2) this device must accept any interference received, including interference that may cause undesired operation.

Any Changes or modifications not expressly approved by the party responsible for compliance could void the user's authority to operate the equipment.

This equipment has been tested and found to comply with the limits for a Class B digital device, pursuant to part 15 of the FCC Rules. These limits are designed to provide reasonable protection against harmful interference in a residential installation. This equipment generates uses and can radiate radio frequency energy and, if not installed and used in accordance with the instructions, may cause harmful interference to radio communications. However, there is no guarantee that interference will not occur in a particular installation. If this equipment does cause harmful interference to radio or television reception, which can be determined by turning the equipment off and on, the user is encouraged to try to correct the interference by one or more of the following measures:

- Reorient or relocate the receiving antenna.
- Increase the separation between the equipment and receiver.
- Connect the equipment into an outlet on a circuit different from that to which the receiver is connected.
- Consult the dealer or an experienced radio/TV technician for help.

The SAR limit of USA (FCC) is 1.6 W/kg averaged over one gram of tissue. Device types CD8 (FCC ID: 2ADYY-CD8) has also been tested against this SAR limit. The highest reported SAR values for head, body-worn accessory, and product specific (Hotspot) are 0.62 W/kg, 0.75 W/kg, and 0.76 W/kg respectively. The Max simultaneous SAR is 1.02W/kg. This device was tested for typical body-worn operations with the back of the handset kept 10mm from the body. To maintain compliance with FCC RF exposure requirements, use accessories that maintain a 10mm separation distance between the user's body and the back of the handset. The use of belt clips, holsters and similar accessories should not contain metallic components in its assembly. The use of accessories that do not satisfy these requirements may not comply with FCC RF exposure requirements, and should be avoided.