

# User Manual

Mobile Phone

BB4j

TECNO

FCC ID: 2ADYY-BB4J

TECNO MOBILE LIMITED

ROOM 604 6/F SOUTH TOWER WORLD,  
FINANCE CTR HARBOUR CITY 17  
CANTON ROAD TST KL, Hong Kong

# Explosion diagram specification

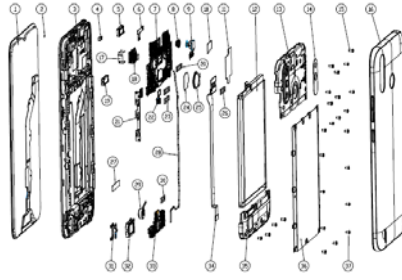

1	LCD ASM	2	LT sensor
3	F hsg asm	4	LT sensor seal rubber
5	Receiver	6	Receiver FPC
7	PCBA ASM	8	F Cam seal rubber
9	Front camera	10	F Cam con fb
11	MAIN ShieldCop foil	12	Battery
13	R hsg asm	14	R Cam lens 884 glass
15	Screw	16	Bat cover asm
17	R Cam Cop foil	18	Back camera
19	LCM FPC frame	20	MAIN FPC con rubber
21	FPC Switch key	22	Bat to FPC
23	Bat con rubber	24	FM Con fb
25	Fingerprint ASM	26	LCM FPC con rubber
27	LCM FPC seal mylar	28	Coaxial cable
29	MOTO	30	SUB PCB con rubber
31	SPK FPC	32	SPK
33	USB PCBA	34	FPC MAIN&SUB PCB
35	SPK frame asm	36	Bat imp steel
37	Screw		

## Know your phone

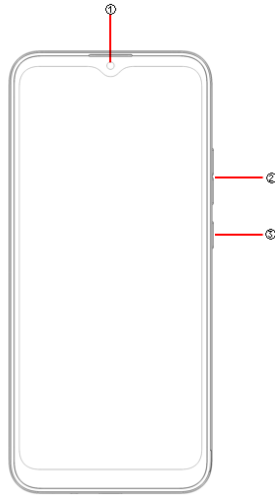

1. Front camera
2. Volume key
3. Power key

## SIM/SD card installation

1. Power off mobile.
2. Refer to the following picture for SIM / SD card installation.

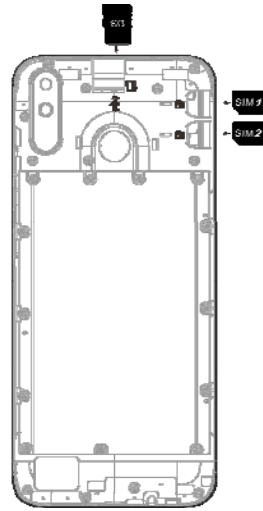

## Charging the phone

You can charge your device using a charger or by connecting it to the computer using a USB cable (comes with the phone).

1. Please remind the front and back of the plug.
2. Use only TECNO charger and cables. Other chargers or cables may damage the device. This will invalidate your phone warranty.

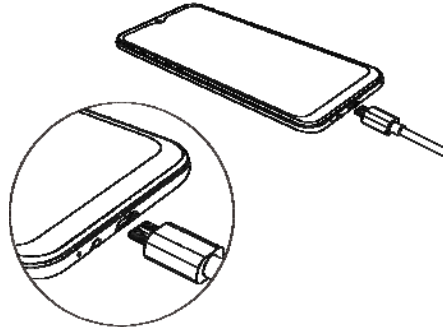

**Emergency call**

If any emergency arises, dial 112/911 (or other emergency call number) for emergency help.

Due to the nature of cellular networking, the success of emergency call is not guaranteed.

**FCC Warning:**

This device complies with part 15 of the FCC Rules. Operation is subject to the following two conditions: (1) This device may not cause harmful interference, and (2) this device must accept any interference received, including interference that may cause undesired operation.

Any Changes or modifications not expressly approved by the party responsible for compliance could void the user's authority to operate the equipment.

This equipment has been tested and found to comply with the limits for a Class B digital device, pursuant to part 15 of the FCC Rules. These limits are designed to provide reasonable protection against harmful interference in a residential installation. This equipment generates uses and can radiate radio frequency energy and, if not installed and used in accordance with the instructions, may cause harmful interference to radio communications. However, there is no guarantee that interference will not occur in a particular installation. If this equipment does cause harmful interference to radio or television reception, which can be determined by turning the equipment off and on, the user is encouraged to try to correct the interference by one or more of the following measures:

- Reorient or relocate the receiving antenna.
- Increase the separation between the equipment and receiver.
- Connect the equipment into an outlet on a circuit different from that to which the receiver is connected.
- Consult the dealer or an experienced radio/TV technician for help.

The SAR limit of USA (FCC) is 1.6 W/kg averaged over one gram of tissue. Device types BB4j (FCC ID: 2ADYY-BB4J) has also been tested against this SAR limit. The highest reported SAR values for head, body-worn accessory, and product specific (Hotspot) are 0.63 W/kg, 0.33 W/kg, and 0.33 W/kg respectively. The Max simultaneous SAR is 0.68W/kg. This device was tested for typical body-worn operations with the back of the handset kept 10mm from the body. To maintain compliance with FCC RF exposure requirements, use accessories that maintain a 10mm separation distance between the user's body and the back of the handset. The use of belt clips, holsters and similar accessories should not contain metallic components in its assembly. The use of accessories that do not satisfy these requirements may not comply with FCC RF exposure requirements, and should be avoided.