

Android mobile data terminal

Quick Reference Guide

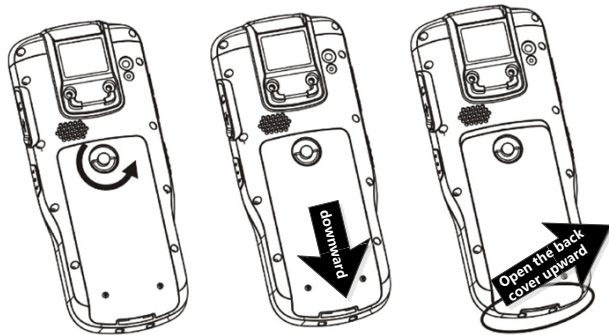

1. Installation of SIM and TF card



1 Unscrew the fixing nut

2 Open the back cover downward

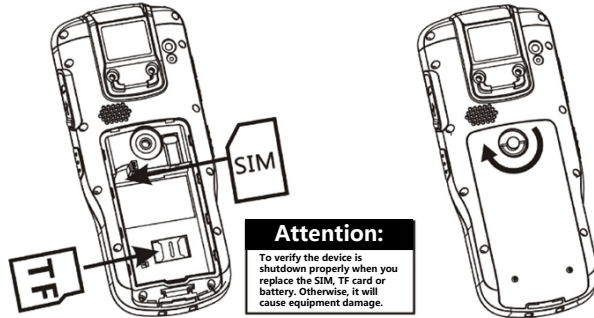

3 insert SIM and TF card.

4 put the battery in and put the cover on then screw fixing nut on.

Attention:

To verify the device is shutdown properly when you replace the SIM, TF card or battery. Otherwise, it will cause equipment damage.

2 Battery charge

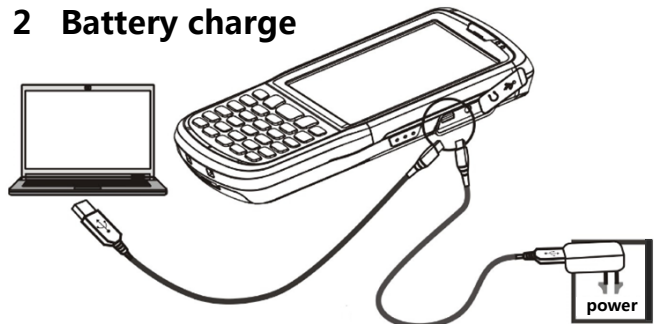

1 This cell phone can be recharged via USB devices(trickle charge)
2 you can recharge(fast charge) by 5v,1A power adapter.

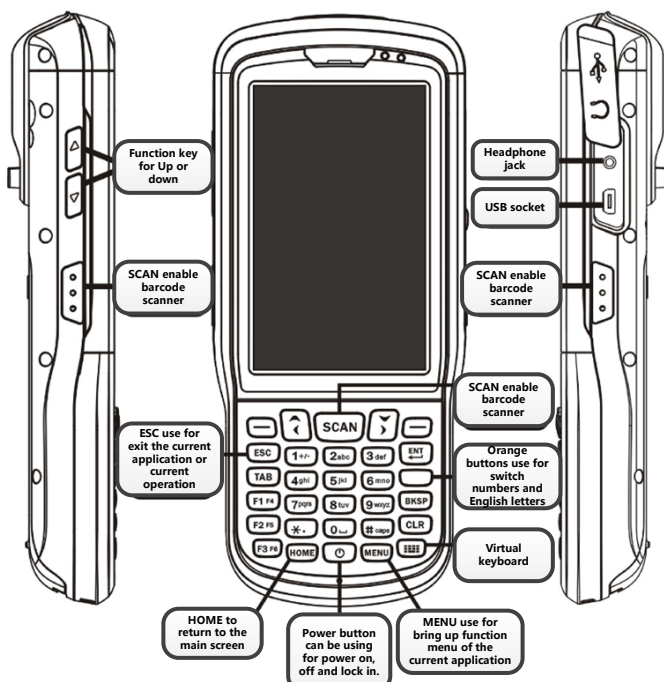

6 Barcode scanning

1 Start bar code scanning

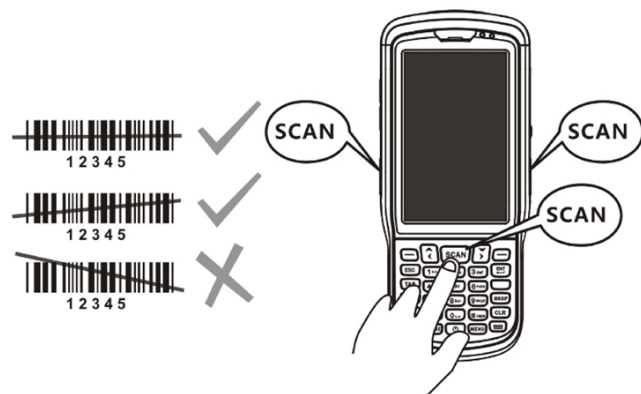

7 Starting WIFI Wi - Fi and 3G data application

1 Open the WiFi wireless network

Access to the Android system setup options, then click [network] operation, start the WLAN and enter WLAN setting, then to select the Wi-Fi network which you need. When the connection is successful the network icon is shown below:



2 Open the applications of 3G Data

Enter setup options of the Android system , to click[network] ,[more],[mobile network],[start data flow]



3G means that currently accessing the 3G network

E means that EDGE is current network



G means that GPRS is current network.

There are three mobile data connections and it depending on your wireless network environment. Access speed of 3G is the fastest among them. Secondly, EDGE . The GSM data access is slowest.

Attention: it will generate traffic expense after connecting to mobile networks; the system will turn off the 3G data applications automatically When Wi-Fi wireless network is connected successfully. This cell phone support for GSM2G network and 3G, please refer to the product model(EVDO Telecom 3G W

Attention:

- 1 LED display charge was
- 2 We sugges
- 3 It needs to for a longt
- 4 To use the

3 start and

1 start-u



1 Long pres until the

2 Restart



Long press the seconds to res

9 Funct

Managem

Home - menu
Suggest resett



OK-Guest user
which the cust

Guest Permission
Guest Permission

Switch resources repla
The resource of specified dr
card can be replaced to syste
Home name subtitles

Battery Icon	Description
	Main battery
	State of charge
	Battery run out



Attention:

- 1 LED display flashing red when charging , and the LED will normally on when the charge was completed.
- 2 We suggested to charge more than 12 hours with power adapter when first recharge.
- 3 It needs to ensure charge and discharge at least once within 2 months if left unused for a longtime.
- 4 To use the charging equipment which compatible please.

3 start-up, shutdown, restart and restore factory settings

start-up

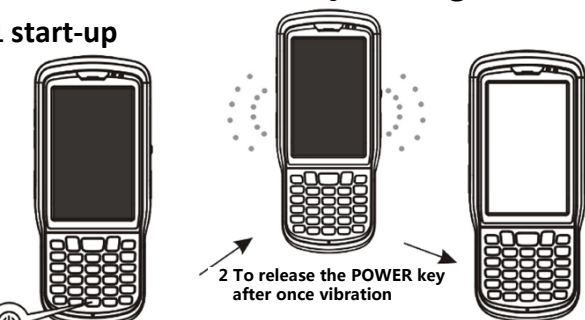

Restart

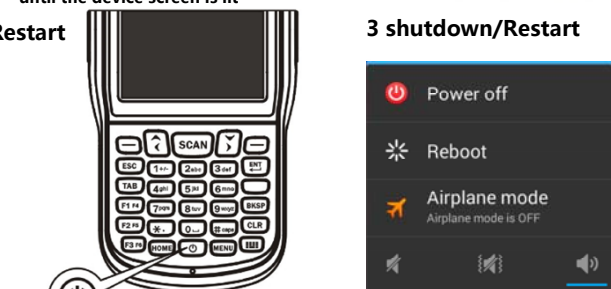

Long press the POWER button for 7 seconds to restart in the state of power on

1 Press the POWER button for 2 seconds in the state of power on
2 Click on the "Shutdown" or "restart" button

3 Restore factory settings

Enter "setting" option , click on "personal" , click on "restore factory settings"

Attention: all settings you have been made for this cell phone will be restored to the original settings, please operation carefully.

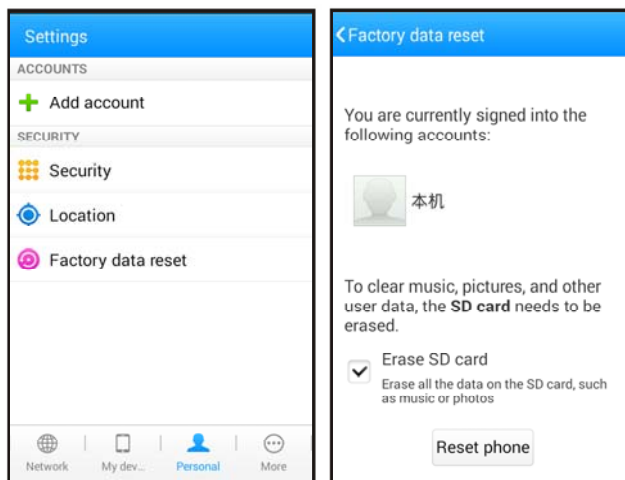

4 Connect to PC

This device can exchange data with PC through the USB DATA cable. The operation process is as follows:

- 1 To insert the standard cable of this cell phone into USB port of PC and then insert the other end of the data wire into this cell phone.
- 2 There will pop up "USB has been connected" on the left top of the screen , to scroll down to connect Icon on the top of the screen , to click the "USB has been connected".
- 3 To click "open the USB storage device" on the pops up interface.

5 Operations for touch screen and keys

1 Touch screen

The cell phone has adopted capacitive touch screen. It supports multi-touch and you can operate by slight touch, such as select, click, move, screen zooms in and out, soft keyboard input and other operations.

Attention:

Do not tap the screen with a touch pen; this operation is not valid for capacitive screen and the screen may not have any response when you operation wearing gloves that is normal phenomenon.

WARNING:

This device complies with part conditions:
(1)This device may not cause h
(2)This device must accept any undesired operation.Changes o party responsible for complian

NOTE:

This equipment has been teste device, pursuant to part 15 of th reasonable protection against h

This equipment generates, use and used in accordance with the communications. However, the particular installation. If this eq television reception, which can is encouraged to try to correct t
- Reorient or relocate the receiv
- Increase the separation betwee
- Connect the equipment into an connected.
- Consult the dealer or an exper

FCC RF Exposure Information a

The SAR limit of USA (FCC) is Device types:FCC ID:2ADXO-M The highest SAR value reporte the body or use at the ear is 0.1

CE Note:

The SAR limit of Europe (CE) is RHYTHM RX10 has also been reported under this standard du and on the body is 0.155W/kg.

Warning:

1.Sound Pressure warning:
Use careful with the earphone and headphones can cause hear

2.Battery warning:
Caution:Risk of explosion if bat according to the instructions.
3. The product shall only be co
4. Adapter shall be installed ne
5. The EUT maximum Operatin
6. The model number of the ad disconnect device of adapter
7. RF distance warning:
The device complies with RF sp
8. R&TTE 1999/5/EC declaratio Declaration of Conformity
Hereby, (Mexxen Technology(T Terminal) product is in complia of Directive 1999/5/EC. A copy { <http://mexxen.diytrade.com/> }

Function customization

Management permission

Home - menu - management permissions setting- default password 123456 suggest resetting the administrator password (shall not be less than 6 - bit)

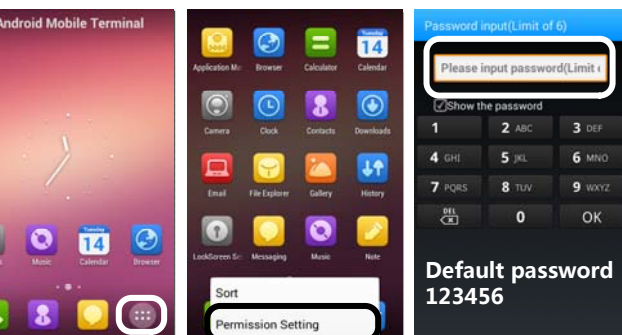

Guest user permissions (tick)- Guest application settings (tick the program which the customer cannot use (Users will not see the selected program)

Permission release:

Homepage-menu-management permission settings-enter the administrator password-ok- remove the tick of guest user permission- Guest application settings-remove the tick on the program-save-return

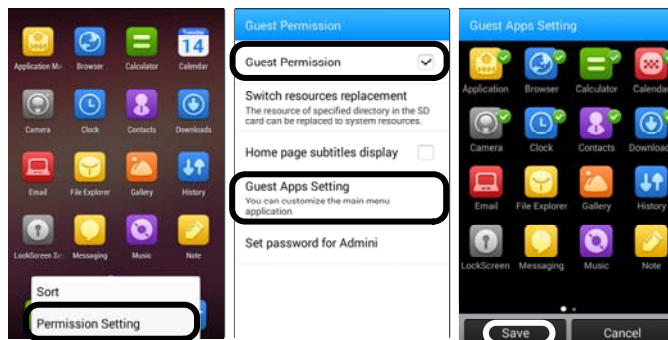

Customize the display text of homepage:

Home page - long press text strip- set text attributes and content - return - to confirm the modification

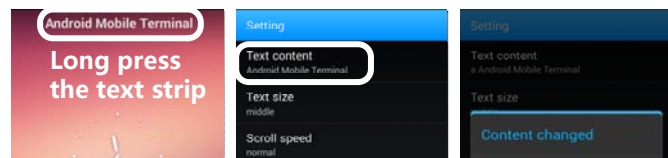
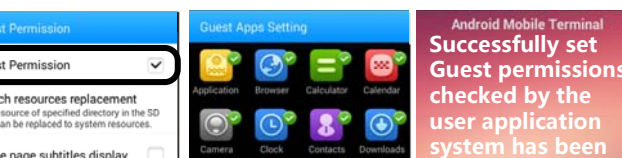

lies with part 15 of the FCC Rules. Operation is subject to the following two

may not cause harmful interference, and
must accept any interference received, including interference that may cause
operation.Changes or modifications not expressly approved by the
for compliance could void the user's authority to operate the equipment.

has been tested and found to comply with the limits for a Class B digital
to part 15 of the FCC Rules. These limits are designed to provide
protection against harmful interference in a residential installation.

generates, uses and can radiate radio frequency energy and, if not installed
in accordance with the instructions, may cause harmful interference to radio
operation. However, there is no guarantee that interference will not occur in a
particular installation. If this equipment does cause harmful interference to radio
operation, which can be determined by turning the equipment off and on, the user
is asked to try to correct the interference by one or more of the following measures:
• Reorient or relocate the receiving antenna.
• Increase the separation between the equipment and receiver.
• Plug the equipment into an outlet on a circuit different from that to which the receiver is

connected, or consult the dealer or an experienced radio/TV technician for help.

Information and Statement:

FCC ID: A54989-AD2 (FCC) is 1.6 W/kg averaged over one gram of tissue.
FCC ID: 2ADXX-MX-5050 has also been tested against this SAR limit.
The highest SAR value reported under this standard during product certification for use on
the head is 0.110W/kg and on the body is 0.128W/kg.

Europe (CE) is 2.0 W/kg averaged over one gram of tissue. Device types:
This device has also been tested against this SAR limit. The highest SAR value
reported under this standard during product certification for use at the Head is 0.118W/kg
and on the body is 0.155W/kg.

Warning:
Excessive use of the earphone may cause excessive sound pressure from earphones
which can cause hearing loss.



Caution:
Explosion if battery is replaced by an incorrect type. Dispose of used batteries
in accordance with the instructions.
The device shall only be connected to a USB interface of version USB 1.1.
The device shall be installed near the equipment and shall be easily accessible.
Maximum Operating temperature is 40°C.
The model number of the adapter is TS39-502000A and the plug considered as
Type A of adapter.

Warning:
The device complies with RF specifications when the device is used at 1 cm from your body.
CE/EC declaration:
Declaration of conformity
{ Shenzhen Technology (Shanghai) INC. } declares that this { Android Mobile Data
device is in compliance with essential requirements and other relevant provisions
of the 2014/53/EU. A copy of the Declaration of conformity can be found at
{ www.sztrade.com/ }

6 Barcode scanning

1 Start bar code scanning

To view the scan status icon on the top right of the screen

Scanning has been activated if it is  . Scanning has not activate yet if it is  .Need to open it in setting

Start Methods for bar code scanning

Method A: Starting the desktop application [scan setting]  , General Settings->Bar Code Scanning->on / off/

Method B: to enter the setup option of the Android system, click [scan setting], start bar code scanning

2 Start Scanning

Open any text input box or client application, and you can activate the scanning by press the scanning key on both side.

Please run " Scan Settings " application if you want more barcode scanning settings option.

network.

Attention: it will generate traffic expense after connecting to mobile networks; the system will turn off the 3G data applications automatically When Wi-Fi wireless network is connected successfully. This cell phone support for GSM2G network and 3G, please refer to the product model(EEVDO Telecom 3G W WCDMA China Unicom 3G)

8 Care & Maintenance

- 1 This cell phone can achieve the industrial dustproof and waterproof , and tolerate a certain degree of harsh working conditions but do not use in circumstances beyond this standard for a long term.
- 2 The working temperature of this cell phone is 20°C-60°C. Just do not use in ultra - low temperature or high temperature environment long term.
- 3 This cell phone can bear fell down from 12 meters heights for many times. But its touch screen maybe damage in the process of falling down by contact with hard objects directly, and avoid slide down in use.
- 4 To charge the cell phone with the power adapter in line with national standards. Use our company's standard battery please.
- 5 Do not make the battery contact with metal objects , as that will cause polarity short circuit of the battery and battery damage temporarily or permanently even explosion.
- 6 Please avoid red dust - proof piece of the barcode scanner window scratches by sharp objects. Otherwise probably reduce the performance of bar code reading.

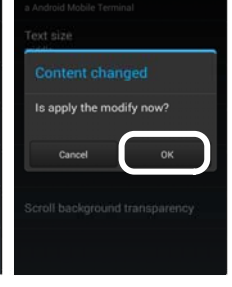
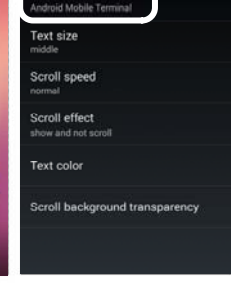
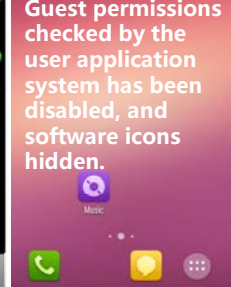
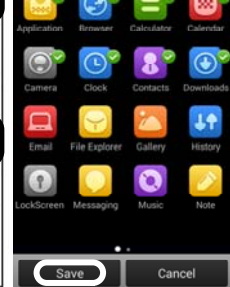
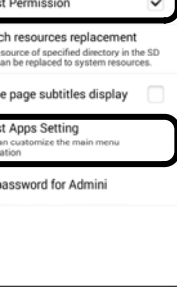

Mexxen Technology(ShangHai)INC.
TEL : +86-21-64955599
FAX : +86-21-64959598
Address:Unit B,12F,Building 11,No. 518,xinzhuan Rd.,
Songjiang District,Shanghai,China

