





Features

-  Self-developed easyROM with stable system, fluent and easy operation.
-  Thousands of movies, dramas and shows sources. Enjoy the biggest entertainment.
-  Built-in HD camera offers a solution to have video chat with family and friends on TV very freely.
-  AhlaTV can be used as hotspot and offers WiFi signal to other devices.

01

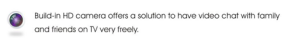
AhlaTV Outline

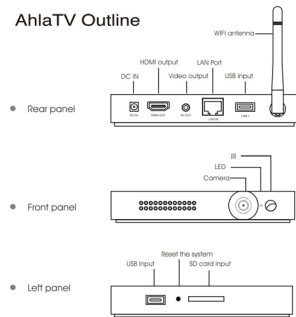

02

Package contents

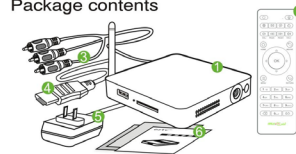

No.	Items	Quantity	Unit
1	AhlaTV	1	pcs
2	Remote control	1	pcs
3	AV cable	1	pcs
4	HDMI cable	1	pcs
5	power supply	1	pcs
6	Manual and warranty card	1	pcs

03

Remote control



Icon Name	Features
	Standby/Wake up
	Open search
	Open browser to visit website page
	Access to email
	Access to video message
	Give good comments if like the application
	Increase volume
	Previous page
	Next page
	Back to homepage
	Popup simulate mouse and turn it off
	Popup menu
	back to previous page
	Move cursor up
	Move cursor down
	Move cursor left
	Move cursor right
	Confirm the cursor refers to options
	One-time press for numbers. Multiple press for letters
	Enter URL, and click "GO", it goes to the destination webpage.
	Delete input text

04

Quick Start Guide

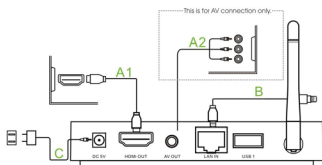

05

Step 1 Connection

A: connect with TV

Note: please choose from below 2 connections according to what kind of TV (HDTV or SDTV) you are using.

A1 HDTV connections

Connect AhaTV HDMI output port with TV HDMI input port with the HDMI cable from package. Select TV source signal to the right HDMI input channel with TV remote control.

A2 SDTV connection

Connect single end AV cable to AV output port of AhaTV and three RCA end to AV input port of TV. Select TV source signal to the right AV input channel with TV remote control.

B: Network connection (skip this step if using WIFI connection.)

Connect network cable one end with AhaTV network port and the other end with family network connection device like modem or switch etc. Choose either of the two above connection. Wire network connection is recommended as priority for fluent and stable operation.

C: Power supply connection

Connect DC5V power supply to AhaTV.

06

Step2 Set up network

Make sure network connection is normal before setting up network and choose configuration according to actual situation.

For wire network connection:

Click "Setting" -> "Network setting" in homepage to set the relevant information.

Click "Setting" -> "Network setting" in homepage to set the relevant information.

When access to set up network, it is "wired network" by default. If the router or switch has been set to be dynamic IP, AhaTV will automatically gain IP address and display "Wired network connected" at the screen bottom. Connection is normal when the current network information displayed to be IP address and Physical address.



07

Warm notice: Thanks for using our product. Please reserve the PRODUCT WARRANTY CARD carefully for future after-sale service. At the presentation of the warranty card, free exchange or free maintenance is available within 12 months since the purchase date if any quality problem is found. Please contact us with the warranty card and valid invoice for maintenance service if out of 12 months warranty period. The service is charged at a reasonable price.

PRODUCT WARRANTY CARD

Product information

Product model

Product serial number

Distributor

Purchase date

Maintenance records

Date	Descriptions	Causes	Solutions

For more info, please click
www.ahlatv.com

For wireless network connection:

Click "Setting" -> "Network setting" in homepage.
Click "Wi-Fi" to start wireless connection mode. After the wireless network auto search (usually takes 5-10 seconds) is finished, choose the relevant Wi-Fi network name and it will connect automatically (if need to set password, please follow the page guidance at the first connection. No need to input password for future connection). When the screen displays successful connection, it works normally.



08

For Broadband dial-up connection:

Click "Setting" -> "Network setting" in homepage.
Click "Broadband dial-up", input account name and password offered by network supplier and then click "Broadband dial-up". It will display "Dial succeeded" after it is connected.

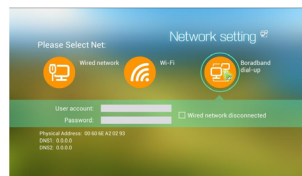

09

Application download

It can download applications freely through website or SD card.
The downloaded applications will be shown in "others". It can also download applications in APP store. In "movie", "APP" or "game" page, click "add" to access to APP store.

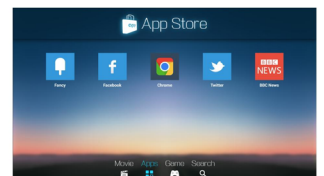

10

Can use PgUp, PgDn to turn page. Click the applications and access its details.
 Click "download", system will automatically download the application installation package. Then click "install". It can be allowed to review application permission and users can choose "agree" or "cancel" the installation. Click "return" to exit the application(or press "c" on Remote)



11

When the installation is done, click "run" and access to the application.
 If not want to use this application any more, click "uninstall" to remove it.



12

FCC Certification Requirements

Caution: Any changes or modifications in construction of this device which are not expressly approved by the party responsible for compliance could void the user's authority to operate the equipment.

This device complies with part 15 of the FCC Rules. Operation is subject to the following two conditions: (1) This device may not cause harmful interference, and (2) This device must accept any interference received, including interference that may cause undesired operation.

The manufacturer is not responsible for any radio or TV interference caused by unauthorized modifications to this equipment. Such modifications could void the user's authority to operate the equipment.

This equipment has been tested and found to comply with the limits for a Class B digital device, pursuant to Part 15 of the FCC Rules. These limits are designed to provide reasonable protection against harmful interference in a residential installation. This equipment generates, uses and can radiate radio frequency energy and, if not installed and used in accordance with the instructions, may cause harmful interference to radio communications. However, there is no guarantee that interference will not occur in a particular installation. If this equipment does cause harmful interference to radio or television reception, which can be determined by turning the equipment off and on, the user is encouraged to try to correct the interference by one or more of the following measures:

- Reorient or relocate the receiving antenna.
- Increase the separation between the equipment and receiver.
- Connect the equipment into an outlet on a circuit different from that to which the receiver is connected.

Consult the dealer or an experienced radio/TV technician for help.

13



AHLA i TV **أهلا تي في**
 Powered by Android™
 Ahlatv QUICK START GUIDE

www.ahlatv.com