



Thanks for buying EZFUN smart doorbell !

7. Bind Setting

Bind smart phone to the indoor unit using APP, follow steps 1,2,3

1. Select "Bind" Option (picture 7.1), then press the indoor unit Wi-Fi binding button (picture 7.2), the indoor unit binding light will flash.

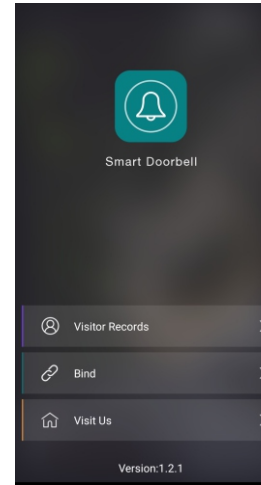

Picture 7.1

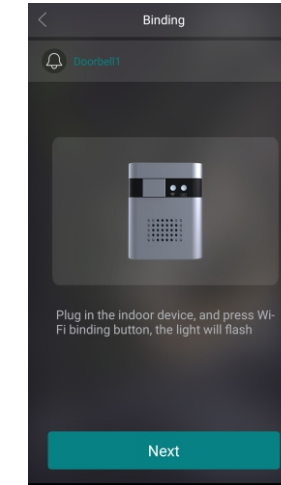

Picture 7.2

Please connect to 2.4G Wi-Fi.

2. Select "next" option, enter your Wi-Fi password to connect to the internet (picture 7.3), then select "complete settings" (picture 7.4)

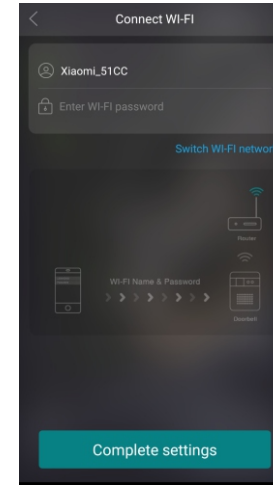

Picture 7.3

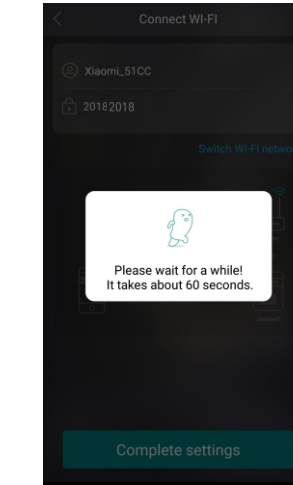

Picture 7.4

When binding is completed, you will hear the doorbell sound from the indoor unit, then the doorbell is ready to use (picture 7.5). When a visitor presses the doorbell button, the APP will receive a snapshot (picture 7.6). If the APP send an error message (picture 7.7) when you bind smart phone to indoor unit, please follow step 2 and 3 to bind again.

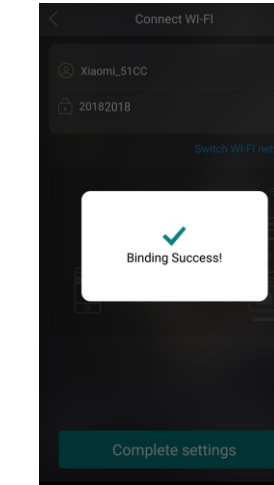

Picture 7.5

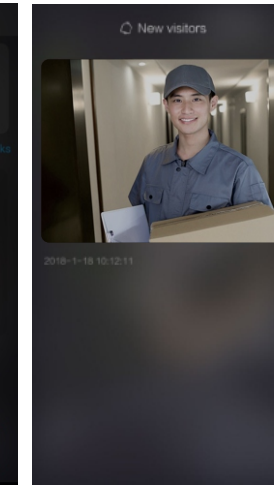

Picture 7.6

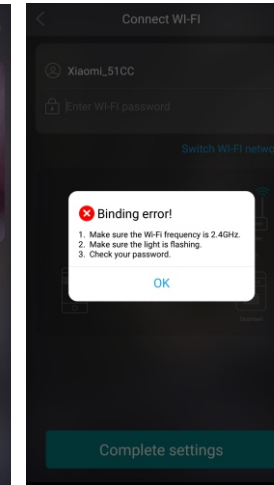

Picture 7.7

8. FAQ

Question 1: When I press the doorbell, there is no doorbell sound.

Answer:

Check the battery to see if it's installed properly, also check the battery life.

Check the indoor unit and the outdoor unit to see if they are paired correctly. Please follow step 1 then step 2. Do not press the indoor unit and outdoor unit at the same time.

Step 1: Indoor Unit Setting

Use tool such as push pin to push the button on the left side of the indoor unit, the indoor/outdoor unit pairing light will blink, now go to step 2.

Step 2: Outdoor Unit Setting

Press the doorbell button for more than 3 seconds, the outdoor unit will send signal to the indoor unit. When you hear doorbell sound from the indoor unit, the indoor unit and outdoor unit are paired correctly.

Question 2: APP cannot connect to indoor unit

Answer: Check the Wi-Fi connection and your password.

EZFUN®

Smart Doorbell D01

Quick Start Guide



Welcome to EZFUN family !

1. Outdoor Unit

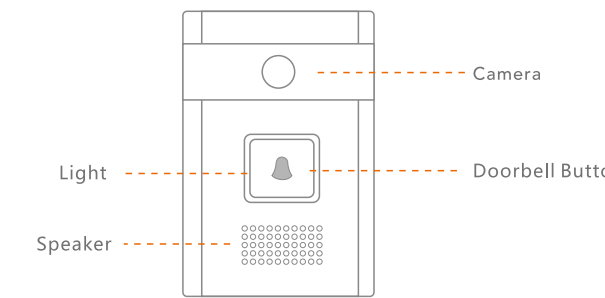

2. Indoor Unit

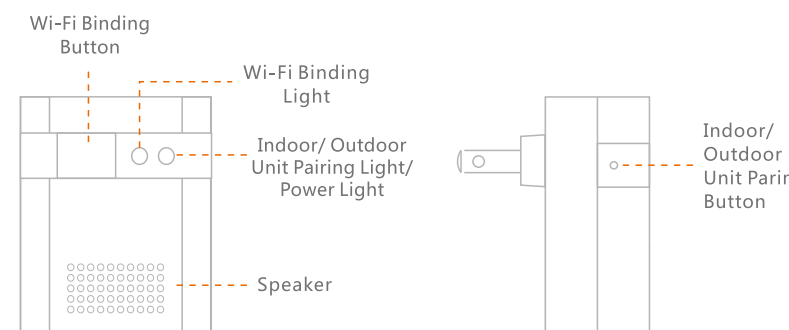

3. Specification

Outdoor Unit	
Image Sensor	2.0MP 1/4 inch CMOS
Transmission Mode	RF2.4GHz
Power Supply	AAA Battery x 2
Speaker	Buzzer
Installation	3M Glue or Screw Fix
Size	87 x 58 x 15mm(3.43" x 2.28" x 0.59")
Weight	80g(0.18 lb)
Indoor Unit	
Transmission Mode	RF2.4GHz+ Wifi2.4GHz
Power Supply	100-240V AC
Speaker	Dingdong Sound
Size	56.8 x 36.3 x 68mm (2.24" x 1.43" x 2.68")
Weight	35g (0.08 lb)
APP	Support

4. Battery Installation

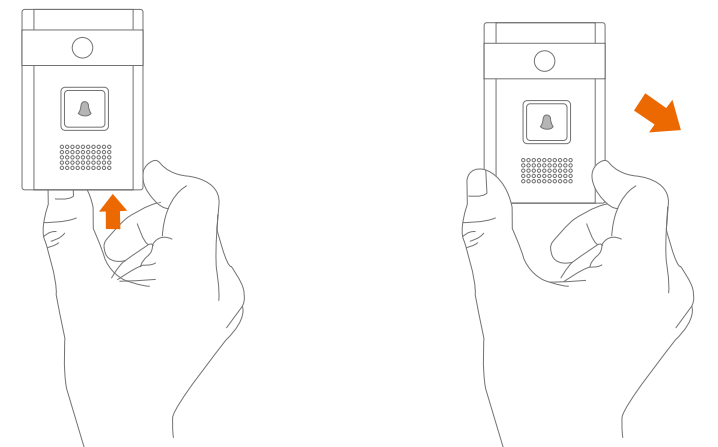

Push up the shell(as instructed by the picture above),remove it.And install the batteries(The product does not contain batteries).

After the batteries are installed, pull down the shell to lock it up(as instructed by the picture above).

5. Installation for Outdoor Unit Installation of the Doorbell

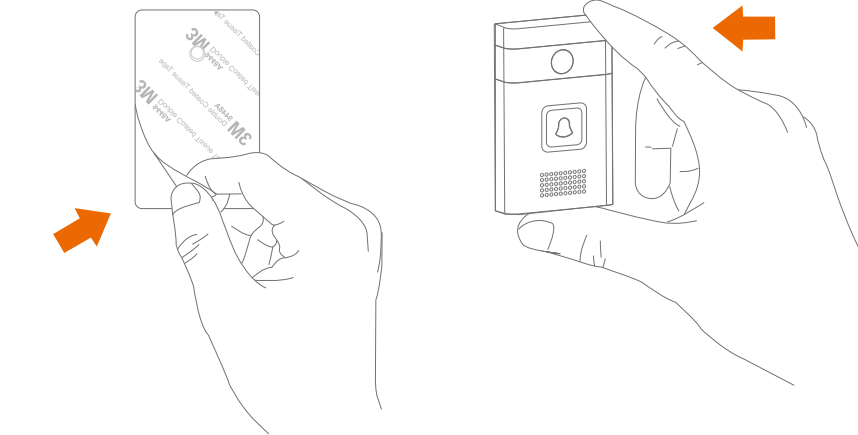

Remove the 3M release paper from the back of the outdoor Unit.

Stick it to the door or wall firmly. Please make sure the surface of the door or wall that the doorbell sticks to is clean and smooth.

* The outdoor unit should be installed at the same height of your face.

Installation of the Doorbell

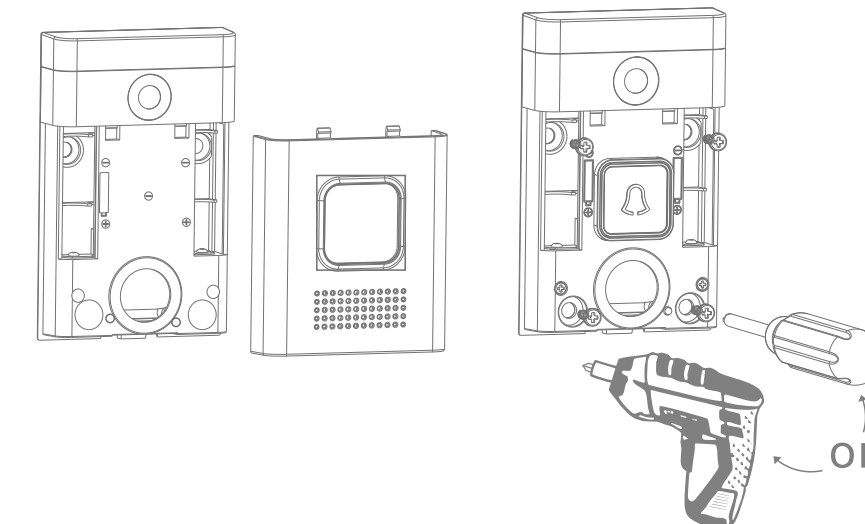

You can install the outdoor unit using screw instead of 3M sticker.

6. Download Smart Doorbell D01 (Android or iOS)



- Way 1:Scan the QR-code and download the APP.
- Way 2:Search Smart Doorbell D01 in App Store or Google play,and download the APP.
- Way 3:Visit the URL: <http://www.ezfun.mobi/doorbell/Index/download/> by your smartphone , and download the APP.

FCC Warning:

This equipment has been tested and found to comply with the limits for a Class B digital device, pursuant to part 15 of the FCC Rules. These limits are designed to provide reasonable protection against harmful interference in a residential installation.

This equipment generates, uses and can radiate radio frequency energy and, if not installed and used in accordance with the instructions, may cause harmful interference to radio communications. However, there is no guarantee that interference will not occur in a particular installation. If this

equipment does cause harmful interference to radio or television reception, which can be determined by turning the equipment off and on, the user is encouraged to try to correct the interference by one or more of the following measures:

- o Reorient or relocate the receiving antenna.
- o Increase the separation between the equipment and receiver.
- o Connect the equipment into an outlet on a circuit different from that to which the receiver is connected.
- o Consult the dealer or an experienced radio/TV technician for help.

Caution: Any changes or modifications to this device not explicitly approved by manufacturer could void your authority to operate this equipment.

This equipment complies with FCC RF radiation exposure limits set forth for an uncontrolled environment. This device and its antenna must not be located or operating in conjunction with any other antenna or transmitter.

To comply with FCC RF exposure compliance requirements, this grant is applicable to only mobile configurations. The antennas used for this transmitter must be installed to provide a separation distance of at least 20 cm from all persons and must not be co-located or operating in conjunction with any other antenna or transmitter.