

A801-38

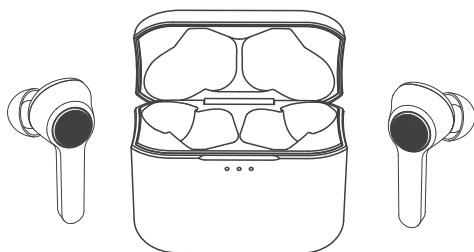

# User Guide

BLUETOOTH HEADSET

English 05-12

## PACKAGE CONTENTS (Fig. 1)

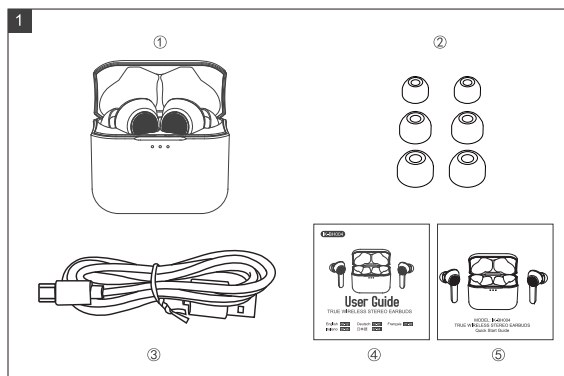

### EN

- 1 iTeknic True Wireless Stereo Earbuds (IK-BH004)
- 2 6 x Ear Tips (two are equipped on the earbuds)
- 3 1 x Micro-USB Charging Cable
- 4 1 x User Manual
- 5 1 x Quick Start Guide

### DE

- 1 iTeknic True Wireless Stereo-Kopfhörer (IK-BH004)
- 2 6 x Ohrstöpsel (2 Stöpsel haben schon an Ohrhörern angebracht)
- 3 1 x Micro USB Ladekabel
- 4 1 x Bedienungsanleitung
- 5 1 x Schnellstart-Anleitung

### FR

- 1 iTeknic Écouteurs Bluetooth Sans Fil (IK-BH004)
- 2 6 x Embouts d'Oreillette (deux sont déjà installés sur les écouteurs)
- 3 1 x Câble de Charge Micro USB
- 4 1 x Manuel de l'Utilisateur
- 5 1 x Guide de Démarrage Rapide

### IT

- 1 iTeknic Auricolari True Wireless Stereo (IK-BH004)
- 2 6 x Gommioni Auricolare (due già montati sugli auricolari)
- 3 1 x Cavo di Ricarica Micro USB
- 4 1 x Manuale Utente
- 5 1 Manuale di Avvio Rapido

### JP

- 1 iteknic完全ワイヤレスステレオイヤホン (IK-BH004)
- 2 6 x イヤーチップ (2つは本体装着済み)
- 3 1xUSB 充電ケーブル
- 4 1 x 取扱説明書
- 5 1 x クイックスタートガイド

## PRODUCT DIAGRAM (Fig. 2)

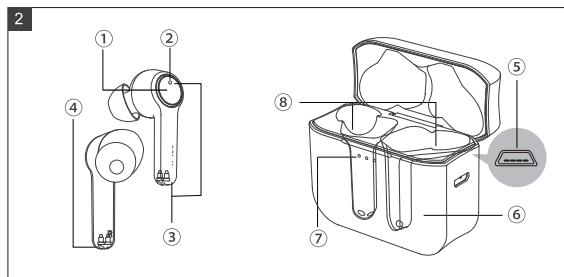

### EN

- ① Multifunction Touch Control
- ② LED Indicator
- ③ Microphone
- ④ Charging Contacts
- ⑤ Micro-USB Charging Port
- ⑥ Wireless Charging Case
- ⑦ Charging Indicator
- ⑧ Charging Slot

### DE

- ① Multifunktionale Touch Steuerung
- ② LED Anzeigelampe
- ③ Mikrofon
- ④ Ladekontakte
- ⑤ Micro-USB Ladeanschluss
- ⑥ Wireless Ladebox
- ⑦ Ladeanzeigelampe
- ⑧ Ladungsslot

### FR

- ① Multifonction Touche Tactile
- ② Voyant à LED
- ③ Microphone
- ④ Contacts de Charge
- ⑤ Port de Charge Micro-USB
- ⑥ Boîtier de Chargement Sans Fil
- ⑦ Voyant de Charge
- ⑧ Slot de Charge

### JP

- ① タッチコントロール
- ② LEDインジケータ
- ③ マイク
- ④ 充電接続部
- ⑤ USB ポート
- ⑥ ワイヤレス 充電ケース
- ⑦ 充電インジケータ
- ⑧ 充電スロット

### IT

- ① Controllo Touch Multifunzione
- ② Indicatore LED
- ③ Microfono
- ④ Contatti per la Ricarica
- ⑤ Porta di Ricarica Micro-USB
- ⑥ Custodia di Ricarica Wireless
- ⑦ Indicatore di Ricarica
- ⑧ Slot per la Ricarica

EN

## HOW TO WEAR

### Choose the Right Tips

Ear tips with different sizes are included in the package, try all sizes and choose the ones fitting you best.

### Wear the Earbuds (Fig. 3)

Please wear the earbuds as shown below.

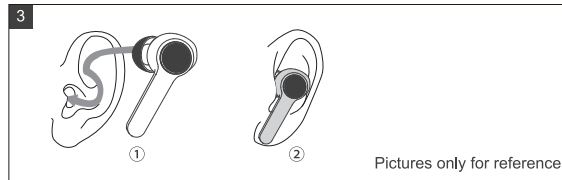

### Bluetooth Caution

- When the device is connected wirelessly to another device, place the two devices close to each other to achieve their normal functionalities and avoid possible signal interference.
- The effective Bluetooth range may vary with the environmental circumstances.
- When using a wireless connection, make sure there are no obstacles between the two devices. Obstacles including walls and fences may shorten the effective range.

## USING YOUR EARBUDS

### Charging

Charging the Earbuds

1. Put the earbuds into the charging case as per the L (left) and R (right) marks (Fig. 4).
2. Cover the lid and charging will start automatically (Fig. 5).

#### Note:

- Please fully charge the earbuds when using them for the first time.
- When battery is low, a "Battery low" voice prompt will be heard (if you are wearing the earbuds). Please charge it in time or the earbuds will turn off automatically around 10 minutes later.
- Charge the earbuds at least once every 3 months when not using for a long time.

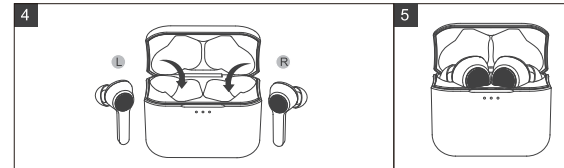

### Charging the Charging Case

1. Connect the charging port with any USB charging adapter or active computer USB port (Fig. 6).
2. The four charging indicators will light up progressively.

Note: Unplug the charging cable (timely) when fully charged.

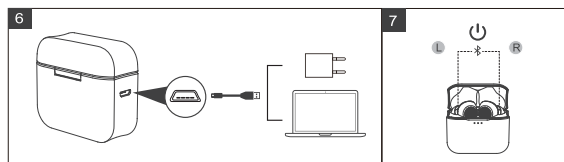

**Power On (Fig. 7)**  
Uncover the lid and they will power on automatically.

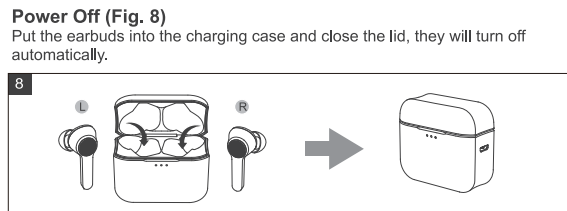

**Power Off (Fig. 8)**  
Put the earbuds into the charging case and close the lid, they will turn off automatically.

### Pairing

- You can use one earbud or both earbuds as per your preference. Please refer to the corresponding pairing instructions.
- Before pairing, please turn off other Bluetooth devices and place the device to be connected close to the earbuds.

- When the earbuds are disconnected from your device for more than 10 minutes, they will turn off automatically.

### Couple Earbuds Mode

1. Uncover the lid to turn on the earbuds, they will connect with each other automatically. Once connected, The LED indicators on both earbuds will flash red and white alternately indicating the earbuds are in pairing mode now.
2. Turn on the Bluetooth function on your device and search for nearby devices. Find "iTeknic IK-BH004" in the searching results, tap on the name to connect.
3. Once connected, the LED indicators on both earbuds will flash white slowly.

#### Note:

- We recommend you to take out the earbuds from the charging case only when the earbuds complete automatic pairing in the charging case.
- If the earbuds failed to pair with each other, please disconnect the Bluetooth connection with your device, put them back into the charging case, close the lid then open it to pair again.
- It is not recommended to wear the two earbuds on different people. If needed, please keep the 2 earbuds within 3 meters / 9.8 feet in couple earbuds mode.

### Single Earbud Mode

1. Take out one earbud from the charging case, and make sure the other one is placed in the charging case and the lid is covered.
2. It will try to pair with the last paired device first then enter pairing mode with its LED indicator flashing red and white alternately if pairing failed.
3. Turn on the Bluetooth function on your device and search for nearby devices. Find "iTeknic IK-BH004" in the searching results, tap on the name to connect.

4. Once connected, the LED indicator will flash white slowly.

**Note:**

If you want to change to couple mode, simply take out the other earbud from the charging case, they will pair with each other automatically.

**Clear Pairing List**

If you failed to pair your device with the earbuds, please clear the pairing history as instructed below:

1. If you have paired your device with the earbuds before, remove "iTeknic IK-BH004" from the Bluetooth device list.
2. Put the earbuds back into the charging case close the lid, then open case to take out a earbud, make sure the other earbud is in the caharging case and the lid is closed. tap the touch control 6 times, and the headset 's white light flashes 3 times, and the red light flashes 3 times while earbud is turned off; Then take out other earbud from the case, tap the touch control 6 times, and the headset 's white light flashes 3 times, and the red light flashes 3 times while the other earbud is turned off. Put two earbuds into the charging case and close the lid, then open the lid again and the two earbuds will pair with each other automatically.
3. Pair them with your device when the LED indicators on both earbuds flashes red and white alternately indicating the earbuds are in pairing mode now.

**Note:**

If you want to pair the earbuds with another device when you have already paired them with a device, deactivate the Bluetooth function on the paired device or clear "iTeknic IK-BH004" from its Bluetooth list. Restore the earbuds to factory settings as instructed above if pairing failed.

**OPERATION AND FUNCTIONS**

Function	Operation	Voice Prompt
Play / Pause	Tap the Touch Control on either of the earbuds twice	/
Volume +	Tap the Touch Control on the right earbud.	Toots when highest setting is reached
Volume -	Tap the Touch Control on the left earbud	
Next Track	Tap the Touch Control on the right earbud three times	/
Previous Track	Tap the Touch Control on the left earbud three times	/
Answer Phone Call	Tap the Touch Control on either of the earbuds once	/
Hang up Phone Call	Tap and hold the Touch Control on either of the earbuds for 2 seconds	/
Decline an Incoming Call	Tap and hold the Touch Control on either of the earbuds for 2 seconds	Call rejected
Turn On / Off Voice Control	When paired successfully, press and hold the Touch Control on either of the earbuds for 2 seconds until a beep is heard	Toot
Clear Pairing List	Refer to the "Clear Pairing List" section	/
Go into Pairing Mode	Refer to the "Pairing" section	Pairing
Successfully paired with your device	/	Connected
Bluetooth out of Range / Failed to pair with your device	/	Disconnected

**Note:** Only when you are wearing the earbuds can you hear the voice prompt.

### CLEANING AND MAINTENANCE

1. Clean the earbuds and the charging case on a regular basis.
  2. Use dry and soft cotton cloth to wipe the unit.
- Note:** Do not insert anything into the product.
3. Keep away from sharp objects to avoid scratches.
  4. Put the unit in a dry and shady place if it is to be idle for a long time.
  5. Do not clean the product with detergent or chemicals.

### TROUBLESHOOTING

No.	Problem	Solution
1	Failed to turn on the earbuds	Earbuds low battery, please charge them
2	Failed to charge the earbuds	<ul style="list-style-type: none"> <li>• Place the earbuds into the charging case properly</li> <li>• Make sure the charging case is charged fully</li> </ul>
3	Can't charge the charging case	Make sure the charging cable is intact and plugged in properly
4	Can't find "iTeknic IK-BH004" in the Bluetooth device list	<p>The earbuds reconnected with previously paired device automatically:</p> <ul style="list-style-type: none"> <li>• Deactivate the Bluetooth function of previously paired device or clear "iTeknic IK-BH004" from its Bluetooth device list, and then search again</li> <li>• Put the device to be connected and the earbuds within 10 meters / 33 feet</li> </ul>
5	Failed to pair the earbuds with your device	<ul style="list-style-type: none"> <li>• Turn on the device and activate its Bluetooth function before pairing</li> <li>• Bring the earbuds into pairing mode as instructed in the "Pairing" section</li> </ul>

6	No sound in one of the earbuds in couple earbuds mode	Place both earbuds back to the charging case then take them out, they will pair with each other automatically. If pairing failed, restore them back to the factory settings as instructed in the "Restore to Factory Settings" section
7	Poor sound quality	<ul style="list-style-type: none"> <li>• Wear the earbuds properly and keep them close to each other.</li> <li>• Place the connected device close to the earbuds or remove the obstacles between them</li> <li>• Clear the debris on the earbuds</li> </ul>
8	Unstable connection	<ul style="list-style-type: none"> <li>• Keep the earbuds and your Bluetooth device within 10 meters / 33 feet</li> <li>• The effective distance may shorten with obstacles in the way</li> <li>• Turn off other Bluetooth devices to decrease the interference</li> </ul>
9	Can't hear the other party during a phone call	Set the volume to higher level
10	The other party can't hear your voice during a phone call	Free the built-in microphone of any covers
11	Multifunction Touch control of the earbuds is unresponsive	Place the two earbuds into the charging case and cover the lid, disconnect the Bluetooth connection. Uncover the lid to turn on the earbuds and pair again.

### WARRANTY AND SERVICE

If any problems occur, please contact the iTeknic Customer Care Centre in your country via the contact information listed in this User Guide.

 **Bluetooth** EN The Bluetooth® word mark and logos are registered trademarks owned by the Bluetooth SIG, Inc. and any use of such marks by Sunvalleytek International Inc. is under license. Other trademarks and trade names are those of their respective owners.

**DE** Die Marke Bluetooth® und das Bluetooth Logo sind eingetragene Markenzeichen der Bluetooth SIG, Inc. und jegliche Verwendung dieser Marke durch Sunvalleytek International Inc. ist lizenziert. Die Rechte an anderen Markenzeichen liegen beim jeweiligen Eigentümer.

**FR** Le terme et les logos Bluetooth® sont la propriété de Bluetooth SIG, Inc. et toute utilisation de ces marques par Sunvalleytek International Inc. se fait sous licence. Les autres désignations commerciales et marques mentionnées sont détenues par leur propriétaire respectif.

**ES** La marca Bluetooth® y los logotipos son de propiedad de Bluetooth SIG, Inc. y se encuentra autorizado cualquier uso de estas marcas por parte de Sunvalleytek International Inc. Otras marcas y nombres comerciales son aquellas de sus respectivos propietarios.

**IT** La parola e i loghi Bluetooth® sono marchi di fabbrica registrati di proprietà di Bluetooth SIG, Inc. e qualsiasi utilizzo di questi marchi da parte di Sunvalleytek International Inc. avviene su licenza. Gli altri marchi di fabbrica e nomi commerciali appartengono ai rispettivi proprietari.

**JP** Bluetooth®のワードマークおよびロゴはBluetooth SIG, Inc.が所有する登録商標であり、Sunvalleytek International Inc.はこれらのマークおよびロゴをライセンスに基づいて使用しています。その他の商標およびトレードネームは、それぞれの所有者に帰属します。



**WEEE Compliance**

Correct Disposal of This Product (Waste Electrical & Electronic Equipment)  
(Applicable in countries with separate collection systems)

This marking on the product, accessories or literature indicates that the product and its electronic accessories should not be disposed of with other household waste at the end of their working life. To prevent possible harm to the environment or human health from uncontrolled waste disposal, please separate these items from other types of waste and recycle them responsibly to promote the sustainable reuse of material resources. Household users should contact either the retailer where they purchased this product, or their local government office, for details of where and how they can take these items for environmentally safe recycling. Business users should contact their supplier and check the terms and conditions of the purchase contract. This product and its electronic accessories should not be mixed with other commercial wastes for disposal.

**NOTE:**

This equipment has been tested and found to comply with the limits for a Class B digital device, pursuant to part 15 of the FCC Rules. These limits are designed to provide reasonable protection against harmful interference in a residential installation. This equipment generates uses and can radiate radio frequency energy and, if not installed and used in accordance with the instructions, may cause harmful interference to radio communications.

However, there is no guarantee that interference will not occur in a particular installation. If this equipment does cause harmful interference to radio or television reception, which can be determined by turning the equipment off and on, the user is encouraged to try to correct the interference by one or more of the following measures:

- Reorient or relocate the receiving antenna.
- Increase the separation between the equipment and receiver.
- Connect the equipment into an outlet on a circuit different from that to which the receiver is connected.
- Consult the dealer or an experienced radio/TV technician for help

The device has been evaluated to meet general RF exposure statement.

The device can be used in portable exposure condition without restriction

FCC ID: 2ADTV-A801-38

Changes or modifications not expressly approved by the party responsible for compliance could void the user's authority to operate the equipment. This device complies with Part 15 of the FCC Rules. Operation is subject to the following two conditions:

- (1) this device may not cause harmful interference, and
- (2) this device must accept any interference received, including interference that may cause undesired operation.