

黑色

We'd love to hear from you. Scan with your Walmart app and let us know what you think.



The Fine Print

FCC Statement

This equipment has been tested and found to comply with the limits for a Class B digital device, pursuant to Part 15 of the FCC Rules. These limits are designed to provide reasonable protection against harmful interference in a residential installation. This equipment generates uses and can radiate radio frequency energy and, if not installed and used in accordance with the instructions, may cause harmful interference to radio communications.

However, there is no guarantee that interference will not occur in a particular installation. If this equipment does cause harmful interference to radio or television reception, which can be determined by turning the equipment off and on, the user is encouraged to try to correct the interference by one or more of the following measures: -- Reorient or relocate the receiving antenna. -- Increase the separation between the equipment and receiver. -- Connect the equipment into an outlet on a circuit different from that to which the receiver is connected.

The Fine Print

-- Consult the dealer or an experienced radio/TV technician for help. This device complies with part 15 of the FCC Rules. Operation is subject to the following two conditions: (1) This device may not cause harmful interference, and (2) this device must accept any interference received, including interference that may cause undesired operation.

Warning:

Changes or modifications to this unit not expressly approved by the party responsible for compliance could void the user's authority to operate the equipment.

Need help? We're here for you every day from 7 a.m.-9 p.m. CST. Give us a call at 1-888-516-2630.

Produced for Walmart Inc. Bentonville, AR 72716

The device has been evaluated to meet general RF exposure requirement. The device can be used in portable exposure condition without restriction.

Ver. 03/26/17/22

FCC ID :2ADTV-2890

onn.™

Wireless On-Ear Headphones Quick Start Guide

Get to Know Your Wireless Headphones

- 1) Model: AAABLK100002890
2) Speaker Rated Input Power: 10mW
3) Speaker Maximum Input Power: 15mW
4) Speaker Diameter: 30mm
5) Speaker Impedance: 32Ω±15%
6) Sensitivity: 100±4dB
7) Charging Cable: 50cm
8) Audio Cable: 120cm

What's in the Box?

Check to make sure you have everything below

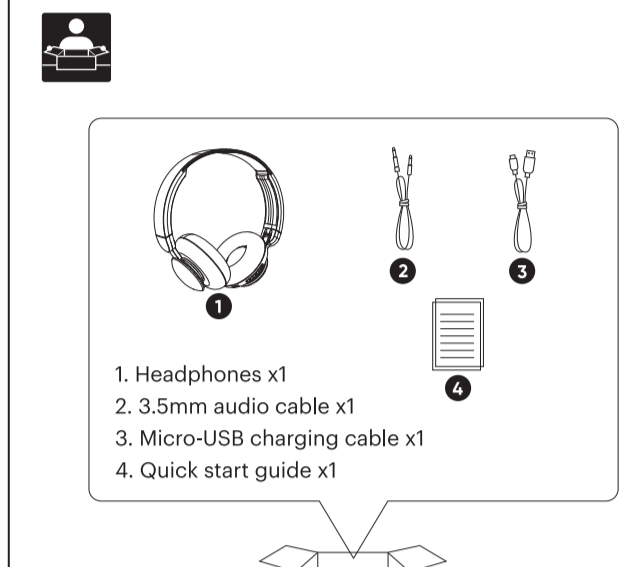

Let's Get Started! On/Off & Pairing 01

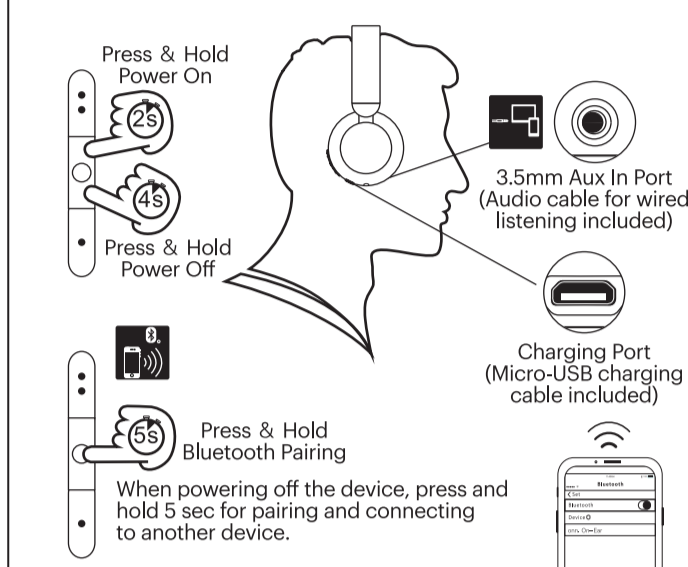

For the first time use, power on the headphones and it will go to pairing mode automatically. Product will automatically reconnect to the last paired device when powered on next time.

Enjoy Your Music 02

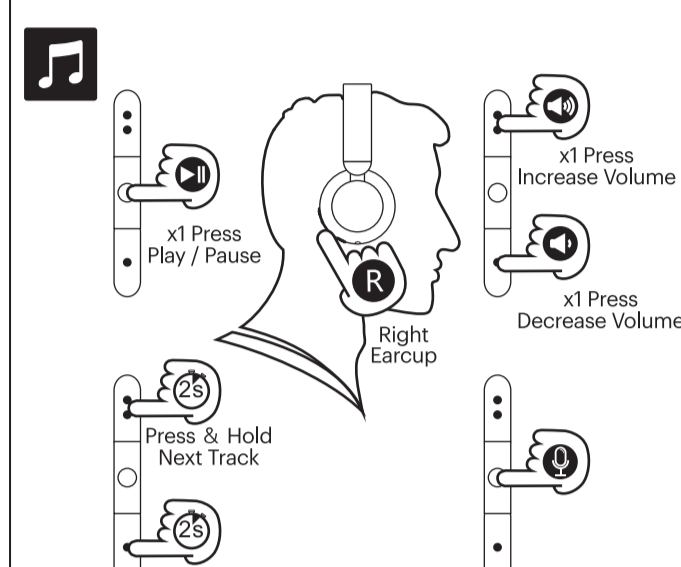

Take a Clear Phone Call 03

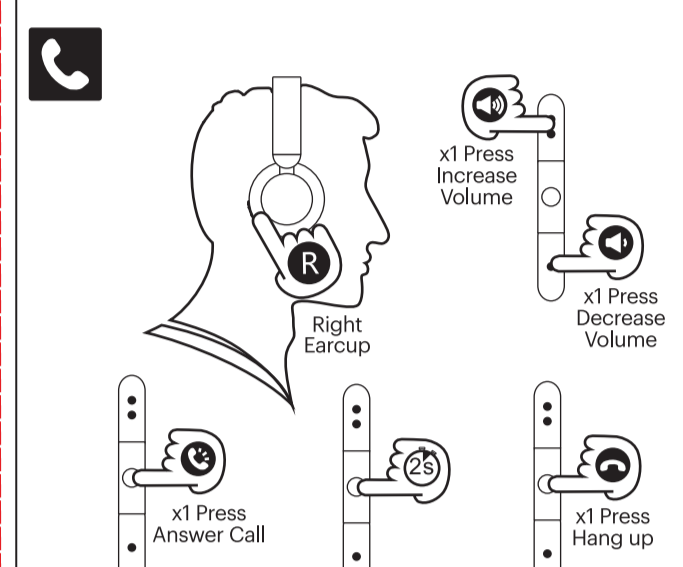

Charge Your Headphones 04

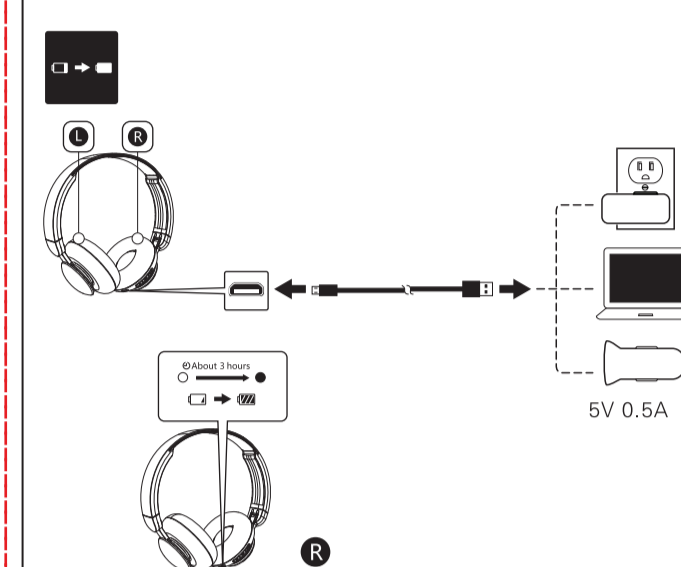

3/26/17/22

蓝色

We'd love to hear from you. Scan with your Walmart app and let us know what you think.



The Fine Print

FCC Statement

This equipment has been tested and found to comply with the limits for a Class B digital device, pursuant to Part 15 of the FCC Rules. These limits are designed to provide reasonable protection against harmful interference in a residential installation. This equipment generates uses and can radiate radio frequency energy and, if not installed and used in accordance with the instructions, may cause harmful interference to radio communications.

However, there is no guarantee that interference will not occur in a particular installation. If this equipment does cause harmful interference to radio or television reception, which can be determined by turning the equipment off and on, the user is encouraged to try to correct the interference by one or more of the following measures: -- Reorient or relocate the receiving antenna. -- Increase the separation between the equipment and receiver. -- Connect the equipment into an outlet on a circuit different from that to which the receiver is connected.

The Fine Print

-- Consult the dealer or an experienced radio/TV technician for help. This device complies with part 15 of the FCC Rules. Operation is subject to the following two conditions: (1) This device may not cause harmful interference, and (2) this device must accept any interference received, including interference that may cause undesired operation.

Warning:

Changes or modifications to this unit not expressly approved by the party responsible for compliance could void the user's authority to operate the equipment.

Need help? We're here for you every day from 7 a.m.-9 p.m. CST. Give us a call at 1-888-516-2630.

Produced for Walmart Inc. Bentonville, AR 72716

The device has been evaluated to meet general RF exposure requirement. The device can be used in portable exposure condition without restriction.

Ver. 03/26/17/22

FCC ID :2ADTV-2890

onn.™

Wireless On-Ear Headphones Quick Start Guide

Get to Know Your Wireless Headphones

- 1) Model: AAABLU100002890
2) Speaker Rated Input Power: 10mW
3) Speaker Maximum Input Power: 15mW
4) Speaker Diameter: 30mm
5) Speaker Impedance: 32Ω±15%
6) Sensitivity: 100±4dB
7) Charging Cable: 50cm
8) Audio Cable: 120cm

What's in the Box?

Check to make sure you have everything below

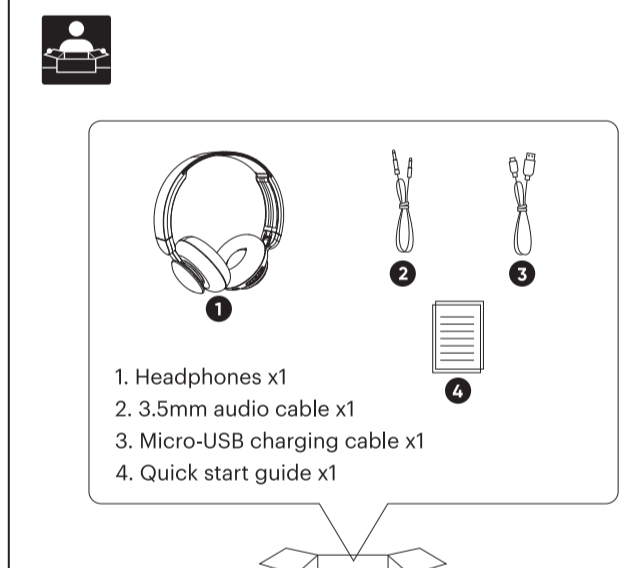

Let's Get Started! On/Off & Pairing 01

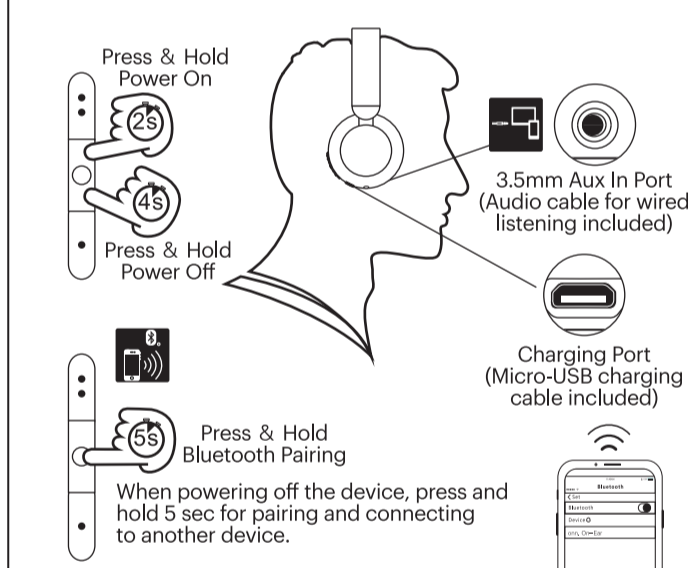

For the first time use, power on the headphones and it will go to pairing mode automatically. Product will automatically reconnect to the last paired device when powered on next time.

Enjoy Your Music 02

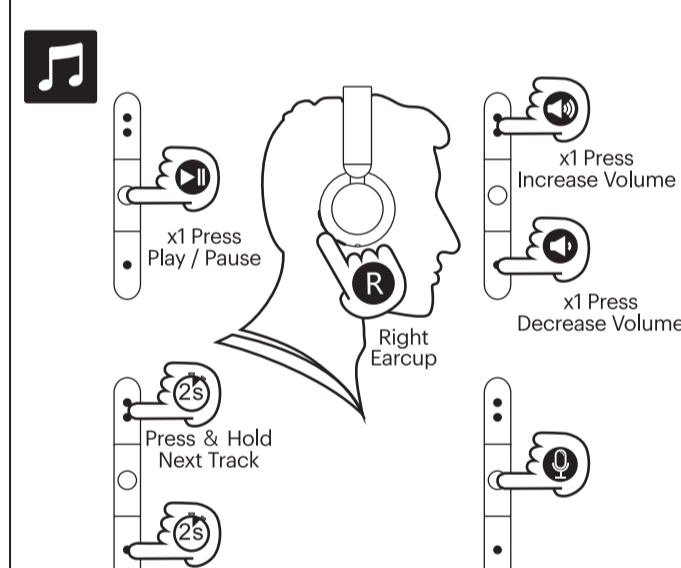

Take a Clear Phone Call 03

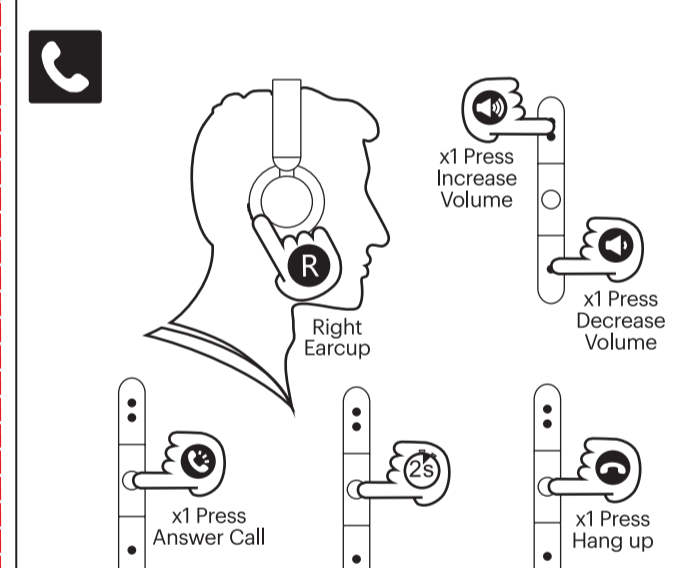

Charge Your Headphones 04

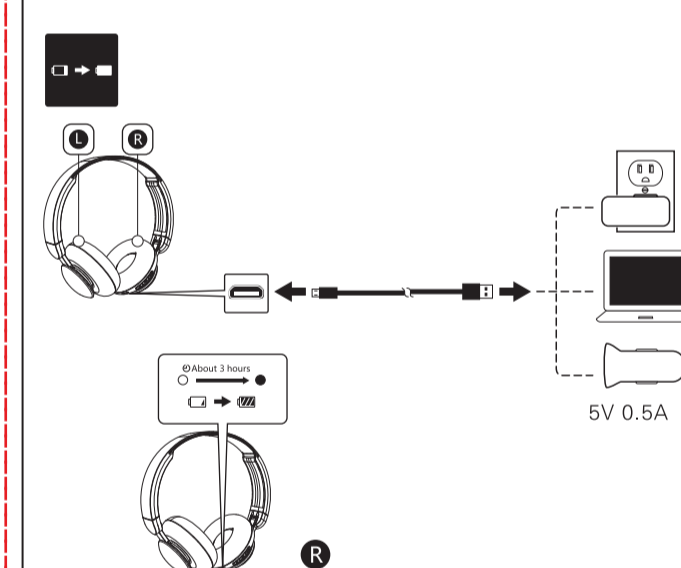

紫色

We'd love to hear from you. Scan with your Walmart app and let us know what you think.



The Fine Print

FCC Statement

This equipment has been tested and found to comply with the limits for a Class B digital device, pursuant to Part 15 of the FCC Rules. These limits are designed to provide reasonable protection against harmful interference in a residential installation. This equipment generates uses and can radiate radio frequency energy and, if not installed and used in accordance with the instructions, may cause harmful interference to radio communications.

However, there is no guarantee that interference will not occur in a particular installation. If this equipment does cause harmful interference to radio or television reception, which can be determined by turning the equipment off and on, the user is encouraged to try to correct the interference by one or more of the following measures: -- Reorient or relocate the receiving antenna. -- Increase the separation between the equipment and receiver. -- Connect the equipment into an outlet on a circuit different from that to which the receiver is connected.

The Fine Print

-- Consult the dealer or an experienced radio/TV technician for help. This device complies with part 15 of the FCC Rules. Operation is subject to the following two conditions: (1) This device may not cause harmful interference, and (2) this device must accept any interference received, including interference that may cause undesired operation.

Warning:

Changes or modifications to this unit not expressly approved by the party responsible for compliance could void the user's authority to operate the equipment.

Need help? We're here for you every day from 7 a.m.-9 p.m. CST. Give us a call at 1-888-516-2630.

Produced for Walmart Inc. Bentonville, AR 72716

The device has been evaluated to meet general RF exposure requirement. The device can be used in portable exposure condition without restriction.

Ver. 03/26/17/22

FCC ID :2ADTV-2890

onn.™

Wireless On-Ear Headphones Quick Start Guide

Get to Know Your Wireless Headphones

- 1) Model: AAAPRP100002890
2) Speaker Rated Input Power: 10mW
3) Speaker Maximum Input Power: 15mW
4) Speaker Diameter: 30mm
5) Speaker Impedance: 32Ω±15%
6) Sensitivity: 100±4dB
7) Charging Cable: 50cm
8) Audio Cable: 120cm

What's in the Box?

Check to make sure you have everything below

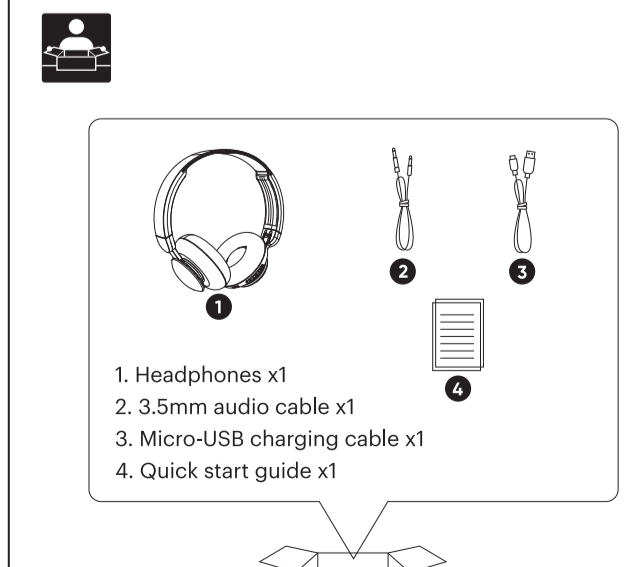

Let's Get Started! On/Off & Pairing 01

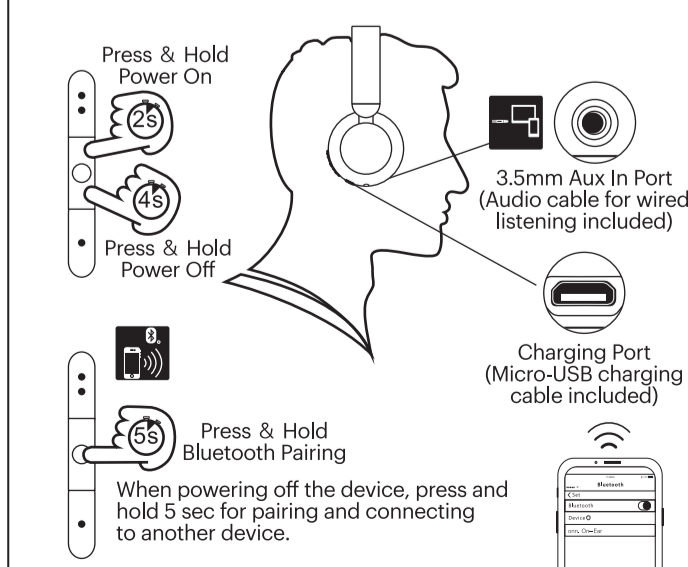

For the first time use, power on the headphones and it will go to pairing mode automatically. Product will automatically reconnect to the last paired device when powered on next time.

Enjoy Your Music 02

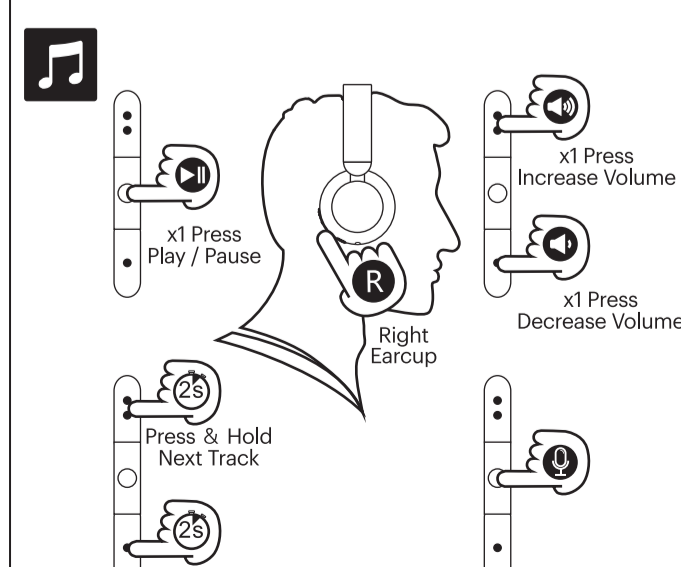

Take a Clear Phone Call 03

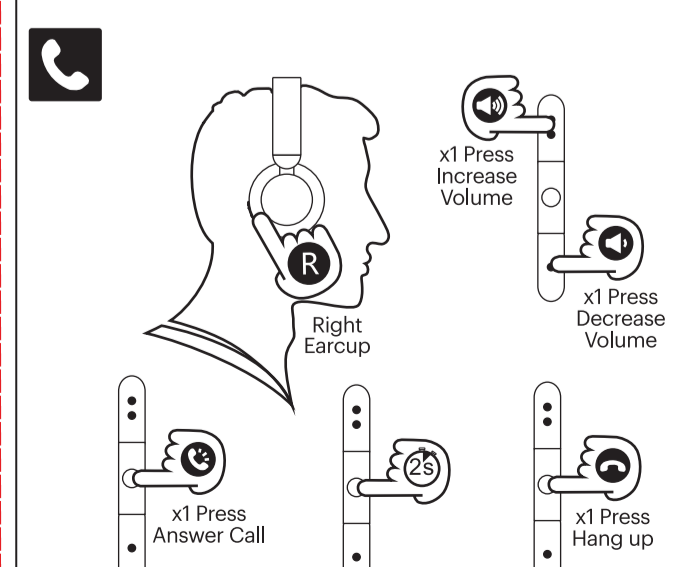

Charge Your Headphones 04

