

About this Manual

Congratulations on purchasing the Coleman DV6000AF Sports & Action Camera! The contents of this manual are subject to change without notice. Note that the example screens and product illustrations shown in this User's Guide may differ somewhat from the screens and configuration of the actual camera.

Copyright

This manual contains proprietary information protected by copyright. All rights are reserved. No part of this manual may be reproduced by any mechanical, electronic or other means, in any form, without prior written permission of Elite Brands Inc. ©.

FEDERAL COMMUNICATIONS COMMISSION INTERFERENCE STATEMENT

This equipment has been tested and found to comply with the limits for a Class B digital device, pursuant to Part 15 of the FCC Rules. These limits are designed to provide reasonable protection against harmful interference in a residential installation. This equipment generates, uses and can radiate radio frequency energy and, if not installed and used in accordance with the instructions, may cause harmful interference to radio communications. However, there is no guarantee that interference will not occur in a particular installation. If this equipment does cause harmful interference to radio or television reception, which can be determined by turning the equipment off and on, the user is encouraged to try to correct the interference by one or more of the following measures:

- Reorient or relocate the receiving antenna.
- Increase the separation between the equipment and receiver.
- Connect the equipment into an outlet on a circuit different from that to which the receiver is connected.
- Consult the dealer or an experienced radio/TV technician for help.

CAUTION:

Any changes or modifications not expressly approved by the party responsible for compliance could void the user's authority to operate the equipment. This device complies with Part 15 of the FCC Rules. Operation is subject to the following two conditions:

- (1) This device may not cause harmful interference and
- (2) This device must accept any interference received, including interference that

may cause undesired operation.

CE Mark Warning

This is a Class B product, in a domestic environment, this product may cause radio interference, in which case the user may be required to take adequate measures.

Camera Information

- Do not disassemble or attempt to service the camera yourself.
- Do not expose the camera to moisture, or extreme temperatures.
- Allow the camera to warm up when moving from cold to warm temperatures.
- Do not touch and put pressure on the camera lens.
- Do not expose the lens to direct sunlight for extended periods.
- Do not use abrasive chemicals, cleaning solvents or strong detergents to clean the product. Wipe the product with a slightly damp soft cloth.
- Do not use the flash or LED Light near a person's eyes to prevent possible eye injury.
- To prevent you from falling over or resulting in traffic accident, please do not use the camera while you are walking, driving or riding a vehicle.
- Please handle the camera strap with care, and never place the strap around the neck of an infant or child. Wrapping the strap around a neck may cause suffocation.
- Do not subject the LCD screen to impact.
- To prevent the risk of fire or electric shock, do not expose the inside of this product to rain or moisture.

Battery Information

- Turn off the camera before installing or removing the battery.
- Use only the provided batteries or type of battery and charger that came with your camera. Using other types of battery or charger may damage the device and invalidate the warranty.
- Inserting the battery upside down can cause damage to the product and possibly cause an explosion.
- When the camera is used for an extended period of time, it is normal for the camera body to feel warm.
- Download all pictures and remove the battery from the camera if you are going to store the camera for a long period of time.
- Risk of explosion if battery is replaced by an incorrect type. Dispose of used batteries according to the instructions.
- Please keep the batteries out of the reach of children to prevent from swallowing the batteries, which might cause poisoning.
- If the battery's color or shape changes in any way, stop using the battery immediately.

USB Adaptor Information

- Do not expose the adaptor to high temperatures or moisture places. Otherwise, it may cause fire or electric shock.
- Do not attempt to repair, disassemble, change or transform the adaptor.
- Avoid sudden changes in temperature, which may cause condensation on the adaptor's internal surfaces. Please do not use it immediately in this situation.
- Do not touch the plug with wet hands. Otherwise, it may cause electric shock.
- Do not use the travel voltage converter or AC/DC power inverter. Otherwise, it may cause damage, overheating, malfunction or fire to the camera.

Waterproof and Dustproof Information

- The waterproof and dustproof performance described do not guarantee that the camera will remain completely waterproof or free from damage and trouble under all conditions.
- Do not subject the camera to excessive shock, Vibration or pressure by dropping it, hitting it or placing a heavy object on it. Failure to observe this precaution could deform the camera, cause water to seep inside, or damage the airtight seals,

resulting in camera malfunction.

- The battery door must be closed securely and the lock engaged in order for the camera to be waterproof. Failure to do this can allow water to enter the camera and damage it.

The camera can shoot images underwater at a depth of 3m (10ft) for up to 60 minutes.

- Do not drop the camera, strike it against a hard object such as a rock, or throw it against a water surface.
- Do not subject the camera to shock when using it underwater.
- Do not expose to depths greater than 3m (10ft) underwater.
- Do not continuously use the camera underwater for 60 minutes or more.
- Do not insert a wet memory card or battery in the camera.
- Do not open the battery cover when the camera or your hands are wet. Doing so may cause water to seep inside the camera or result in camera malfunction.
- Do not open the battery cover underwater.
- If moisture such as water droplets adheres to the outside of the camera or inside of the battery cover, immediately wipe it off with a soft dry cloth.
- If a foreign substance adheres to the outside of the camera or inside of the battery cover, immediately remove it with a soft cloth.
- Do not leave the camera in cold conditions or hot conditions of 40°C (104°F) or more for a long period of time.
- When using the camera underwater, make sure the water temperature is from 0°C-40°C (32°F to 104°F).
- Do not use the camera in hot springs.

Before Using the Camera Underwater

Check the items below before using the camera underwater.

- Make sure that there are no foreign substances inside the battery cover.
- Make sure that the waterproof packing of the battery cover is not cracked or deformed.
- Make sure that the battery door is firmly closed and the battery cover security lock is in the LOCK position.
- Failure to follow these steps can result in damage to the camera.

Notes about Opening and Closing the Battery Door

- Make sure the camera and your hands are not wet.
- Make sure that there are no debris inside the battery-chamber or memory card slot.
- Make sure that the battery cover is firmly closed and the security lock is in the lock position.

Precautions When Cleaning

- Do not puncture the microphone or speaker openings with a sharp implement.
- If the inside of the camera is damaged, the waterproof performance will deteriorate.
- Do not use soap, natural detergents, or chemicals such as benzene for cleaning.

Do Not Apply Strong Impact to the Camera

The product may malfunction if subjected to strong shock or vibration. In addition, do not touch or apply force to the lens.

Avoid Sudden Changes in Temperature

Sudden changes in temperature, such as when entering or leaving a heated building on a cold day, can cause condensation to form inside the device. To prevent condensation, place the device in a carrying case or a plastic bag before exposing it to sudden changes in temperature.

Keep Away from Strong Magnetic Fields

Do not use or store this device in the vicinity of equipment that generates strong electromagnetic radiation or magnetic fields. Doing so could result in loss of data or camera malfunction.

Do Not Point the Lens at Strong Light Sources for Extended Periods

Avoid pointing the lens at the sun or other strong light source light sources for extended periods when using or storing the camera. Intense light may cause the image sensor to deteriorate or produce a white blur effect in photographs.

Turn the Product Off before Removing or Disconnecting the Power Source or Memory Card

Do not remove the battery while the product is on, or while images are being saved or deleted. Forcibly cutting power in these circumstances could result in loss of data or cause damage to the memory card or internal circuitry.

Notes about the LCD Screen

- The LCD Screens are constructed with extremely high precision; At least 99.99% of pixels are effective, with no more than 0.01% being missing or defective. Hence, while these displays may contain pixels that are always lit (white, red, blue or green) or always off (black), this is not a malfunction and has no effect on images recorded with the device.
- Images viewed on the LCD screen may be difficult to see under certain lighting.
- Do not apply pressure to the LCD screen, as this could cause damage or malfunction.

The Battery

Precautions for Use

- Note that the battery may become hot after use.
- Do not use the battery at ambient temperatures below 0°C (32°F) or above 40°C (104°F) as this could cause damage or malfunction.
- If you notice any abnormalities such as excessive heat, smoke, or an unusual smell coming from the battery, immediately discontinue use and consult your retailer.
- After removing the battery from the camera or optional battery charger, put the battery in a plastic bag, etc. in order to insulate it.

Charging the Battery

Check the battery level before using the camera and replace or charge the battery if necessary.

- Charge the battery indoors with an ambient temperature of 5°C (41°F) to 35°C (95°F) before use.
- A high battery temperature may prevent the battery from charging properly or

completely, and may reduce battery performance. Note that the battery may become hot after use; wait for the battery to cool before charging. When charging the battery inserted into this camera using the Charging AC Adapter or a computer, the battery is not charged at battery temperature below 5°C (41°F) or above 55°C (131°F).

- When the battery is between 45°C (113°F) - 55°C (131°F), the chargeable capacity may decrease.
- Do not continue charging once the battery is fully charged as this will result in reduce battery performance.
- The battery temperature may increase during charging.

Using the Battery When Cold

On cold days, the capacity of batteries tends to decrease. If an exhausted battery is used at a low temperature, the camera may not turn on. Keep spare batteries in a warm place and exchange as necessary. Once warmed, a cold battery may recover some of its charge.

Recycling Used Batteries

Replace the battery when it no longer holds a charge. Used batteries are a valuable resource. Please recycle used batteries in accordance with local regulations.

Cleaning After Using the Camera Underwater

Follow the procedure below to rinse the camera with fresh water within 30 minutes after using it under saltwater or at the beach.

1. Keep the battery cover closed and wash off the camera with fresh water. Immerse the camera in a shallow basin filled with fresh water for 10 minutes.
2. Immerse the camera in fresh water and shake it sufficiently in the water to remove any foreign substances from the camera.
3. When the camera is immersed in the water, a few air bubbles may come out from the water drain holes of the camera such as openings in the microphone or speakers. This is not a malfunction.
4. Wipe off water droplets with soft cloth and dry the camera in a well-ventilated and shady place.
5. Place the camera on a dry cloth to dry it.
6. Do not dry the camera with hot air from a hair dryer or clothes dryer.

7. After making sure that there are no water droplets on the camera, open the battery cover and use a soft dry cloth to gently wipe off any water or sand remaining on the waterproof packing or inside the camera.
 - **If the cover is closed when the inside is wet, this could cause condensation or a malfunction.**

Cleaning After Using the Camera in Conditions Other than Underwater

Use a blower to remove any dust or lint that adheres to the lens, monitor or camera body. To remove fingerprints or other stains that cannot be removed with a blower, gently wipe the parts with a soft dry cloth. If you wipe with too much pressure or with a rough cloth, it may damage the camera or cause a malfunction.

Storage

If you do not intend to use the camera for an extended period, remove the battery and avoid storing the camera in any of the following types of locations:

- Places that are poorly ventilated or subject to humidity of over 60%
- Place exposed to temperatures above 50°C (122°F) or below -10°C (14°F).
- Place next to equipment that produces strong electromagnetic field, such as television or radios.

To prevent mold or mildew, take the camera out of storage at least once a month, and turn it on and release the shutter a few times before putting it away again.

■ CAMERA OVERVIEW



CAMERA OVERVIEW

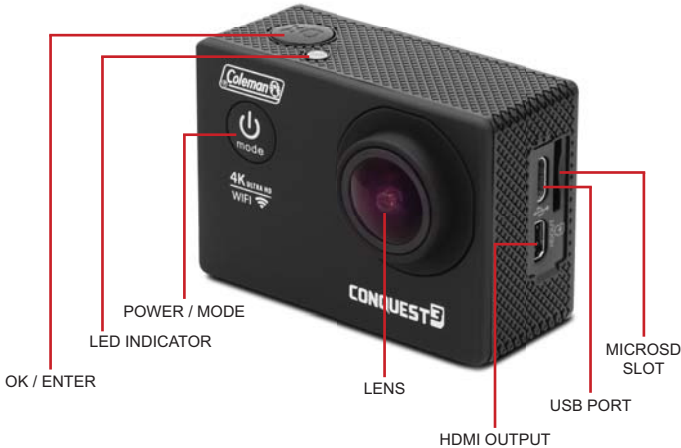

■ CAMERA OVERVIEW

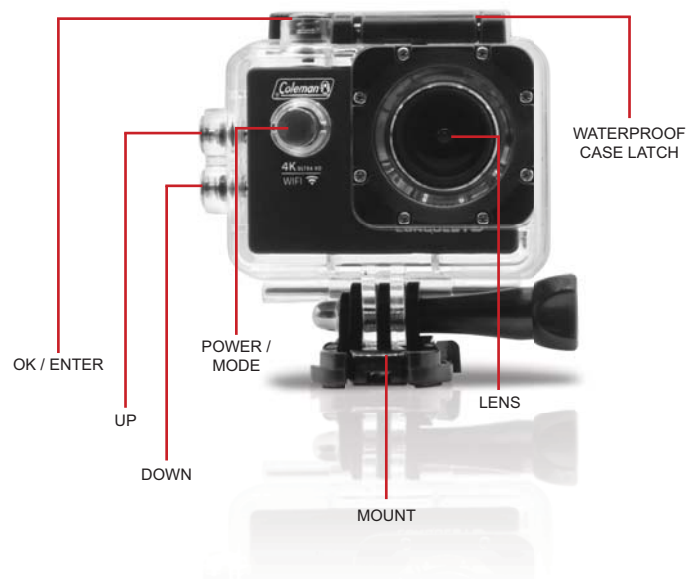

Operating Guide

1. Inserting / Removing a Memory Card

Ensure the camcorder is powered off. Insert a MicroSD card into the MicroSD card slot. The MicroSD card can only be inserted one way. Do not force it through. Once successfully inserted, it will click in. To remove, simply push the card in for it to pop out.



2. Inserting / Removing the Battery

- Remove the battery cover by pinching the small tab inward and pull up.
- The battery is purposely shaped so that it can be inserted only one way. Follow the shape of the battery compartment before inserting.
- To remove the battery, first power the camcorder off. Remove the battery cover. The battery is easily removed by pulling on the black plastic pull tab.

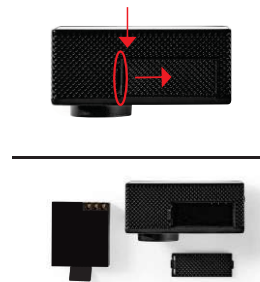

3. Charging the Battery

- a. Connect the included USB cable's small end into the camcorder's USB input, and the larger end into the AC adaptor. The LED will flash in red and will stay solidly lit in red once the battery is fully charged.
- b. You may use the camcorder for recording or playback while it is plugged into auxiliary power (AC adaptor, computer, mobile charger).
- c. For the quickest charge, please ensure that the camcorder is powered off.

4. Power On / Off

- a. Ensure that the battery is fully charged.
- b. Press and hold the **POWER** button for 3 seconds until the camcorder powers on. Press and hold the **POWER** button again for 3 seconds to power off.

5. Enabling / Disabling WiFi

- a. Enabling WiFi: Press the **UP** button once. The LED light will flash in yellow and the screen will display the WiFi details.
- b. Disabling WiFi: Once the WiFi is enabled, press the **UP** button once. The yellow LED light will no longer illuminate.

6. Changing Modes

The power button also functions as the **MODE** button. Once the camcorder is powered on, press the power button to cycle between Recording Videos / Shooting Photographs / Slow-Motion Video / Burst Photo / Playback / Settings.



Video Mode

To record video, ensure the camera is powered on and in **VIDEO** mode.

To begin recording:

Press the **ENTER** button. The camera will emit a *beep* sound and the status LED will blink while recording.

To stop Recording:

Press the **ENTER** button again. The camera will emit another *beep* sound and the status LED will no longer illuminate.



Photo Mode

Ensure the camera is in **PHOTO** mode by tapping the **POWER** button.

To capture a photo:

Press the **ENTER** button. The camera will emit a *shutter* sound.



Burst Mode

Ensure the camera is in **BURST PHOTO** mode by tapping the **POWER** button.

To start burst photos:

Press the **ENTER** button. The camera will emit *shutter* sounds for each photo.



Time Lapse Series

Ensure the camera is in **TIME LAPSE** mode by tapping the **POWER** button, and verify that *continuous lapse* is enabled in the settings menu.

To start a time lapse series:

Press the **ENTER** button. The camera initiates a countdown and will emit a *shutter* sound for each photo that is captured.

7. LED Light Color Statuses

Blue LED: The camcorder is busy processing an image or video.

Yellow LED: WiFi is enabled. When flashing yellow, the WiFi is waiting to connect; when solidly lit, WiFi is connected.

Red LED: The battery is charging.

8. Recording Video

Once powered on, the camcorder automatically enters VIDEO mode. Press the **ENTER** button to begin recording. The bottom of the screen will show a flashing red dot, denoting that video is recording. Press the **ENTER** button again to stop recording.

9. Shooting Photographs

Once powered on, press the **POWER** button again to enter PHOTO mode. Press the **ENTER** button to capture a photo. The upper left corner of the screen will show that you are in PHOTO mode.

10. Recording Slow Motion Video

Once powered on, press the **POWER** button twice to enter SLOW MOTION VIDEO mode. Press the **ENTER** button to begin recording. The bottom of the screen will show a flashing red dot, denoting that video is recording. Press the **ENTER** button again to stop recording.

11. Playback on Camcorder

Once powered on, press the **POWER** button to cycle through the modes until you enter PLAYBACK mode. Press the **UP** and **DOWN** buttons to cycle through your media. Press **ENTER** to playback a video file. Press and hold the **ENTER** button for 3 seconds to delete a single file.

12. Connecting to a Computer

a. Connect your camcorder to a computer with the included USB cable. Power the camcorder on and the following prompts will display. Select "USB Mode" and press the **ENTER** button to continue.

- b. Go to Start -> My Computer -> and find the removable disk. Your camcorder acts like a card-reader when connected and can be easily accessed this way. Your media will be stored in a folder on this removable disk. Copy the folder to your computer.
- c. To use your camera as a webcam, select "PC CAMERA" after plugging in the USB.

13. Connecting to a Smartphone

STEP 1: Download the Smartphone App

To wirelessly operate the DV6000AF camcorder you will need to install the "XDV" app on your Android or iOS device. Scan the QR Code below to download the app.



STEP 2: Connecting Your Camera to Your Smartphone

The camcorder can be operated remotely by following the steps below:

1. Power the camera on and press the UP button once to activate the WiFi network. The WiFi network name and password will be displayed on the screen.
2. To disable the camera's WiFi network, press the UP button once again.
3. The status LED will blink YELLOW while searching for a WiFi connection.
4. Go in to your smartphone's WiFi network settings menu, turn all wireless settings ON and connect to the network named "COLEMAN" to join your camera to the network. The WiFi password is 12345678.
5. The status LED will show a steady YELLOW color when connected and the camcorder screen will turn off.
6. On your smartphone, exit the wireless menu and open the "XDV" app to launch remote operation of the camcorder.
7. The app will automatically connect with your camcorder.

STEP 3: App Location Settings - iOS

Once connected successfully, launch the XDV app. When launching the app for the first time, you will be prompted to allow the XDV app to use your location.

Select **"Allow While Using App"**. This will allow the app to communicate with your camera and will allow the app to work properly. The app will not connect to your camera if you select **"Don't Allow"**.

As part of the iOS operating system, your smartphone's Location Settings must be enabled in order to allow proper communication between your smartphone and your Coleman camera. Selecting will prevent your camera from connecting to the XDV app.

If you selected **"Don't Allow"**, then you can change this setting by going into your iOS Settings, selecting the **XDV** app, selecting the Location settings and select **"While Using App"**.

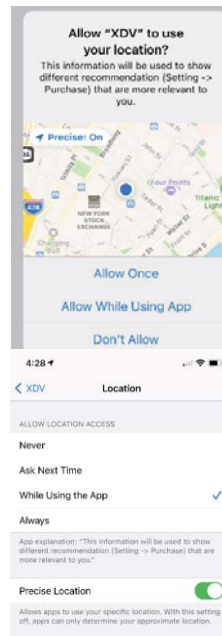

STEP 4: Operating the XDV App

Your camera can now integrate with your smartphone. Upon launching the app, it will initially default to the video recording function. Follow the steps below to select modes.

To change recording modes, tap the each mode icon on the at the center of the smartphone app.

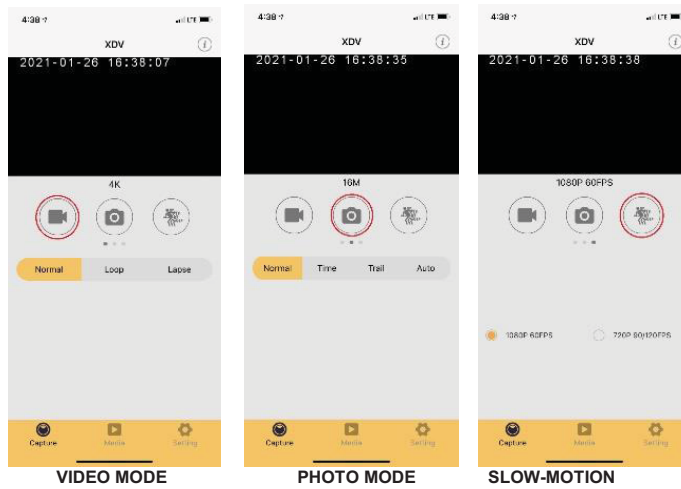

Recording Videos Remotely

1. To start recording a video, tap the Video icon on your smartphone screen. While a video is recording remotely, the status indicator LED will flash

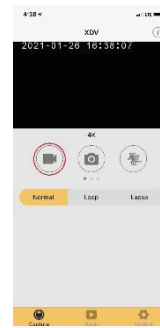

2. The Video Recording mode can be changed by selecting one of the options shown below. You can select Normal video recording, Loop Recording or Time-Lapse.



Shooting Photos Remotely

1. Switch to Photo mode by tapping the Camera icon on your smartphone screen. To capture a photo, tap the Camera icon again.

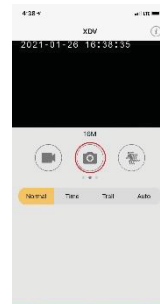

2. The Photo mode can be changed by selecting one of the options shown below. You can select Normal, Self-timer, Photo Burst or Time-Lapse.

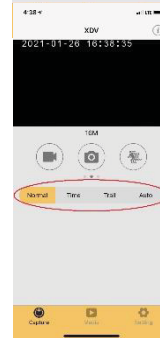

Viewing Media on the App

To view your photos and videos on the app, tap the Media icon in the bottom middle of your smartphone screen. Then select Device at the top of your screen to show the media on the camcorder. Tap the photo or video file you wish to view.



To download media to your smartphone or to delete media from the camera, tap the down arrow at the top right corner of the smartphone screen. Then select Download or Delete. Select the media you wish to download or delete

and tap the confirm button on the bottom right corner of your smartphone screen. If a photo or video is deleted on the app, it will also be removed from the memory card in your camera.

Note: Any media deleted is permanent and cannot be undone.

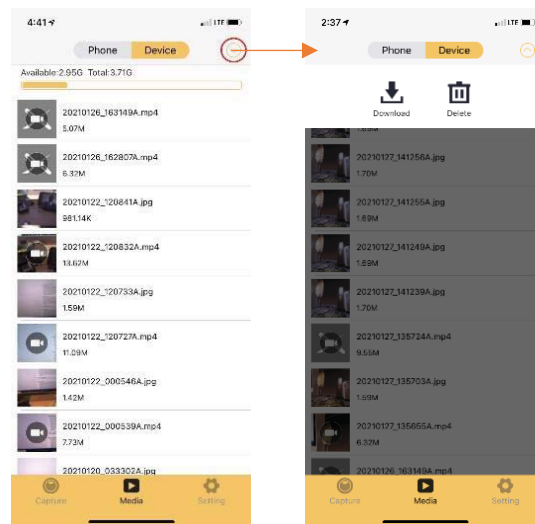

Changing Camera Settings on the App

Settings can also be accessed through the app. Tap the Settings icon in the bottom right-hand corner of the screen to launch the Settings menu. From here, all of the camcorder settings can be adjusted.



14. MENU & SETTINGS INTERFACE

Overview

Your camcorder comes preset with some user-adjustable settings to fine tune and customize how you would like your camcorder to function. The settings are already optimized and preset for the easiest experience.

Before you begin, ensure you are in SETTINGS mode. From the main screen, press the **MODE** button until a gear is shown on the screen. Press the **ENTER** button to access the settings mode.

14.1 Video Mode Settings

Overview

Your camcorder comes preset with some user-adjustable settings to fine tune and customize how you would like your videos to be captured. The settings are already optimized and preset for the easiest experience.

Before you begin, ensure you are in SETTINGS mode. From the main screen, press the **MODE** button until a gear is shown on the screen. Press the **ENTER** button to access the settings mode. Then, make sure that you are in Video Mode Settings, the yellow line at the top of the screen should be below the camcorder icon.

14.1.1 Video Resolution

Your camcorder has a number of preset resolution and frames per second rates. A higher resolution will produce a higher quality and larger video file.

1. In SETTINGS mode, select '*Video Resolution*' by using the **UP** or **DOWN** buttons. Press the **ENTER** button to enter the '*Video Resolution*' submenu.

2. Press the **UP** or **DOWN** buttons to navigate the submenu and select a setting. You can select from *4K 30FPS, 2.7K 30FPS, 1080P 60FPS, 1080P 30FPS, 720P 120FPS, 720P 60FPS, 720P 30FPS*.
3. Press the **OK** button to confirm your selected setting.
4. Press the **MODE** button to exit the settings menu without making a selection.

14.1.2 Audio Recording

This setting allows you to set the built-in microphone ON or OFF during a video recording. Once you select an option, your camcorder will either record audio within the video file, or record a video file without audio captured.

1. In **SETTINGS** mode, select '*Audio Recording*' by using the **UP** or **DOWN** buttons.
2. Press the **ENTER** button to turn Audio Recording On or Off, if the box has a check mark, then sound recording is On.

14.1.3 Time Lapse

This feature allows you to capture long sequences of events in a much shorter time period.

1. In **SETTINGS** mode, select '*Time Lapse*' by using the **UP** or **DOWN** buttons. Press the **ENTER** button to enter the '*Time Lapse*' submenu.
2. Press the **UP** or **DOWN** buttons to navigate the submenu and select a setting. You can select from *Close, Interval of 0.5 Seconds, 1 Second, 2 Seconds, 5 Seconds, 10 Seconds, 30 Seconds, 60 Seconds*.
3. Press the **OK** button to confirm your selected setting.
4. Press the **MODE** button to exit the settings menu without making a selection.

NOTE: By selecting '10s' the camcorder will capture a photo every 10 seconds and create a time-lapse video. To disable Time-Lapse recording, select 'Off' in this submenu.

14.1.4 Loop Recording

This setting allows you to set a maximum duration for each video clip recorded. Once you select an option, your camcorder will record video clips in this time interval only. Once your selected duration recording time is reached, the camcorder will end the recording and begin recording a new video file seamlessly.

1. In **SETTINGS** mode, select '*Loop Recording*' by using the **UP** or **DOWN** buttons. Press the **ENTER** button to enter the '*Loop Recording*' submenu.
2. Press the **UP** or **DOWN** buttons to navigate the submenu and select a setting. You can select from *Close, 2 Minutes, 3 Minutes, 5 Minutes*.
3. Press the **OK** button to confirm your selected setting.
4. Press the **MODE** button to exit the settings menu without making a selection.

3.1.5 Slow Motion

This function sets the frame rate of the recorded video to a much slower rate.

1. In **SETTINGS** mode, select '*Slow Motion*' by using the **UP** or **DOWN** buttons. Press the **ENTER** button to enter the '*Slow Motion*' submenu.
2. Press the **UP** or **DOWN** buttons to navigate the submenu and select a setting. You can select from *1080P 60FPS, 720P 120FPS*.
3. Press the **OK** button to confirm your selected setting.
4. Press the **MODE** button to exit the settings menu without making a selection.

14.2 Photo Mode Settings

Overview

Your camcorder comes preset with some user-adjustable settings to fine tune and customize how you would like your photos to be captured. The settings are already optimized and preset for the easiest experience.

Before you begin, ensure you are in SETTINGS mode. From the main screen, press the **MODE** button until a gear is shown on the screen. Press the **ENTER** button to access the settings mode. Then, make sure that you are in Photo Mode Settings, the yellow line at the top of the screen should be below the camera icon. Press the **MODE** button to move the yellow line to the camera icon.

14.2.1 Photo Resolution

Your camcorder has a number of preset photo resolution sizes. A higher resolution will produce a higher quality and larger file size photo.

1. In SETTINGS mode, select '*Photo Resolution*' by using the **UP** or **DOWN** buttons. Press the **ENTER** button to enter the '*Photo Resolution*' submenu.
2. Press the **UP** or **DOWN** buttons to navigate the submenu and select a setting. You can select from *16M*, *12M*, *8M*, *5M*, *2M*.
3. Press the **OK** button to confirm your selected setting.
4. Press the **MODE** button to exit the settings menu without making a selection.

14.2.2 Timed (Self Timer)

This function determines the time delay before a photograph is captured. This setting can be used by photographers to take photographs of themselves.

1. In SETTINGS mode, select '*Timed*' by using the **UP** or **DOWN** buttons. Press the **ENTER** button to enter the '*Timed*' submenu.
2. Press the **UP** or **DOWN** buttons to navigate the submenu and select a setting. You can select from *Close*, *3S*, *5S*, *10S*, *20S*.

3. Press the **OK** button to confirm your selected setting.
4. Press the **MODE** button to exit the settings menu without making a selection.

14.2.3 Auto (Auto Capture)

This feature allows you to capture a single photo at a set interval. It will continue to capture a single photo after each time interval until stopped.

1. In **SETTINGS** mode, select '*Auto*' by using the **UP** or **DOWN** buttons. Press the **ENTER** button to enter the '*Auto*' submenu.
2. Press the **UP** or **DOWN** buttons to navigate the submenu and select a setting. You can select from *Close*, *3S*, *10S*, *15S*, *20S*, *30S*.
3. Press the **OK** button to confirm your selected setting.
4. Press the **MODE** button to exit the settings menu without making a selection.

Note: By selecting 10 Seconds, the camcorder will capture a single photo every 10 seconds. Each photo will be saved as a separate file on the memory card. When this feature is active, press the OK button to start the countdown to the first photo capture. A countdown will show on the bottom of the screen. To stop taking additional pictures, press the OK button.

14.2.4 Drama Shot (Photo Burst)

This function allows to you capture consecutive photos with one click of the OK button.

1. In **SETTINGS** mode, select '*Drama Shot*' by using the **UP** or **DOWN** buttons. Press the **ENTER** button to enter the '*Drama Shot*' submenu.
2. Press the **UP** or **DOWN** buttons to navigate the submenu and select a setting. You can select from *Close*, *3P/S (photos per shot)*, *5P/S*, *10P/S*.
3. Press the **OK** button to confirm your selected setting.
4. Press the **MODE** button to exit the settings menu without making a selection.

14.3 General Settings

Overview

Your camcorder comes preset with some user-adjustable settings to fine tune and customize your camcorder. The settings are already optimized and preset for the easiest experience.

Before you begin, ensure you are in SETTINGS mode. From the main screen, press the **MODE** button until a gear is shown on the screen. Press the **ENTER** button to access the settings mode. Then, make sure that you are in General Settings, the yellow line at the top of the screen should be below the three horizontal lines icon. Press the **MODE** button to move the yellow line to the three horizontal lines.

14.3.1 Exposure

This function adjusts the frame brightness in your video.

1. In SETTINGS mode, select '*Exposure*' by using the **UP** or **DOWN** buttons. Press the **ENTER** button to enter the '*Exposure*' submenu.
2. Press the **UP** or **DOWN** buttons to navigate the submenu and select a setting. You can select from -3, -2, -1, 0, 1, 2, 3.
3. Press the **OK** button to confirm your selected setting.
4. Press the **MODE** button to exit the settings menu without making a selection.

14.3.2 White Balance

White Balance changes the color of light in your pictures, making it seem warmer or cooler depending on how the light you're shooting in affects the frame.

1. In SETTINGS mode, select '*White Balance*' by using the **UP** or **DOWN** buttons. Press the **ENTER** button to enter the '*White Balance*' submenu.
2. Press the **UP** or **DOWN** buttons to navigate the submenu and select a setting. You can select from *Auto*, *Sunny*, *Cloudy*, *Incandescent Light*, *Florescent Light*.
3. Press the **OK** button to confirm your selected setting.
4. Press the **MODE** button to exit the settings menu without making a selection.

14.3.3 WiFi

This option activates the WiFi connection, this allows you to control the camcorder from the app on your smartphone.

1. In SETTINGS mode, select '*Audio Recording*' by using the **UP** or **DOWN** buttons.
2. Press the **ENTER** button to turn WiFi On.
3. The WiFi name and password will appear on the screen.
4. Press the **UP** button to exit WiFi. Connecting to WiFi and app instructions can be found in the Operating Guide section, point 13.

14.3.4 Image Rotation

This option will flip the recorded videos and images 180 degrees.

1. In SETTINGS mode, select '*Image Rotation*' by using the **UP** or **DOWN** buttons.
2. Press the **ENTER** button to turn Image Rotation On or Off, if the box has a check mark, then image rotation is On.

14.3.5 Driving Mode

This feature will allow you to record video when the memory card is full, the new recording will overwrite the earliest recording. **The earliest recording will be deleted and cannot be undone.**

1. In SETTINGS mode, select '*Driving Mode*' by using the **UP** or **DOWN** buttons.
2. Press the **ENTER** button to turn Driving Mode On or Off, if the box has a check mark, then driving mode is On.

Note: when Driving Mode is activated, the camcorder will automatically start recording when powered on.

14.3.6 Light Source Frequency

This setting allows you to set the power frequency of your camcorder. This setting is dependent on the region that the camcorder is being used in.

1. In SETTINGS mode, select '*Light Source Frequency*' by using the **UP** or **DOWN**

- buttons. Press the **ENTER** button to enter the '*Light Source Frequency*' submenu.
2. Press the **UP** or **DOWN** buttons to navigate the submenu and select a setting. You can select from *Auto*, *50Hz*, *60Hz*. The default frequency for the United States is 60Hz.
 3. Press the **OK** button to confirm your selected setting.
 4. Press the **MODE** button to exit the settings menu without making a selection.

14.3.7 LED Light Indicator

This function allows you to turn the LED Indicator Light on and off.

1. In **SETTINGS** mode, select '*LED Light Indicator*' by using the **UP** or **DOWN** buttons.
2. Press the **ENTER** button to turn the LED Light Indicator On or Off, if the box has a check mark, then the LED Light Indicator is On.

14.3.8 Auto Screensaver

This setting allows you to set the length of time before the LCD Screen turns off automatically.

1. In **SETTINGS** mode, select '*Auto Screensaver*' by using the **UP** or **DOWN** buttons. Press the **ENTER** button to enter the '*Auto Screensaver*' submenu.
2. Press the **UP** or **DOWN** buttons to navigate the submenu and select a setting. You can select from *10S*, *20S*, *30S*, *Close*.
3. Press the **OK** button to confirm your selected setting
4. After the selected amount of time without input, the screen will power off. To wake the screen back on, press any button.
5. Press the **MODE** button to exit the settings menu without making a selection.

14.3.9 Auto Shutdown

This setting allows you to set the length of time before the camcorder powers off automatically.

1. In **SETTINGS** mode, select '*Auto Shutdown*' by using the **UP** or **DOWN** buttons. Press the **ENTER** button to enter the '*Auto Shutdown*' submenu.
2. Press the **UP** or **DOWN** buttons to navigate the submenu and select a setting. You can select from *1 minute, 2 minutes, 5 minutes, Close*.
3. Press the **OK** button to confirm your selected setting
4. After the selected amount of time with input, the camcorder will power off. Press and hold the **POWER** button for 3 seconds to power the camcorder back on.
5. Press the **MODE** button to exit the settings menu without making a selection.

14.3.10 Time Watermark

This setting allows you to imprint a date & time onto your recorded video files. Once a video file is recorded with the imprint, the imprint cannot be removed.

1. In **SETTINGS** mode, select '*Time Watermark*' by using the **UP** or **DOWN** buttons.
2. Press the **ENTER** button to turn the Time Watermark On or Off, if the box has a check mark, then the Time Watermark is On.

14.4 Setup Settings Menu

Overview

Your camcorder comes preset with some user-adjustable settings to fine tune and customize your camcorder. The settings are already optimized and preset for the easiest experience.

Before you begin, ensure you are in SETTINGS mode. From the main screen, press the **MODE** button until a gear is shown on the screen. Press the **ENTER** button to access the settings mode. Then, make sure that you are in Setup Settings, the yellow line at the top of the screen should be below the gear icon. Press the **MODE** button to move the yellow line to the gear icon.

14.4.1 Language

This setting allows you to set the language for your camcorder's menus.

1. In SETTINGS mode, select '*Language*' by using the **UP** or **DOWN** buttons. Press the **ENTER** button to enter the '*Language*' submenu.
2. Press the **UP** or **DOWN** buttons to navigate the submenu and select a setting.
3. Press the **OK** button to confirm your selected setting.
4. Press the **MODE** button to exit the settings menu without making a selection.

14.4.2 Date-Time

This setting allows you to set a date and time for display on videos and photos.

1. In SETTINGS mode, select '*Date-Time*' by using the **UP** or **DOWN** buttons. Press the **ENTER** button to enter the '*Date-Time*' submenu.
2. Press the **UP** or **DOWN** buttons to change the highlighted value.
3. When you are satisfied with the highlighted value, press the **ENTER** button to confirm that value and proceed to the next value.

Once all values are set, press the **MODE** button once to save your setting and exit.

14.4.3 Format Memory Card

This setting allows you to erase all video and photo files stored on your memory card.

1. In SETTINGS mode, select 'Format' by using the **UP** or **DOWN** buttons. Press the **ENTER** button to enter the 'Format' submenu.
2. Press the **UP** or **DOWN** buttons to navigate the submenu and select a setting.
3. Press the **OK** button to confirm your selected setting. You can select from *Confirmation, Cancel*.
4. Press the **MODE** button to exit the settings menu without making a selection.

NOTE: Use extreme caution when accessing this setting. There is no way to recover formatted media. Once you format your memory card, all recorded media will be DELETED permanently and cannot be recovered.

14.4.4 Factory Reset

This setting allows you to reset all menu settings to the factory default settings. This function will not delete any media stored on your memory card.

1. In SETTINGS mode, select 'Factory Reset' by using the **UP** or **DOWN** buttons. Press the **ENTER** button to enter the 'Factory Reset' submenu.
2. Press the **UP** or **DOWN** buttons to navigate the submenu and select a setting.
3. Press the **OK** button to confirm your selected setting. You can select from *Confirmation, Cancel*.
4. Press the **MODE** button to exit the settings menu without making a selection.

14.4.5 Firmware Version

This setting displays the current firmware version of your camcorder.

1. In SETTINGS mode, select 'Firmware Version' by using the **UP** or **DOWN** buttons.
2. The current firmware version will be shown on the screen.
3. Press the **MODE** button to exit the firmware version screen.

■ ACCESSORIES OVERVIEW



**CX14WP
Camera**



**Underwater
Case (100 ft.)**



**Hand Bar /
Pole Mount**



**Remote
Control**



**Velcro
Straps**



**3/8-16 Socket
Tip Adaptor**



User Manual



**Clip
Mount**



**Mount w/Extra
Adhesive Strips**



**Additional
Mounting Options**



**Lithium-Ion
Battery**



AC Adaptor



USB Cable



PC Software

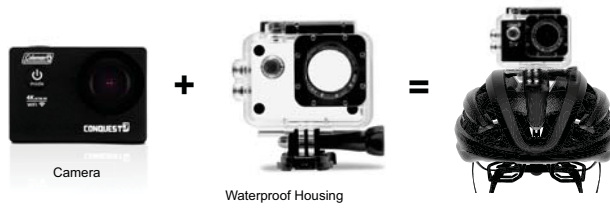

■ ACCESSORIES OVERVIEW



TECHNICAL SPECIFICATIONS

| | |
|---------------------------------|---|
| LCD Screen | 2.0" 230k HD LTPS |
| Front Lens | 170 Degrees Wide-Angle |
| Sensor Resolution | 8.0 Mega Pixels CMOS |
| Optional Languages | English, Spanish, French, German, Italian, Portugese, Dutch, Thai, Japanese, Polish, Simplified Chinese, Traditional Chinese, Korean, Russian |
| Video Resolution | 4k30fps / 2.7k30fps / 1080p60fps / 1080p30fps / 720p120fps / 720p60fps / 720p30fps |
| Video File Format | MP4 |
| Video Compression Format | H.264 |
| Photo Resolution | 16 Mega Pixels / 12 Mega Pixels / 8 Mega Pixels / 5 Mega Pixels / 2 Mega Pixels |
| Photo File Format | JPG |
| Storage Format/Capacity | MicroSDXC up to 64GB |
| Video Recording Modes | Normal / Timing / Automatic / Sports Trail |
| Photo Recording Modes | Normal / Loop / Slow Motion |
| Slow-Motion Video | 1080p60fps / 720p120fps |
| Light Frequency | Auto / 50Hz / 60Hz |
| Interfaces | USB 2.0 / Mini HDMI |
| Power Adaptor | 5V / 1A |
| Battery | S009, 3.7v 900mAh, 3.33Wh |
| Recording Time | 1080p and WiFi Connected - 90 minutes |
| Dimensions | 2.3 x 1.6 x 1.2 inches |
| Weight | 1.6 oz (2.1 oz with battery installed) |
| Operating Temperature | 14 Degrees~131 Degrees F |
| Storage Temperature | -4 Degrees~158 Degrees F |
| Waterproof Case Depth | 30 meters / 100 feet |
| Remote Control Distance | 10 meters / 33 feet |

Elite Brands Inc.,
40 Wall Street, 61st Floor
New York, NY 10005
www.elitebrands.com
www.colemanoptics.com

Coleman,  , are registered trademarks of
The Coleman Company, Inc. used under license
©2022 The Coleman Company, Inc.

*If you're having difficulties with your camera, or would like further assistance,
please call our toll-free technical support hotline at 800-441-1100. Please be
sure to have your camera handy when calling.*

