

# Access Control Terminal

## Quick Start Guide

UD19603B

### 1 Appearance

- Without Fingerprint Module

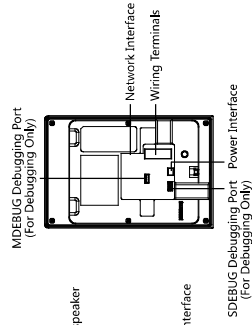
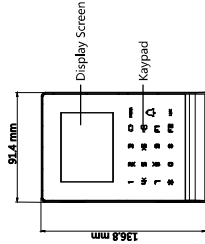

- Without Fingerprint Module

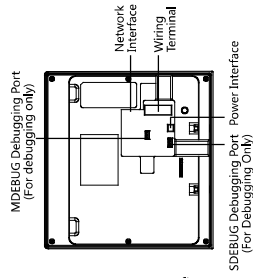
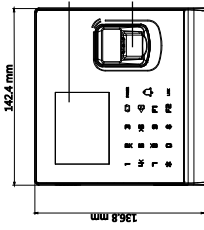

The pictures here are for reference only.

### 2 Keypad Introduction

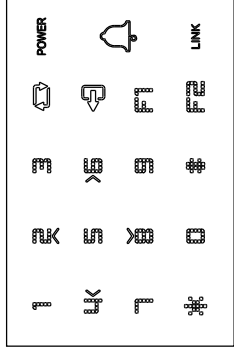

**Numeric Key**  
Enter numbers/lowercases, numbers/upercases and symbols in the textbox. When entering non-numeric characters, 0 can be a space key.  
Shift between numeric key and direction key on the non-initial page.

**F1**  
Deleting key. Press to delete contents in the textbox.

**F2**  
Reserved.

**\***  
Exit key.

**#**  
Hold the key to enter the login page. Press the key to confirm. After login, the key can be a confirmation or selection key.

**POWER**  
Power status indicator.  
Solid Blue: Normal Power;  
Off: Power Exception

**LINK**  
Doorbell ring.  
Solid Blue: Present normal card/Network or Wi-Fi is connected/Client software is armed.  
Flashing Blue: Card reader mode.  
Off: Network or Wi-Fi is disconnected/Client software is not armed.

### 3 Installation

- Without Fingerprint Module

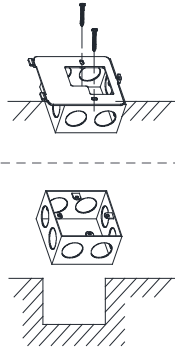

- With Fingerprint Module

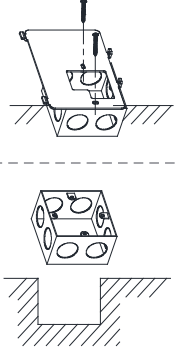

1. Install gang box.  
Make sure that the wall is strong enough to withstand three times the weight of the device.

2. Secure the device mounting plate on the gang box with two screws (supplied).

3. Align the terminal with mounting plate and buckle the terminal on the mounting plate and complete the installation.

4. Tighten the screw to fix the terminal on the mounting plate and complete the installation.

©2020 Hikvision, Hikvision Digital Technology Co., Ltd. All rights reserved.  
About this Manual  
This manual is for your reference only. The information contained in this manual is subject to change without notice. All software updates or other changes are subject to change without notice. Please visit <https://www.hikvision.com/> for the latest version of the Product.

Hikvision, Hikvision logo and other Hikvision's trademarks and logos are the properties of Hikvision in various countries and/or regions. All other trademarks and logos mentioned are the properties of their respective owners.  
TO THE MAXIMUM EXTENT PERMITTED BY APPLICABLE LAW, THIS MANUAL AND THE PRODUCT THEREIN ARE PROVIDED "AS IS" WITHOUT WARRANTY OF ANY KIND, EITHER EXPRESS OR IMPLIED, INCLUDING MERCHANTABILITY, FITNESS FOR A PARTICULAR PURPOSE, TITLE, OR OTHERWISE. HIKVISION SHALL NOT BE LIABLE FOR ANY SPECIAL, CONSEQUENTIAL, INCIDENTAL, PROFITS, BUSINESS INTERRUPTION, OR LOSS OF DATA, CORRUPTION OF SYSTEM, OR LOSS OF INFORMATION, OR OTHERWISE IN CONNECTION WITH THE USE OF THE PRODUCT, OR THE PRODUCTION OF THE PRODUCT, OR OTHERWISE IN CONNECTION WITH THE USE OF THE PRODUCT, OR THE PRODUCTION OF THE PRODUCT, OR OTHERWISE IN CONNECTION WITH THE USE OF THE PRODUCT, OR THE PRODUCTION OF THE PRODUCT, OR OTHERWISE IN CONNECTION WITH THE USE OF THE PRODUCT.  
HIKVISION SHALL NOT TAKE ANY RESPONSIBILITY FOR ABNORMAL OPERATION, DAMAGE TO DATA, OR OTHER INTEREST SECURITY RISKS. HOWEVER, HIKVISION WILL PROVIDE TECHNICAL SUPPORT OR REFERENCE WITH ALL APPLICABLE LAWS AND YOU ARE SOLELY RESPONSIBLE FOR ENSURING THAT YOUR USE CONFORMS TO THE APPLICABLE LAWS AND REGULATIONS OF YOUR COUNTRY AND/OR REGION, INCLUDING WITHOUT LIMITATION, RIGHTS AND OBLIGATIONS OF THIRD PARTIES, INCLUDING WITHOUT LIMITATION, RIGHTS AND OBLIGATIONS OF THIRD PARTIES, INCLUDING WITHOUT LIMITATION, RIGHTS AND OBLIGATIONS OF THIRD PARTIES, INCLUDING WITHOUT LIMITATION, RIGHTS AND OBLIGATIONS OF THIRD PARTIES, INCLUDING WITHOUT LIMITATION, RIGHTS AND OBLIGATIONS OF THIRD PARTIES.  
YOU SHALL NOT USE THIS PRODUCT FOR ANY PROHIBITED END-USES, INCLUDING THE PRODUCTION OF CHEMICAL, OR BIOLOGICAL WEAPONS, ANY ACTIVITIES IN THE CONTEXT OF HUMAN RIGHTS ABUSES, OR UNLAWFUL ACTIVITIES.  
LATER REVISIONS  
Any conflicts between this manual and the applicable law, the development of Hikvision devices incorporates privacy by design principles. For example, the encryption method for fingerprint devices, only fingerprint template will be saved, which is not sensitive information. As a data controller, you are advised to collect, store, process and transfer data in accordance with applicable laws and regulations, such as, implementing reasonable security controls, to our cloud services, conduct periodic reviews and assessments of the effectiveness of your security controls.

## 4 Wiring

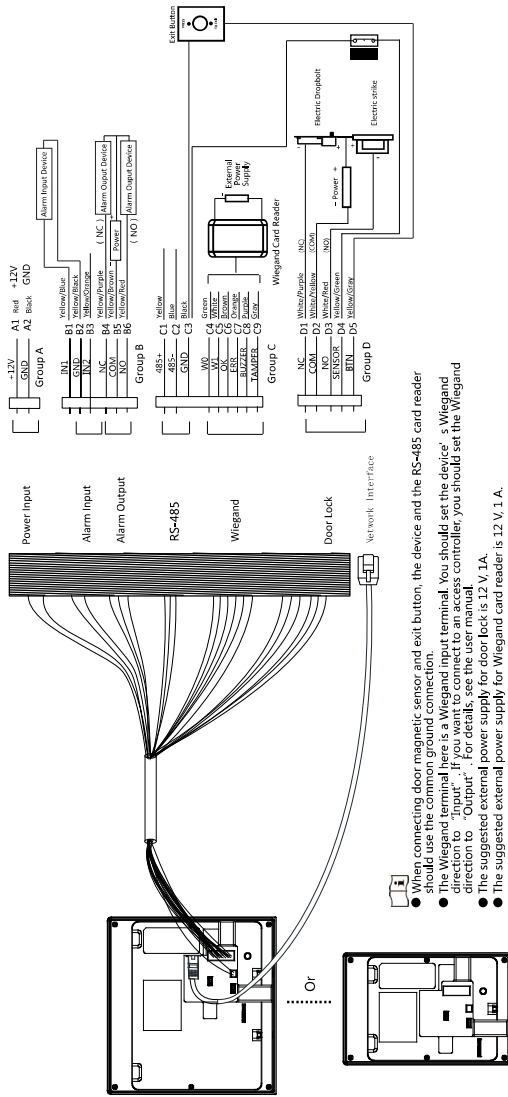

- When connecting door magnetic sensor and exit button, the device and the RS-485 card reader should use the common ground connection.
- The Wiegand terminal here is a Wiegand input terminal. You should set the device's Wiegand direction to "Input". If you want to connect to an access controller, you should set the Wiegand direction to "Output". For details, see the user manual.
- The suggested external power supply for door lock is 12 V, 1 A.
- Do not wire the device to the electric supply directly.

## 5 Activation

- You should activate the device before the first login. Activation via the device, SAPP tool and the client software are supported.
- The default values of the device are as follows:
- The default IP address: 192.0.0.64
  - The default port No.: 8000
  - The default user name: admin
- **Activation via Device**
1. Power on the device. If it is the first time to use the device. After powering on, you will enter the activation page.
  2. Create a password and press #.
  3. Confirm the password and press #.
- After the device activation, you will enter the administrator adding page. Add an administrator before of other operation.
- **Activation via SADP**
1. Get and install the SADP software.
  2. Run the SADP software and search the online devices.
  3. Find and select your device in online device list.
  4. Enter new password (admin password) and confirm the password.
  5. Click **Activate** to start activation.
- Status of the device becomes **Active** after successful activation.
- a. Select the device.
  - b. Change the device IP address to the same subnet as your computer by either modifying the IP address manually or checking Enable DHCP.
  - c. Input the admin password and click **Modify** to activate your IP address modification.

**!** The password strength of the device can be automatically checked. We highly recommend you change the password of your own choosing (using a minimum of 8 characters, including at least three kinds of following categories: upper case letters, lower case letters, numbers, and special characters) in order to increase the security of your product. And we recommend you reset your password regularly, especially in the high security system, resetting the password monthly or weekly can better protect your product. Proper configuration of all passwords and other security settings is the responsibility of the installer and/or end-user.



## Regulatory Information

**FCC Information**  
Please take attention that changes or modification not expressly approved by the party responsible for compliance could void the user's authority to operate the equipment.  
This equipment has been tested and found to comply with the limits for a Class B digital device, pursuant to part 15 of the FCC Rules. These limits are designed to provide reasonable protection against harmful interference in a residential installation. This equipment generates, uses and can radiate radio frequency energy and, if not installed and used in accordance with the instructions, may cause harmful interference to radio communications. However, and, if not installed and used in accordance with the instructions, may cause harmful interference to radio communications. However, if this equipment does cause harmful interference to radio or television reception, which can be determined by turning the equipment off and on, the user is encouraged to try to correct the interference by one or more of the following measures:

1. Reorient or relocate the receiving antenna.
  2. Increase the distance between the equipment and the receiver.
  3. Connect the equipment into an outlet on a circuit different from that to which the receiver is connected.
  4. Consult the dealer or an experienced radio/TV technician for help.
- FCC Equipment** should be installed and operated with a minimum distance 20cm between the radiator and your body.  
This device complies with part 15 of the FCC Rules. Operation is subject to the following two conditions:  
1. This device may not cause harmful interference.  
2. This device must accept any interference received, including interference that may cause undesired operation.

**CE** This product and - if applicable - the supplied accessories too are marked with "CE" and comply therefore with the EMC Directive 2014/53/EU, the RoHS Directive 2011/65/EU.  
2012/19/EU (WEEE directive): Products marked with this symbol cannot be disposed of as unsorted municipal waste in the European Union. For proper recycling, return this product to your local supplier upon the purchase of a new product or equipment, or dispose of it at designated collection points. For more information see: [www.recyclingthis.info](http://www.recyclingthis.info)  
2006/66/EC (battery directive): This product contains a battery that cannot be disposed of as unsorted municipal waste in the European Union. See the product documentation for specific battery information. The battery is marked with this symbol, which may include lettering to indicate cadmium (Cd), lead (Pb), or mercury (Hg). For more information, please return the battery to your supplier or to a designated collection point. For more information see: [www.recyclingthis.info](http://www.recyclingthis.info)

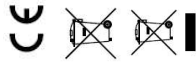

**Safety Instructions**  
These instructions are intended to ensure that user can use the product correctly to avoid danger or property loss. The precaution measure is divided into Warnings and Cautions:  
Warnings: Neglecting any of the warnings may cause serious injury or death.  
Cautions: Neglecting any of the cautions may cause injury or equipment damage.

- !** Warning
1. The device-outlet shall be installed near the equipment and all be easily accessible.
  2. All wiring shall be in accordance with local building codes.
  3. The equipment has been designed, when required, modified for connection to an IT power distribution system.
  4. This equipment is not suitable for use in locations where children are likely to be present.
  5. CAUTION: Risk of explosion if the battery is replaced by an incorrect type.
  6. Replacement of the battery with an incorrect type may defeat a safeguard (for example, in the case of some lithium battery types).
  7. Do not subject the battery to extremely low air pressure, which may result in an explosion or the leakage of flammable liquid or gas.
  8. Do not dispose of the battery into fire or a hot oven, or mechanically crush or cut the battery, which may result in an explosion, leakage of flammable liquid or gas, or an extremely high temperature surrounding environment, which may result in an explosion or the leakage of flammable liquid or gas.
  9. Do not subject the battery to extremely high air pressure, which may result in an explosion or the leakage of flammable liquid or gas.
- Precautions of used batteries according to the instructions.
1. All electronic operators should be strictly compliance with the electrical safety regulations, fire prevention regulations and other related regulations in your local region.
  2. Please use the power adapter, which is provided by normal company. The power consumption cannot be less than the required value.
  3. Do not connect several devices to one power adapter as adapter overload may cause over-heat or fire hazard.
  4. Please make sure that the power has been disconnected before you wire, install or dismantle the device.
  5. Do not touch the power supply or the power cord when the device is powered on.
  6. If smoke, odors or noise rise from the device, turn off the power at once and unplug the power cable, and then please contact the service center.
  7. If the product does not work properly, please contact your dealer or the nearest service center. Never attempt to disassemble the device yourself. (We shall not assume any responsibility for problems caused by unauthorised repair or maintenance).

- !** Caution
1. The positive terminal(s) of equipment which is used with, or generates direct current - identifies the negative terminal(s) of equipment which is used with, or generates direct current.
  2. The USB port of the equipment is used for connecting to a mouse, a keyboard, or a USB flash drive only.
  3. The serial port of the equipment is used for debugging only.
  4. Do not expose it to high electromagnetic radiation. Avoid the equipment installation on vibrations surface or places subject to shock (ignomance can cause equipment damage).
  5. Do not place the device in extremely hot (refer to the specification of the device for the detailed operating temperature), cold, dusty or damp locations, and do not expose it to high electromagnetic radiation.
  6. The equipment should be protected from direct sunlight, low ventilation or heat source such as heater or radiator is forbidden (ignomance can cause fire danger).
  7. The device, at the sun or other bright place, A blabiting or snear may occur otherwise (which is not a malfunction however), and affecting the endurance of sensor at the same time.
  8. Please use the provided glove when open up the device cover, avoid direct contact with the device cover, because the acidic sweat of the fingers may erode the surface coating of the device cover.
  9. Please do not use alkaline detergents.
  10. Please keep all wrappers after unpack them for future use. In case of any failure occurred, you need to return the device to the factory with the original wrapper.
  11. Transportation without the original wrapper may result in damage on the device and lead to additional costs.