

TALKPOD® Mulit Band Transceiver

Amateur Radio

USER MANUAL

Talkpod

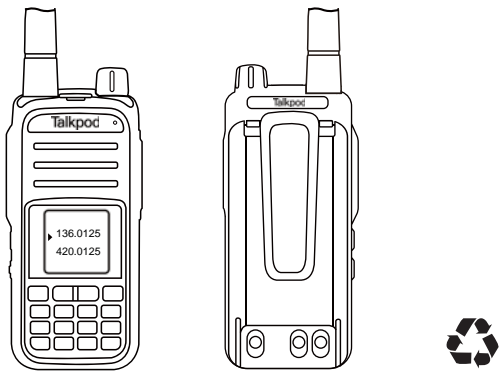

The Talkpod logo are trademarks or registered trademarks of Talkpod Technology Co., Ltd and are used under license. All other trademarks are the property of their respective owners.
©2023 Talkpod Technology Co., Ltd. All rights reserved.
Printed in China

Safety and General Information

FCC Statement:

Any Changes or modifications not expressly approved by the party responsible for compliance could void the user's authority to operate the equipment.

This device complies with part 15 of the FCC Rules. Operation is subject to the following two conditions:

(1) This device may not cause harmful interference, and

(2) This device must accept any interference received, including interference that may cause undesired operation.

Note: This equipment has been tested and found to comply with the limits for a Class B digital device, pursuant to part 15 of the FCC Rules. These limits are designed to provide reasonable protection against harmful interference in a residential installation. This equipment generates, uses and can radiate radio frequency energy and, if not installed and used in accordance with the instructions, may cause harmful interference to radio communications. However, there is no guarantee that interference will not occur in a particular installation.

If this equipment does cause harmful interference to radio or television reception, which can be determined by turning the equipment off and on, the user is encouraged to try to correct the interference by one or more of the following measures:

- Reorient or relocate the receiving antenna.
- Increase the separation between the equipment and receiver.
- Connect the equipment into an outlet on a circuit different from that to which the receiver is connected.

-Consult the dealer or an experienced radio/TV technician for help.

SAR tests are conducted using standard operating positions accepted by FCC with the device transmitting at its highest certified power level in all tested frequency bands, although the SAR is determined at the highest certified power level, the actual SAR level of the device while operating can be well below the maximum value. Before a new model is available for sale to the public, it must be tested and certified to the FCC that it does not exceed the exposure limit established by the FCC. Tests for each product are performed in positions and locations as required by the FCC.

For body worn operation, this device has been tested and meets the FCC RF exposure guidelines when used with and accessory designated for this product or when used with and accessory that contains no metal.

To maintain compliance with FCCRF exposure guidelines hold the transmitter and antenna at least 1 inch (2.5 centimeters) from your face and speak in a normal voice, with the antenna pointed up and away from the face.

Your wireless hand held portable transceiver contains a low power transmitter. This product

sends out radio frequency (RF) signals when the Push-to- Talk(PTT) button is pressed.

The device is authorized to operate at a duty factor not to exceed 50%.

Facilities

To avoid electromagnetic interference and/or compatibility conflicts, turn off your radio in any facility where posted notices instruct you to do so. Hospitals or health care facilities may be using equipment that is sensitive to external RF energy.

Aircraft

When instructed to do so, turn off your radio when onboard an aircraft. Any use of a radio must be in accordance with applicable regulations per airline crew instructions.

Medical Devices — Pacemakers, Defibrillators or other Implanted Medical Devices

Persons with pacemakers, Implantable cardioverter–defibrillators (ICDs) or other active implantable medical devices (AIMD) should:

- Consult with their physicians regarding the potential risk of interference from radio frequency transmitters, such as portable radios (poorly shielded medical devices may be more susceptible to interference).
- Turn the radio OFF immediately if there is any reason to suspect that interference is taking place.
- Do not carry the radio in a chest pocket or near the implantation site, and carry or use the radio on the opposite side of their body from the implantable device to minimize the potential for interference.

Hearing Aids

Some digital wireless radios may interfere with some hearing aids. In the event of such interference, you may want to consult your hearing aid manufacturer to discuss alternatives.

Other Medical Devices

If you use any other personal medical device, consult the manufacturer of your device to determine if it is adequately shielded from RF energy. Your physician may be able to assist you in obtaining this information. Always check the laws and regulations on the use of radios in the areas where you drive.

Use of Communication Devices While Driving

- Give full attention to driving and to the road.
- Use hands-free operation, if available.
- Pull off the road and park before making or answering a call, if driving conditions or regulations so require.

For Vehicle With Air Bags

Refer to the vehicle manufacturer's manual prior to installation of electronic equipment to avoid interference with air bag wiring.

Do not place a portable radio in the area over an air bag or in the air bag deployment area. Air bags inflate with great force. If a portable radio is placed in the air bag deployment area and the air bag inflates, the radio may be propelled with great force and cause serious injury to occupants of the vehicle.

Potentially Explosive Atmosphere

Turn off your radio prior to entering any area with a potentially explosive atmosphere. Only radio types that are especially qualified should be used in such areas as "Intrinsically Safe". Do not remove, install or charge batteries in such areas. Sparks in a potentially explosive atmosphere can cause an explosion or fire resulting in bodily injury or even death.

Note: he areas with potentially explosive atmosphere referred to above include fueling areas such as below decks on boats, fuel or chemical transfer or storage facilities, areas where the air contains chemicals or particles (such as grain, dust or metal powders) and any other area where you would normally be advised to turn off your vehicle engine. Areas with potentially explosive atmospheres are often — but not always posted.

Blasting Caps and Areas

To avoid possible interference with blasting operations, turn off your radio when you are near electrical blasting caps, in a blasting area, or in areas posted "Turn off two-way radios". Obey all signs and instructions.

Operational Cautions

Antennas

Do not use any portable radio that has a damaged antenna. If a damaged antenna comes into contact with your skin, a minor burn can result.

Batteries

All batteries can cause property damage and/or bodily injury such as burns if a conductive material touches exposed terminals. The conductive material may complete an electrical circuit (short circuit) and become hot.

- Exercise care when removing AAA batteries. Do not use sharp or conductive tools to remove these batteries.
- Exercise care in handling any charged battery, particularly when placing it inside a pocket, purse or other container with metal objects.

Do not discard your battery in a fire

- Do not replace the battery in any area labeled "Hazardous Atmosphere". Any sparks created in a potentially explosive atmosphere can cause explosion or fire.
- Do not disassemble, crush, puncture, shred or otherwise attempt to change the form of your battery.
- Do not dry a wet battery or damp battery with an appliance or heat source, such as a hair dryer or microwave oven.
- If the radio battery contact area has been submerged in water, dry and clean the battery contacts before attaching the battery to the radio.

Licensing Information

USA		
If you wish to have the document faxed or mailed, or if you have questions, please use the following contact information:		
For a fax:Contact the Fax-On-Demand system	For mail service: Call the FCC Forms Hotline	If you have questions about the FCC License: Call the FCC
1-202-418-0177	1-800-418-FORM(3676)	1-888-CALL-FCC (225-5322)

Canada

Use of Talkpod radio in Canada is subject to the rules & regulations of Industry Canada (IC). IC requires no license when operated in Canada.

Changes or modifications not expressly approved by TALKPOD Solutions may void the user authority granted by the IC/FCC to operate this radio and should not be made. To comply with IC/FCC requirements, transmitter adjustments should be made only by or under the supervision of a person certified as technically qualified to perform transmitter maintenance and repairs in the private land mobile and fixed services as certified by an organization representative of the user of those services. Replacement of any transmitter component (crystal, semiconductor, etc) not authorized by the IC/FCC equipment authorization for this radio could violate IC/FCC rules.

Note: Use of this radio outside the country where it was intended to be distributed is subject to government regulations and may be prohibited.

Names of each section

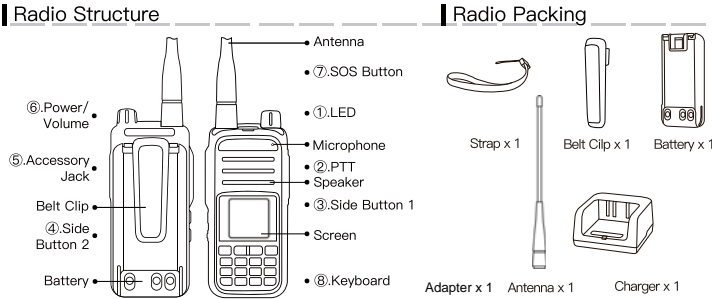

Button Details

NO	Icon	Name	Description
1		LED Light	Green: RX Red: TX
2		PTT	Press to Talk
3		Side Button 1	Programmable Side button
4		Side Button 2	Programmable Side button(Better use Long press S2 for SOS)
5		Accessory Jack	For Headsets, Program Cable
6		Power Knob	Turn clockwise to power on and increase the volume Turn counterclockwise to power off the power and decrease the volume
7		SOS button on the top	One click on SOS alarm
8		Keyboard	Multifunction keyboard

Attach Battery

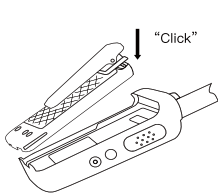

Note

Turn off the radio before removing the battery.

If not assembled with battery specified by Company, the radio will give alarm tone to remind you when powering on. Afterwards,it will operate normally.

Assemble Antenna

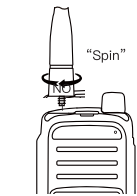

Note

Turn off the radio before removing the battery.

If not assembled with battery specified by Company,the radio will give alarm tone to remind you when powering on. Afterwards,it will operate normally.

LED Indicator

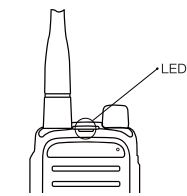

LED Status	Product Status
Steady Green	Receiving
Steady Red	Transmitting

Assembling the Belt Clip Building the Accessories Button Details

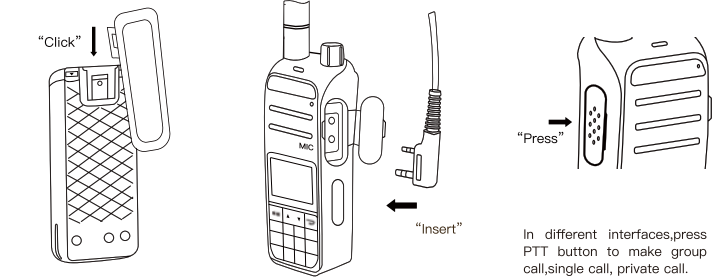

Powering On/Off

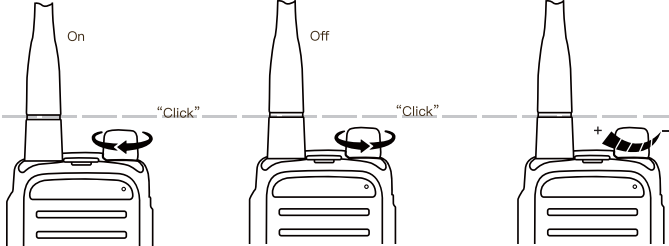

Charge the radio

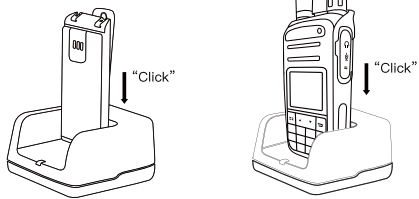

Charging Status		
Steady Red		Rapid Charging
Steady Green		Fully Charged

PTT Button

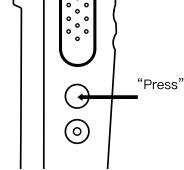

According to different models and user habits, side buttons can be set to group/member/friend selection,SOS or to broadcast current groups.

Multi-Band Portable Transceiver menu description

NO	Function function	Secondary menu	Setting instructions
1	SQL	0, ..., 9	The lower the squelch level, the easier it is to interfere,the higher the level, the worse the sensitivity, and the setting should be moderate
2	STEP	2.50K 5.00K 6.25K 10.00K 12.50K 20.00K 25.00K 30.00K 50.00K	In the frequency mode, press the up and down keysto change the step value of the frequency
3	MEMCH	000,...,256	Indicate the channel number to be stored while store channel. If 'CH' in front of number means this channel already has a channel parameter.
4	DELCH	000,...,256	Delete the channel parameters of the specified channel. If there is no CH parameters and the operation is invalid.
5	R-CTCSS	OFF 67.0HZ,...,254.1HZ	None CTCSS Standard CTCSS. Input standard or nonstandard CTCSS via keypad.
6	R-DCS	OFF D023N,...,D754I	None DCS Standard DCS
7	T-CTCSS	OFF 67.0HZ,...,254.1HZ	None CTCSS Standard CTCSS. Input standard or nonstandard CTCSS via keypad.
8	T-DCS	OFF 67.0HZ,...,254.1HZ	None DCS Standard DCS
9	VOICEPRI	OFF Encryption 1 Encryption 2 Encryption 3 Encryption 4	

NO	Function function	Secondary menu	Setting instructions
10	CH-NAME	COMMON NAME LIST	
11	TXP	HIGH	High Power Transmitting
12	SAVE	OFF 1 2 3	Off Battery Saving Off Battery Saving Normal Saving Super Saving
13	ROGER	OFF NO	Turn Off Turn On
14	TOT	30,60,...,480s	The number is from 30 to 480s, and the maximum time for PTT transmission is indicated in 30s steps.
15	VOX	OFF 1,2,...9	Turn off VOX function, transmitting without PTT pressing. Activate the sound pressure intensity of voice control, level 1 is the most sensitive
16	W/N	WIDE NARR	Wide mode Narrow mode
17	VOICE	OFF NO	Turn off voice prompt Turn on voice prompt
18	BEEP	OFF NO	Turn off operation prompt Turn on operation prompt
19	LANGUAGE	ENGLISH CHINESE	English Chinese
20	BCL	OFF NO	OFF NO
21	ABR	NO 5s,10s,...,3min	Background light is always on. Time between the background light ON to automatically OFF.
22	OFFSET	00.000,...,99.995	In frequency mode, the difference between the transmitting and receiving frequencies.
23	SC-REV	TO CO SE	Time scanning, the walkie-talkie pauses scanning when it detects a signal, and after staying stopped for about 5 seconds, the walkie-talkie will continue scanning even if the signal is still there. Carrier scanning, the two-way radio pauses scanning when a channel is detected and keeps it on the same frequency until the signal disappears. There is a 2-second delay between the disappearance of the signal and the resumption of scanning to allow time for the response to begin transmission. Search scanning, the walkie-talkie exits scanning when it detects a signal and stays at this frequency.
24	PF2		
25	PF2 LONG PRESS		
26	PF3		
27	SFT-D	OFF + -	In frequency mode, turn off the difference between the transmitting and receiving frequencies. In frequency mode, the TX frequency=RX frequency plus frequency difference. In frequency mode, the TX frequency=RX frequency minus frequency difference
28	SCAN CTCSS		
29	SCAN DCS		
30	CDCSS SAVE MODE	ALL RX TX LOGO	ALL Receiving Transmitting Photo
31	POWER ON MSG	VOL TAGE	Battery voltage
32	ANI NAME	NUM1...NUM60	No.1---No.50 radio. The radio name of 51-60 can be set
33	S-CODE	1,2,3,...,15	
34	DTMF CODE	OFF BOT EOT BOTH	Turn off Press PTT to transmitting DTMF Release PTT to transmitting DTMF BOTH
35	AUTOLK	OFF 5s,10s,...,3min	Turn off auto keypad lock Turn on the keypad timing automatic lock function
36	DTMFST	OFF DT-ST ANI-ST DT+ANI	No DTMF prompt when press key to transmitting DTMF DTMF prompt when press key to transmitting DTMF DTMF prompt when automatically transmitting DTM DTMF prompt when automatically transmitting DTMF and press key to transmitting DTMF
37	SCAN ADD		
38	STONE	1000,1450,1750,2100Hz	
39	PTT-LT	0,100,...,1000	Delay time before automatic DTMF transmitting
40	MENU EXIT TIME	5,10,...,60s	Control the time of menu automatically exit
41	VOX DELAY	0.5SEC,...,2.0SEC	Due to the delay of the repeater, noise appears when receive instant signal.
42	RP_STE	OFF 1,2,3,4,5,...,10s	OFF: Adjust to eliminate the tail. If want to ensure if the repeater is work or not, set OFF.
43	RPT-RL	OFF 1,2,3,4,5,...,10s	OFF: Adjust the length of time the tail sound appears, if not needed, set it to off.
44	ANI FUNCTION	OFF NO	Turn off Turn on
45	MDF-A	FREQ CH NAME	A band displays as frequency in channel mode A band displays as channel in channel mode A band displays as channel name in channel mode
46	MDF-B	FREQ CH NAME	B band displays as frequency in channel mode B band displays as channel in channel mode B band displays as channel name in channel mode
47	TX-A/B	OFF A B	In dual standby mode, transmitting current frequency band In dual standby mode, press PTT to transmitting A band for cross-band TX/RX
48	TX-A/B	OFF NO	Turn off Turn on
49	STE	OFF NO	After releasing the PTT, the radio will send a turn-off code to suppress the instant noise of the receiver. After releasing the PTT, the radio will send a turn-off code to suppress the instant noise of the receiver.
50	AL-MOD	SITE SOUND CODE	On-site Emergency Send emergency voice Send emergency code

NO	Function function	Secondary menu	Setting instructions
51	DISPLAY	OFF NO	Turn off Turn on
52	RESET	VFO ALL	Menu back to factory setting Menu and channel back to factory setting
53			

Technical Information

Setting instructions

Operation Modes	Operation Frequency Range (MHz)
VHF Receiving	108-136 136-174 220-260
UHF Receiving	350-390 400-520
Scanning	108-136 136-174 220-260 350-390 400-520
VHF Transmit	144-148
UHF Transmit	420-450

Warning:

MODIFICATION OF THIS DEVICE TO RECEIVE CELLULAR RADIOTELEPHONE SERVICE SIGNALS IS PROHIBITED UNDER FCC RULES AND FEDERAL LAW.

Troubleshooting

Phenomena	Receive Frequency	Transmit Frequency
Power-on Failure	The battery may be improperly installed.	Remove the battery and reassemble it.
	The battery power may be used up	Remove or replace the battery.
	The battery is poorly connected due to dirtied or damaged battery contacts.	Clean the battery contacts.If the problem cannot be solved, contact your dealer or authorized service center for inspection and repair.
During receiving,the voice is weak,discontinuous or totally inactive.	Low battery voltage.	Recharge or replace the battery.
	Low volume level.	Increase the volume by rotating the Volume Control knob.
	The antenna may be loosened or improperly installed.	Reassemble the antenna after turning off the radio
Unable to communicate with other members.	The speaker may be blocked or damaged.	(Clean the surface of the speaker.If the problem cannot be solved,contact your dealer or authorized service center for inspection and repair.
	The frequency or signaling may be inconsistent with that of other members.	Set your TX/RX frequency and signaling to the same as that of other members.
	The channel type(digital/analog)may be set inconsistently.	Make sure all members are on the same digital/analog channel.
Irrelevant communication or noise is heard on the channel.	You may be interrupted by radios using the same frequency.	Change the frequency, or adjust the squelch level.
	You may be interrupted by radio using the same frequency.	Change the frequency, or adjust the squelch level.
	The radio may be set with no signaling.	Set signaling for all member radios to avoid inference at the same frequency.And change the signaling settings for all portable radios at the same time.
The noise is too loud.	You may be too far away from oter members	Move towards other members.
	You may locate in an unfavorable position.For example, your communication may be blocked by high buildings or frustated in the underground areas.	Move to an open and flat area, and restart the radio to try again.
	You may suffer from external disturbance (such as electromagnetic interference).	Stay away from equipment that may cause interference.

Contact Information

How to Obtain Warranty Service or Other Information?

To obtain customer service or information: www.Talkpodonline.com/page/support
+86-595-86753355 E-mail us at support@talkpod.com

For Accessories:

Please call the telephone number designated above for the Product with which they are used. You will receive instructions on how to ship the Products or Accessories at your expense, to Talkpod or a TALKPOD Authorized Repair Center. To obtain service, you must include: (a) a copy of your receipt, bill of sale or other comparable proof of purchase; (b) a written description of the problem; (c) the name of your service provider, if applicable; (d) the name and location of the installation facility (if applicable) and, most importantly; (e) your address and telephone number.

For more information, please visit us at:



www.talkpodonline.com



https://www.facebook.com/talkpod



http://youtube.com/@talkpodtech