

成品尺寸:80\*60MM

## 使用说明书

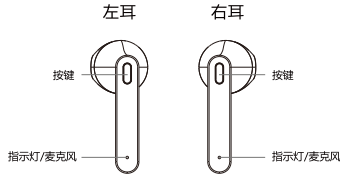

### 参数

型号	K010
蓝牙版本	BT5.0
信号距离	15M
充电盒电池	400mAh
耳机电池	40mAh
播放时间	3-4h
待机时间	>200h
充电时间	1-2h
充电盒电压	DC 5V
支持的手机系统	Support IOS, Android

### 按键定义

开机	长按开机键4秒	蓝灯快闪烁3下
关机	长按关机键4秒	红灯亮
接听电话	短按按键一次	
挂断电话	短按按键一次	
拒接来电	双击按键二次	
中断拨出电话	短按按键一次	
播放/暂停	短按按键一次	
音量 +	右耳机双击按键二次	
音量 -	左耳机双击按键二次	
上一曲	左耳机按键三次	
下一曲	右耳机按键三次	
中英文切换	进入配对模式4连击进行切换	
语音	长按按键2.5秒	

### 充电模式

充电座充电时	关机中，蓝灯闪烁。
耳机充电时	关机中，长亮红灯。
耳机低电量报警	当电池电压低到10%后提示低电量，红灯5秒闪两次。

### 耳机配对

进入双耳配对模式	双耳同时长按键4秒开机后，直接进入配对模式，配对时间为10秒，如果5分钟内还未配对手机就转入关机状态。	红灯闪烁
进入单耳配对模式	1.单耳长按4秒开机后再继续长按3秒进入单耳配对模式。2.单耳长按键5秒开机后，15秒后自动进入单耳配对模式，如果5分钟内还未配对手机就转入关机状态。	红灯闪烁
清除双耳配对	进入配对模式快速单击5次直到亮红灯,并听到关机提示音。	红灯亮

### 备注：

1. 蓝牙搜索名称K010
2. 播放音乐时放进充电盒并盖上充电盒时，此时蓝牙与手机会断开，蓝牙关机，再次打开充电盒盖取出耳机自动开机回连。
3. 开机自动连接手机，如不能自动回连，短按按键一下可以回连。
4. 如果耳机无法连接手机,请清除配对模式,重新开机再配对连接。
5. 请常配5V充电器。



CE RoHS

## User Quick Guide

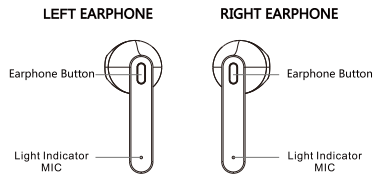

### PARAMETER

Model number	K010
Bluetooth version	BT5.0
Transmission distance	15M
Charge box capacity	400mAh
Earphone battery	40mAh
Talking time	3-4h
Standby time	>200h
Charge time	1-2h
Input	DC 5V
Support phone system	Support IOS, Android

### KEY DEFINITION

Power on	Press the POWER key for 4 seconds. The blue light flashes quickly for 3 times.
Power off	Press the POWER key for 4 seconds. The red light flashing.
Answer the call	Press the POWER key once.
Hang up the call of other sides	Press the POWER key once.
Refuse the incoming calls	Double clicks on POWER key.
Interrupt dial-out calls.	Press the POWER key once.
Play/pause	Press the POWER key once.
Volume +	Double clicks on POWER key at R side.
Volume -	Double clicks on POWER key at L side.
Previous song	Three clicks on POWER key at L side.
Next song	Three clicks on POWER key at R side.
Chinese-English switching	Enter pairing 4 and make switching by continuous clicks.
SIRI	Press the POWER key for 2.5 seconds.

### CHARGING MODE

Charge with the charging dock. The blue light flashing.
The earphone is charged and powers off. The red light is normally on.
Low battery alarm, Prompt low battery when the battery level is lower than 10%.

### EARPHONE PAIRING MODE

Enter double earphones pairing mode.	Press the POWER for 4 seconds by both earphones at the same time to power on. It enters pairing mode directly. The pairing time is 10 seconds. If pairing is not made within 5 minutes, the Earbuds will switch to power-off state.	The red and blue light flashing.
Enter single earphone pairing mode.	1. Press the single earphone for 4 seconds to power on. Continue to hold down SS to enter single earphone pairing mode. 2. Press the POWER for 5 seconds by the single earphone to power on. Then it enters single earphone pairing mode 15 seconds later automatically. If pairing is not made within 5 minutes, the Earbuds will switch to power-off state.	The red and blue light flashing.
Clear double earphones pairing.	Enter pairing mode and make single click for 5 times quickly until the red light is on. And you hear the prompt sound for power off.	The red light flashing.

### REMARK

1. Bluetooth pairing name K010
2. When the music is played, place it into the charging box and put the charging box cover. At the moment, the Bluetooth disconnects from the mobile phone. The Bluetooth switches off. When the cover of charging box is opened again, it powers on automatically for connection.
3. Connect the mobile phone automatically after power on. If connection cannot be made automatically, press POWER key to connect.
4. Please reset pairing mode if the earbuds can't connect to your mobile phone, turn it on and connect again.
5. Please always have a 5V charger.



CE RoHS

NOTE: This equipment has been tested and found to comply with the limits for a Class B digital device, pursuant to part 15 of the FCC Rules. These limits are designed to provide reasonable protection against harmful interference in a residential installation. This equipment generates uses and can radiate radio frequency energy and, if not installed and used in accordance with the instructions, may cause harmful interference to radio communications. However, there is no guarantee that interference will not occur in a particular installation. If this equipment does cause harmful interference to radio or television reception, which can be determined by turning the equipment off and on, the user is encouraged to try to correct the interference by one or more of the following measures:

- Reorient or relocate the receiving antenna.
- Increase the separation between the equipment and receiver.
- Connect the equipment into an outlet on a circuit different from that to which the receiver is connected.
- Consult the dealer or an experienced radio/TV technician for help

Changes or modifications not expressly approved by the party responsible for compliance could void the user's authority to operate the equipment.

This device complies with Part 15 of the FCC Rules. Operation is subject to the following two conditions:

- (1) this device may not cause harmful interference, and
- (2) this device must accept any interference received, including interference that may cause undesired operation.