

User's manual



POLMP01B  
POLMP01W  
POLMP01BL  
POLMP01R



Power on/off

Press the power button for about 3 to 5 seconds.  
Press the power button for about 2 seconds.  
**Note**  
When you turn on the power, the operating status LED indicator blinks for about 5 seconds. You can print it out when the blinking ends, and the LED is turned on white.

**Charging the battery**  
This device has a built-in battery. Make sure that the battery is charged fully before use. Average charging time: About 1 hour and 30 minutes



Charging status indicator	Description of status
	Charging in progress
	Charging completed

**Notice**  
• Use the standard charger provided by this device.  
• The use of a non-standard charger can cause malfunction and exception from the subjects of warranty service.  
• There may be the risk of electric shock during the process of charging, so please use with care.  
• Do not give abnormal impacts.

4. Begin searching for surrounding Pomiini when selecting "Search for devices" after selecting "Yes" on the Bluetooth permission request window. (Permission request window doesn't come out when Bluetooth function is turned on.)

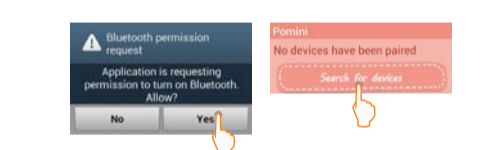

5. Select "Pomiini(XX-XX)" from the Other Available Device list and select "OK" when "Bluetooth pairing request" pops up. (MAC Address can be checked in the label inside the device.)

\* "Pairing request" window may not come out depending on the Phone type.

6. Upon completion of Pairing, it is added to the Paired Device list. (The process of NO. 4-6 is carried out one for the first time, but this process can be omitted in a Pairing state.)

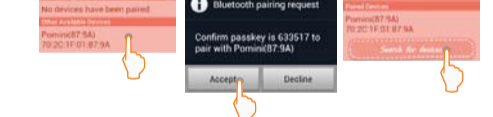

Print Mode

**Image Full**  
As shown in the left side of the picture, the photo matches the printing paper so that the full image can appear in Image Full.

As the ratio of width to height (2.3) is greater, the white space is wider.

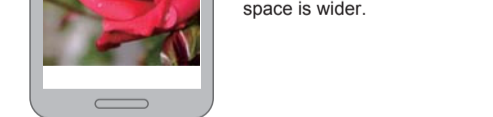

**Paper Full**  
As shown in the left side of the picture, the photo matches the printing paper so that the image can be resized in Paper Full.

As the ratio of width to height (2.3) is greater, the original image is further severed.

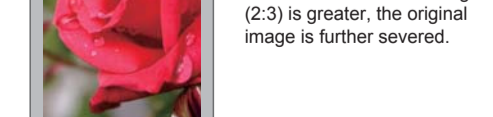

Safety Precautions

This equipment has been tested and found to comply with the limits for a Class B digital device, pursuant to Part 15 of the FCC Rules. These limits are designed to provide reasonable protection against harmful interference in a residential installation.  
This equipment generates, uses and can radiate radio frequency energy and, if not installed and used in accordance with the instructions, may cause harmful interference to radio communications. However, there is no guarantee that interference will not occur in a particular installation.

If this equipment does cause harmful interference to radio or television reception which can be determined by turning the equipment off and on, the user is encouraged to try to correct the interference by one or more of the following measures.

- Reorient or relocate the receiving antenna.
- Increase the separation between the equipment and receiver.
- Connect the equipment into an outlet on a circuit different from that to which the receiver is connected.
- Consult the dealer or an experienced radio, TV technical for help.

Finally, any changes or modifications to the equipment by the user not expressly approved by the grantee or manufacturer could void the user's authority to operate such equipment.  
This device complies with Part 15 of the FCC Rules. Operation is subject to the following two conditions: (1) this device may not cause harmful interference, and (2) this device must accept any interference received, including interference that may cause undesired operation of this device.

Application installation

Installation in Store

Android:  
Search for "Pomiini" in Play Store for installation.

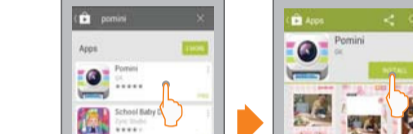

iOS:  
Search for "Pomiini" in AppStore for installation.

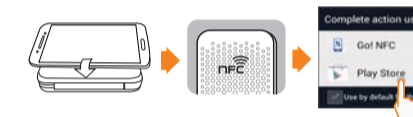

(\* Android phone that supports NFC function is connected to PlayStore Link when it comes in contact with the top cover.)

7. Tap the Print button at the bottom on the Print Preview screen.

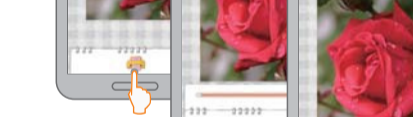
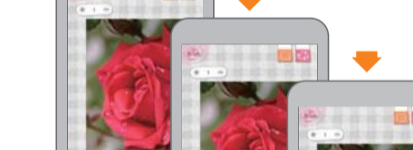

Description of LED Status Indicators

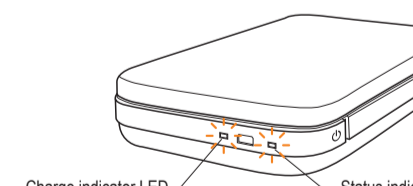

Charging status indicator	Operating status indicator	Current status	Details
		Off	Turn on the power to print.
		Standby On	Wait for print commands. Turn off automatically after the set time.
		Charging in progress	The battery is being charged.
		Charging is completed	The battery is fully charged.
		Operating Flashing	Power off, image transmission, image processing, printing, cooling standby
		Error Flashing	No paper, paper jam, cancel operation, cover open, low battery, image not supported, update failure, etc.

CAUTION

Any changes or modifications in construction of this device which are not expressly approved by the party responsible for compliance could void the user's authority to operate the equipment.

**CE WARNING**  
• Changes and modifications not expressly approved by the party responsible for compliance could void the user's authority to operate the equipment.  
• It is desirable that it be installed and operated with at least 20cm or more between the radiator and person's body (excluding extremities: hand, wrists, feet, and ankles).

**EN Test Regulations**  
ETSI EN 300 328 V1.1.1  
ETSI EN 301 489-1 V1.1.2  
ETSI EN 301 489-17 V2.1  
EN 60950-1:2006/A1:2009/A1:2010/A12:2011/A2:2013

BATTERY WARNINGS

- 1 Avoid contact with leaking or a damaged battery.
  - 2 Do not short battery terminals.
  - 3 Adult supervision is recommended when product is used by young children.
  - 4 Avoid areas of excessive heat or moisture.
  - 5 Do not disassemble the battery.
- This product contains electrical or electronic materials. The presence of these materials may, if not disposed of properly, have potential adverse effects on the environment and human health. Presence of this label on the product means it should not be disposed of as unsorted waste and must be collected separately. As a consumer, you are responsible for ensuring that this product is disposed of properly. Risk of explosion if Battery is replaced by an incorrect type. Dispose of used Batteries according to the instructions.

iOS

Search for "Pomiini" in AppStore for installation.



iOS (App Store)

Installation with QR Code

Scan the QR Code in the product box and install the App.



iOS Android

iOS

1. Turn on the power of the device.
2. For Bluetooth connection, change the mode to "Turn on [Bluetooth]" from [Settings] of the device.
3. Connect "Pomiini(XX-XX)" in the searched list. (MAC Address can be checked in the label inside the device.)

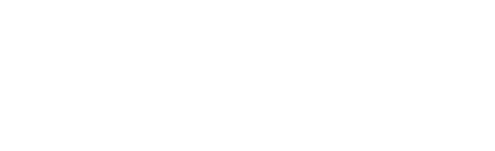

Product specifications

Type	Size
Paper size	50 x 76 (mm)
Type of supported image file/size	PNG(2550x3000)/JPEG(baseline) Within a maximum of 10M Byte Progressive JPEG not supported ZINK Paper (for Pomiini only)
Paper storage conditions	Temperature: 20 ~ 25°C Humidity: 40 ~ 55% RH
Product operating conditions	Temperature: 5 ~ 40°C Humidity: Less than 70% (35°C)
Optimal print conditions	Temperature: 15 ~ 32°C Humidity: Less than 70%(32°C)
LED display	Power on/Standby/Communication/Charge/Error/Print/Update
Communication	Bluetooth 4.0
External connection terminal	Micro USB port (charging only)
USB power supply	Rated DC 5V / 1.0A adapter (optional)
Built-in battery	500mAh lithium polymer (rechargeable)
Proper image resolution	More than 1280 x 2448 pixel
Weight	186g
Support App version	Android / 4.0 or higher iOS / 5.1 or higher (Support may not be provided depending on the user's Smart phone version and environment.)

\* Product design and specifications are subject to change without notice.

Safety Precautions

**WARNING**  
A violation of labeling regulations can cause serious injury or death.



**NOTICE**  
A violation of labeling regulations causes minor injury or damage to the product.

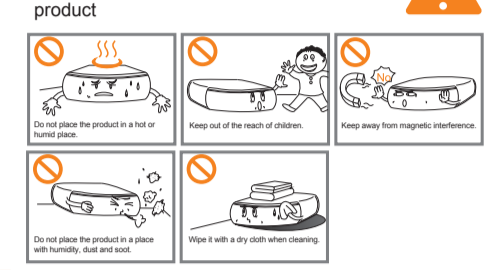

Cover Open method

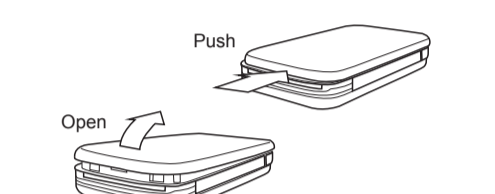

Inserting printing paper

- Prepare the blue Smart Sheet and white printing paper pack after unpacking the photo printing paper pack.
- Open the top cover and insert the Smart Sheet and printing paper as shown in the figure.

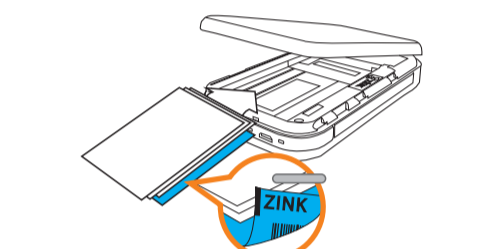

**Notice**  
• Do not open the Cover while printing.  
• Printing quality of output cannot be guaranteed in case of using Zink paper of other companies.

4. Execute a dedicated App.
5. Select the desired photo from [Take a picture / Photo Album].
6. Select the print image at the top right corner of the Edit screen.
7. Select the print image at the bottom of the Print Preview window.

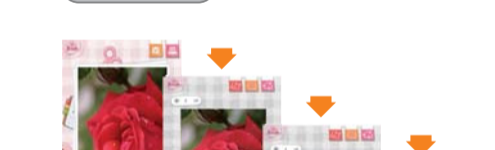

Items to check before reporting a malfunction

Problems	Checklist
The power does not turn on.	Check to see if the battery is charged. Reboot the Bluetooth of the phone, or connect directly from the Settings menu. Try connecting in about 5 minutes after turning on the power to the device.
Bluetooth connection is not established.	The paper is automatically ejected if you turn on the power after printing out the Smart Sheet 2 to 3 times. The printing paper should be stored in an environment with low temperature/humidity. Do not fold or crumple the paper.
Printing paper seems to be jammed.	Check the Auto Time Off value within "Settings" -> "see more" of the App (None, 3 minutes, 5 minutes, 10 minutes). The operating status LED flickering Red indicates there is no power remaining on the battery. In this case, charge the battery with a dedicated adapter.
Stopped during printing operation.	Print it again after printing out the Smart Sheet 2 to 3 times. (A slash mark appears in case an impact is applied to the printer during the printing operation.)
The printed photo shows a line.	A slash mark appears in the middle of the photo.
The power turns off automatically after a certain period of time.	The printed image quality differs greatly from the original image quality. The image quality is somewhat degraded when editing the image using Pomiini App's Edit menu. Print it again after printing out the Smart Sheet 2 to 3 times. The Smart Sheet within the same pack with printing paper should be used. Check to see if the image has the proper resolution (1280x2448) or higher. The printed image quality cannot be guaranteed in case you use printing paper of other companies. Use the original printing paper. Turn on the power after pressing the Reset Hole with a pointed object.
The printed image quality differs greatly from the original image quality.	The above methods do not resolve the problems.

Operating Temperature

If the optimum operating temperature of (15~32°C) is not met when using this device, it may not print or lead to failure to provide the best print quality. For stability of the product, refrain from using it at a low temperature in the winter.

Table of Contents

- 1. Items confirmed before use 6
  - Components check
  - Names of parts
  - Power on/off
  - Charging the battery
- 2. Application installation 8
  - Installation in Store
  - Installation with QR Code
- 3. Cover Open method 10
- 4. Inserting printing paper 10
- 5. Printing 12
  - Android OS
  - iOS
  - Settings
  - Print Mode
- 6. Checking LED indicators 20
- 7. Product specifications 21
- 8. Items to check before reporting a malfunction 22

Zink Smart Sheet



**Features**  
• Provide optimum image quality correction suitable for each printing paper pack.  
• Remove foreign objects from printer head.

**How to use**  
• Eject automatically before printing out the paper in initial output.  
• Poor quality and occurrence of horizontal lines can be improved by repeatedly printing 2 to 3 times.  
• Recycle until the printing paper of each printing paper pack is exhausted.

**Notice**  
• Optimum image quality cannot be guaranteed when the Smart Sheet of each printing paper pack is not used, or the bar code is damaged.  
• Long-term storage after opening the printing paper pack can have a bad effect on printing quality due to a discoloration or distortion of printing paper.

Change in device settings Android & iOS (common)

1. Select [See More] in [Information] after selecting [Settings] at the top left corner of the main screen.
2. Set/check out each function on the Settings screen.

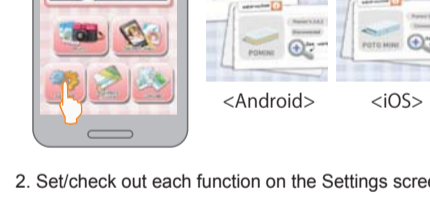

Problems

Problems	Checklist
White LED flashes and printed paper does not come out.	This device requires the proper temperature of (15~32°C) to facilitate smooth printing operation. Thus, a greater warm-up time is required in temperatures that are lower than ideal, and cooling times are greater when the temperature is higher than ideal. Please wait a moment to reach the proper temperature.
Printed paper comes out too late.	The paper is automatically ejected if you turn on the power after printing out the Smart Sheet 2 to 3 times. The printing paper should be stored in an environment with low temperature/humidity. Do not fold or crumple the paper.
The printed image quality differs greatly from the original image quality.	The image quality is somewhat degraded when editing the image using Pomiini App's Edit menu. Print it again after printing out the Smart Sheet 2 to 3 times. The Smart Sheet within the same pack with printing paper should be used. Check to see if the image has the proper resolution (1280x2448) or higher. The printed image quality cannot be guaranteed in case you use printing paper of other companies. Use the original printing paper. Turn on the power after pressing the Reset Hole with a pointed object.
The above methods do not resolve the problems.	

1. Items confirmed before use

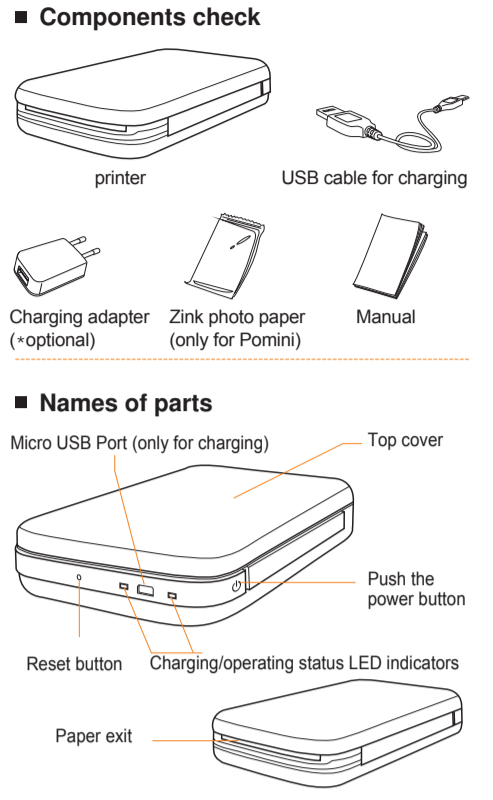

5. Printing

1. Execute a dedicated App after turning on the power of the printer.
2. Select the desired photo from [Take a Picture / Photo Album] after selecting [Print] from the App's main screen.
3. Select the Print button at the top right corner of the Edit screen.
  - Optimum image quality cannot be guaranteed when the Smart Sheet of each printing paper pack is not used, or the bar code is damaged.
  - Long-term storage after opening the printing paper pack can have a bad effect on printing quality due to a discoloration or distortion of printing paper.

Description of Settings Details

Function	Description
Auto Exposure	Automatic exposure settings
Print Mode	Print mode settings (Image Full, Paper Full)
Auto Power OFF	Auto power off setting (None, 3 minutes, 5 minutes, 10 minutes)
Device Status	Device status (Idle, Busy, Paper Empty, etc.)
Battery	Battery level
Number of page Printed	The total number of pages printed.
MAC Address	Bluetooth MAC address
Update	Firmware and color correction data updates

Warranty Card

\*\*\* Warranty Card \*\*\*

1. Retain the original dated sales receipt.
2. This product is fully guaranteed against defects in materials and workmanship for one year from the original date of purchase.
3. Any component part or parts which become defective in normal use due to faulty materials or workmanship, will be repaired or replaced at our discretion free of charge.
4. This guarantee will be null and void if the item has been interfered with in any way by any unauthorized party, or misused in any way.
5. This warranty does not apply when failure is due to shipping damage, accident, alteration, modification, unauthorized service, misuse, abuse, use with incompatible accessories or attachments, failure to follow our operation, maintenance or packing instructions, failure to use items supplied by us (such as adapters and cables), or claims made after the duration of this warranty.
6. This limited warranty will be honored only within the geographical location that Printer and accessories were purchased.

AS: Add: Support Tel: Registration of Purchase Name: Address: Phone no: Model no: Serial no: Date of purchase

PRINTING INFORMATION	
COLOR	CMYK
PROCESS	Offset Printing
MATERIAL	

A	M	E	N	D	DATE	NO	CONTENT	SIGN
					-5	+0.05	+0.10	+0.25
-15	+0.07	+0.20	+0.35					
-50	+0.10	+0.30	+0.50					
-150	+0.18	+0.55	+0.90					
-500	+0.30	+0.90	+1.50					

NO	CODE	MATERIAL	TREATMENT	QTY	MODEL	REMARK
DRAWN	DESIGN	CHECK	APPRO	DATE	2014. 10. 23	
				TOL		
				SCALE	A1	
				UNIT	mm	
				DWG NO		MANUAL USER (Japan)
						GK07X0000100