

# Qi WIRELESS CHARGER INSTRUCTIONS

## Warning:

1. To prevent damage to the phone holder, make sure the temperature of the phone holder is above freezing during installation and removal.
2. Do not install any accessory near or on air bags. Never obstruct driver's view.
3. Check manufacturer's specifications of your device prior to use. Custom Accessories limits its liability only to the replacement of product.

**DO NOT RETURN PRODUCT TO THE STORE**

Please contact us toll free at (800) 962-6676 if you have any questions

# Qi WIRELESS CHARGER INSTRUCTIONS

## FCC Warning:

This device complies with Part 15 of the FCC Rules. Operation is subject to the following two conditions: (1) this device may not cause harmful interference, and (2) this device must accept any interference received, including interference that may cause undesired operation.

**NOTE:** This equipment has been tested and found to comply with the limits for a Class B digital device, pursuant to Part 15 of the FCC Rules. These limits are designed to provide reasonable protection against harmful interference in a residential installation. This equipment generates, uses and can radiate radio frequency energy and, if not installed and used in accordance with the instructions, may cause harmful interference to radio communications. However, there is no guarantee that interference will not occur in a particular installation. If this equipment does cause harmful interference to radio or television reception, which can be determined by turning the equipment off and on, the user is encouraged to try to correct the interference by one or more of the following measures:

- Reorient or relocate the receiving antenna.
- Increase the separation between the equipment and receiver.
- Connect the equipment into an outlet on a circuit different from that to which the receiver is connected.

Consult the dealer or an experienced radio/TV technician for help. **CAUTION:** Changes or modifications not expressly approved by the party responsible for compliance could void the user's authority to operate the product.

This equipment complies with FCC radiation exposure limits set forth for an uncontrolled environment. This transmitter must not be co-located or operating in conjunction with any other antenna or transmitter.

# Qi WIRELESS CHARGER INSTRUCTIONS

## FCC Warning:

The product is suitable for any car

Installation environment: Window or Dash Mount

### Driver Seat

Knee	29 cm
Leg	36 cm
Body	74 cm
Hand	45 cm
Arm	62 cm
Head	114 cm

### Passenger Seat

FRONT	
Knee	28 cm
Leg	35 cm
Body	75 cm
Hand	46 cm
Arm	61 cm
Head	115 cm

## Your Kit Contains

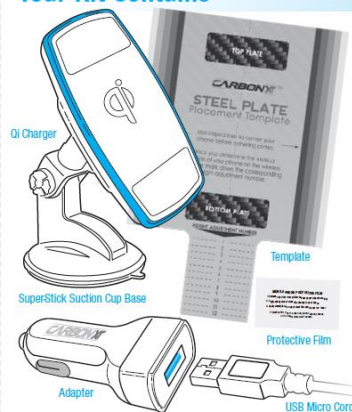

1

## IMPORTANT!

Not all phones can accept a wireless charge. Before you begin, check your mobile phone specifications to make sure it has wireless charging capabilities.

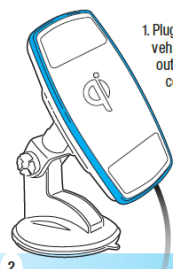

1. Plug the adapter into your vehicle's 12-24 Volt power outlet. Connect the included cord to both the adapter and the Qi Charger. Qi Charger LED ring will flash GREEN and then turn BLUE. To maximize your charging speed, use the adapter supplied with this unit.

2

2. You may use your Qi Wireless Charger with a case or without a case. However, excessively thick cases may not allow a wireless charge. Also, be sure to remove any steel plates (used with magnetic phone holders) near the center of your phone. Steel plates in the center of your phone will block the wireless charge.

To test your case, simply hold your phone with case on the center of the wireless charger. Your phone should indicate that it is taking a charge and the Qi Wireless Charger LED light ring should glow RED. If you don't get a wireless charge, try moving your phone up or down slightly to locate the optimum position for charging. If you still cannot get a charge, your case may be too thick. Consider a thinner case if you want to take advantage of your phone's wireless charging capabilities.

3

3. Place the template over the charger, aligning the steel plates on the template to the magnets on the charger.
4. Place phone over template and center left to right using the shaded lines.

4

5. Slide your phone up and down slowly until your phone indicates it is taking a charge. The Qi Chargers LED light ring will glow RED when phone placement is in the optimal position. Remember the **Height Adjustment Number** (the closest horizontal line to the bottom of your phone) on your template for use in step 7.
6. Flip the template over and peel the backing off of the steel plates.

5

7. Place your phone on flat a surface, face down. Align the template horizontally using the gray shaded lines. Align the template vertically using your **Height Adjustment Number** determined in step 5. In the example above, the **Height Adjustment Number** is 3.



8. Press firmly on the steel plates for 1 minute, carefully remove the template and let the adhesive set for 1 hour before use.

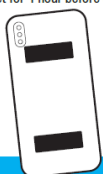

9. Now your phone has the steel plates in the optimum location for placement on the Qi Charger.

6

10. To charge your phone, simply place your phone on the Qi Charger. The embedded light ring will glow RED to ensure your phone is charging.

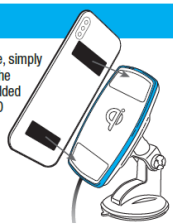

### LED Color Ring Legend

LED Color	Status
Blue	Ready/Standby
Flashing Red	Foreign Object Detected
Constant Red	Charging
Green	Fully Charged

Customer Service: 1-800-962-6676 Visit our website at: www.cauto.com

CUSTOM ACCESSORIES, INC., RICHMOND, IL 60071  
MADE IN CHINA © 06\_2019 CA

7