



Record Player Turntable For Vinyl Record

With BT Speaker & FM Radio Functions

Instruction Manual

Thank you for purchasing the Record Player Turntable For Vinyl Record. This manual provides more information about this Record Player, please read the instructions before using.



Product Overview

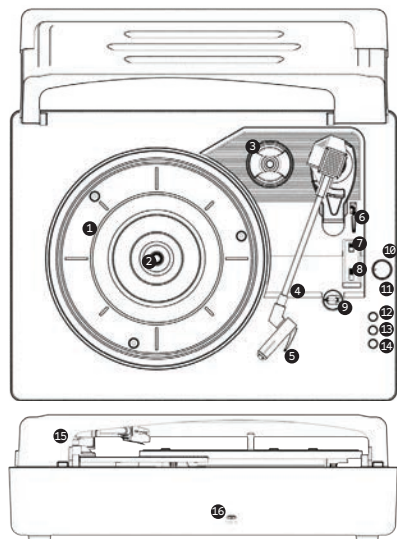

- | | |
|--------------------------|--------------------------------|
| 1: Turntable Platter | 9: Tonearm Holding Clip |
| 2: Turntable Spindle | 10: Power ON/OFF & Volume Dial |
| 3: 45 RPM Adapter | 11: Power Indicator |
| 4: Tonearm | 12: Scan /Prev Button |
| 5: Cartridge | 13: Scan /Prev Button |
| 6: Tonearm Lifter Handle | 14: Mode /Play / Pause Button |
| 7: Auto Stop ON/OFF | 15: Dust Cover |
| 8: RPM Speed Selector | 16: Micro USB Port DC 5V / 1A |

Package Contents

- 1(One) Record Player Turntable 14in. x 10.2in. x 4.7in. (35.5cm x 26cm x 11.9cm)
- 1(One) Micro USB Power Cable 39.4in. (100cm)
- 1(One) Instruction Manual

Technical Specification

- Driver Diameter: 52 mm x 2
- Impedance: 4 Ohms
- Turntable Speed: 33 / 45 / 78 RPM
- Bluetooth Version: 5.3
- Bluetooth Range: 32.8 Feet
- Power Supply: DC 5V / 1A
- Micro USB Power Cable (Included)

Power your record player

- Use the Micro USB Power cable provided with this record player.
- Connect the Micro USB Power plug to Micro USB port on the record player, then connect the USB plug to a USB port on a computer or wall adapter to power the record player.

NOTE:

- You must select a qualified USB adapter from a regular manufacturer.

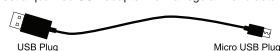

Power ON/OFF

Turn the Power ON/OFF & Volume Dial clockwise to switch on the unit. Power indicator will be on with Red.
Turn the Power ON/OFF & Volume Dial anticlockwise, until you hear a "click" sound to switch off the unit. The power indicator will be off.

Adjust the Volume

Rotate the Power ON/OFF & Volume Dial clockwise/anticlockwise to adjust the volume.

Mode Change

Long press "Mode" button to switch between BT speaker mode, LP mode and FM mode
Power On will be in BT mode, different Beep sounds represent different mode.
Sequency: BT speaker mode(1 Beep) -> LP mode(2 Beeps) -> FM mode(3 Beeps) -> BT speaker mode(1 Beep)

BT Speaker Mode

- Switch to BT speaker mode
- Connect device to BT speaker, pairing name: RECORD PLAYER SPK
- After connected, play music via device
- Under BT speaker mode, both Volume knob and BT device will control the volume
- Short press "Mode" to play or pause music
- Short press "Prev" button for previous song
- Short press "Next" button for next song
- Switch to LP mode will turn off the BT speaker

FM Mode

- Switch to FM mode
- Long press "Scan" button 2 secs to scan and save FM channel automatically, FM88.00-108.00
- Short press "Prev" or "Next" button switch channel between saved channels
- Use the Volume knob to control the volume
- Switch to BT mode will turn off the FM radio

LP Mode

Switch to LP mode

- Place the unit on a flat and level surface. The selected location should be stable and free from vibration.
- Set the RPM Speed accordingly to the record speed request.
- Place the record on the record player. Use the 45 RPM Adapter if necessary.

12-inch vinyl /
10-inch vinyl



7-inch vinyl
45 RPM Adapter

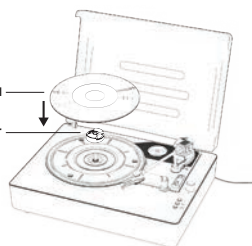

- Remove the cartridge protector.
- Note: To avoid cartridge damage, make sure the cartridge protector is in place and fixed on Tonearm holding clip whenever the record player is being moved or cleaned.

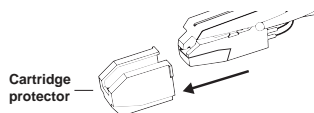

- Turn on the power of record player.
 - Release the Tonearm Holding Clip.
- Note: When the record player is not in use, remember to secure the Tonearm.

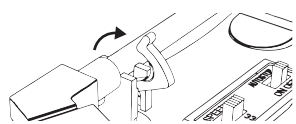

- Use the Tonearm Lifter to lift up the Tonearm.
- Note: Never close the dust cover when Tonearm is lift up!

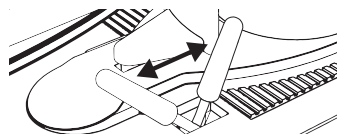

- Gently move the tonearm over the sound track of record. Set the Tonearm Lifter to the down position, the tonearm will descend slowly on sound track of record and begin to play music.
- When the record is finished playing, use the Tonearm Lifter to raise the tonearm and then return it to the tonearm holding clip rest position.

Auto Stop Function

If switch set at the AUTO STOP position, the turntable platter will stop spinning when the tonearm is moved to the inner of vinyl record or return to the Tonearm Holder. If the AUTO STOP Switch is in OFF position, the turntable platter will start/stop spinning when the unit is power ON/OFF.

Record Care

- Records should be stored vertically in a dry environment away from sources of heat.
- A record cleaning brush can be used to remove dirt from the record's grooved surface. Use a record cleaning solution to further clean your records to ensure crystal clear playback.
- It is important to use the cueing lever when lifting or lowering the tonearm to prevent accidental slipping and scratching of your vinyl.

Stylus Care

When the playback sound becomes distorted and unsatisfactory:

- Please confirm that no dust or lint has accumulated on the stylus tip.
- If there is visible foreign matter on the tip of the stylus, please remove it carefully with a soft stylus-cleaning brush.

Cartridge

- Attach the provided protector to the cartridge when the product is not in use.
- Do not touch the stylus of the cartridge with your finger.
- Do not allow the stylus to bump against the platter, felt mat, or edge of the record.

FAQ

- If the record player didn't work:**
Ensure that the USB power cable is connected between player and USB adapter. If you use a power outlet, ensure that the power supply is connected securely and the outlet works.
- If the turntable didn't run:**
Ensure the power is on by turn Power On/Off & Volume Dial to clockwise with the RED LED is on. Ensure the tonearm is moved over the record.
- My turntable seems to wobble:**
It is normal for a turntable to have a slight wobble, however this should not affect audio quality. If your turntable is wobbling and you are concerned, make sure you have the turntable on a flat surface. Check your vinyl to ensure it is not warped.
- What do I do if my records are skipping:**
Ensure that the Record Player is setup on a level and sturdy surface. It is also important to ensure your records are kept clean and stored properly to prevent warping. Check the stylus for debris. Ensure the cueing lever is lowered completely. If the issue persists it is recommended to test with other records.
- I'm experiencing feedback when listening to records:**
Feedback can occur when the volume is too loud in the environment where the record is being played. The stylus can pick up this noise and send it back into the system causing feedback. If you experience feedback, lower the volume of the Record Player.
- Is it normal to hear pops and crackling when playing a record:**
Dirt and debris on a record can cause popping and crackling noises. It is important to properly clean your records to ensure they are in the best condition for playback. Popping and crackling can also be caused by scratches, wear over time, or inherent flaws from vinyl production.
- Tonearm auto stop is not functioning properly:**
If your unit's tonearm auto stop is not stopping or stopping too early it is recommended to test with additional records. Due to variances in vinyl record production some records may not work correctly with the auto stop function. Please note that the Record Player does not have an automatic tonearm return function. The tonearm must be manually returned to the tonearm rest.
- My records play too fast or too slow:**
There is a RPM Speed Selector switch located next to the Power ON/OFF & Volume Dial. The speed selector switch has 3 different speed settings (33 RPM, 45 RPM or 78 RPM). Please ensure that you have selected the correct setting based on the record you are attempting to play. To change the speed, please adjust the selector switch to the required speed for the record you are playing.

SAFETY INSTRUCTIONS

- Keep the product away from excessive heat sources and direct sunlight. Do not place it on or in heating devices, such as microwave ovens, stoves or radiators. Do not use this product near water.
- When closing the dust cover, close it completely. Do not open the dust cover during playback.
- This product should be operated only by the type of power source indicated on the marking label or in this instruction manual.
- Keep the product dry. Avoid dusty, damp and dirty environments. Using the product in these environments may damage the circuitry.
- Do not attempt to disassemble or remanufacture the product, insert foreign objects into it, or immerse or expose it to water or other liquids. Doing so may lead to fire, explosion, or other hazards.
- Product should be moved with care. Quick stops, excessive force, and uneven surfaces may cause the product damaged.
- Slots and openings in the cabinet are provided for ventilation and to ensure reliable operation of the product and to protect it from overheating. Do not block or cover these openings.
- Unplug the product during lightning storm or when unused for long periods of time.

FCC warning:

Any Changes or modifications not expressly approved by the party responsible for compliance could void the user's authority to operate the equipment.

Note: This equipment has been tested and found to comply with the limits for a Class B digital device, pursuant to part 15 of the FCC Rules. These limits are designed to provide reasonable protection against harmful interference in a residential installation. This equipment generates uses and can radiate radio frequency energy and, if not installed and used in accordance with the instructions, may cause harmful interference to radio communications. However, there is no guarantee that interference will not occur in a particular installation. If this equipment does cause harmful interference to radio or television reception, which can be determined by turning the equipment off and on, the user is encouraged to try to correct the interference by one or more of the following measures:
-Reorient or relocate the receiving antenna.
-Increase the separation between the equipment and receiver.
-Connect the equipment into an outlet on a circuit different from that to which the receiver is connected.
-Consult the dealer or an experienced radio/TV technician for help.

This equipment complies with FCC radiation exposure limits set forth for an uncontrolled environment. This equipment should be installed and operated with minimum distance 20cm between the radiator & your body.

FCC ID: 2ADM5-SP-00888

This device complies with Part 15 of the FCC Rules. Operation is subject to the following two conditions:
(1) This device may not cause harmful interference, and
(2) This device must accept any interference received, including interference that may cause undesired operation.

CAUTION: The micro USB power cable included with this item is intended for use with this product. Only use the included micro USB power cable to operate this product.

Class 1 LED product

Keep All Relevant Information for Future Reference

Item # SP-0088-B
Distributed by 1616 Holdings, Inc.
701 Market Street, Suite 200
Philadelphia, PA 19106

Made in China