



SENSOR WIRELESS HEADPHONES

INSTRUCTION MANUAL



Table of Contents

- 1 Introduction..... 1
- 2 Packaging Contents..... 2
- 3 Connection Diagram..... 2
- 4 How To Use..... 3
 - 4.1 General Function..... 3
 - 4.2 Pairing To Mobile Phone..... 4
 - 4.3 Charging Your Headphones 5
 - Method 1 5
 - Method 2 6
- 5 Product Specification..... 6
- 6 FAQ..... 7
- 7 FCC Statement..... 7
- Battery Statement..... 8

1. Introduction

Congratulations, and thank you for choosing the Sensor Wireless Headphones. This manual will help you operate the Sensor Wireless Headphones, but firstly you should familiarize yourself with the Bluetooth functionality of your mobile phone or other devices before using the Sensor Wireless Headphones.

Safety Rules

- 1 Please follow the rules depicted in this manual closely to ensure your safety. Before using this Bluetooth headphones, we would strongly encourage you to read through this user manual.
- 2 Be more wary of any edges, uneven surfaces, metal parts, accessories and its packaging so as to prevent any possible injury or damage.
- 3 Do not modify, repair or dismantle this Bluetooth headphones. Doing so may result in fires, electric shocks, complete breakdown of this Bluetooth headphones, etc. All are not covered under warranty.
- 4 Do not use an diluent or volatile liquid to clean the Bluetooth headphones.
- 5 Do not use the Bluetooth headphones in a hazardous location.

1

2. Packaging Contents



3. Connection Diagram

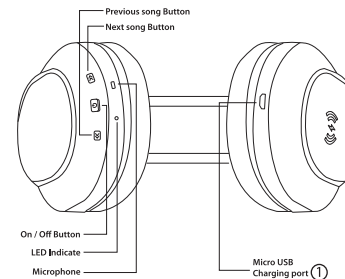

2

4. How to use

4.1.General Functions

Desired Result	Required Action
Turn on & Enter the pairing mode	Press and hold the On / Off Button for 3 seconds. After turning on, the LED indicator flashes red/blue.
Pairing	Use a mobile phone with Bluetooth function or other Bluetooth devices to perform necessary pairing action. After pairing, the LED indicator slowly blinks with blue.
Turn off	Press and hold the On / Off Button for 3 seconds.
Charging	Method 1: Plug the Micro USB to the micro USB port. Method 2: Put Headphone's earcup to wireless charging pad. When charging, the LED indicator turn red, after full charged, the LED indicator turns off on both method.
Answering a Call	Press On / Off button to answer phone call, press On / Off button again to end call. Press and hold 2 seconds to reject call. Double click to redial last call.
Play / Pause Music	Press On / Off button to play music and press it again to pause music.

3

4.2. Pairing to Mobile phone or other device

To use your Bluetooth headphones, you must first pair your headphones with a mobile phone or other Bluetooth device. Once your Bluetooth headphones is paired to a specific mobile phone, they will remain paired and automatically recognize each other whenever they are within range.

Pairing to a phone and Entertainment:

- Turn on your phone and ensure the Bluetooth function is activated.
- Turn on the headphones, enter the pairing mode.
- Search your Bluetooth devices on your phone by following the phone's instructions. Refer to your phone's user manual for more information.
- After a few seconds the phone will list the "BT SENSOR HP" as a discover device. Select it and follow your phone's instructions to select this pairing.
- Your phone will confirm the pairing, and then press Yes/OK.

4

4.3. Charging your Headphones

Method 1

⚠ For your safety, please always use an appropriate 5V input charger/Adapter to charge the product. **DO NOT USE** Quick Charging USB Adapter to charge the product, as it might damage the product.

Use the Micro USB charging cable accessory provided with this headphones. Connect the Micro USB plug to the Micro USB charging port on the headphones positioned at ① in headphones diagram on page 2. Connect the USB plug to a USB port on a computer or wall adapter to activate charging.

**Make sure to keep the headphones charging for a minimum of 2 hours before initial use.



Warning:

- You must select a qualified charger from a regular manufacturer.
- You must charge the Bluetooth headphones if it has not been used for more than 6 months.

5

Method 2

You can also charge your headphones by wireless charging pad as below way.

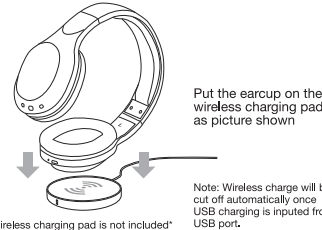

5. Product Specification

Driver Diameter: 40 mm
Impedance: 32 Ohms
Frequency Response: 20 Hz - 20K Hz
Sensitivity: 100 dB +/- 3 dB
Battery Capacity: Li-ion Battery 3.7 V 180 mAh
Playtime: 2-3 Hours
Charging Time: 1.5-2 Hours
Bluetooth Range: 32.8 Feet
Bluetooth Version: 5.1
Charging Method: Wireless Charging / Micro USB Charging

6

6. FAQ

1. Why is there no power even when the headphones is turned on?
Ans: Ensure the battery has been charged up to 1 hour for initial use.
2. There is no sound when playback.
Ans: Check the connection between headphones with phone or computer, if the connection is not established, please connect again. Make sure the headphones is paired and connected with your target phone or other master device.

7. FCC Statement

FCC STATEMENT
1, This device complies with Part 15 of the FCC Rules, Operation is subject to the following two conditions:
(1) This device may not cause harmful interference.
(2) This device must accept any interference received, including interference that may cause undesired operation.
2, Changes or modifications not expressly approved by the party responsible for compliance could void the user's authority to operate the equipment.

NOTE: This equipment has been tested and found to comply with the limits for a Class B digital device, pursuant to Part 15 of the FCC Rules. These limits are designed to provide reasonable protection against harmful interference in a residential installation. This equipment generates uses and can radiate radio frequency energy and, if not installed and used in accordance with the instructions, may cause harmful interference to radio communications. However, there is no guarantee that interference will not occur in a particular installation. If this equipment does cause harmful interference to radio or television reception, which can be determined by turning the equipment off and on, the user is encouraged to try to correct the interference by one or more of the following measures:
- Reorient or relocate the receiving antenna.
- Increase the separation between the equipment and receiver.
- Connect the equipment into an outlet on a circuit different from that to which the receiver is connected.
- Consult the dealer or an experienced radio/TV technician for help.

RF warning statement:
The device has been evaluated to meet general RF exposure requirement. The device can be used in portable exposure condition without restriction.

7

⚠ Safety instructions for the lithium battery and charging the product

- The input voltage to the product is 5V 1A.
- In order to charge the product in safe manner and reliable conditions, please only adopt certified appropriate charger/ adapter for charging the product.
- Only charge the product at ambient temperatures between 10 deg °C/ 50 deg °F and 40 deg °C/104 deg °F.
- Do not heat above 70 deg °C/158 deg °F, e.g. Do not expose to sunlight or throw into fire.
- Switch off the product after use.
- Please note that we won't take any responsibility for any wrong operation (e.g. Voltage higher than 5V) as this may result in severe injury or loss of property, and we cannot control the operating process during the time the user using this product.
- In extreme cases, abuse or misuse of Lithium battery pack can lead to explosion, heat generation, fire development or smoke development.

FCC ID: 2ADM5-HP-0414



Distributed by 1616 Holdings, Inc.
701 Market Street, Suite 200
Philadelphia, PA 19106

Item # HP-0414
Made in China

Keep All Relevant Information For Future Reference

8

Approval:

Date: