

FRONT SIDE



CHROMA

TRUE WIRELESS EARBUDS

INSTRUCTION MANUAL

Thank you for purchasing the CHROMA True Wireless Earbuds. This manual provides more information about the wireless earbuds, please read the instructions before using.



Product Overview

CHROMA True Wireless Earbuds

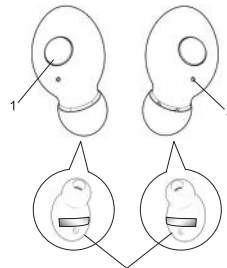

Protective Stickers
(on the back side)

Remove the protective stickers before using

Portable Charging Case

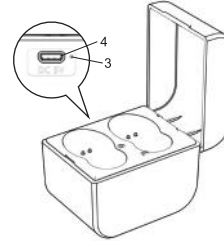

- 1, On/Off Button/
Play/Pause Music
Answer/End Call
- 2, LED Indicator
- 3, Charging LED Indicator
- 4, Micro USB Charging Port

Package Contents

1(One) Pair Earbuds / 1.1in. x 0.9 in. x 0.7in. (2.9cm x 2.3cm x 1.7cm) each
1(One) Portable Charging Case 1.9in. x 1.6in. x 1.4in. (4.8cm x 4.1cm x 3.6cm)
1(One) Charging Cable 10 in. (25 cm)
1(One) Instruction Manual

Specifications

Driver Diameter: 10 mm
Impedance: 32 Ohms
Frequency Response: 20 Hz - 20 KHz
Sensitivity: 96 dB +/- 3 dB
Power Supply: Li-ion Battery 3.7V 35 mAh Per Earbud
Playtime: 10 Hours
Charging Time: 2 Hours
Bluetooth Range: 32.8 Feet

Charging Case Battery Capacity: 500 mAh
Micro USB Charging Cable Included

Power On/Off

Power On

Press and hold down the On/Off Button of earbuds for 3 seconds and the LED will flash.

Power Off

Press and hold down the On/Off Button of earbuds for 4 seconds and the LED will turn off.

Pair the wireless earbuds with your mobile device

1. Keep the distance between the earbuds and mobile device within 32.8 feet.
2. De-activate the Bluetooth function on your mobile device.
3. The protective stickers must be removed from the earbuds and put the earbuds back to charging case before use. Take both earbuds out from charging case and wait for 3 to 5 seconds for auto pairing. The earbud has indicator blinking quickly. Another earbud's indicator will be off when auto pairing is done successfully.
4. Activate the Bluetooth function on your mobile device and select "CHROMA TWS" from the list shown.
5. After pairing is successful, both earbuds will stop blinking.

*Attention: If the auto pairing is not successful, manual pairing between earbuds is essential by following below procedures:

1. Make sure the earbuds are charged.
2. De-activate the Bluetooth function on your mobile device, (if you had been paired the earbuds to some other mobile device(s) nearby, please sure to de-activate those device(s) too).
3. Power on both earbuds simultaneously by pressing the On/Off buttons for 3 seconds and wait for 3 to 5 seconds for auto pairing. (Keep the Bluetooth function off on your mobile device before this operation.)
4. Activate the Bluetooth function on your mobile device and select "CHROMA TWS" from the list shown.
5. After pairing successfully, both earbuds will stop blinking.

Reconnect the wireless earbuds to your mobile device

When powered on, the wireless earbuds will automatically connect with the last successfully paired device.

Disconnect the wireless earbuds from your mobile device

Power off the wireless earbuds; or
Switch off the Bluetooth on your mobile phone; or
Leave the earbuds 60ft away from your mobile phone or further.

BACK SIDE

Answer / Reject a call

When receive a call, press the On/Off Button once (on either earbud) to accept the call, or answer the call normally via your mobile phone. Press and hold 2 seconds to reject it.

End a call

To end the call, just press On/Off button at any side of earbud with Beep sound to end it.

Functions

Pause / Play Music: Short Press on On/Off Button
Go back to previous song: Double tap Left On/Off Button.
Advance to next song: Double tap Right On/Off Button.

Charging your Earbuds

1. Open the charging case cover.
2. Remove the protective stickers between earbuds and charging case.
3. Insert the earbuds into the charging case.
4. The earbuds will start the charge automatically.
5. LED indicator light of the earbuds will be turned on when charging.
6. Once fully charged, the LED will be off.

Recharge Charging Case

⚠ For your safety, please always use appropriate 5V output charger/Adapter to charge the product. **DO NOT USE** Quick Charging USB Adapter to charge the product, as it might damage the product.

1. Use the Micro USB charging cable provided with the packaging.
2. Connect the Micro USB plug to Micro USB charging port on the charging case, then connect the USB plug to a USB port on a computer or wall adapter to begin charging.
3. The LED on the charging case will be flash during charge.
4. Once fully charged, the LED will stop flash.
5. The LED will be on during earbuds is charging and will be off after fully charged.

NOTE:

- You must select a qualified charger from a regular manufacturer.
- You must charge the charging case and earbuds if it has been not used for more than 6 months.



FAQ

If the wireless earbuds cannot be paired with your device, please try the following:

Ensure that your earbuds are in pairing mode or reconnection mode
Ensure that Bluetooth search function of your mobile device is activated.

If the wireless earbuds will not turn on:

Make sure the earbuds are fully charged.
Make sure the protective stickers are removed from the Earbuds

Can I change the battery for the earbuds and the charging case?

The wireless earbuds and the charging case use a built-in non-detachable battery which cannot be removed.

If the charging case cannot be recharged:

If you use a power outlet, ensure that the power supply is connected securely and the outlet works. If you use a computer, ensure that it is connected and the USB port is powered.

⚠ Safety instructions for the lithium battery and charging the product

- The input voltage to the product is 5V 1A.
- In order to charge the product in safe manner and reliable conditions, please only adopt certified appropriate charger/ adapter for charging the product.
- Only charge the product at ambient temperatures between 10 deg °C/ 50 deg °F and 40 deg °C/104 deg °F.
- Do not heat above 70 deg °C/158 deg °F, eg. Do not expose to sunlight or throw into fire.
- Switch off the product after use.
- Please note that we won't take any responsibility for any wrong operation (eg. Voltage higher than 5V) as this may result in severe injury or loss of property, and we cannot control the operating process during the time the user using this product.
- In extreme cases, abuse or misuse of Lithium battery pack can lead to explosion, heat generation, fire development or smoke development.

FCC STATEMENT

1. This device complies with Part 15 of the FCC Rules. Operation is subject to the following two conditions:

- (1) This device may not cause harmful interference.
 - (2) This device must accept any interference received, including interference that may cause undesired operation.
2. Changes or modifications not expressly approved by the party responsible for compliance could void the user's authority to operate the equipment.

NOTE: This equipment has been tested and found to comply with the limits for a Class B digital device, pursuant to Part 15 of the FCC Rules. These limits are designed to provide reasonable protection against harmful interference in a residential installation. This equipment generates uses and can radiate radio frequency energy and, if not installed and used in accordance with the instructions, may cause harmful interference to radio communications. However, there is no guarantee that interference will not occur in a particular installation. If this equipment does cause harmful interference to radio or television reception, which can be determined by turning the equipment off and on, the user is encouraged to try to correct the interference by one or more of the following measures:

- Reorient or relocate the receiving antenna.
- Increase the separation between the equipment and receiver.
- Connect the equipment into an outlet on a circuit different from that to which the receiver is connected.
- Consult the dealer or an experienced radio/TV technician for help.

RF warning statement:

The device has been evaluated to meet general RF exposure requirement. The device can be used in portable exposure condition without restriction.



FCC ID : 2ADM5-EP-0676

ITEM# EP-0676

Distributed by 1616 Holdings, Inc.
701 Market Street, Suite 200
Philadelphia, PA 19106

Keep all relevant information for future reference

Made in China