

Antenna Data Sheet

Catalogue

- 1. Antenna model number and Location**
- 2. Antenna Passive Efficiency**
- 3. Simple Antenna Pattern Plot**
- 4. Antenna return loss**

a. Main software and hardware facilities for antenna R&D

SAR DASYS 5:1

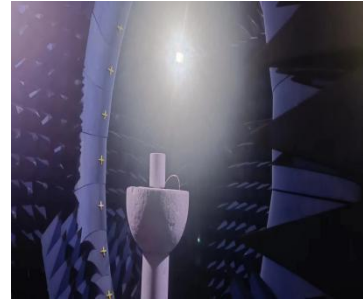

Shenzhen: GTS1800:1 GTS2800:1



Satimo SG24

GTS2800



DASY4/5

b. Full category testing capability

Support system

GSM/WCDMA/EVDO/TDSCDMA/TDD/FDD/5G-SA/5G-NSA/eMTC/

NB-iot/GPS/WiFi/BT/CA/ENDC

Common equipment

SP9500

Anritsu MT8820C

5071C

CMW500

DASY4/5 SAR



StarPoint SP9500

Anritsu MT8820C

1. Antenna model number and Location

- a. Antenna model number: RXU1030
- b. Antenna location

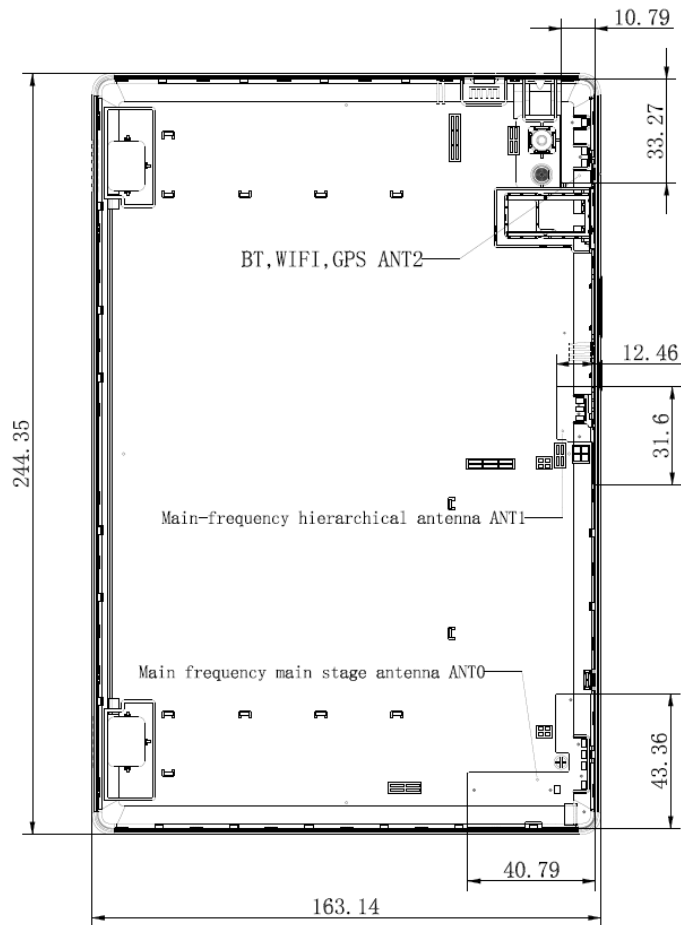

2. Antenna Passive Efficiency

a. Main Antenna

Main	Band	Average Gain	Maximum Gain
WCDMA	Band 2	1	2.02
	Band 4	1	1.38
	Band 5	0.25	0.52
LTE	Band 2/25	1	2.02
	Band 4/66	1	1.38
	Band 5/26	0.25	0.52
	Band 12/17	-2	-1.12
	Band 71	-1.95	-1.8
	Band 41	-3.1	-1.95

b. Div Antenna

DIV	Band	Average Gain	Maximum Gain
WCDMA	Band 2	-1.55	-1.3
	Band 4	-5.05	-4.9
	Band 5	-6.9	-6.7
LTE	Band 2/25	-1.55	-1.3
	Band 4/66	-5.05	-4.9
	Band 5/26	-6.9	-6.7
	Band 12/17	-10	-9
	Band 71	-15	-14.3
	Band 41	-2.7	-1.6

c. GPS/WiFi/BT Antenna

GPS/WIFI/BT	Band	Average Gain	Maximum Gain
GPS	L1 1575.5	-0.23	-0.1
WIFI	2.4Ghz-2.5Ghz	-0.2	0.31
BT	2.4Ghz-2.5Ghz	-0.2	0.31
5G WIFI	5.15Ghz-5.85Ghz	2.91	4.5

3. Simple Antenna Pattern Plot

a. Main Antenna

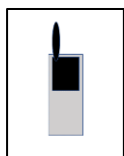

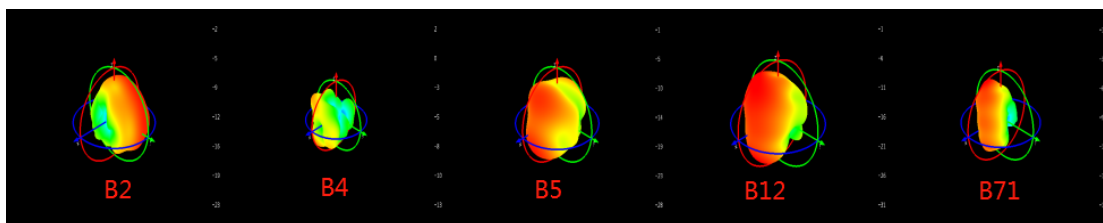

b. Div Antenna

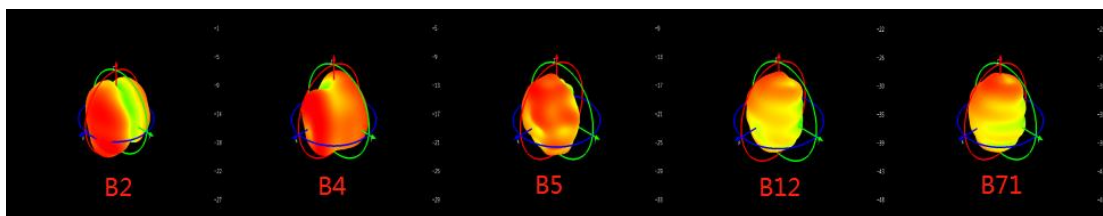
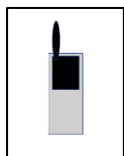

c. GPS/BT/WiFi Antenna

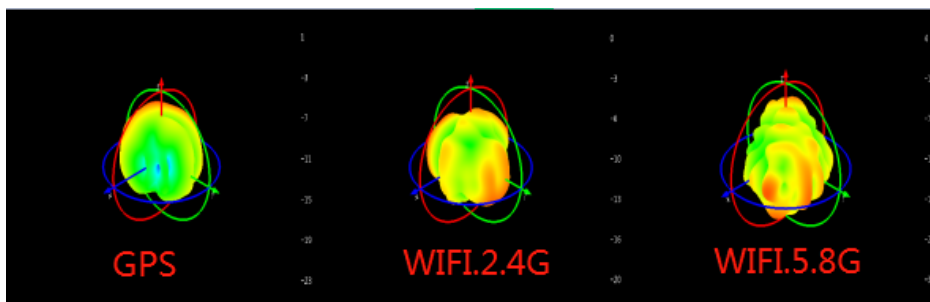
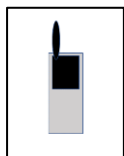

4. Antenna return loss

a. Main Antenna

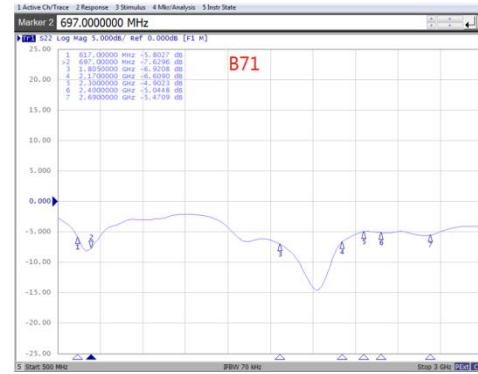
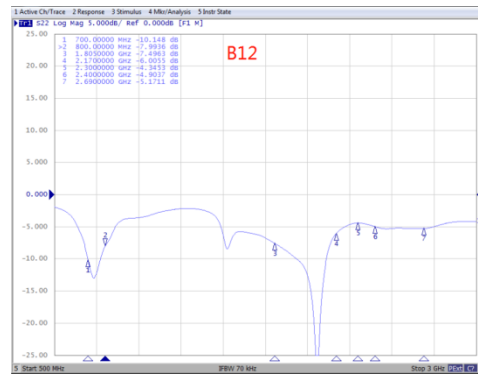
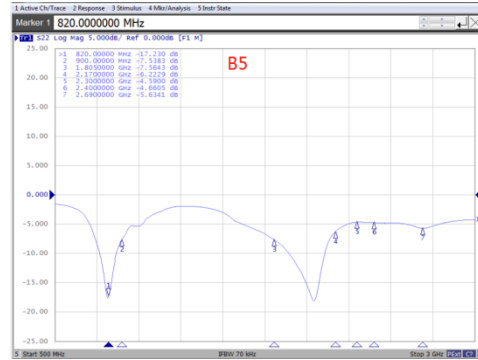
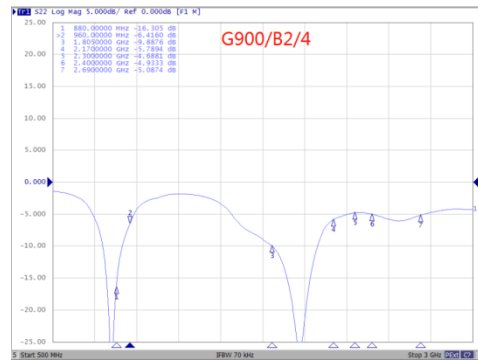

b.Div Antenna

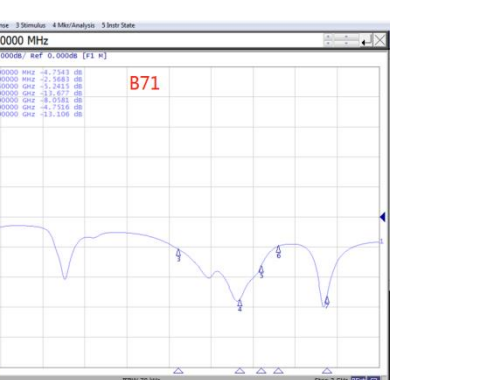

c.GPS/BT/WiFi Antenna

Kunshan Innwave Communication Technology Co.Ltd

Add.: Hongxintai Industrial Park, No. 28, Yinying Road, Gaoying Village, Dalang Town, Dongguan
<http://www.innowave.cn/>

