

Pair Pocket Auto Catch Plus with your phone

1. Turn on your mobile Bluetooth.
2. Launch the Map View of Pokémon Go. Tap the **Main Menu** button.
3. Tap **Settings** at the top right.
4. Select Pokémon Go Plus in settings page.
5. Select Pokémon Go Plus in available devices
6. Waiting for pairing. When Pokémon Go Plus icon turns on, it means the pairing is completed.

Assemble and put on Pocket Auto Catch Plus

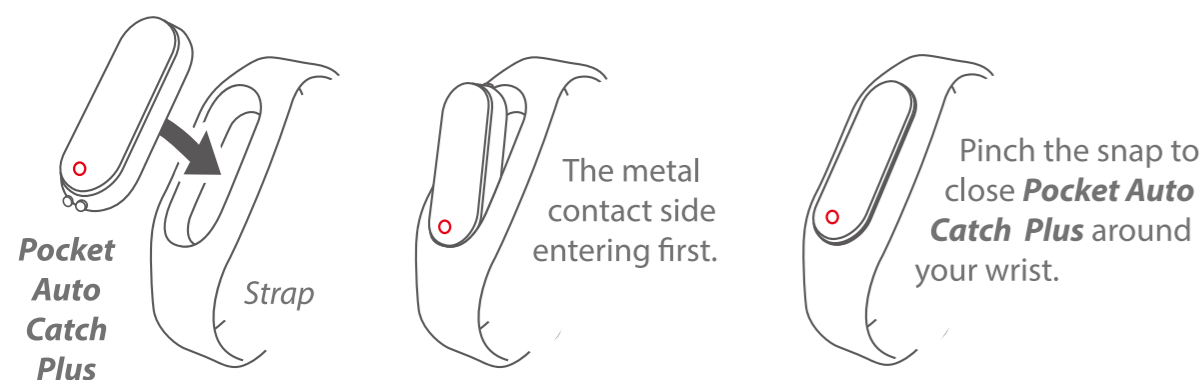

Charge Your Pocket Auto Catch Plus

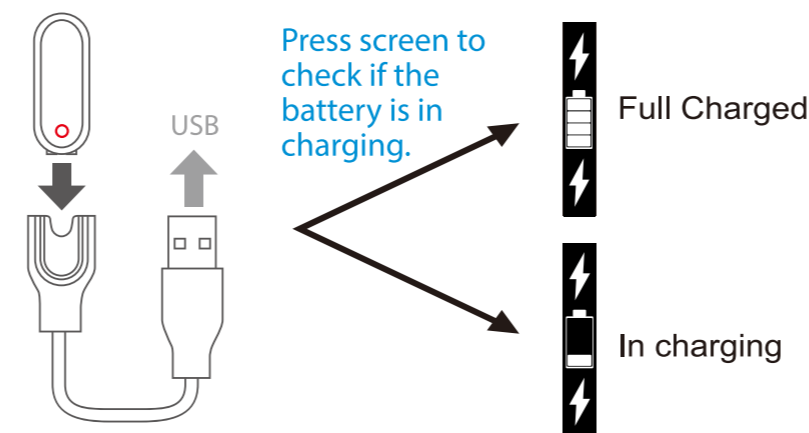

Notice

1. A full charge takes approx. 1 hour and lasts for approx. 12 hours with continuous use. And when it is full charged, you won't see charging graphic.
2. Standby time is approx. 48 hours.

IMPORTANT

Pocket Auto Catch Plus may fail to pair to device because of the update of Pokemon Go app, and the upgrade of Android and iOS.



Product Liability Insurance included



Application 「Pocket Center」 Support



Auto Catch isn't waterproof

Tap the red circle while it is charging, the charging icon will display. If you don't see the charging icon, make sure **Pocket Auto Catch Plus** is placed firmly into the charging cable.

Having difficulties pairing?

When your **Pocket Auto Catch Plus** has paired to other device, runs out of power or has any abnormality that it cannot be paired to your current device

- 1 Go to "Bluetooth" in "Settings" on the phone to remove/ clear Pokemon Go Plus.
- 2 Go to the "Settings" in the game, exit/ clear Pokemon Go Plus.
- 3 Then tap the red circle on **Pocket Auto Catch Plus**. When it pops up a new Pokemon Go Plus in the settings in the game, tap it to pair.

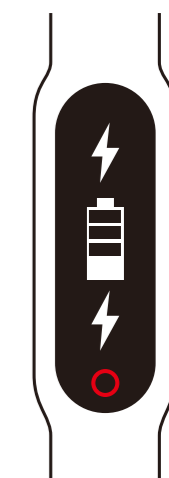

Notice

It's recommended to take off the **Pocket Auto Catch Plus** when doing intense activities.

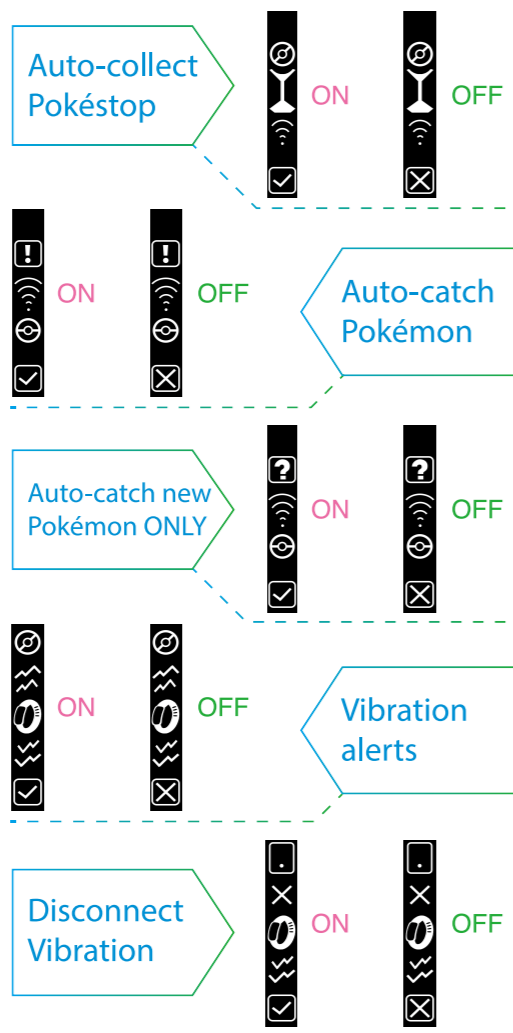
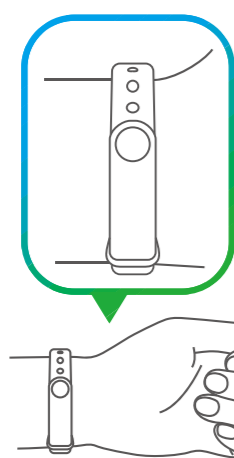

How to change the mode

1. Touch the red circle to switch between modes.
2. Long press the red circle for 3 second to turn **ON** / turn **OFF** that mode.



*** If Pocket Auto Catch Plus fails to pair to the device and displays "not paired", please go to "Bluetooth" in "Settings" on the device to remove/ clear Pokemon Go Plus, then pair it again in the game.**

Catching/ Caught Pokémon

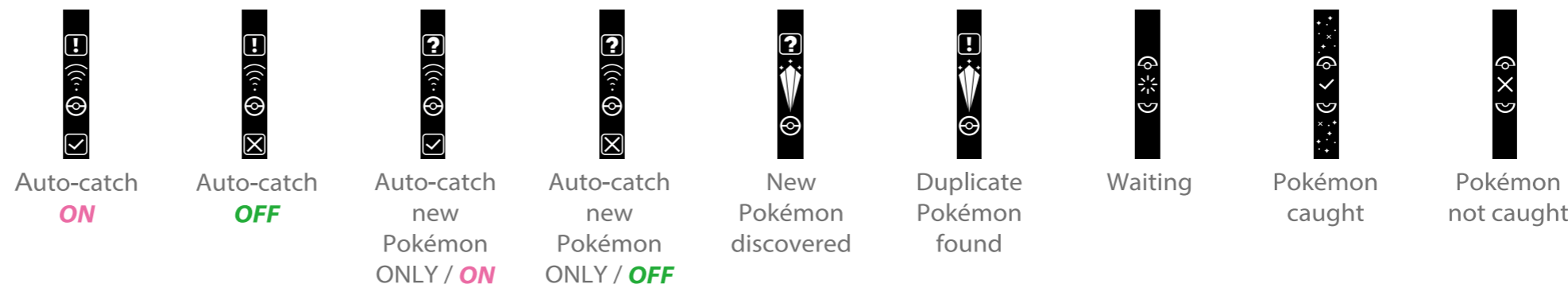

Pokéstops

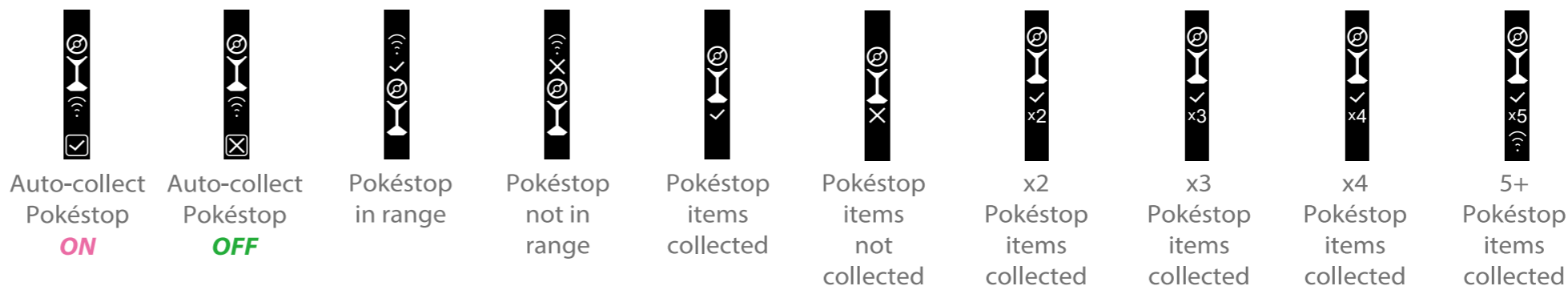

Other Alerts

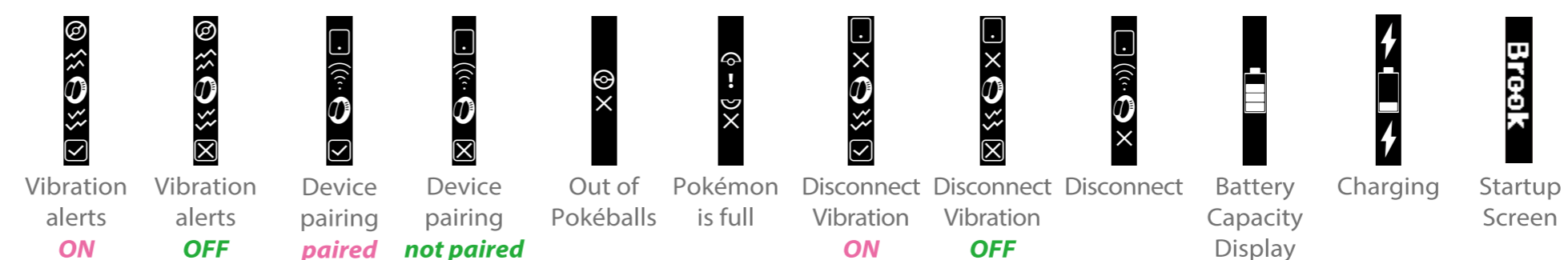

FCC Statement:

This device complies with part 15 of the FCC Rules. Operation is subject to the following two conditions:

- (1) This device may not cause harmful interference, and
- (2) This device must accept any interference received, including interference that may cause undesired operation.

NOTE: This equipment has been tested and found to comply with the limits for a Class B digital device, pursuant to part 15 of the FCC Rules. These limits are designed to provide reasonable protection against harmful interference in a residential installation.

This equipment generates, uses and can radiate radio frequency energy and, if not installed and used in accordance with the instructions, may cause harmful interference to radio communications. However, there is no guarantee that interference will not occur in a particular installation.

If this equipment does cause harmful interference to radio or television reception, which can be determined by turning the equipment off and on, the user is encouraged to try to correct the interference by one or more of the following measures:

- Reorient or relocate the receiving antenna.
- Increase the separation between the equipment and receiver.
- Connect the equipment into an outlet on a circuit different from that to which the receiver is connected.
- Consult the dealer or an experienced radio/TV technician for help.

Changes or modifications not expressly approved by the party responsible for compliance could void the user's authority to operate the equipment.

This device has been evaluated to meet general RF exposure requirement. The device can be used in portable exposure condition without restriction.



P/N : Pocket Auto Catch Plus
M/N : ZPPA000 ZPP005X

For more details please visit our official website at www.brookaccessory.com