

- \*雙面印製
- \*紙質材質：書寫紙80g
- \*要摺的地方：綠線為摺線  
綠線請勿印出來

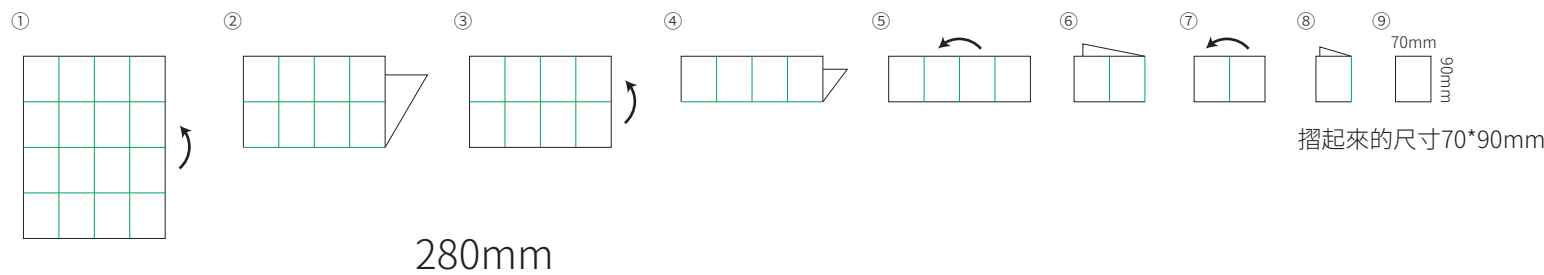

▼ 此頁為封面(摺起來的尺寸70\*90mm)

## Brook Wireless Headset

### QUICK GUIDE

- 快速指南
- クイックガイド
- 빠른 안내서

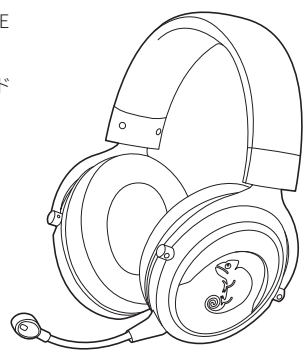

Thanks for choosing Brook Wireless Headset  
With the right setup, Brook enables every gamer to access the limitless joy of gaming.

Brook,  
Your Game. Our Play.

### Contents

English .....	03
繁體中文 .....	10
日本語 .....	17
한국의 .....	23

### Product overview

The 2.4G wireless headset features with low latency, Hi-Fi sound quality, and stereo output. It is perfect for playing games, listening to music and other entertainment usage. It is compatible with PS5, PS4, Nintendo Switch consoles, PC and Mac.

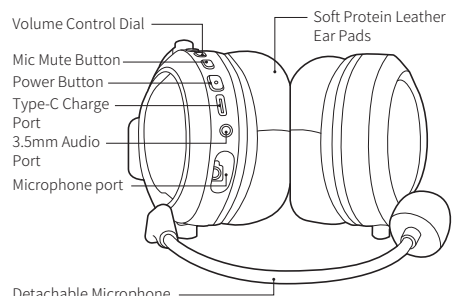

### Power ON / OFF

Hold the power button for 3 seconds until you hear a beep. If the product is not used for 15 minutes, it will automatically shut down.

### Pairing

Hold the mic mute button for 5 seconds until you hear beeps. Microphone will be muted when the button is pressed once. After pairing once, it will be automatically paired when the headset is turned on, and there is no need to re-pair.

※ The headset can be used as a wired headset with the included 3.5mm audio cable. The microphone is not functional in this configuration.

### LED ON / OFF

Adapter LED	Headst	2.4G Wireless Adapter
Blue flashing fast	Not connect to adapter	—
Blue flashing slowly	Battery low	—
Red solid on	Charging	Successfully connected
LED off	Fully charged	—

### Headset connection to PS5 / PS4

#### • Wireless

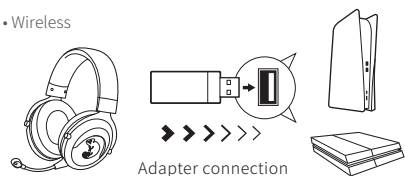

#### • Wired

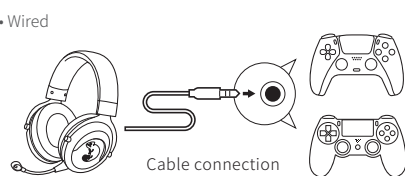

### Headset connection to NINTENDO Switch

#### • Wireless

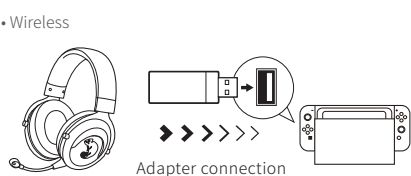

#### • Wired

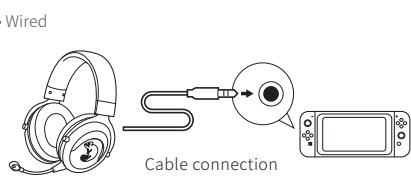

### Headset connection to PC

#### • Wireless

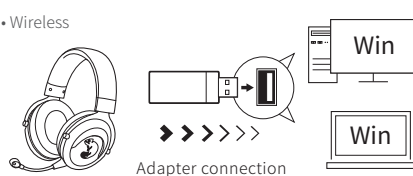

#### • Wired

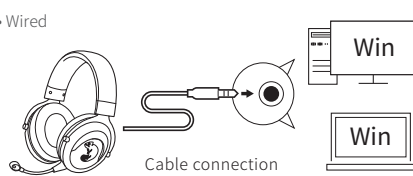

### Headset connection to Mac

#### • Wireless

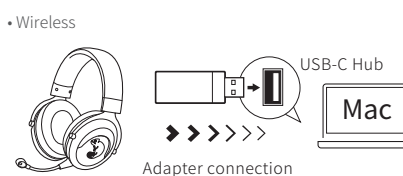

#### NOTE:

- Please fully charge the battery before first use.
- Do not keep the battery in discharged state for a long time, please allow the battery to retain some power to extend battery life.
- Please unplug the USB charging cable immediately after the headset is fully charged.
- Please put the headset at room temperature
- When the first time use, turn the volume down as low as possible. Then turn it up again.

### FCC Compliance statement:

This device complies with part 15 of the FCC Rules. Operation is subject to the following two conditions:

- ① This device may not cause harmful interference, and
- ② this device must accept any interference received, including interference that may cause undesired operation.

### FCC Compliance statement:

This equipment has been tested and found to comply with the limits for a Class B digital device, pursuant to Part 15 of the FCC Rules. These limits are designed to provide reasonable protection against harmful interference in a residential installation.

This equipment generates, uses and can radiate radio frequency energy and, if not installed and used in accordance with the instructions, may cause harmful interference to radio communications.

However, there is no guarantee that interference will not occur in a particular installation. If this equipment does cause harmful interference to radio or television reception, which can be determined by turning the equipment off and on, the user is encouraged to try to correct the interference by one or more of the following measures:

- Reorient or relocate the receiving antenna.
- Increase the separation between the equipment and receiver.
- Connect the equipment into an outlet on a circuit different from that to which the receiver is connected.
- Consult the dealer or an experienced radio/TV technician for help.

Warning: Changes or modifications to this unit not expressly approved by the part responsible for compliance could void the user's authority to operate the equipment.

FCC Radiation Exposure Statement  
The device has been evaluated to meet general RF exposure requirement.

The device can be used in portable exposure condition without restriction.

P/N: Brook Wireless Headset  
M/N: ZPP0061

### 產品概述

本產品 2.4G 無線耳機的特點包含低延遲、Hi-Fi 音質、立體聲輸出等，適合玩遊戲、聽音樂或其他娛樂等多用途。相容 PS5、PS4、Nintendo Switch 等遊戲主機，以及 PC、Mac 等電腦主機。

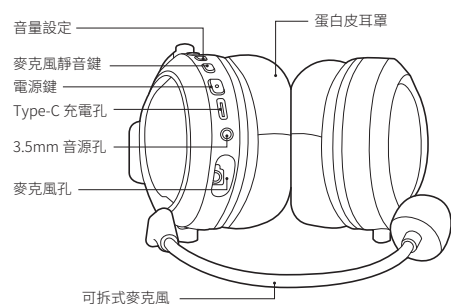

### 電源鍵開關

按下電源鍵約 3 秒直到聽到「逼」一聲，15分鐘不使用本產品將會自動關機。

### 配對

按住麥克風靜音鍵持續 5 秒鐘，直到聽到嗶聲即完成配對。按下按鈕一次，麥克風將靜音。配對一次後，耳機一開機即自動配對，無需再次重新配對。※ 本款耳機可使用隨附的 3.5 mm 音源線作為有線耳機，須注意麥克風在此狀態下不起作用。

### LED ON / OFF

發射器 LED	耳機	2.4G Wireless Adapter
藍燈快速閃爍	耳機未連接到發射器	—
藍燈慢速閃爍	電量不足	—
紅燈長亮	充電中	耳機成功連接到發射器
紅燈熄滅	充滿電力已滿	—

### 耳機連接 PS5 / PS4 遊戲主機

#### • 無線

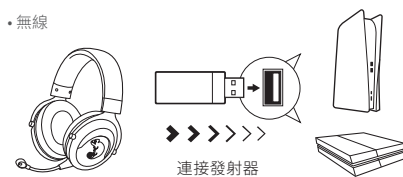

#### • 有線

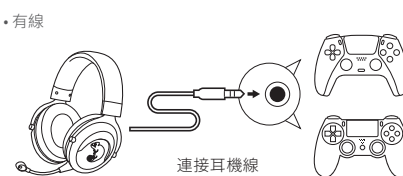

### 耳機連接任天堂 Switch 遊戲主機

#### • 無線

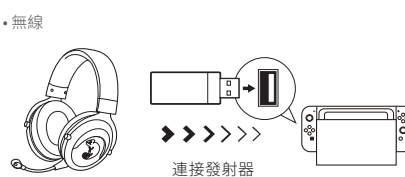

#### • 有線

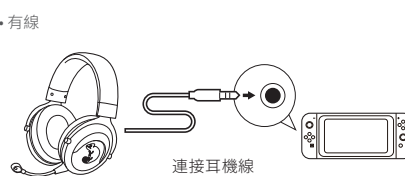

### 耳機連接 PC 電腦主機

#### • 無線

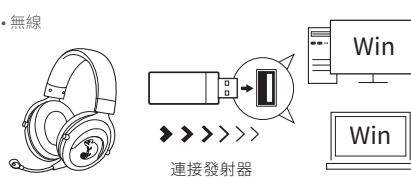

#### • 有線

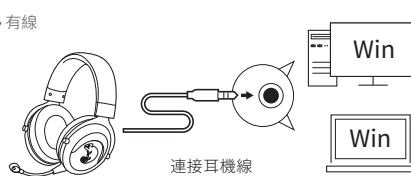

### 耳機連接 Mac 電腦主機

#### • 無線

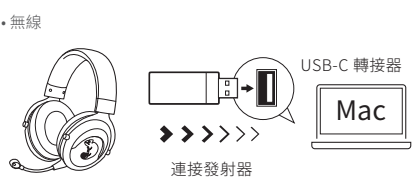

#### 重要事項:

- 首次使用前請先將電池充滿電
- 勿讓電池長期保持完全放電狀態，請讓電池保留部分電量以延長電池續航時間
- 耳機充滿電後請立即拔掉 USB 充電線
- 請將耳機放置在室溫環境中
- 剛開始使用耳機時，盡可能將音量調至最低，然後再調高

### 低功率電波輻射性電機管理辦法

#### ※第十二條

經型式認證合格之低功率射頻電機，非經許可，公司、商號或使用者均不得擅自變更頻率、加大功率或變更原設計之特性及功能。

#### ※第十四條

低功率射頻電機之使用不得影響飛航安全及干擾合法通信；經發現有干擾現象時，應立即停用，並改善至無干擾時方得繼續使用。

前項合法通信，指依電信法規定作業之無線電通信。低功率射頻電機須忍受合法通信或工業、科學及醫療用電波輻射性電機設備之干擾。

360mm

製品概要

本製品は、低遅延、高音質Hi-Fi、ステレオ出力が特長の2.4Gワイヤレスヘッドセットです。ゲームプレイや音楽のリスニング、その他のエンターテインメント用途に適しています。PS5、PS4、Nintendo Switchゲーム機、PC、Macに対応しています。

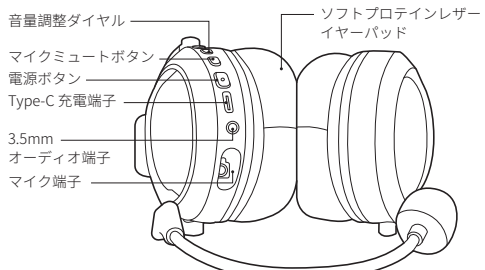

電源のON / OFF

電源ボタンを「ピー」と音がするまで3秒間長押しします。15分間使用しない場合は、自動的に電源が切れます。

ペアリング

マイクミュートボタンを5秒間、ピー音がするまで長押しするとペアリングされます。ボタンを1回押しと、マイクがミュートされます。一度ペアリングすると、その後はヘッドセットの電源を入れたときに自動的にペアリングされるため、再度ペアリングする必要はありません。  
※付属の3.5mmヘッドセットケーブルを使用し、有線ヘッドセットとして使用することができますが、この状態ではマイクが作動しませんのでご注意ください。

LEDのON / OFF

アダプター LED	ヘッドセット	2.4Gワイヤレスアダプター
青色 すばやく点滅	アダプターに接続されていません	—
青色 ゆっくり点滅	バッテリー残容量：低	—
赤色 点灯	充電中	接続完了
LED 消灯	充電完了	—

PS5 / PS4とヘッドセットの接続

•ワイヤレス

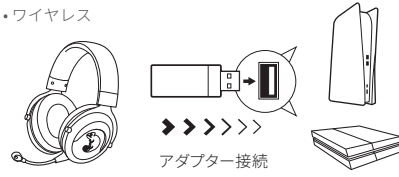

•有線

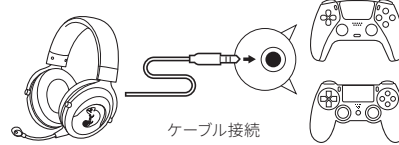

NINTENDO Switchとヘッドセットの接続

•ワイヤレス

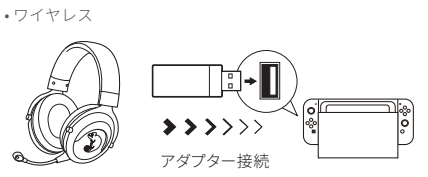

•有線

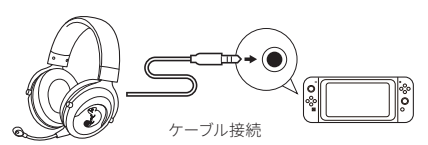

PCとヘッドセットの接続

•ワイヤレス

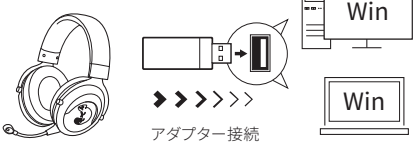

•有線

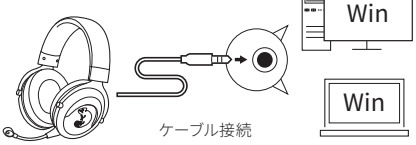

Macとヘッドセットの接続

•ワイヤレス

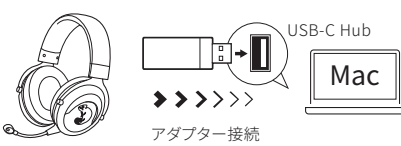

ご注意:

- 初めて使用する際は、完全に充電してからお使いください。
- 放電状態での長期放置はしないでください。バッテリーを使い切った状態のまま放置すると、バッテリーの劣化につながります。バッテリー残量は、ある程度残しておいてください。
- ヘッドセットが完全に充電された後は、すぐにUSB充電ケーブルを抜いてください。
- ヘッドセットは常温で保管してください。
- ヘッドセットを初めて使用する際は、装着の前に音量を下げてからお使いください。装着後、音量を少しずつ上げて調節してください。

製品 개요

2.4G 무선 헤드셋은 적은 대기 시간, Hi-Fi 사운드 품질 및 스테레오 출력 기능을 가집니다. 이 헤드셋은 게임 플레이하거나 음악 및 다른 엔터테인먼트 용도로 사용하기에 적합합니다. 이 제품은 PS5, PS4, Nintendo Switch 콘솔, PC 및 Mac과 호환됩니다.

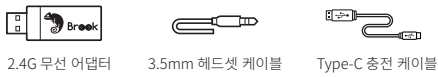
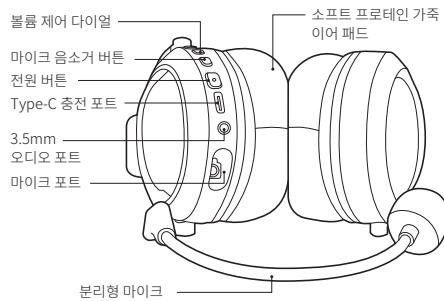

전원 켜기/끄기

경고음이 들릴 때까지 전원 버튼을 3초 동안 누르십시오. 15분 동안 제품을 사용하지 않으면 전원이 자동으로 종료됩니다.

페어링

경고음이 들릴 때까지 마이크 음소거 버튼을 5초 동안 누르십시오. 버튼을 한 번 누르면 마이크가 음소거됩니다. 페어링이 한 번 되면 헤드셋을 켤 때 자동으로 페어링되고 다시 페어링할 필요가 없습니다.  
※ 헤드셋에 포함된 3.5mm 오디오 케이블을 사용하여 유선 헤드셋으로 사용할 수 있습니다. 이 구성에서는 마이크가 작동하지 않습니다.

LED 켜기/끄기

어댑터 LED	헤드셋	2.4G 무선 어댑터
파란빛이 빠르게 깜박임	어댑터에 연결 안 됨	—
파란빛이 느리게 깜박임	배터리가 부족함	—
빨간빛이 계속 켜짐	충전 중	성공적으로 연결됨
LED 꺼짐	완전히 충전됨	—

PS5 / PS4에 헤드셋 연결

•무선

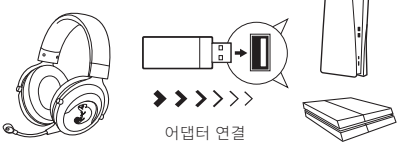

•유선

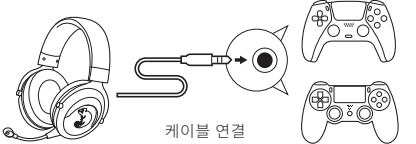

NINTENDO Switch에 헤드셋 연결

•무선

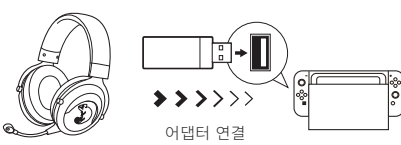

•유선

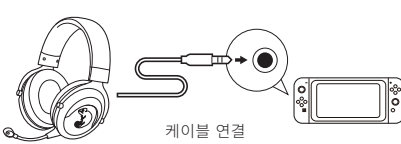

PC에 헤드셋 연결

•무선

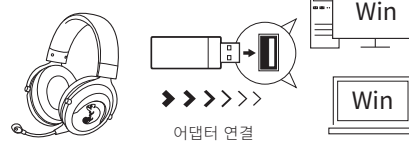

•유선

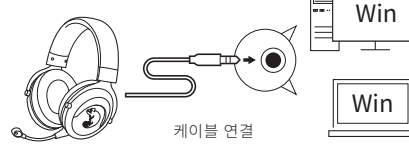

Mac에 헤드셋 연결

•무선

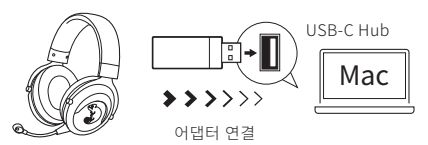

참고:

- 배터리는 처음 사용하기 전에 완전히 충전하십시오.
- 배터리를 방전 상태로 오래 두지 마시고, 배터리 수명 연장을 위해 배터리에 일부 전력이 남아 있도록 하십시오.
- 헤드셋이 완전히 충전되면 USB 충전 케이블을 즉시 분리하십시오.
- 헤드셋은 방 온도 상태로 보관하십시오.
- 처음 사용할 때는 볼륨을 가능한 가장 작게 낮추십시오. 그런 다음 다시 높이십시오.