

FCC ID : 2ADK3X0-9860

Wireless Charging Stand and Bluetooth Speaker

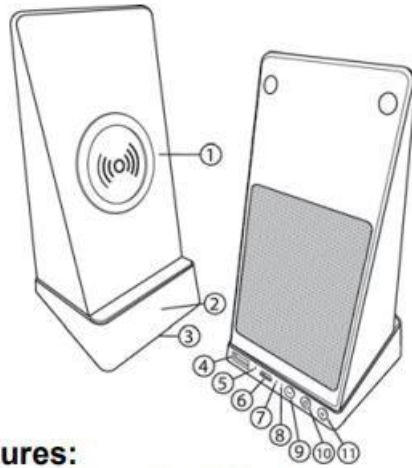

Features:

1. Wireless Charging Surface
2. Wireless Charging ON/OFF Touch Panel
3. Wireless Charging LED Indicator
4. USB Output
5. Charging LED Indicator
6. Micro-USB charging port
7. Microphone
8. Bluetooth LED Indicator
9. Vol-/Previous Track
10. ON/OFF Button
11. Vol +/Next Track

What's included:

1pc Bluetooth Speaker with Wireless charger

1pc USB charging cable

1pc manual

Specifications:

*Playing time: up to 5 hours at max volume

*charging time: up to 4 hours

*Pairing name:Weston Speaker

*USB input:5V/2A Max.

*USB output: 5V/2A Max.

*Wireless Charging Output:5V/1A(5W)

Instruction:

(Be sure to fully charge the speaker before using for the first time)

1. Charging the Speaker

*Connect the provided charging cable to a power source and to the Micro USB port on the speaker.

* Red LED flash when the powerbank is being charged by cable, LED turn off when the powerbank is full charged.

2. Bluetooth Setup:

*Press and hold the power button to turn on the speaker, Bluetooth LED will quickly flash Blue

*Turn on the Bluetooth function on mobile device,Select “Weston Speaker”pairing name .LED will turn solid blue if successfully paired.

*Speaker will auto-pair if the mobile device has been paired before.

*Press and hold the speaker on/off button to turn off the device.

3. Using the Speaker

When receiving a phone call, the speaker will pause the current audio. Press the Play/Pause

/Power /Phone button to answer the call,press this button again to end the call.Long press to reject the call.

“Vol+/Next track”:

Long press - next track.

Short press - increase volume.

“Vol-/Previous track”:

Long press - previous track

Short press - reduce volume

4. Charging mobile phones and other electronic devices:

*Connect the charging cable to your mobile phone/device using the appropriate connector. Connect the USB part of the cable into USB Output LED indicator will illuminate BLUE when charging.

*Remove the USB cable from your mobile device when it is fully charged.

5. Wireless Charging Function:

*Touch the speaker front panel for 2s to turn on the wireless charging function, the speaker bottom LED will light Solid Blue.

1) if don't put the phone on the pad, the blue LED will turn off after 15s, the LED will flash once/10s, then the LED will totally turn off after 60s, that means the wireless charger is power off. Within 60 seconds.

2) if put a phone on the charging pad, solid Blue LED will keep light on. After turn on the wireless charging function, if don't put a phone on the charging pad within 60s, need touch the panel to turn on this function again.

*Touch the speaker front panel for 2s again to turn on the wireless charging function

Warning:

This device complies with Part 15 of the FCC Rules. Operation is subject to the following two conditions:

this device may not cause harmful interference, and

this device must accept any interference received, including interference that may cause undesired operation.

Any Changes or modifications not expressly approved by the party responsible for compliance could void the user's authority to operate the equipment.

FCC RF Radiation Exposure Statement:

1. This Transmitter must not be co-located or operating in conjunction with any other antenna or transmitter.

2. This equipment complies with RF radiation exposure limits set forth for an uncontrolled environment.