

SIZE:165\*90MM

## Wooden Bluetooth Speaker w/Wireless Charging Pad

### Instruction Manual

7197-05

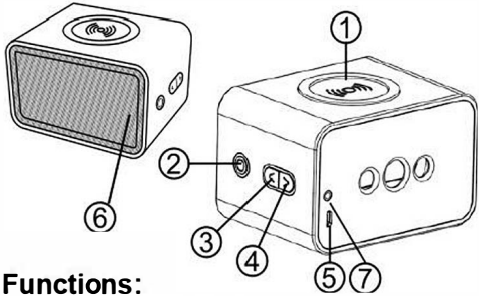

#### Functions:

1. Wireless Charging Pad
2. Play/Pause/Power Button
3. Vol-/Previous Track
4. Vol +/Next Track
5. Micro-USB charging port
6. Microphone
7. 3.5mm Aux Input

#### What's included:

- 1 x Bluetooth® Speaker (7197-05)
- 1 x USB to Micro-USB Charging Cable
- 1 x Instruction Manual

#### Tech Specifications

- Playing time: up to 6 hrs at max volume
- Charging time: up to 3 hrs
- Pairing Name: "Wooden Speaker"

#### Instructions:

(Be sure to fully charge the speaker before using for the first time).

##### 1. Charging the Speaker

- Connect the provided charging cable to a power source and to the micro USB port on

the speaker (5).

*The LED indicator light will glow red when charging and turn off when fully charged.*

##### 2. Wireless Charging:

- Speaker will need connected with the provided 2A micro-USB cable and a 2A outlet adapter (not included) to a power source and to the micro USB port on the speaker(5).
- Place wireless charging supported mobile device on top of the wireless charging pad.
- Phone will begin to charge automatically.
- LED indicator will turn RED when charging.

##### 3. Bluetooth® Setup:

- Press and hold power button to turn ON the speaker, LED Indicator will flash BLUE when in pairing mode.
- Turn on the Bluetooth function on mobile device, Select "Wooden Speaker" pairing name.
- \* LED will turn solid BLUE if successfully paired
- *Speaker will automatically pair if the mobile device has been paired before.*

##### 4. Playing Music:

- Short press "Power Button" key to pause music. A second short press will resume playing music again.
- Long press "Previous track/Vol-", the speaker will play the previous track.
- Short press to reduce speaker volume.
- Long press "Vol+/Previous Track", the speaker will play the next track.
- Short press to increase speaker volume.

##### 5. Call Function:

- Short press "Power Button" to answer a incoming call, press again to end call.
- Double press to reject the call.

#### SAFETY PRECAUTIONS:

- WARNING-When using this product, basic precautions should always be followed:
1. Read all the instructions before use.
  2. Never store or use this product in temperatures below 32°F (0°C) or above 115°F (45°C).
  3. Do not overcharge your phone. The unit may become hot under excessive use. Remove your phone once it is fully charged. Never charge your phone for more than 7 hours at a time.
  4. The unit will only achieve full performance after 2 or 3 completed charge and discharge cycles.
  5. To reduce the risk of injury, close supervision is required when the product is used near children.
  6. Do not expose the device to moisture.
  7. Do not use the device in excess of its output rating. Overload outputs above the rating may result in a risk of fire or injury.
  8. Do not use the device if damaged or modified.
  9. Damaged or modified batteries may exhibit unpredictable behaviour resulting in fire, explosion or risk of injury.
  10. Do not disassemble the device. For repairs, seek a qualified service professional. Incorrect reassembly may result in a risk of fire or injury.
  11. Do not expose the device to fire or excessive temperatures. Exposure to fire or temperatures above 104°F (40°C) may result in explosion.
  12. To ensure product safety, ensure that qualified service professionals use only identical replacement parts.
  13. Attachments on the back of your phone

can impede the effectiveness of the wireless charger, and lead to overheating. Please remove attachments from the phone before charging on this device.

#### FCC Statement:

This device complies with Part 15 of the FCC Rules. Operation is subject to the following two conditions:

- (1) This device may not cause harmful interference, and
- (2) This device must accept any interference received, including interference that may cause undesired operation.

#### \* Warning:

Changes or modifications not expressly approved by the party responsible for compliance could void the user's authority to operate the equipment.

This device complies with Part 18 of the FCC Rules. This equipment generates uses and can radiate radio frequency energy and, if not installed and used in accordance with the instructions, may cause harmful interference to radio communications. If this equipment does cause harmful interference to radio or television reception, which can be determined by turning the equipment off and on, the user is encouraged to try to correct the interference by one or more of the following measures:

- Increase the separation between the equipment and any other radio device.
- Connect the equipment into an outlet on a circuit different from that to which the receiver is connected.
- 



MADE IN CHINA