

#### CHARGING CASE

Charging time: ~2.5 hours  
Input: 5V == 0.5A  
Output: 5V == 0.2A  
Rechargeable Li-ion battery: 400mAh

FCC ID: 2ADH6-1909033L  
FCC ID: 2ADH6-1909033R

#### Federal Communications Commission (FCC) Statement

This device complies with part 15 of the FCC Rules. Operation is subject to the following two conditions:

- (1) This device may not cause harmful interference, and
- (2) this device must accept any interference received, including interference that may cause undesired operation.

Note: This equipment has been tested and found to comply with the limits for a Class B digital device, pursuant to part 15 of the FCC Rules. These limits are designed to provide reasonable protection against harmful interference in a residential installation. This equipment generates, uses and can radiate radio frequency energy and, if not installed and used in accordance with the instructions, may cause harmful interference to radio communications. However, there is no guarantee that interference will not occur in a particular installation. If this equipment does cause harmful interference to radio or television reception, which can be determined by turning the equipment off and on, the user is encouraged to try to correct the interference by one or more of the following measures:

- Reorient or relocate the receiving antenna.
- Increase the separation between the equipment and receiver.
- Connect the equipment into an outlet on a circuit different from that to which the receiver is connected.
- Consult the dealer or an experienced radio/TV technician for help.

Warning: Changes or modifications made to this device not expressly approved by the party responsible for compliance may void the FCC authorization to operate this device.

Note: The manufacturer is not responsible for any radio or TV interference caused by unauthorized modifications to this equipment. Such modifications could void the user's authority to operate the equipment.

#### RF exposure statement:

This device complies with FCC RF radiation exposure limits set forth for an uncontrolled environment. The device is installed and operated without restriction.

#### IMPORTANT SAFETY INSTRUCTIONS FOR ALL RECHARGEABLE BATTERIES

The battery is not fully charged upon purchase. Before using the earbuds, read the safety instructions below and then follow the charging procedures outlined.

#### READ ALL INSTRUCTIONS

Earbuds are splash and sweat resistant with a rating of IPX4 under IEC standard 60529.

Splash and sweat resistance are not permanent conditions and resistance might decrease as a result of normal wear and tear. Do not try to charge wet earbuds.

The charge case does not have any IP rating.

Liquid damage is not covered under warranty. Do not incinerate the battery module even if it is severely damaged or is completely worn out. The battery can explode in a fire. Toxic fumes and materials are created when lithium batteries are burned.

If battery contents come into contact with the skin, immediately wash area with mild soap and water. If battery liquid gets into the eye, rinse attention is needed, the battery electrolyte is composed of a mixture of liquid organic carbonates and lithium salts.

Contents of opened battery cells may cause respiratory irritation. Provide fresh air. If symptoms persist, seek medical attention.

**DO NOT** charge or use the battery in explosive atmospheres, such as in the presence of flammable liquids, gases or dust.

**DO NOT** modify the battery in any way to fit a non-compatible charger as the battery may rupture causing serious personal injury.

**DO NOT** splash or immerse in water or other liquids.

**DO NOT** store or use the earbuds in locations where the temperature may reach or exceed 105° F (40° C) (such as outside sheds or metal buildings in summer). For best life, store earbuds in a cool, dry location. The True Wireless Earbuds should not be disposed of as municipal solid waste. To recycle it, contact your local hazardous waste processor or contact Call 2 Recycle® on their website, call2recycle.org, or by phone at 877-273-2925 to find the nearest drop-off location for lithium-polymer batteries.

**⚠WARNING:** Burn hazard. Battery liquid may be flammable if exposed to spark or flame.

**⚠WARNING:** Fire hazard. Never attempt to open the battery pack for any reason. If the battery pack is cracked or damaged, do not insert the charging cable. Do not crush, drop or damage the battery. Do not use the earphones if they have received a sharp blow, been dropped, run over or damaged in any way (e.g. pierced with a nail, hit with a hammer, stepped on).

**Damaged batteries should be returned to a service center for recycling.**

## GUARANTEED FOR LIFE

E-filliate warrants to the consumer that the product and all accessories provided in the sales package ("Product") are free from material defects in material and workmanship when used normally and in accordance with operation instructions. E-filliate will repair or replace (at E-filliate's option), without charge, a Materially Defective Product. If we repair or replace a Materially Defective Product under the terms of this warranty, this warranty also applies to repaired or replacement Products. If we repair this Product, we may use new or refurbished replacement parts. If we choose to replace this Product, we may replace it with a new or refurbished Product of the same or similar design. E-filliate will return repaired or replacement Products to you in working condition. We will retain defective parts, or equipment. Repair or replacement of Product is your exclusive remedy.

This warranty does not cover Product that has been subjected to misuse, accident, shipping or other physical damage, improper installation, abnormal operation or handling, neglect, inundation, fire, water or other liquid intrusion, or Product that has been damaged due to repair, alteration or modification by anyone other than an E-filliate authorized representative.

## Customer Service:

We're here to help. If you are not fully satisfied with this product or have questions on how to use it, please contact E-filliate Inc. You do not need to contact the retailer from whom the product was purchased. Please contact one of our service representatives before shipping merchandise to us.

[www.efilliate.com](http://www.efilliate.com)

[support@efilliate.com](mailto:support@efilliate.com)

(800) 592-7031 toll-free

(916) 858-1000

(916) 858-1009 FAX

11321 White Rock Road  
Rancho Cordova, CA 95742 USA

Customer service representatives are available 8 a.m.-5 p.m. PT, M-F

## Instruction Manual

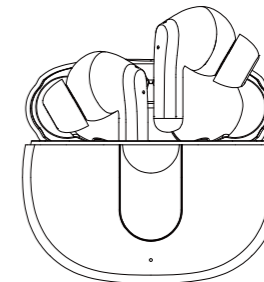

# G7 TWS with Charging Case and Active Noise Cancellation

### Package Contents

- True Wireless Earbuds - Left and Right
- Ear Cushions - 3 Pairs
- Charging Case
- User Manual
- Type C Charging Cable

Item No: 190 9033

Opacity: 30%

Thank you for purchasing the **True Wireless Earbuds with Charging Case**.  
With this wireless headset, you can:

- Enjoy convenient, hands-free calls
- Control wireless music
- Switch between calls and music

## Components at a Glance

### TRUE WIRELESS EARBUDS:

- 1 Microphone
- 2 Touch Pad
- 3 LED Indicator (Earbud)

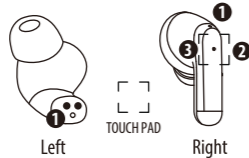

### CHARGING CASE:

- 1 Charging Case
- 2 Battery Light Indicator
- 3 Type C Charge Port
- 4 Reset Button

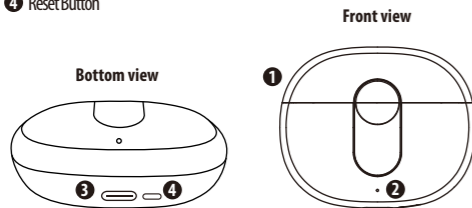

### EARBUD CUSHIONS:

3 Sizes of Cushions:  
Small, Medium & Large

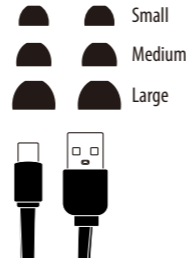

## How To Connect

Open the case to enter pairing mode.

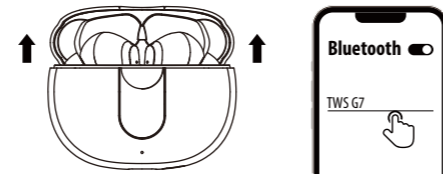

## Power On/Off

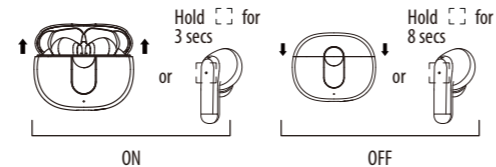

## Music Control



Transparency Mode On = Hold [ ] for 2 secs ←  
ANC On = Hold [ ] for 2 secs → ANC Off = Hold [ ] for 2 secs

## Calling Controls

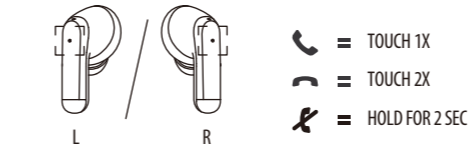

## Reset Button Function

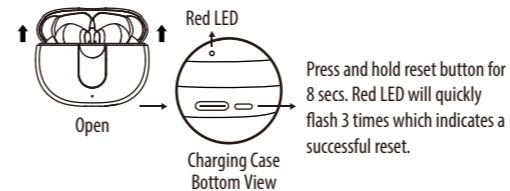

## Charging

### Earbuds

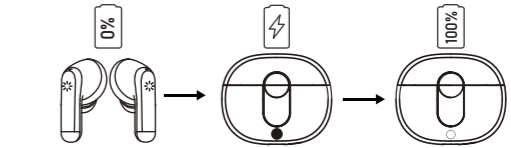

### Case

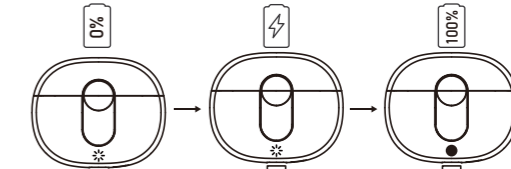

### TECHNICAL DATA EARBUDS

Supported audio: SBC  
Input: 5V == 0.1A  
Music time: Up to 7 hours per charge (Total up to 30 hours with charging case and ANC off)  
Charging time: ~1.5 hour  
Rechargeable lithium-ion battery: 40mAh on each earpiece  
Frequency band: 2.4 GHz ISM Band  
Operating range: Up to 10 meters (33 feet)

Federal Communications Commission (FCC) Statement. This device complies with part 15 of the FCC Rules. Operation is subject to the following two conditions:

- (1) This device may not cause harmful interference, and
- (2) this device must accept any interference received,

including interference that may cause undesired operation. Note: This equipment has been tested and found to comply with the limits for a Class B digital device, pursuant to part 15 of the FCC Rules. These limits are designed to provide Reasonable protection against harmful interference in a residential installation. This equipment generates, uses and can radiate radio frequency energy and, if not installed and used in accordance with the instructions, may cause harmful interference to radio communications. However, there is no guarantee that interference will not occur in a particular installation. If this equipment does cause harmful interference to radio or television reception, which can be determined by turning the equipment off and on, the user is encouraged to try to correct the interference by one or more of the following measures:

- Reorient or relocate the receiving antenna.
- Increase the separation between the equipment and receiver.
- Connect the equipment into an outlet on a circuit different from that to which the receiver is connected.
- Consult the dealer or an experienced radio/TV technician for help.

Warning: Changes or modifications made to this device not expressly approved by E-filiate Incorporated may void the FCC authorization to operate this device. Note: The manufacturer is not responsible for any radio or TV interference caused by unauthorized modifications to this equipment. Such modifications could void the user's authority to operate the equipment.

**RF exposure statement:**

This device complies with FCC RF radiation exposure limits set forth for an uncontrolled environment. The device is installed and operated without restriction.