

QuattroPod

Quick Start Guide 快速啟用手冊 クイックスタートガイド

V.1.0

What's in the box? 包裝內容/パッケージ内容

Standard Package/標準包裝/標準パッケージング

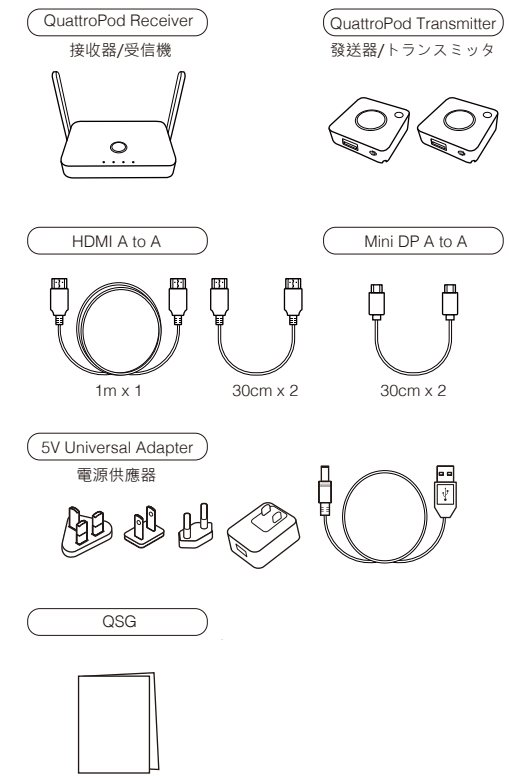

Deluxe Package/豪華套裝/高級スーツ

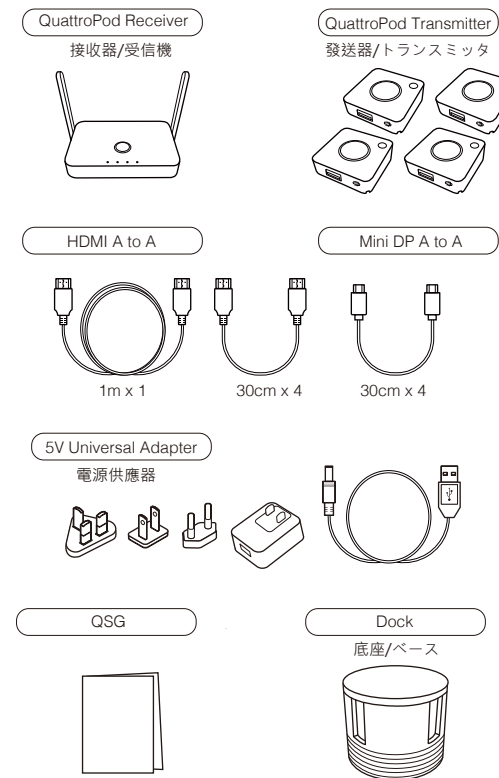

QuattroPod Receiver/接收器/受信機

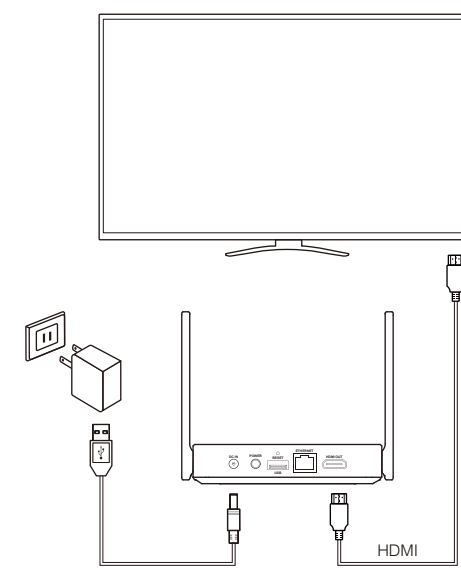

Transmitter Operation 發送器操作 トランスミッタの動作

Transmitter/發送器/トランスミッタ		
Main button(Mirror button) 主按鍵(投影按鍵) メインボタン(投影ボタン)	Host 主持人 ホスト	Guest 訪客 訪問者
Single click 單按 シングルクリック	Mirror/Disconnect 投影/斷開 プロジェクション/断断する	Send mirror request 發送投影要求 キャスト要求を送信する
Hold for 3 seconds 長按3秒 長押し3秒	Full screen mirror 全螢幕投影 全画面投影	Send full screen mirror request 發送全螢幕投影要求 キャストを送信する
Side button(Control button) 側按鍵(控制按鍵) サイドボタン(コントロールボタン)	Host 主持人 ホスト	Guest 訪客 訪問者
Single click 單按 シングルクリック	Allow guest to mirror 允許訪客投影 訪問者にプロジェクトを許可する	—
Double click 雙按 ダブルクリック	Deny request 拒絕訪客投影 要求を拒否する	—
Hold for 3 seconds 長按3秒 長押し3秒	Quit all display 退出全部投影 すべての表示を終了する	—

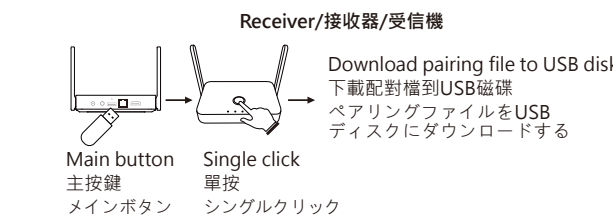

LED Status list

- Enable Guest w/o source input. ソース入力なしでゲストを有効にする。訪客角色但未右有投影源接上。
- Enable Host w/o source input. ソースなしでホストを有効にする。主持人角色但未右有投影源接上。
- Enable Host and casting. ホストとキャストを有効にします。主持人角色並投影中。
- Guest standby w/o casting. キャストなしのゲストスタンバイ。訪客待機中無投影。
- Guest requests casting and wait for allow. ゲストはキャストを要求して許可を待ちます。訪客要求投影並等待許可。
- Enable Guest and casting. ゲストとキャストを有効にする。訪客投影中。
- Transmitter OTA Completed. トランスミッタOTA完了。發送器軟體更新完成。

- Host received request of cast. ホストはキャストのリクエストを受け取りました。主持人收到他方投影要求。
- Host standby w/o casting. キャストなしのホストスタンバイ。主持人待機中無投影。
- 1. Under connection. 接続中・連接中。 2. Pairing/Transmitter OTA download and installation. ペアリング・トランスミッタOTAをダウンロードしてインストールする。 3. Fail to connection(blinking for 1minutes or more). 接続に失敗しました(1分以上点滅) 連接失敗(當閃燈超過一分鐘)
- Pairing done. ペアリングが完了しました。配對完成。
- Transmitter OTA Fail. トランスミッタOTAフェイル。發送器軟體更新失敗。



QuattroPod Transmitter/發送器/トランスミッタ

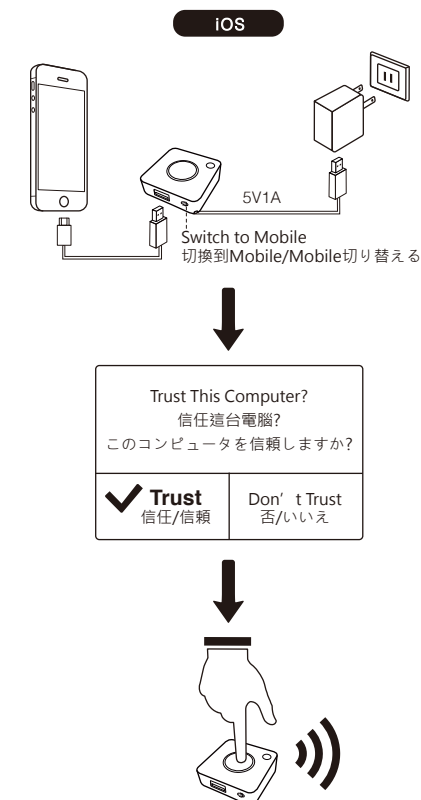
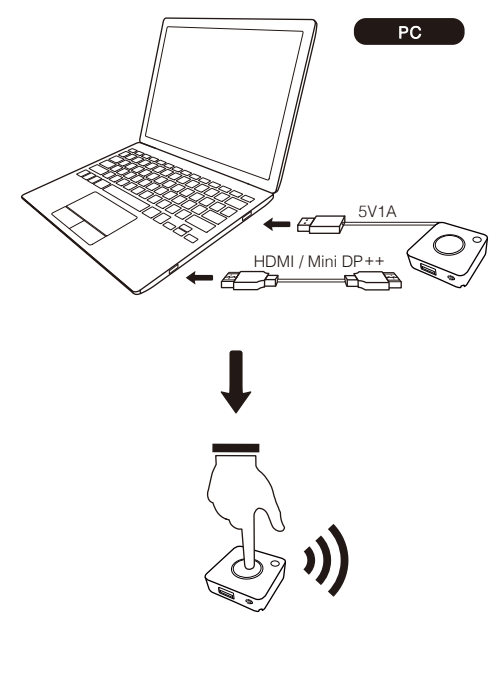

Android

△ Please enable USB Debugging before using.

1. Go to Setting→System→About Phone

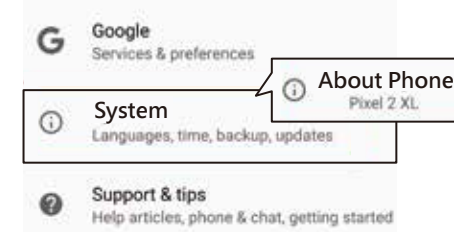

2. Click Build Number for 7 times to enable Developer Option



You are now a developer!

3. Go to Developer option→USB Debugging→On

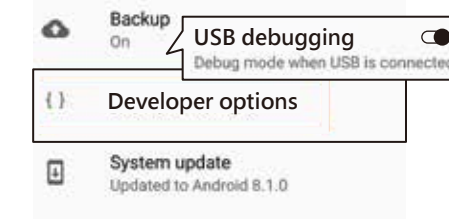

4. Plug to QuattroPod Transmitter and Allow USB debug

*Note: Please select MTP or File Transferring in the notifications when USB is connected.

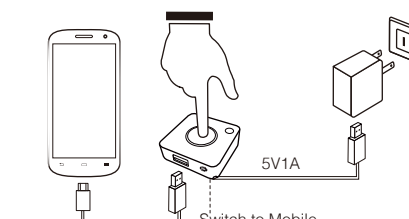

△ 安卓使用者連接前請先啟用USB偵錯

1. 請到設定→系統→關於手機



2. 在版本號碼輕點七下可啟用開發人員選項



你現在已成為開發人員!

3. 進入開發人員選項・啟用USB偵錯



4. 將手機透過USB連接到QuattroPod 發送端並同意USB偵錯

*注意：接上手機後選擇MTP或檔案傳輸模式

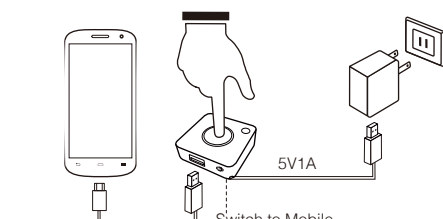

△ USBデバッグを有効にしてから使用してください。

1. 設定→システム→端末情報



2. ビルド番号を7回クリックして、開発者向けオプションを有効にします



これでデベロッパーになりました!

3. 開發者向けオプション→USBデバッグ→オンにする



4. QuattroPodトランスミッタに接続し、USBデバッグを許可する

*通知：USBが接続されている場合、通知でMTPまたはファイル転送を選択してください

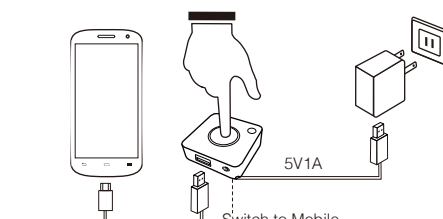

QuattroPod



Quick Start Guide
Rev. 1.055

Introduction

Firstly, thanks for choosing QuattroPod as wireless presentation facility. It integrates powerful dual core SoC and advanced 802.11ac 5G Wi-Fi to provide you a smooth wireless display experience, and it supports almost all devices. Our features not only support "Split Screens Display", "Host Control System" but also let cross platform devices throw the contents in APP-independence. It provides a more friendly and efficient environment for BYOD (Bring Your Own Devices) with wireless projection in legacy/ existing projectors or monitors you have! Enjoy them and help you to achieve more collaboration!

What's in the box?

When you open the box, it contains

- QuattroPod Receiver (hereinafter called Rx) with external antennas, x1
- QuattroPod Transmitter (hereinafter called Tx) with USB cable, x2
- 5V Universal Adapter, x1
- HDMI Cable for Rx, L 100cm, x1
- HDMI Cable for Tx, L 30cm, x1
- DP Cable for Tx, L 30cm, x1
- Quick Start Guide, x1

System Requirement:

-PC: Any PC or laptops with HDMI output or mini DP (DP2.0) output

-Tablet/Smart Phone: iOS 10 above and Android 5.0 above

***Important: Android device must turn ADB mode in advance**

Installation:

QuattroPod RX:

1. Connect Power with the adaptor
2. Connect HDMI with HDMI port with the projectors or displays.

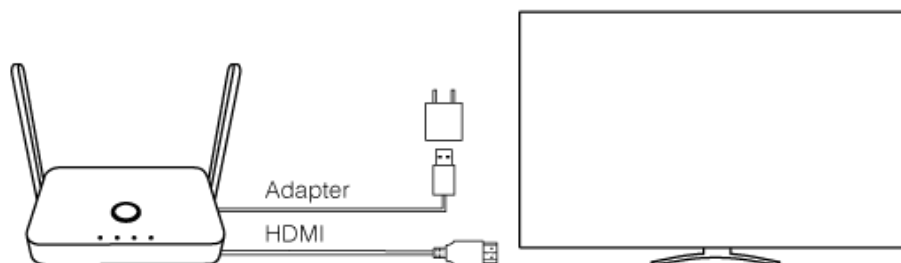

***Notice: Rx is compatible with VESA mounting screw holes. Please use the 5x5 bracket and M4 screws.**

QuattroPod TX:

1. There are 2 ways to supply power to TX.

-Through USB 5V(required 1A at least, through adaptors or USB ports of laptops)

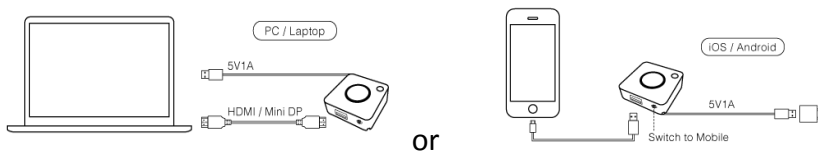

-Through POE (Power over Ethernet): Ethernet switch or router needs to support standard POE (Power over Ethernet) function and keep it active.

- To connect TX with Laptops, to connect HDMI or DP2 ports with proper cables.
To connect TX with Smart phones, to connect USB port with proper cable with phone's connectors such as micro USB, Lighting or USB type C.

I/O Descriptions:

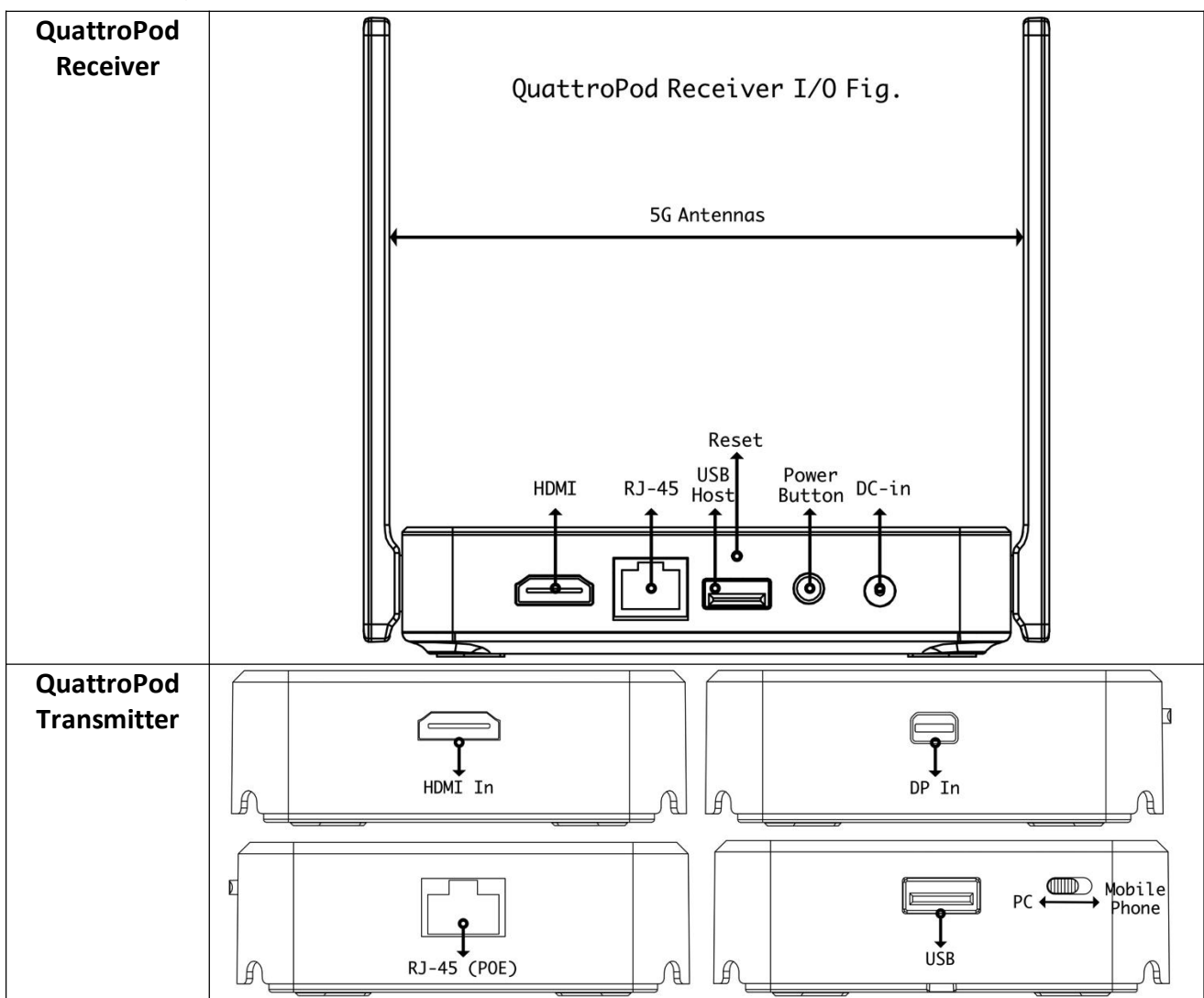

LED Indication:

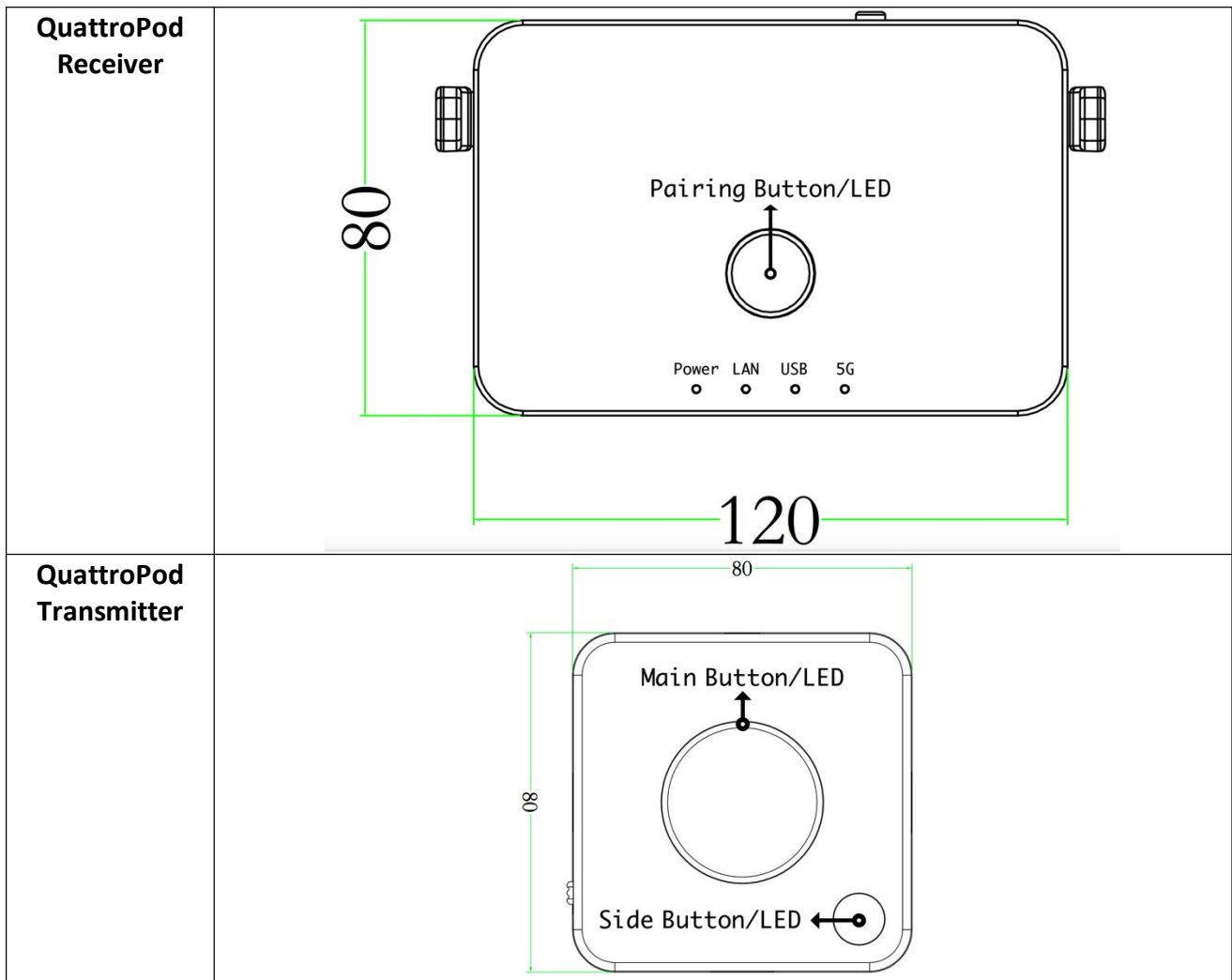

Pairing:

To pair Quattro TX with RX for first time use may be needed. It's suggested if you are not sure QuattroPod TX has ever paired with the Quattro RX you want to cast.

1. Adjust the switch of the side to right .
Plug Quattro TX's USB cable onto Quattro RX's USB port in the rear.
2. The Main LED and Side LED will start blinking while pairing, after pairing is done, the Rx's main LED will turn to White and Tx LED will stop blinking.
3. LED indicator's sequence will be



Notice: when you see main button & side button remain blinking for while , it has 3 possibilities, Upgrading, Pairing, or Error (Disconnecting).

Finger Tips

Before understanding the status of our Quattro, let us introduce the definition of the LED Lights.

There are 2 LED indicators on Quattro RX upside surface. One is in central named Main Button. The smaller button named Side Button.

Main Button indicated the projection status. There are 4 models and meanings are-

- No Light - no Source for projecting
- White Light on - in projecting
- Red Light on - no projecting
- Red Light Blink - ask for projecting or yet connecting to Quattro RX(*)

Side Button indicated the role status, Host or Guest. There are 3 models and meanings are-

- Green Light on - role of Host
- Red Light on - role of Guest
- Red Light Blink - yet connecting to Quattro RX(*)

**** If both Main Button & Side Button are blinking in red simultaneously, which means waiting for connecting to Quattro TX. If it lasts too long, please remove power plug and re-plug again.***

1. Make sure Quattro RX has been turned on and Quattro TX has been paired and well powered.
2. Connect device either Laptop or mobile phones** with powered Quattro TX. The device that is regarded as "Host" should complete connecting to Quattro TX to Quattro RX. The

Quattro TX light will be turn to  and click once, turn to  and Host's content will show on screen.













***** When connect to smart phones, make sure the USB side switch adjust to left.***



TX OTA (Over The Air) Functions-

The TX's Firmware can be updated through connecting to Internet. We provide several ways to activate the OTA procedure,

LED Status list

	Activate Host without source input		Activate Guest without source input	
	Activate Host & in projecting			Host received request of projection
	Guest standby without projecting		Host standby without projecting	
	Guest send request of projection and wait for allow		<ol style="list-style-type: none"> 1. Under connection 2. Pairing/TX OTA 3. Fail to connection (blinking over 1minutes) 	
	Activate Guest & in projecting		Pairing done	
	TX OTA Complete		TX OTA Fail	

When Quattro RX is successfully turned on, below screen will be shown on display-

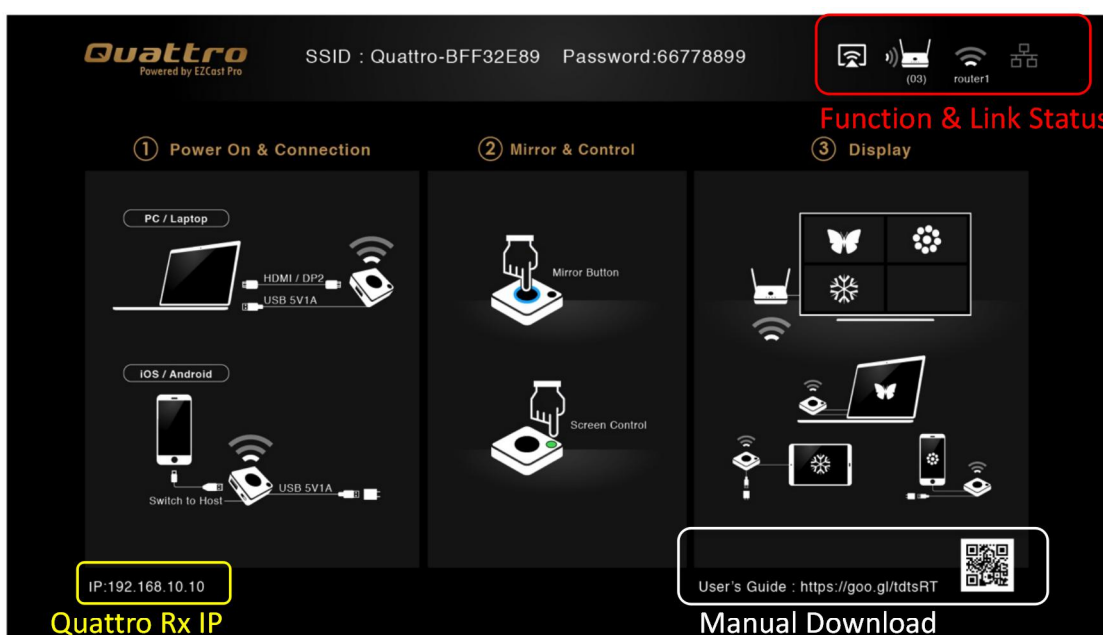

Function & Link Status-

* *Outbound link can select only one of Wi-Fi and RJ45 wire line (LAN).*



Airplay activated after web setting. (Default is off)



Quattro RX has been powered on, however, there is neither Quattro TX nor device linked.



Shift in 3, which means "under pairing" or "building the connection".

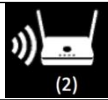

Complete pairing or connection, the number showed total Quattro TX or Device linked.



RJ45 wire line disconnected.



Shift in 3, which means "building the connection".



RJ45 wire line connected and IP acquired



IP conflict or other network error.



Outbound Wi-Fi disconnected.



Shift in 3, outbound Wi-Fi is connecting.



Outbound Wi-Fi connected with the router name shown underline.



Wi-Fi connection Fail, Invalid password or other Errors

Web Setting

Quattro RX IP- when Devices (either laptops or mobile phones) connect with Quattro RX with SSID & Password directly, applying the IP in web browser can enter Admin setting page for more advance setting.

1. Preparation-

To access the setting page, you have to choose either way to connect the devices.

1.1 Direct link- you can apply notebook or mobile phone to search Quattro RX by wifi and key in relative SSID and Password. Turn on web browser and enter “192.168.168.1” in the address bar.

1.2 Through Wifi AP or Routers- if your Quattro RX has been connected to a certain networking device, you can apply notebook or mobile phone to connect the same device. Turn on web browser and enter the address show in mainpage in the Quattro Rx IP shown below.



Once done, the page will show as below-

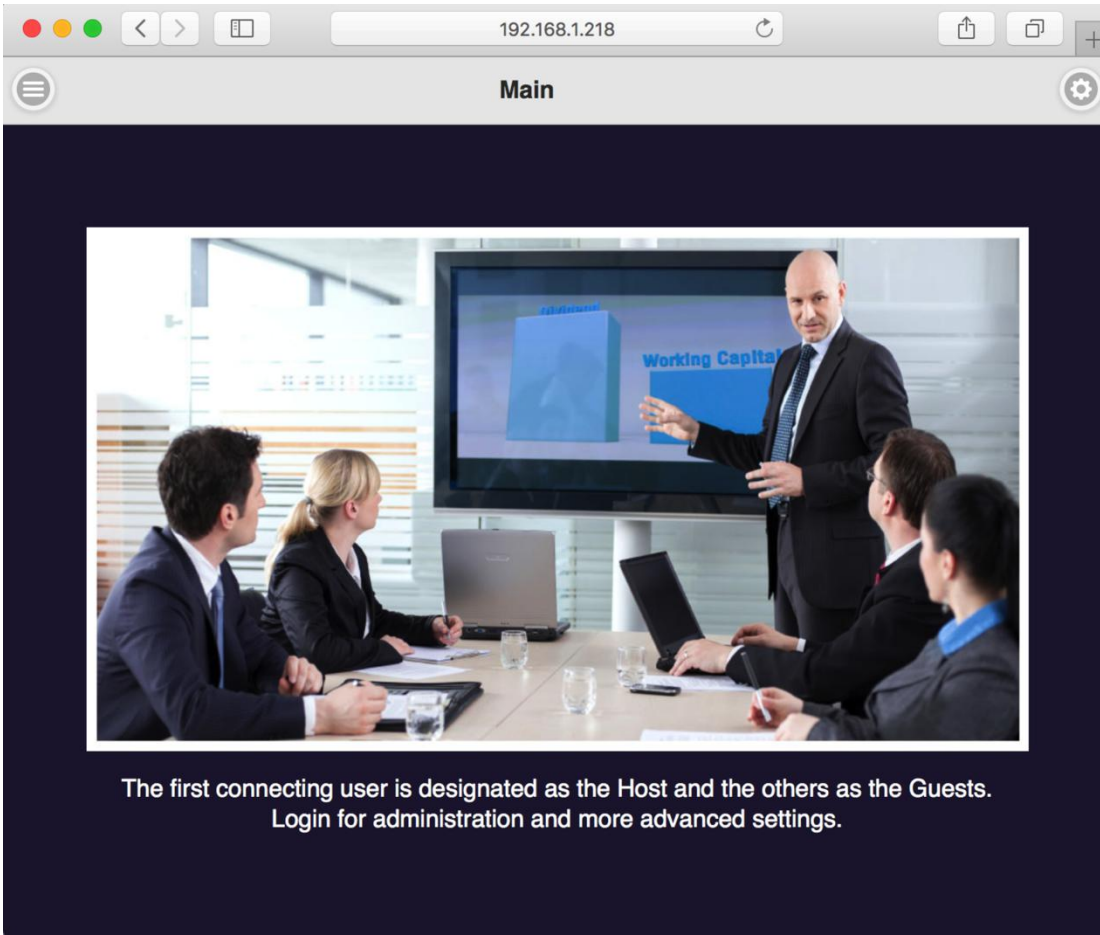

- to indicate menu icon.



- to indicate log-in icon.

2. Log in-

Press the  on the right up corner to log in.

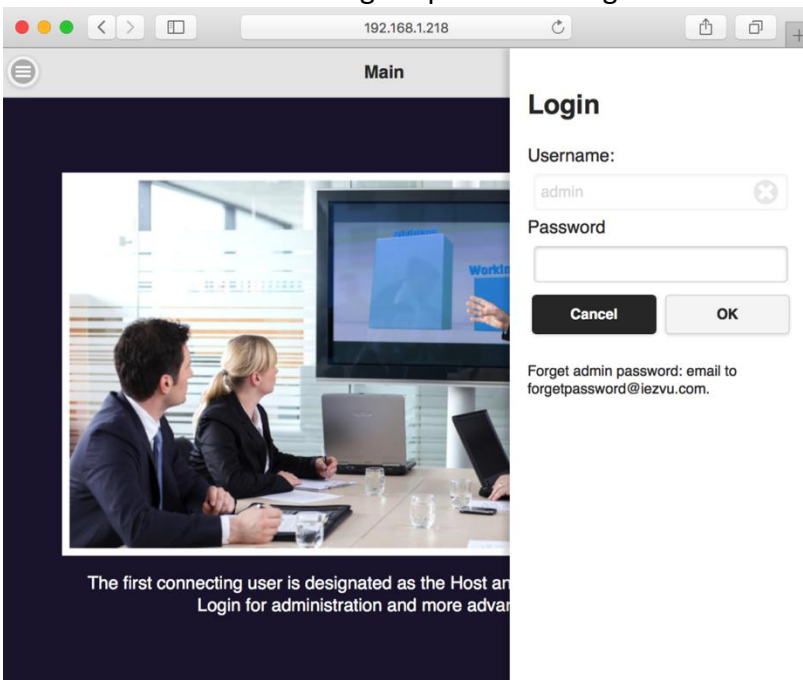

3. Start to set up

- 3.1 Click the menu button on the left up corner and there are drawer show 3 setting functions. They are **Device Management**, **Network Management**, and **Admin Setting**, and **About** which indicates device version, IP addresses and wifi frequency..etc.

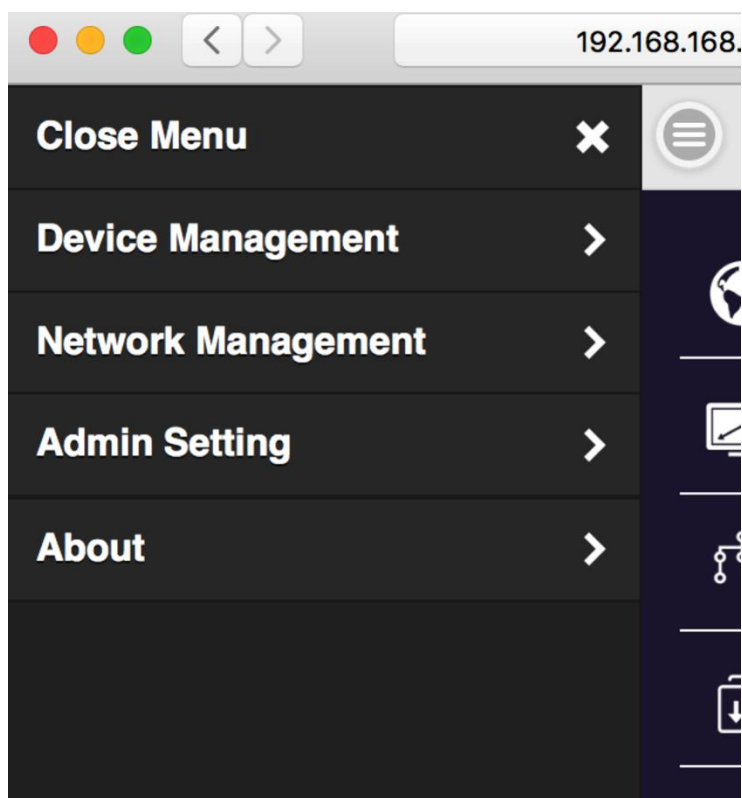

4. Device Management-

This section helps to manage user interface language, output resolutions, Max connection and QuattroPod Receiver & Transmitter pairing file download.

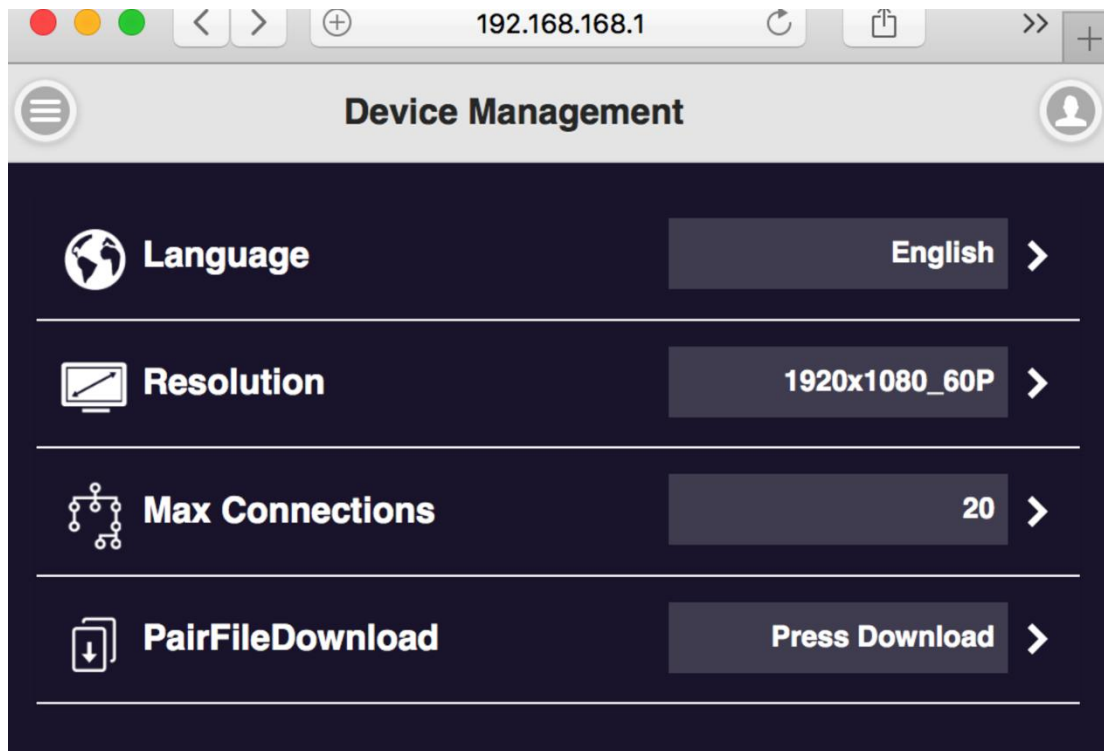

4.1 Language- click it and choose the language you prefer to show in the webpage.

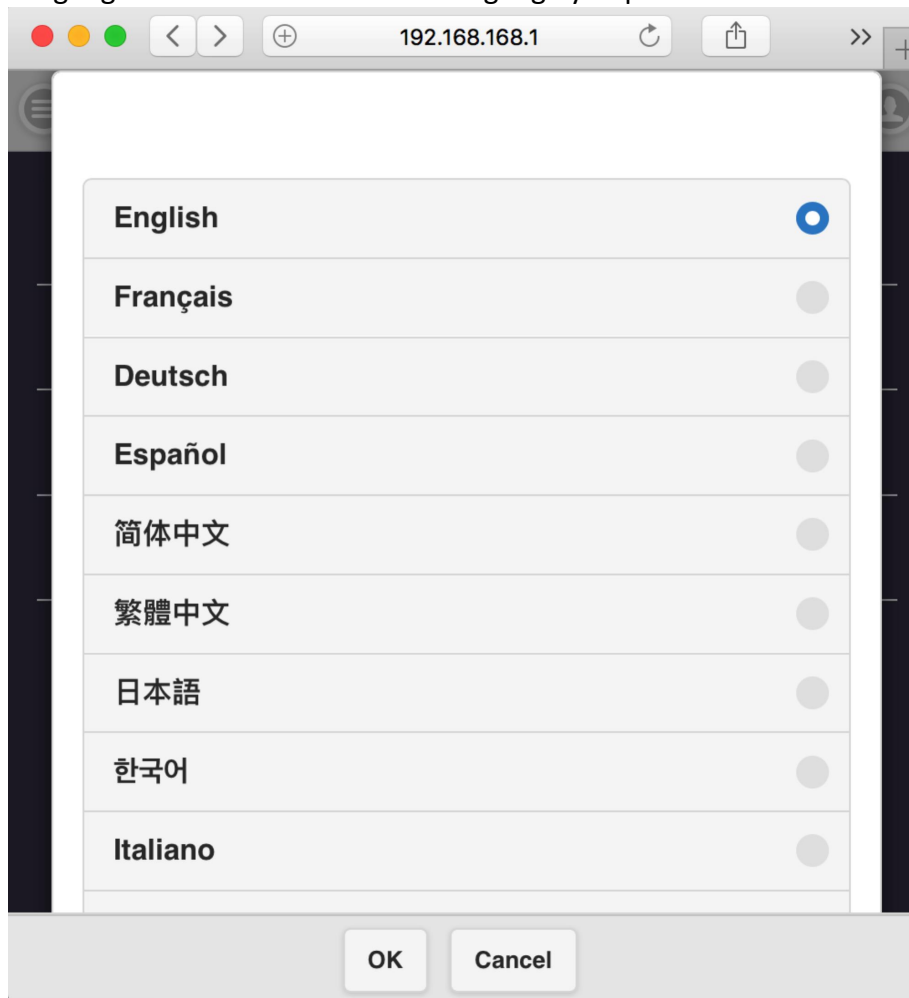

4.2 Resolution-

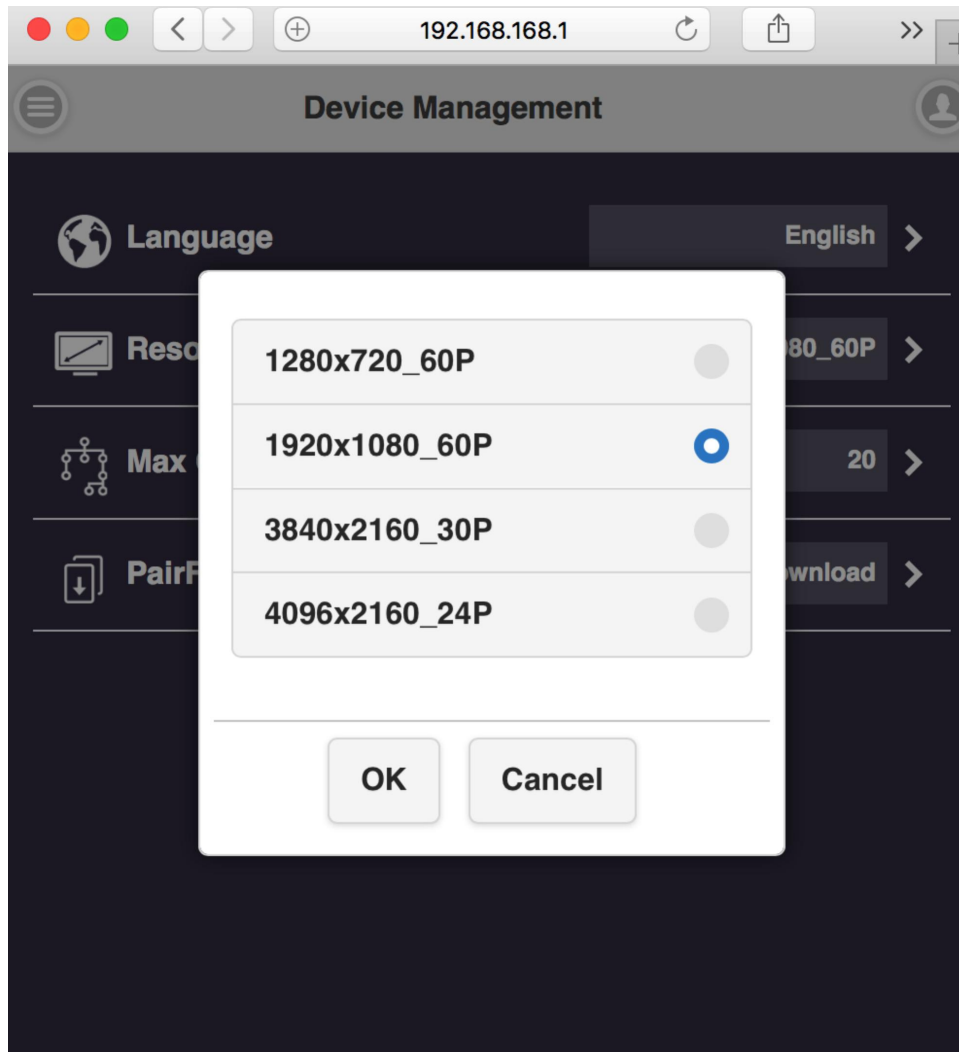

4.3 Max Connection- to set the maximum users of the Receiver. Default is 20 users.

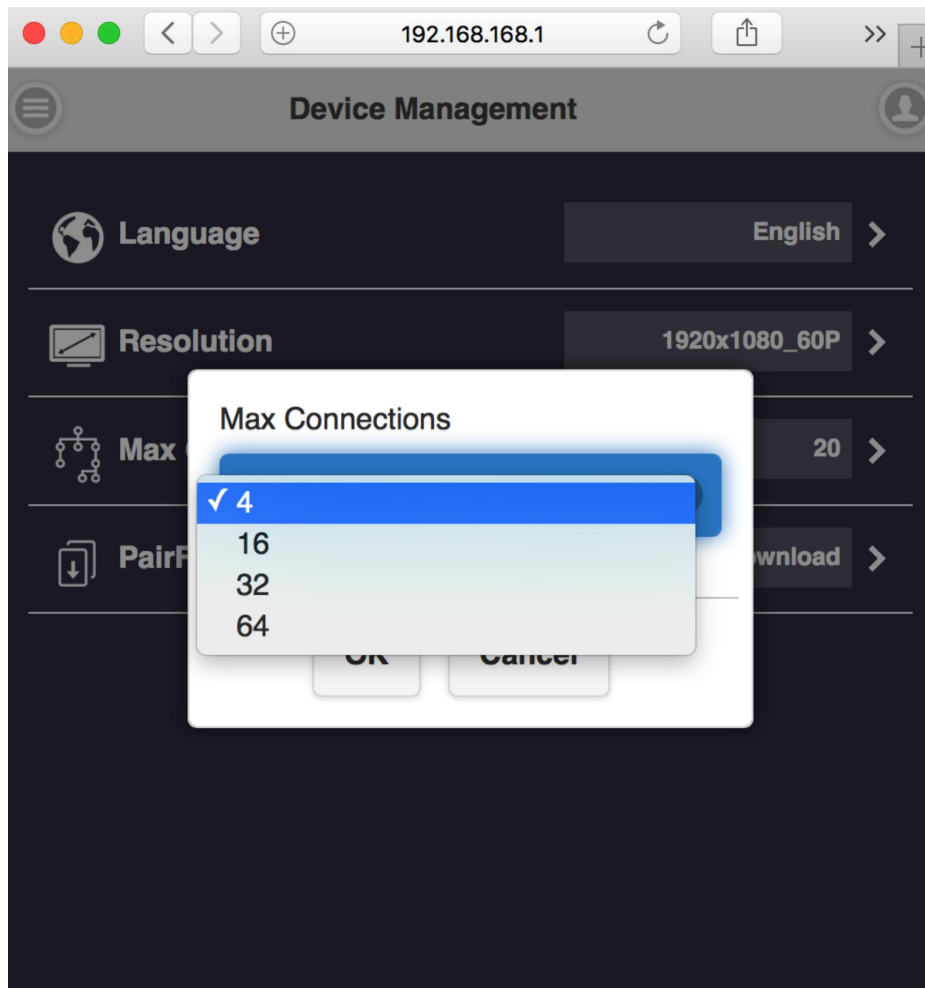

4.4 Pair File Download- down load the pairing file from here and copy to USB drive. Plug in Transmitter for pairing* when the Receiver has been installed on the ceiling or wherever difficult to plug directly.

The switch of USB on Transmitter shall be adjusted to “mobile”.

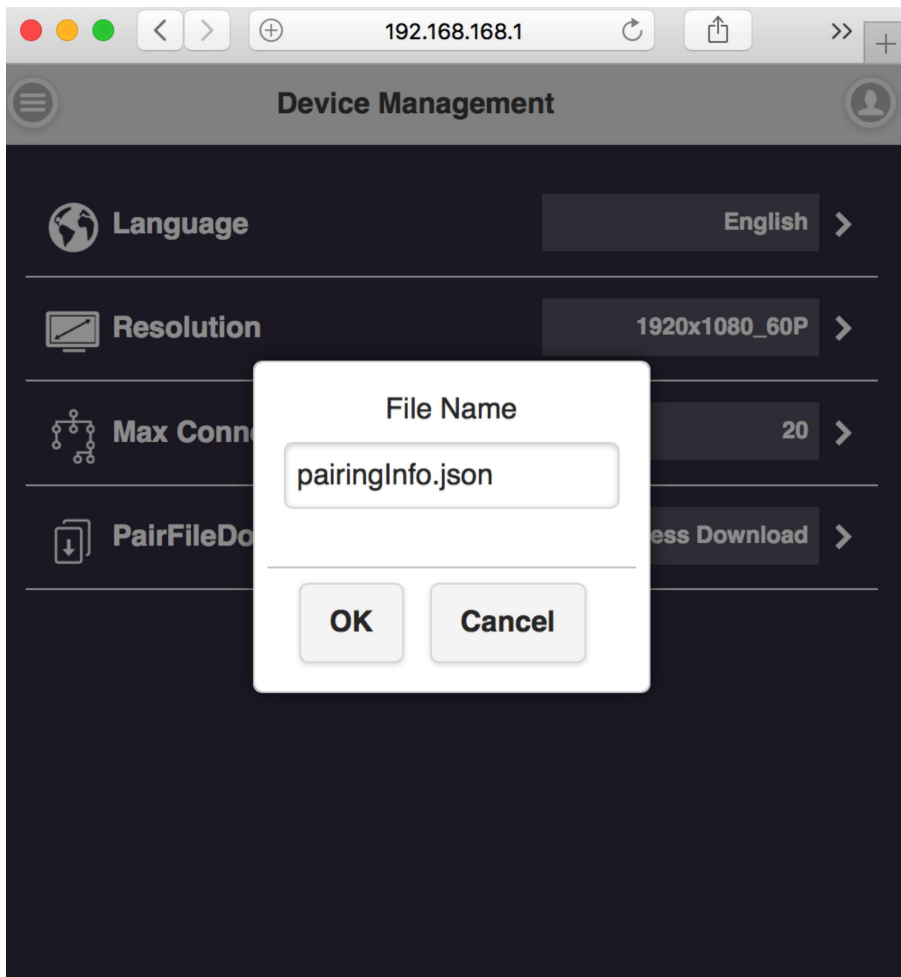



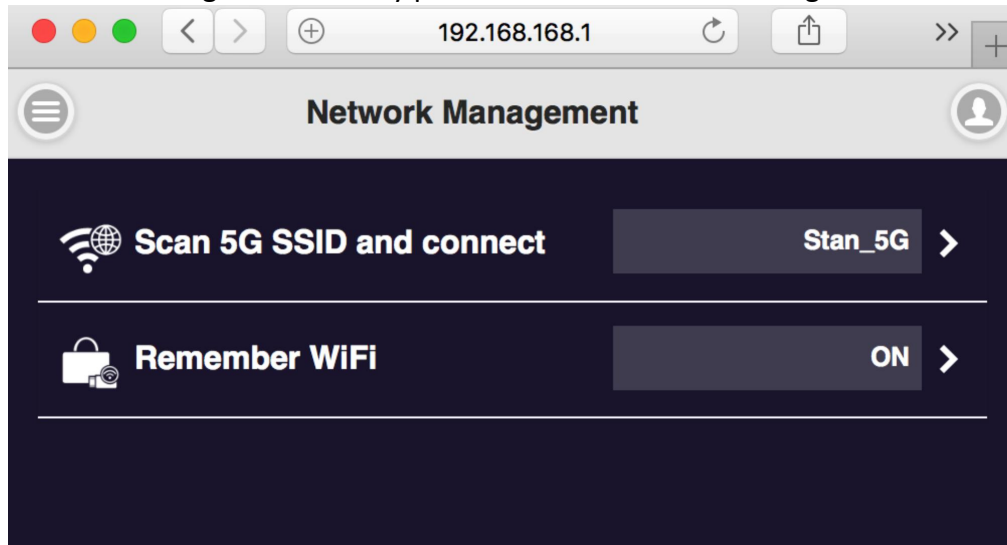

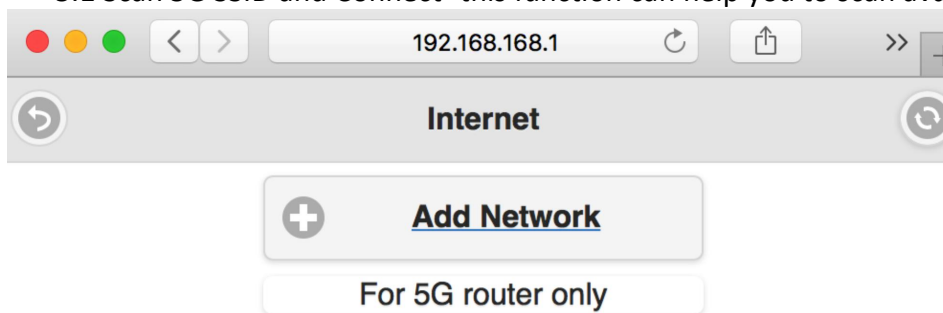

5. Network Management- mainly provide outbound Wi-Fi setting.



5.1 Scan 5G SSID and Connect- this function can help you to scan available Wi-Fi AP and join.



Stan_5G	
alien5G	
QATEST5	
Home WiFi 5G	
5G_tyw_RTAC55	
QuattroR01_5D5475FD	

5.2 Remember Wi-Fi- it to provide options to remember the AP setting parameter or

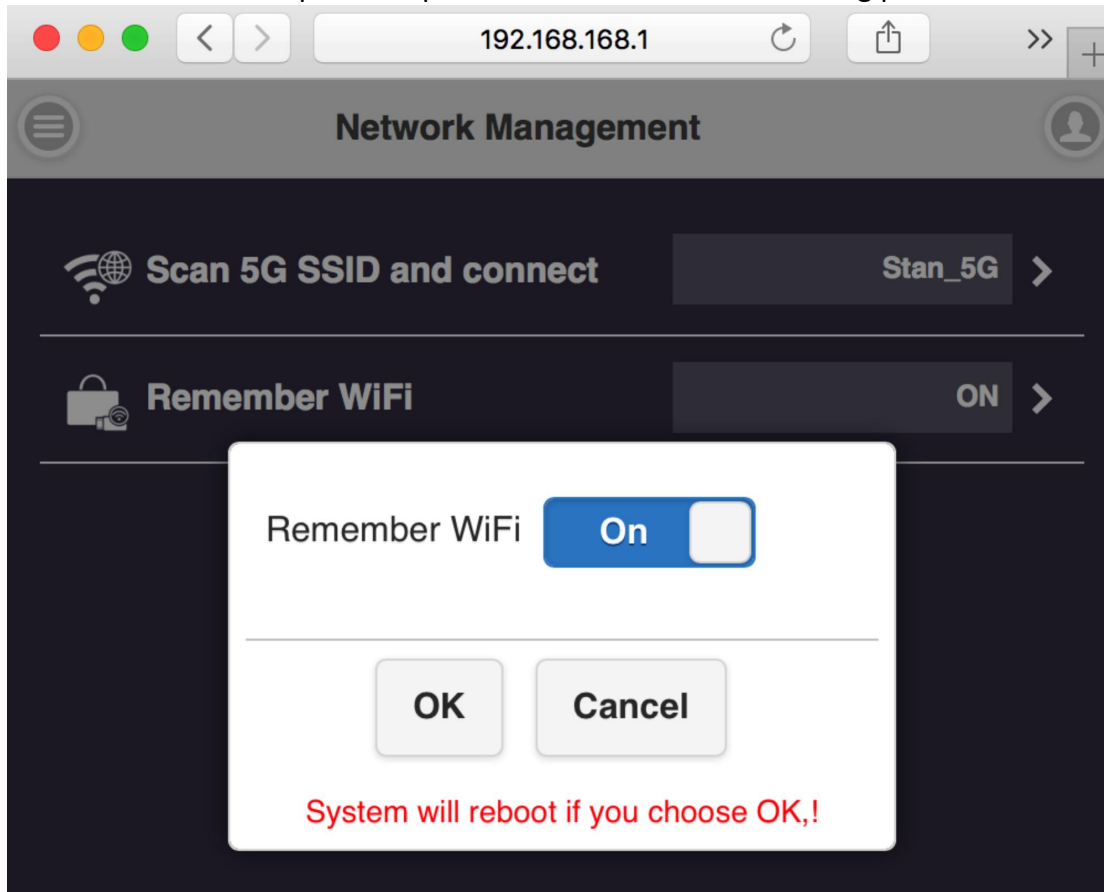

not.

6. Admin Setting-

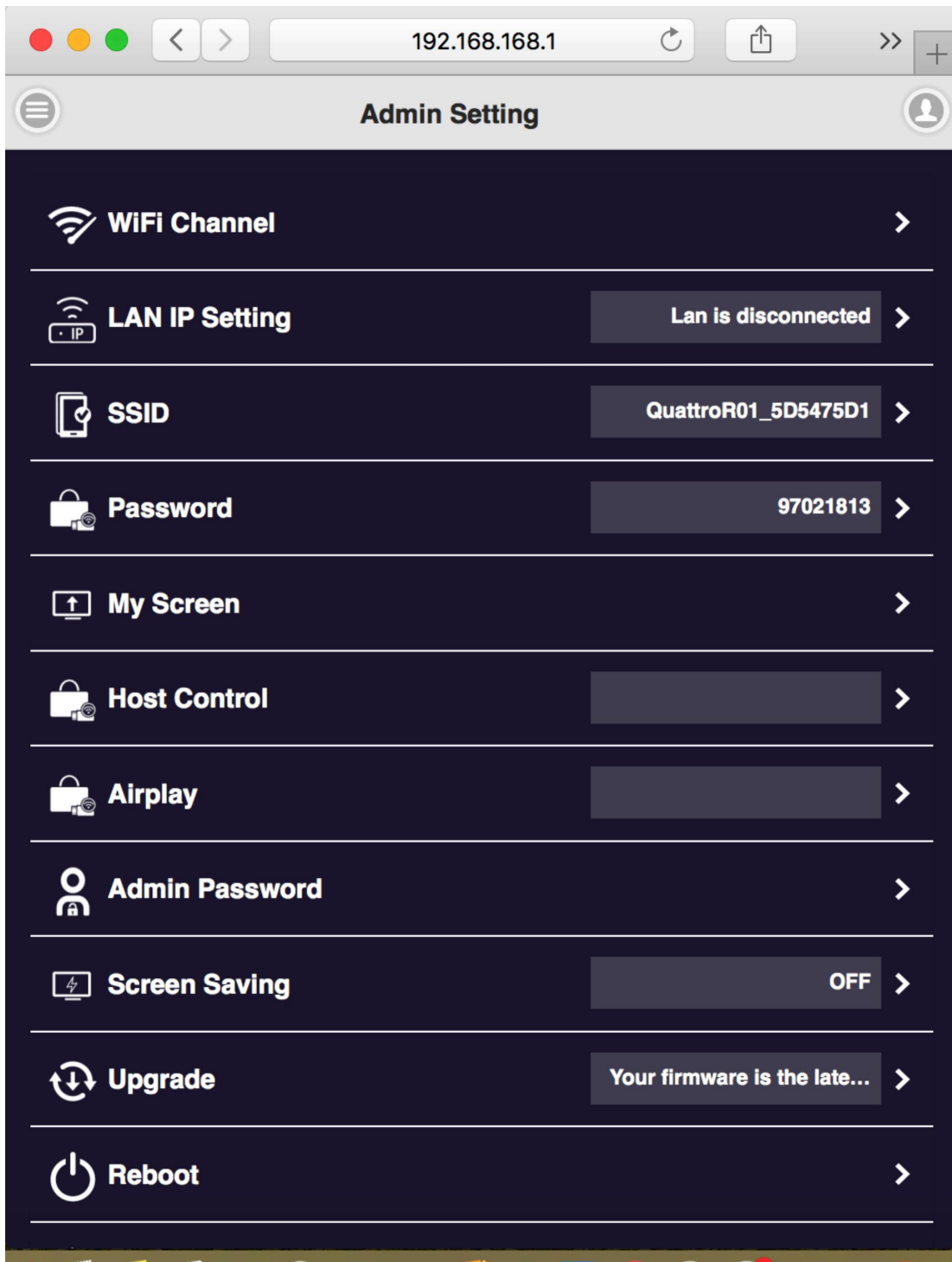

6.1 Wi-Fi Channel- to select the channel between QuattroPod Receiver & Transmitter to adjust the performance.

6.2 LAN IP Setting- to configure the wire line connection through LAN cable. **we can support only one connection, either LAN or Wi-Fi at one time.*

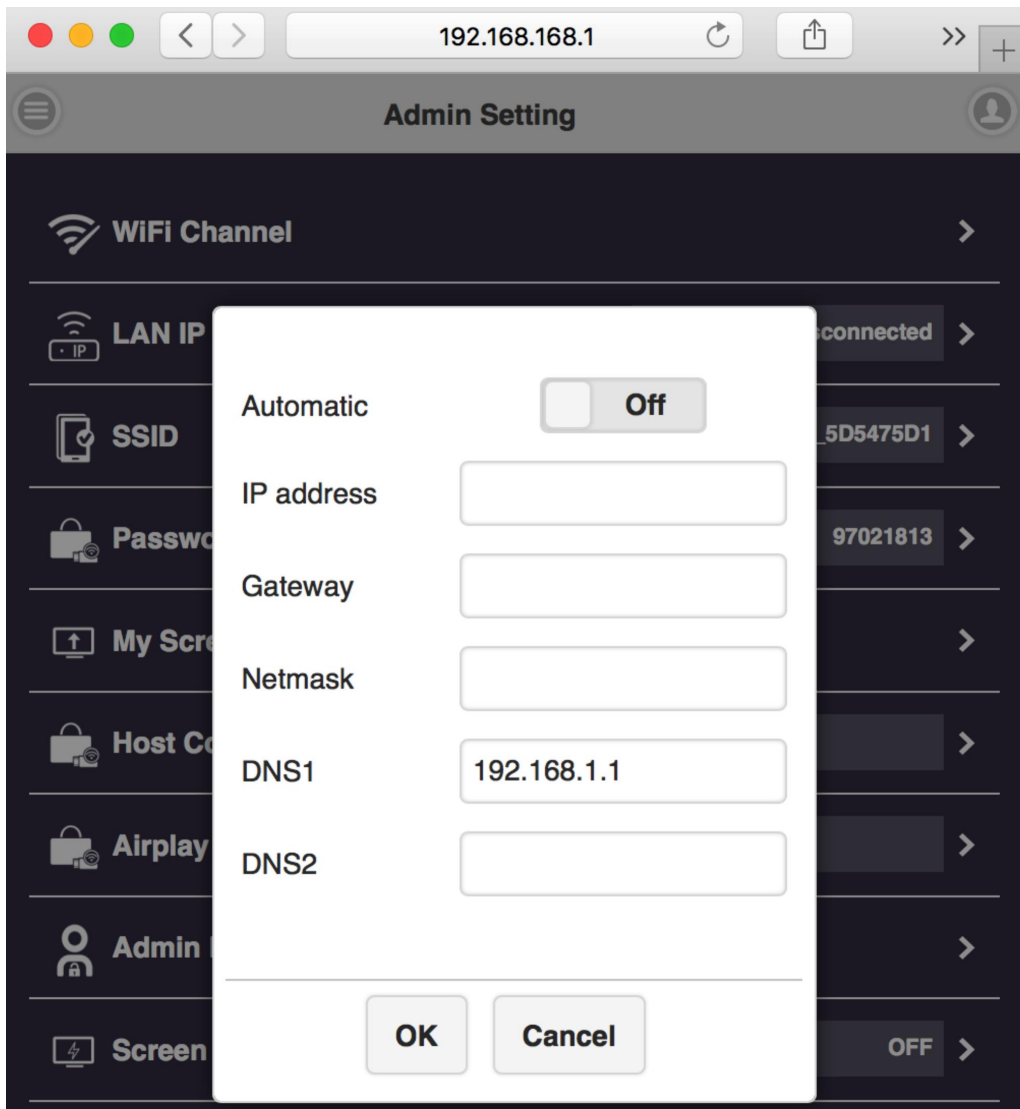

6.3 SSID- to set the SSID indication of the Receiver on the main screen.

New SSID

QuattroR01_5D5475D1

Hide SSID Off

Turn Off SSID Off

OK Cancel

6.4 users can change password of the Receiver, or hide the password to avoid connections without authorization.

Password

97021813

Hide Password: OFF

OK Cancel

6.5 My Screen- Users can replace the theme of the main page of Receiver by uploading graphic or photos.

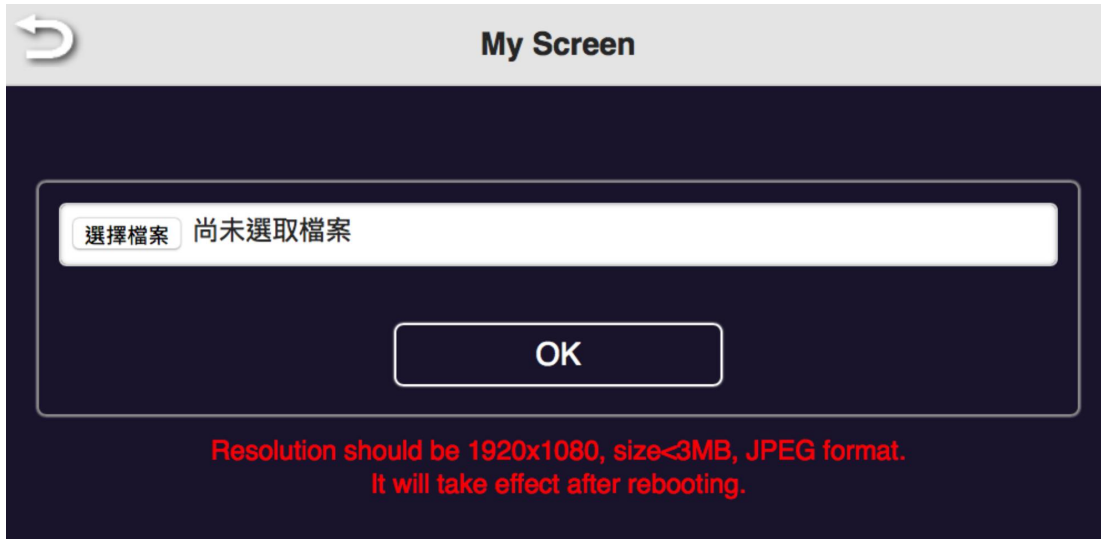

6.6 Host Control- it can be selected the mode of cast request. Auto Allow means the new request will be cast on screen directly. Share screen will present in screen split when it was on. If set it off, the new casting will be full screen mode.

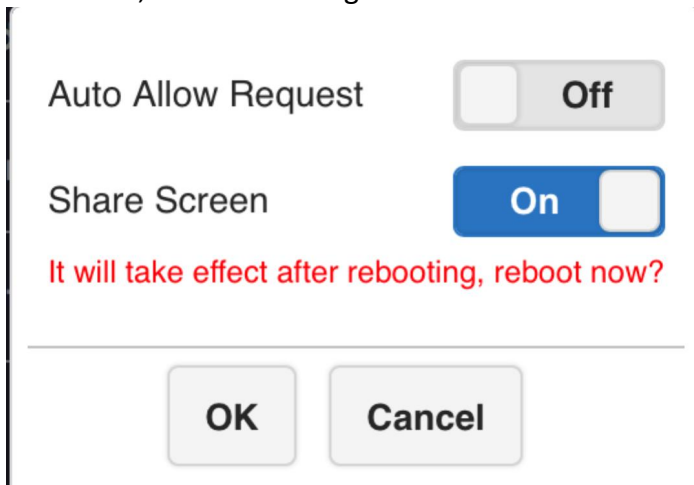

6.7 Airplay- to turn on/off the iOS /Mac devices can cast without QuattroPod Transmitters.

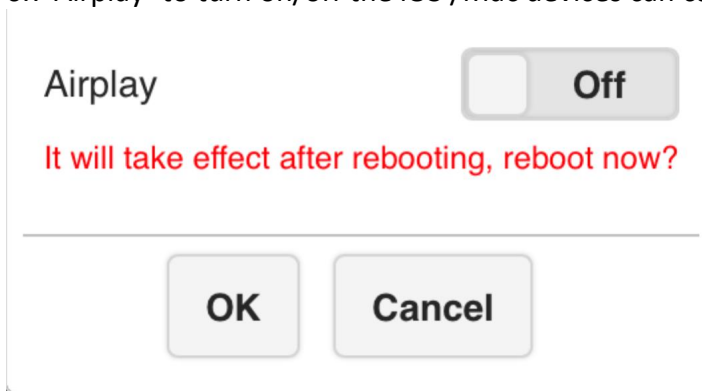

6.8 Change Admin Password- to change the web setting's log in password.

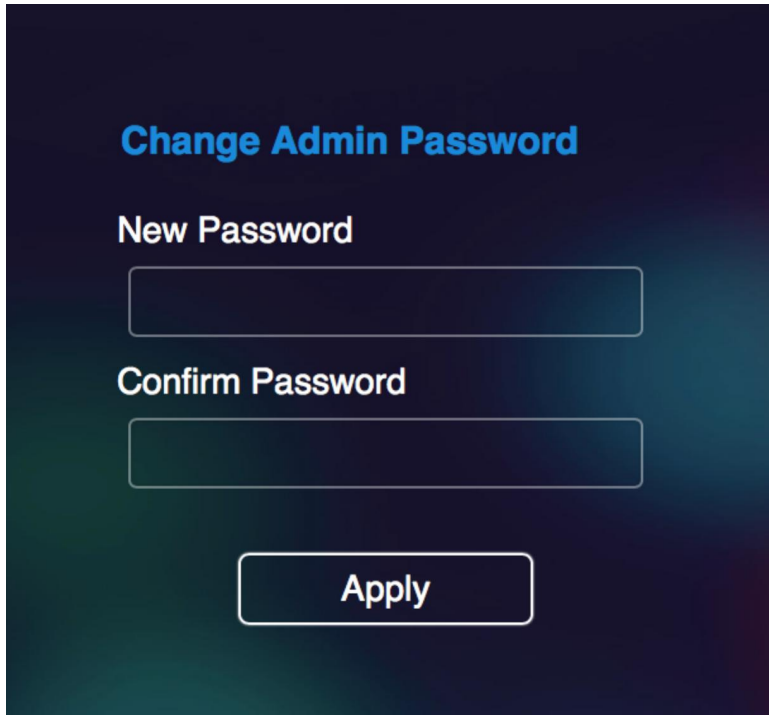

6.9 Screen Saving- to configure the screen off when the input is idle for certain time.

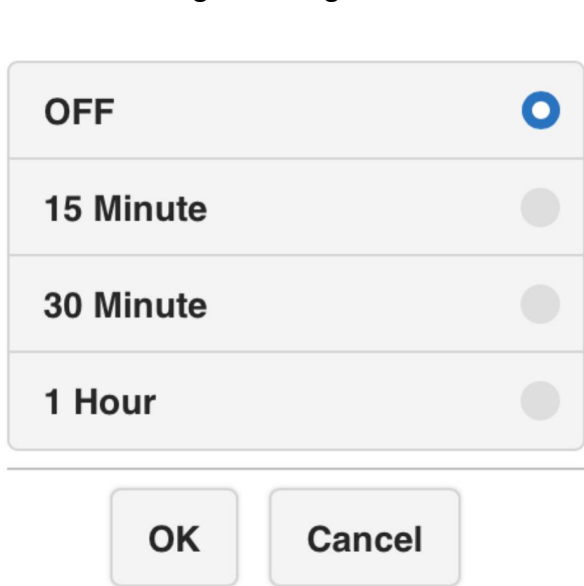

6.10 upgrade firmware- to remind users if there is new firmware released and execute the upgrade (* but the Receiver must connect to internet)

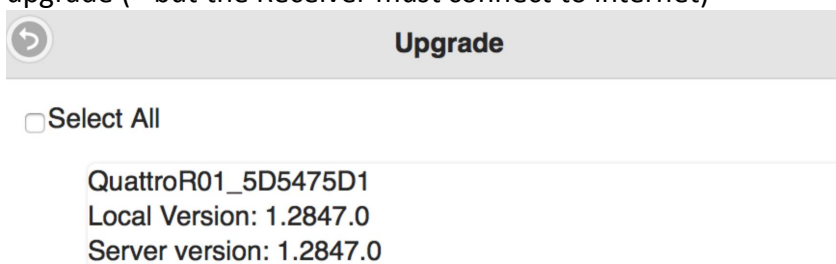

6.11 Reboot- to reboot the equipment.

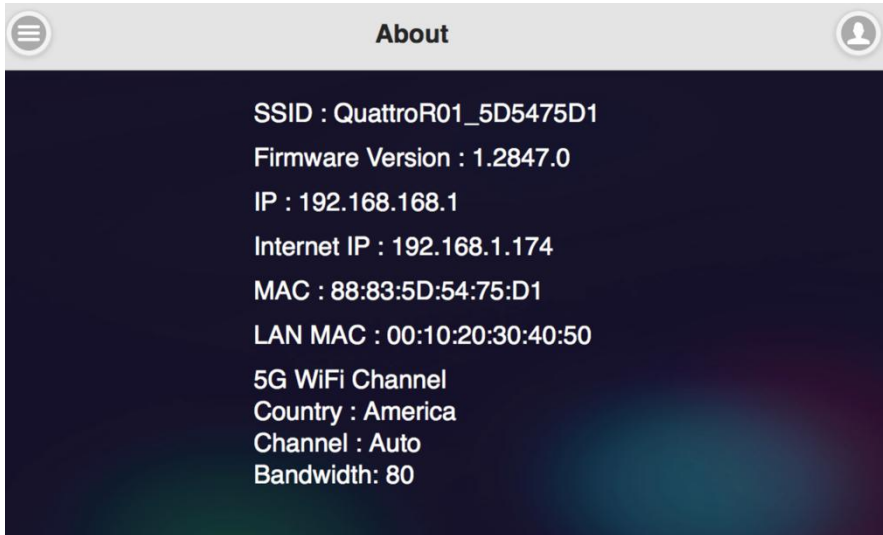

7. About- showing the information of the Receiver.









Frequent Applications & Operation

1. Host has projected on screen, and quest required sharing the screen. Host allows.





	Indicator 1	Indicator 2	Indicator 3	Result of screen
Host				

Guest				
-------	---	---	--	--

2. Host has projected on screen, Host rejects Guest's screen share request.





	Indicator 1	Indicator 2	Indicator 3	Result of screen
Host				
Guest				

3. From share screen mode, Host allows Guest full screen request.





	Indicator 1	Indicator 2	Indicator 3	Result of screen
Host				

Guest				
-------	---	---	---	--

4. Guest full screen mode, Host retrieves share screen request.

	Indicator 1	Indicator 2	Indicator 3	Result of screen
Host				
Guest				

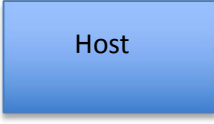
5. Guest full/share screen mode, Host retrieves full screen request.

	Indicator 1	Indicator 2	Indicator 3	Result of screen
Host				
Guest				

This product can only be used indoors, antenna type only allows use of PCB antenna and PIFA Antenna

The transmitter can be used as a receiver and the receiver can be used as a transmitter

FCC STATEMENT

1. This device complies with Part 15 of the FCC Rules. Operation is subject to the following two conditions:

(1) This device may not cause harmful interference.

(2) This device must accept any interference received, including interference that may cause undesired operation.

2. Changes or modifications not expressly approved by the party responsible for compliance could void the user's authority to operate the equipment.

NOTE: This equipment has been tested and found to comply with the limits for a Class B digital device, pursuant to Part 15 of the FCC Rules. These limits are designed to provide reasonable protection against harmful interference in a residential installation. This equipment generates uses and can radiate radio frequency energy and, if not installed and used in accordance with the instructions, may cause harmful interference to radio communications. However, there is no guarantee that interference will not occur in a particular installation. If this equipment does cause harmful interference to radio or television reception, which can be determined by turning the equipment off and on, the user is encouraged to try to correct the interference by one or more of the following measures:

Reorient or relocate the receiving antenna.

Increase the separation between the equipment and receiver.

Connect the equipment into an outlet on a circuit different from that to which the receiver is connected.

Consult the dealer or an experienced radio/TV technician for help.

FCC Radiation Exposure Statement

This equipment complies with FCC radiation exposure limits set forth for an uncontrolled environment. This equipment should be installed and operated with minimum distance 20cm between the radiator & your body